



Legal and Vesting Product Cover Sheet

ORDER INFORMATION

FILE/ORDER NUMBER:	LL-HCBAT-00228	PRODUCT NAME:	LEGAL AND VESTING
BORROWER NAME(S):	JANICE R HEATH		
PROPERTY ADDRESS:	1085 BRUNES BLVD		
CITY, STATE AND COUNTY:	BROWNSBURG, INDIANA, HENDRICKS		

SEARCH INFORMATION

SEARCH DATE:	04/18/2024	EFFECTIVE DATE:	04/17/2024
NAME(S) SEARCHED:	JANICE R HEATH		
ADDRESS/PARCEL SEARCHED:	1085 BRUNES BLVD, BROWNSBURG, INDIANA, 46112 / 32-07-24-113-002.000-016		

ASSESSMENT INFORMATION

COMMENTS:	
-----------	--

CURRENT OWNER VESTING

JANICE R HEATH
COMMENTS:

VESTING DEED

DEED TYPE:	WARRANTY DEED	GRANTOR:	C. K. CRAWFORD AND ANDREA E. CRAWFORD, HUSBAND AND WIFE
DATED DATE:	04/11/2011	GRANTEE:	JANICE R HEATH
BOOK/PAGE:	N/A	RECORDED DATE:	12/04/2011
INSTRUMENT NO:	201108362		
COMMENTS:			

FOR PREAMBLE

CITY/TOWNSHIP/PARISH:	CITY OF BROWNSBURG
-----------------------	--------------------

ADDITIONAL NOTES

LEGAL DESCRIPTION

THE FOLLOWING DESCRIBED REAL ESTATE IN HENDRICKS COUNTY, INDIANA:

UNIT NUMBERED ONE HUNDRED TWELVE (112) IN HOLIDAY PINES FINAL PLAT, AN ADDITION TO THE TOWN OF BROWNSBURG, HENDRICKS COUNTY, INDIANA, AS PER PLAT THEREOF RECORDED NOVEMBER 13, 1998 IN PLAT CABINET 1, SLIDE 186 PAGES 1A AND 1B IN THE OFFICE OF THE RECORDER OF HENDRICKS COUNTY, INDIANA.

32-07-24-113-002.000-016

General Information

Parcel Number
32-07-24-113-002.000-016

Local Parcel Number
14-2-24-61E 113-002

Tax ID:
014-224611-113002

Routing Number
.

Property Class 510
1 Family Dwell - Platted Lot

Year: 2023

Location Information

County
Hendricks

Township
LINCOLN TOWNSHIP

District 016 (Local 014)
BROWNSBURG TOWN

School Corp 3305
BROWNSBURG COMMUNITY

Neighborhood 1452402
HOLIDAY PINES

Section/Plat
024

Location Address (1)
1085 BRUNES BLVD
BROWNSBURG, IN 46112

Zoning

Subdivision
HOLIDAY PINES

Lot
112

Market Model
N/A

Characteristics

Topography Flood Hazard

Public Utilities ERA

Streets or Roads TIF

Neighborhood Life Cycle Stage
Static

Printed Tuesday, April 25, 2023

Review Group 2023

HEATH, JANICE R

Ownership

HEATH, JANICE R
1085 BRUNES BLVD
BROWNSBURG, IN 46112

Legal

HOLIDAY PINES LOT 112 .34AC

1085 BRUNES BLVD

Transfer of Ownership

Date	Owner	Doc ID	Code	Book/Page	Adj Sale Price	V/I
04/12/2011	HEATH, JANICE R		WD	/	\$185,000	I
07/27/1999	CRAWFORD, C K & A		WD	/	\$0	I

510, 1 Family Dwell - Platted Lot

Res

Valuation Records (Work In Progress values are not certified values and are subject to change)

2023	Assessment Year	2023	2022	2021	2020	2019
WIP	Reason For Change	Annual-Adj	Annual-Adj	Annual-Adj	Annual-Adj	Annual-Adj
03/03/2023	As Of Date	04/06/2023	04/07/2022	03/27/2021	04/01/2020	03/22/2019
Indiana Cost Mod	Valuation Method	Indiana Cost Mod	Indiana Cost Mod	Indiana Cost Mod	Indiana Cost Mod	Indiana Cost Mod
1.0000	Equalization Factor	1.0000	1.0000	1.0000	1.0000	1.0000
	Notice Required	<input type="checkbox"/>	<input type="checkbox"/>	<input type="checkbox"/>	<input type="checkbox"/>	<input type="checkbox"/>
\$55,200	Land	\$55,200	\$52,700	\$52,700	\$52,700	\$50,200
\$55,200	Land Res (1)	\$55,200	\$52,700	\$52,700	\$52,700	\$50,200
\$0	Land Non Res (2)	\$0	\$0	\$0	\$0	\$0
\$0	Land Non Res (3)	\$0	\$0	\$0	\$0	\$0
\$235,300	Improvement	\$235,300	\$223,700	\$193,800	\$183,400	\$177,600
\$235,300	Imp Res (1)	\$235,300	\$223,700	\$193,800	\$183,400	\$177,600
\$0	Imp Non Res (2)	\$0	\$0	\$0	\$0	\$0
\$0	Imp Non Res (3)	\$0	\$0	\$0	\$0	\$0
\$290,500	Total	\$290,500	\$276,400	\$246,500	\$236,100	\$227,800
\$290,500	Total Res (1)	\$290,500	\$276,400	\$246,500	\$236,100	\$227,800
\$0	Total Non Res (2)	\$0	\$0	\$0	\$0	\$0
\$0	Total Non Res (3)	\$0	\$0	\$0	\$0	\$0

Land Data (Standard Depth: Res 120', CI 100' Base Lot: Res 104' X 127', CI 0' X 0')

Land Type	Pricing Method	Soil ID	Act Front.	Size	Factor	Rate	Adj. Rate	Ext. Value	Infl. %	Res Elig %	Market Factor	Value
F	F		0	120x125	1.02	\$451	\$460	\$55,200	0%	100%	1.0000	\$55,200

HOLIDAY PINES/1452402

1/2

Notes

8/2/2022 REASSESSMENT: 23/24 CYCLICAL RA - PER PICT & MLS 21105552, ADJ FP FRM MAS TO PREFAB - AR

10/2/2018 REASSESSMENT: 19/20 CYCLICAL RA- NO CHNG PER PICT & NO MLS-DGE

9/4/2007 : 07/08 RESKETCHED TOOK OFF SHED

12/6/2000 : 99-00 SPLIT NEW SUB BASE IS 80 MLJ
00-01 ADDED NEW HOME MEK
01/02 ADDED SHED TMS

Land Computations

Calculated Acreage	0.34
Actual Frontage	0
Developer Discount	<input type="checkbox"/>
Parcel Acreage	0.00
81 Legal Drain NV	0.00
82 Public Roads NV	0.00
83 UT Towers NV	0.00
9 Homesite	0.00
91/92 Acres	0.00
Total Acres Farmland	0.00
Farmland Value	\$0
Measured Acreage	0.00
Avg Farmland Value/Acre	0.0
Value of Farmland	\$0
Classified Total	\$0
Farm / Classified Value	\$0
Homesite(s) Value	\$0
91/92 Value	\$0
Supp. Page Land Value	
CAP 1 Value	\$55,200
CAP 2 Value	\$0
CAP 3 Value	\$0
Total Value	\$55,200

General Information

Occupancy	Single-Family
Description	Single-Family Residen
Story Height	1
Style	N/A
Finished Area	1802 sqft
Make	

Floor Finish

<input type="checkbox"/> Earth	<input type="checkbox"/> Tile
<input type="checkbox"/> Slab	<input type="checkbox"/> Carpet
<input type="checkbox"/> Sub & Joist	<input type="checkbox"/> Unfinished
<input type="checkbox"/> Wood	<input type="checkbox"/> Other
<input type="checkbox"/> Parquet	

Wall Finish

<input type="checkbox"/> Plaster/Drywall	<input type="checkbox"/> Unfinished
<input type="checkbox"/> Paneling	<input type="checkbox"/> Other
<input type="checkbox"/> Fiberboard	

Roofing

<input type="checkbox"/> Built-Up	<input type="checkbox"/> Metal	<input checked="" type="checkbox"/> Asphalt	<input type="checkbox"/> Slate	<input type="checkbox"/> Tile
<input type="checkbox"/> Wood Shingle		<input type="checkbox"/> Other		

Exterior Features

Description	Area	Value
Stoop, Masonry	75	\$2,100
Canopy, Roof Extension	75	\$1,000
Patio, Concrete	144	\$900

Plumbing

	#	TF
Full Bath	2	6
Half Bath	0	0
Kitchen Sinks	1	1
Water Heaters	1	1
Add Fixtures	0	0
Total	4	8

Accommodations

Bedrooms	3
Living Rooms	
Dining Rooms	
Family Rooms	1
Total Rooms	8

Heat Type

Central Warm Air

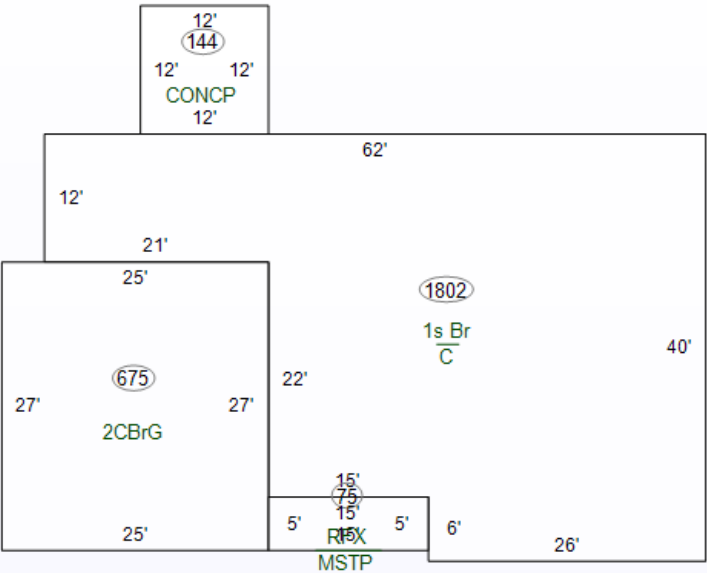

Specialty Plumbing

Description	Count	Value
-------------	-------	-------

Cost Ladder

Floor	Constr	Base	Finish	Value	Totals
1	7	1802	1802	\$128,300	
2					
3					
4					
1/4					
1/2					
3/4					
Attic					
Bsmt					
Crawl		1802	0	\$7,900	
Slab					

Total Base \$136,200

Adjustments 1 Row Type Adj. x 1.00 \$136,200

Unfin Int (-)		\$0
Ex Liv Units (+)		\$0
Rec Room (+)		\$0
Loft (+)		\$0
Fireplace (+)	PS:1 PO:1	\$4,700
No Heating (-)		\$0
A/C (+)	1:1802	\$4,100
No Elec (-)		\$0
Plumbing (+ / -)	8 - 5 = 3 x \$800	\$2,400
Spec Plumb (+)		\$0
Elevator (+)		\$0

Sub-Total, One Unit \$147,400

Sub-Total, 1 Units

Exterior Features (+)	\$4,000	\$151,400
Garages (+) 675 sqft	\$21,700	\$173,100
Quality and Design Factor (Grade)	1.05	
Location Multiplier	1.00	

Replacement Cost \$181,755

Summary of Improvements

Description	Res Eligibl	Story Height	Construction	Grade	Year Built	Eff Year	Eff Co Age nd	Base Rate	LCM	Adj Rate	Size	RCN	Norm Dep	Remain. Value	Abn Obs	PC Nbhd	Mrkt	Improv Value
1: Single-Family Residen	100%	1	Brick	C+1	1999	1999	24 A		1.00		1,802 sqft	\$181,755	22%	\$141,770	0%	100%	1.660 1.0000	\$235,300

DULY ENTERED
FOR TAXATION

APR 12 2011

Cinda Kattau
AUDITOR HENDRICKS COUNTY



* 2 0 1 1 0 8 3 6 2 1 *

201108362

PAUL T HARDIN
HENDRICKS COUNTY RECORDER
04/12/2011 02:47:01PM

WARRANTY DEED 1 of 1

THIS INDENTURE WITNESSETH, that C.K. CRAWFORD AND ANDREA E. CRAWFORD, HUSBAND AND WIFE (Grantor), conveys and warrants to JANICE R. HEATH (Grantee) for the sum of One Dollar (\$1.00) and other valuable consideration, the receipt of which is hereby acknowledged, the following described real estate in Hendricks County, Indiana:

Unit Numbered One hundred twelve (112) in Holiday Pines- Final Plat, an addition to the Town of Brownsburg, Hendricks County, Indiana, as per plat thereof recorded November 13, 1998 in Plat Cabinet 1, Slide 186 pages 1A and 1B in the office of the Recorder of Hendricks County, Indiana.

Subject to all rights-of-way, easements and restrictions of record.

Subject to all taxes now a lien and to become a lien thereon.

IN WITNESS WHEREOF, Grantor has executed this Deed this 11th day of April, 20 11.

C.K. Crawford
C.K. Crawford

Andrea E. Crawford
Andrea E. Crawford

STATE OF INDIANA)
) SS:
COUNTY OF HENDRICKS)

Before me, a Notary Public in and for said County and State, personally appeared C.K. CRAWFORD AND ANDREA E. CRAWFORD, HUSBAND AND WIFE, who acknowledged the execution of the foregoing instrument, and who, having been duly sworn, stated that any representations therein contained are true.

Witness my hand and Notarial Seal this 11th day of April, 20 11.

My Commission Expires

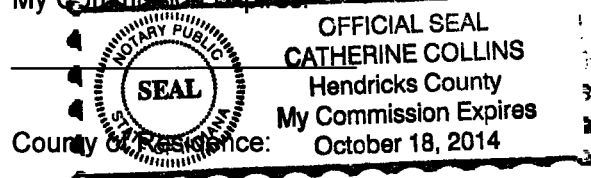

[Signature]
Signature of Notary Public

Printed Name of Notary Public

1 Tax mailing address 1085 BRUNES BLVD BROWNSBURG, IN 46112

Grantee mailing address SAME

I affirm, under the penalties for perjury, that I have taken reasonable care to redact each Social Security number in this document, unless required by law, Ben Comer.

This instrument was prepared by Ben Comer, 71 West Marion Street, P.O. Box 207, Danville, IN 46122, telephone: (317) 745-4300.

Commitment Number: 10-08156

17-
141

Search Results for:

NAME: Heath, Janice (Super Search)



REGION: Hendricks County, IN

DOCUMENTS VALIDATED THROUGH: 04/18/2024 3:24 PM

Showing 25 results

Filter:

Document Details	County	Date	Type	Name	Legal
196700806	Hendricks	08/24/1967	DEED : DEED	HEATH, JANICE RUTH Search Search BROWN, GLADYS M Search HEATH, ROBERT PAUL	Search 20-16N-2E NE NW
198802662	Hendricks	05/02/1988	MORT : MORTGAGE	HEATH, JANICE Search Search HEATH, ROBERT Search UNION FEDERAL SAVINGS AND LOAN ASSOCIATION	Search 20-16N-2E NE NW
198906797	Hendricks	04/06/1989	REL : MORTGAGE RELEASE	HEATH, JANICE RUTH Search Search HEATH, ROBERT PAUL Search UNION FEDERAL SAVINGS & LOAN	
198917263	Hendricks	11/27/1989	MORT : MORTGAGE	HEATH, JANICE RUTH Search Search HEATH, ROBERT PAUL Search BANK ONE PLAINFIELD	Search 20-16N-2E NE NW
199115482	Hendricks	01/08/1991	REL : MORTGAGE RELEASE	HEATH, JANICE Search Search HEATH, ROBERT Search UNION FEDERAL SAVINGS &	
199107229	Hendricks	09/10/1991	REL : MORTGAGE RELEASE	HEATH, JANICE RUTH Search Search HEATH, ROBERT PAUL Search BANK ONE	
199410269	Hendricks	05/11/1994	MORT : MORTGAGE	HEATH, JANICE RUTH Search Search HEATH, ROBERT PAUL Search BANK ONE	Search 20-16N-2E NE NW

Document Details	County	Date	Type	Name	Legal
199603532	Hendricks	02/23/1996	MORT : MORTGAGE	HEATH, JANICE RUTH Search Search HEATH, ROBERT PAUL Search BANK ONE	Search 20-16N-2E NE NW
199604863	Hendricks	03/13/1996	MORT : MORTGAGE	HEATH, JANICE RUTH Search Search HEATH, ROBERT PAUL Search BANK ONE	Search 20-16N-2E NE NW
199605542	Hendricks	03/22/1996	REL : MORTGAGE RELEASE	HEATH, JANICE RUTH Search Search HEATH, ROBERT PAUL Search BANK ONE	
199709131	Hendricks	05/12/1997	MORT : MORTGAGE	HEATH, JANICE R Search Search HEATH, ROBERT P Search BANK ONE	Search 20-16N-2E NE NW
199712123	Hendricks	06/19/1997	REL : MORTGAGE RELEASE	HEATH, JANICE RUTH Search Search HEATH, ROBERT PAUL Search BANK ONE	
199712767	Hendricks	06/26/1997	REL : MORTGAGE RELEASE	HEATH, JANICE RUTH Search Search HEATH, ROBERT PAUL Search BANK ONE	
199823839	Hendricks	09/08/1998	MORT : MORTGAGE	HEATH, JANICE RUTH Search Search HEATH, ROBERT PAUL Search BANK ONE	Search 20-16N-2E NE NW
199825081	Hendricks	09/21/1998	REL : MORTGAGE RELEASE	HEATH, JANICE R Search Search HEATH, ROBERT P Search BANK ONE	
200242047	Hendricks	12/03/2002	MISC : AFFIDAVIT OF SURVIVORSHIP	HEATH, JANICE RUTH Search Search HEATH, ROBERT PAUL	Search 20-16N-2E NE NW
200242048	Hendricks	12/03/2002	MORT : MORTGAGE	HEATH, JANICE RUTH Search Search BANK ONE	Search 20-16N-2E NE NW

Document Details	County	Date	Type	Name	Legal
200242724	Hendricks	12/09/2002	REL : MORTGAGE RELEASE	HEATH, JANICE RUTH Search Search HEATH, ROBERT PAUL Search BANK ONE Search BANK ONE INDIANA	
200729456	Hendricks	11/16/2007	REL : MORTGAGE RELEASE	HEATH, JANICE RUTH Search Search BANK ONE Search JPMORGAN CHASE BANK	
201108362	Hendricks	04/12/2011	DEED : DEED	HEATH, JANICE R Search Search CRAWFORD, ANDREA E Search CRAWFORD, C K	Search Lot 112 HOLIDAY PINES
201108354	Hendricks	04/12/2011	DEED : DEED	HEATH, JANICE RUTH Search Search ED&H LLC	Search 20-16N-2E NE NW
201108355	Hendricks	04/12/2011	MORT : MORTGAGE	HEATH, JANICE RUTH Search Search ED&H LLC	Search 20-16N-2E NE NW
201121575	Hendricks	10/03/2011	REL : MORTGAGE RELEASE	HEATH, JANICE RUTH Search Search ED&H LLC	
201823227	Hendricks	10/11/2018	MORT : MORTGAGE	HEATH, JANICE R Search Search HENDRICKS COUNTY BANK AND TRUST	Search Lot 112 HOLIDAY PINES
202221379	Hendricks	09/08/2022	REL : MORTGAGE RELEASE	HEATH, JANICE R Search Search HENDRICKS COUNTY BANK AND TRUST	

The data or information provided is based on information obtained from Indiana Courts, Clerks, Recorders, and Department of Revenue, and is not to be considered or used as an official record. Doxpop, LLC, the Division of State Court Administration, the Indiana Courts and Clerks of Court, the Indiana Recorders, and the Indiana Department of Revenue: 1) Do not warrant that the information is accurate or complete; 2) Make no representations regarding the identity of any persons whose names appear in the information; and 3) Disclaim any liability for any damages resulting from the release or use of the information. The user should verify the information by personally consulting the official record maintained by the court, clerk, recorder or Department of Revenue.

Copyright © 2002-2024 Doxpop, Ilc. All Rights Reserved