



Property Information		Request Information		Update Information
File#:	BS-W01469-3036253997	Requested Date:	10/25/2023	Update Requested:
Owner:	SUAD ARNAOUT	Branch:		Requested By:
Address 1:	4942 Abbey Rd	Date Completed:		Update Completed:
Address 2:		# of Jurisdiction(s):		
City, State Zip:	Coplay, PA	# of Parcel(s):	1	

Notes

- CODE VIOLATIONS** Per North Whitehall Township Department of Zoning there are no Code Violation cases on this property.
- Collector: North Whitehall Township
 Payable Address: 3256 Levans Road, Coplay, PA 18037
 Business# (610) 799-3411
 UNABLE TO PROVIDE DOCUMENTATION TO THIRD PARTIES. VERBAL INFO ACQUIRED.
- PERMITS** Per North Whitehall Township Department of Building there are no Open/ Pending/ Expired Permit on this property.
- Collector: North Whitehall Township
 Payable Address: 3256 Levans Road, Coplay, PA 18037
 Business# (610) 799-3411
 UNABLE TO PROVIDE DOCUMENTATION TO THIRD PARTIES. VERBAL INFO ACQUIRED.
- SPECIAL ASSESSMENTS** Per North Whitehall Township Department of Finance there are no Special Assessments/liens on the property.
- Collector: North Whitehall Township
 Payable Address: 3256 Levans Road, Coplay, PA 18037
 Business# (610) 799-3411
 UNABLE TO PROVIDE DOCUMENTATION TO THIRD PARTIES. VERBAL INFO ACQUIRED.
- DEMOLITION** NO
- UTILITIES**
- Water:**
 Account #: 1600800
 Payment Status: PAID
 Status: Pvt & Lienable
 Amount: \$0.00
 Good Thru: 02/01/2024
 Account Active: YES
 Collector: Northampton Borough Municipal Authority
 Payable Address: 1 Clear Springs Dr, Northampton, PA 18067
 Business # (610) 262-6711
- UNABLE TO PROVIDE DOCUMENTATION TO THIRD PARTIES. VERBAL INFO ACQUIRED.
- Sewer:** The house is on a community sewer. All houses go to a shared septic system.
- Garbage:**
 GARBAGE PRIVATE HAULER WITH LIEN STATUS AND BALANCE UNKNOWN.

County of Lehigh Online Records Access

Property Details

Street View



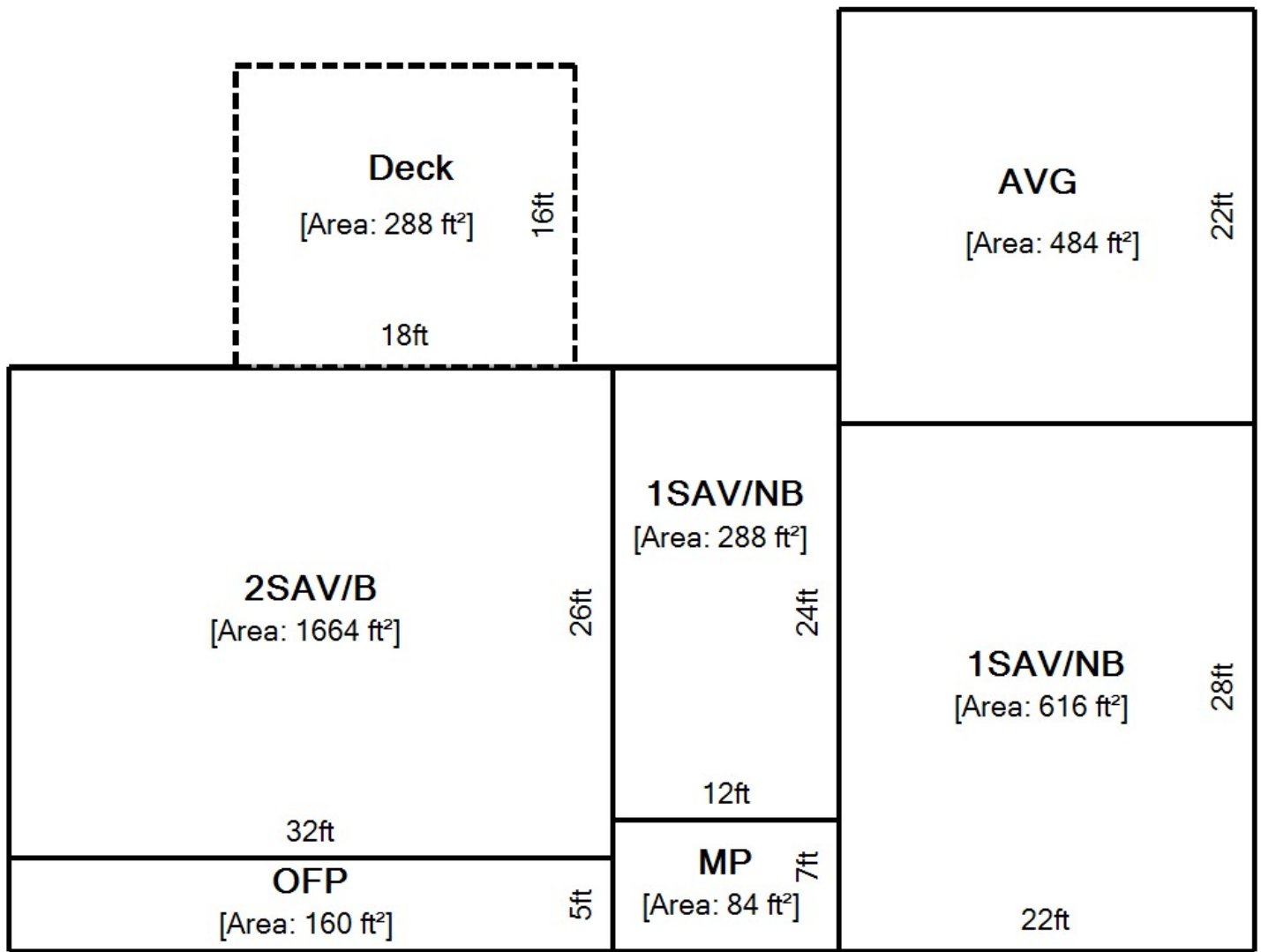

Property Overview

	2023		
Owner Name	ARNAOUT SUAD & BLANCA FLORES		
Owner Address	4942 ABBEY RD COPLAY PA 18037-2637		
Property Address	4942 ABBEY RD COPLAY PA 18037		
Parcel Viewer	View in Parcel Viewer		
Low Number	4942		
High Number	4942		
Sub Division	JENDY ESTATES		
Tax Authority	NORTH WHITEHALL TOWNSHIP		
School District	PARKLAND SCHOOL DISTRICT		
Parcel Id	558026744019 1		
Old Parcel Id	16 D08 010 018		
Tile	505806		
Acres/Dimension	1.009 ACRES		
Lot Sq Ft	43946		
Utilities	NONE		
Class	RESIDENTIAL		
Land Use	SINGLE FAMILY - DETACHED		
Living Units	1		
Zoning	AR		
Homestead Act 72	Application Approved and Enrolled - 01/31/2020		
Preferential Land Act	NO		
Agricultural Easement	NO		
Assessment Base Year	2013		
Total Assessment	Exempt Land		0
	Exempt Building		0
	Taxable Land		74,700
	Taxable Building		237,700
	Total		312,400
	Taxable Total		312,400
Estimated Taxes		Mills	Estimated Taxes
	County	3.780000	\$ 1,180.87
	School	16.400000	\$ 5,123.36
	Municipality	0.600000	\$ 187.44
	Total		\$ 6,491.67
	Tax calculations do not reflect any reduction received due to enrollment in Homestead Act 72		
Bill Number	1600165		
LC_PropertyAddress	4942 ABBEY RD COPLAY PA 18037		

Basic Residential Profile

Type of Residence	SINGLE FAMILY - DETACHED
--------------------------	--------------------------

Number of Stories	2 STORY
Type of Construction	ALUMINIUM/VINYL
Type of Basement	PART
Type of Heating/Cooling	CENTRAL AIR
Type of Garage	ATTACHED TWO CAR OR MORE
Number of Full Bathrooms	3
Number of Half Bathrooms	1
Fireplaces	1
Square Feet	2568
Year Built	1991
Pool	NO POOL
Implement Buildings	NO IMPLEMENT BLDG

Residential Profile Data With No Influence on Assessment Value

Total Rooms	7
Number of Bedrooms	3
Family Rooms	1

Sales History

Sale Date	Owner Name	Document Id	Sale Price
08/2018	ARNAOUT SUAD & BLANCA FLORES	2018023535	\$ 350,000
03/1991	KLEPEISS JOSEPH J & DEBRA J	1467/1175	\$ 43,000
01/1989	JENDY ASSOCIATES	1429/1187	\$ 310,047

The building sketch represents the actual exterior measurement of the structure as measured from the outside. The sketch will show any attached areas and will be labeled with a descriptive code. Measurements are rounded to the nearest foot. Certain sketch dimensions and angles are drawn in approximation to their actual measurements.

The total square-foot area includes only the assessed living area of a residential structure, generally areas that are heated and/or cooled. Living area does not include porches, decks, patios, or garages.

Some of the common abbreviations are listed below for reference:

BUILDING STYLE	
CODE	DESCRIPTION
1S	1 STORY
1.5S	1½ STORY
2S	2 STORY
2.5S	2½ STORY
3S	3 STORY
3.5S	3½ STORY
B-L	BI-LEVEL
S-L	SPLIT-LEVEL

EXTERIOR	
CODE	DESCRIPTION
AV, A, V	ALUMINUM OR VINYL
B	BRICK
B&F	BRICK & FRAME
BFR	BRICK FRONT
BTR	BRICK TRIM
C	CONCRETE
CB	CONCRETE BLOCK
F, FR	FRAME
ST	STONE
SD	STUCCO OR DRYVIT
MTL	METAL
GL	GLASS

CODE	DESCRIPTION	CODE	DESCRIPTION
A	ATTIC	IGP	INGROUND POOL
BAL	BALCONY	LD	LOADING DOCK
B	BASEMENT	MP	MASONRY PATIO
BAY	BAY	MS	MASONRY SLAB
BSG	BASEMENT GARAGE	NB	NO BASEMENT
BW	BREEZEWAY	NA	NOT ADDED
BLT	BUILT	NI	NOT INCLUDED
CP	CARPORT	OFF	OPEN FRAME PORCH
CPY	CANOPY	OMP	OPEN MASONRY PORCH
CC	CATHEDRAL CEILING	OH	OVERHANG
CRLS	CRAWL SPACE	PB	PART BASEMENT
DECK	DECK	PW	PARTY WALL
EFP	ENCLOSED FRAME PORCH	RECRM	RECREATION ROOM
EMP	ENCLOSED MASONRY PORCH	S	SHED
FB	FINISHED BASEMENT	SQFT	SQUARE FOOT
FDN	FOUNDATION	STRG	STORAGE
G	GARAGE	UFB	UNFINISHED BASEMENT
GH	GREENHOUSE	WD	DECK

EXAMPLE SKETCH

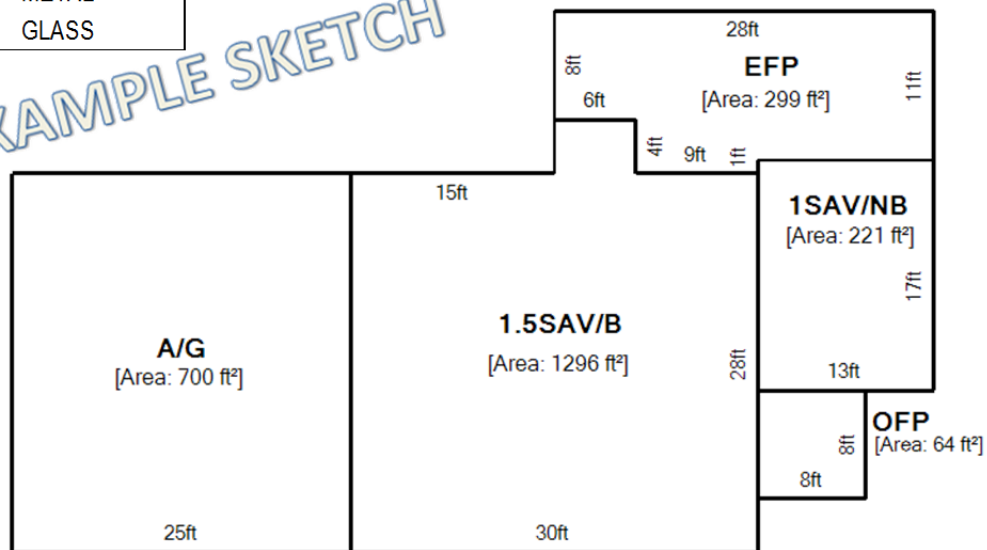

Information on this site is used for tax assessment purposes only and is subject to change without prior notice. The County of Lehigh Assessment Office assumes no responsibility for the use of the information for any other purpose. The use of information for any other purpose other than for tax assessment purposes is the sole and exclusive responsibility of the individual or entity using the information.