

823-R

CRS # 252222
TEL # ~~374~~ 2138
HIS # 104070
PERMIT # 9405
TOWN OF SEYMOUR
BUILDING DEPARTMENT
Field Inspection Report

Date 5-13-2003

Location of Property 11 Elm St.

Owner Peter Schumacher

Contractor Arnel Rodriguez

Inspection Ordered Taken By J.M.M.

Building Plumbing Heating Electrical

Description of Inspection Electric Service, washer & dryer hook up.

Approved Disapproved Violation

Analysis OK

Date 5-14-2003 Inspector John Muelor

Date 6/25 2003
APPLICATION FOR BUILDING PERMIT

Permit # 09542
 CK # 28590
 REC # B02488
 Estimated Cost \$ 4300
 Fee \$ 50.00
 Occupancy Fee \$ _____
 Additional Cost \$ _____

Building _____
 Plumbing _____
 Heating _____
 Electric _____
 Fixtures _____
 Affidavit _____
 Eng. Dept. _____
 Health Dept. _____
 Approved _____

TO THE BUILDING DEPARTMENT, TOWN OF SEYMOUR, CONNECTICUT
 The undersigned, hereby applies for a permit to do work according to the following specifications:

No. 11 Elm Street Lot No. _____ Side of Street _____ Zone _____
 Nearest cross street _____
 Owner of building Mr. & Mrs. Schumacher Address SAME AS ABOVE
Contractor Subicugi Roofing & Siding, Inc. Address 1082 South Main St. Seym
 Architect _____ Address _____
 Size Main Bldg.: No. ft. front overall _____ No. ft. deep overall _____ Area _____
 Size of wings _____ Garages _____ No. of families _____ No. of stories _____
 Construction _____ No. of rooms: 1st _____ 2nd _____ 3rd _____
 Size of Lot _____ Dist. from Street Line _____ Dist. from Side Line Street _____
 Purpose of building is Strip roof and apply retained to 25 year
shingles

Sewer Septic Tank

Dist. from lot line E. _____, W. _____, S. _____, N. _____, Dist. nearest bldg. _____ ft.
 Height of stories—cellar _____ 1st _____ 2nd _____ 3rd _____ 4th _____ 5th _____
 Found. depth below grade _____ Above grade _____ Mat. footing _____ Size footing _____
 Mat. for found. _____ Found. thickness _____ Mat. for sidewalls _____
 Roof _____ Outside studs _____ Dist. centers _____ Size sill _____ Ledges and girts _____
 Size of plate _____ Size hips and valleys _____ No. of stairways _____ Beams _____
 Piers _____ Dist. apart _____ No. of rows _____ Size of pier foundation _____
 Brick walls, if any _____ Size of same—1st _____ 2nd _____ 3rd _____
 If any front, rear, side or partition walls are supported on steel girders: 1st _____ 2nd _____
 Species of lumber—Floor joists _____ Studs _____ Rafters _____ R. Fl. _____ Fin. Fl. _____
 Floor joists, size: 1st _____ 2nd _____ 3rd _____ stories. Dist. on center _____
 Longest span of floor joist: 1st _____ 2nd _____ 3rd _____ If not wood joist const. what type of floor? _____
 Size of studs carrying partitions _____ Size of Roof Rafters _____ Longest span _____ on center.
 Chimneys, size of flues _____ How many? _____ Where does tile start? _____
 Plumbing contractor, Permit No. _____ Oil burners, Permit No. _____ Fixtures, Permit No. _____
 Heating contractor, Permit No. _____ Electrical, Permit No. _____

I hereby agree to conform to all the requirements of the Laws of the State of Connecticut and the Ordinances of the Town of Seymour, and to notify the Building Inspector of any alteration in the plans or specifications of the Building for which this permit is asked. And agree that this building is to be located the proper distance from all street lines, side yard lines and required distances from all other zones and is located in a zone in which this building and its use is allowed.

_____ hereby apply for a Certificate of Occupancy for _____ described in the above application for permit.
 Signed Agnes DeLuigi

CICS # 252222
TOWN OF SEYMOUR, CONNECTICUT
APPLICATION FOR ELECTRICAL PERMIT

Est. Cost \$ 3000.00
Fee \$ 43.00

Permit Number 9905
Date Issued 5-7-2003

REC# M-03552
~ RECEIPT ~

check # 327
Application is hereby made for a Permit to make Electrical Installation according to the following detailed statement of the specifications and plans herewith submitted. All provisions of the Electrical CODE shall be complied with.

LOCATION 11 ELM ST OWNER PETER SCHUMACHER

Commercial Industrial Residence
New Building Old Building Alterations Additional Repairs
Size of Service 200 A Size of Wire _____ Size of Conduit Single Phase Three Ph.
Number of Wires _____
Number of Meters _____

Heating - Oil Burner Gas Burner Electric Heat Elec. Water Heater Oil Fired Water Heater
No. of Circuits Appliance _____ Air Conditioner Washer Dish Water Pump Washer Auto Dryer

Other Electrical Installations _____ Total No. of Outlets _____
Remarks or other information INSTALL 200A SERVICE Total Cost \$ 3000.00
Specialties WASHER WASH AND DRYER HOOK UP Fee \$ 43.00

Contractor ANGEL RODRIGUEZ Address 208 IVEFIELD SD. City BOT CREEK Lic.# 104070
Signed: [Signature] Telephone No. _____ Type E 1
Approved Inspector [Signature]

TOWN OF SEYMOUR **M** **03552**

DATE: 5-7-2003

RECEIVED FROM: ANGEL RODRIGUEZ

RECEIVED BY: J.M.M.

OFFICE OF COMPLIANCE:

- Building Permit # _____ \$ _____
- Electrical Permit # 9405 \$ 43.00
- Heat, AC, Tank permit # _____ \$ _____
- Plumbing Permit # _____ \$ _____
- Other # _____ \$ _____

Check # 327

Cash _____

STATE OF CONNECTICUT
DEPARTMENT OF CONSUMER PROTECTION

ELECTRICAL UNLIMITED CONTRACTOR
ANGEL RODRIGUEZ
208 INFIELD ST
BRIDGEPORT, CT 06606
TYPE: EI

LIC./REG NO. 104070	EFFECTIVE 10/04/2000	EXPIRES 09/30/2003
SIGNED: <i>[Signature]</i>		

TOWN OF SEYMOUR
BUILDING DEPARTMENT
Field Inspection Report

Location of Property 11 Elm ST. Date 6-27-2001

Owner _____
Contractor Rzalewski.

Inspection Ordered Taken By J. M. M.
Building Plumbing Heating Electrical

Description of Inspection Feetruks for Deck
Around pool

Approved Disapproved Violation
Analysis

[Signature]

Date 6-27-2001 Inspector John Mikes

Building..... Date 6-25-51
 Plumbing.....
 Heating.....
 Electric.....
 Fixtures.....
 Affidavit.....
 Eng. Dept.....
 Health Dept.....
 Approved.....
APPLICATION FOR BUILDING PERMIT
REC# 8-01957
 Estimated Cost \$ 2000
 Fee . . . \$ 35.00
 No. 8830
 Occupancy Fee \$
 Additional Cost \$
check # 2356

TO THE BUILDING DEPARTMENT, TOWN OF SEYMOUR, CONN.
 The undersigned, hereby applies for a permit to do work according to the following specifications:

No. 11 Elm St. Lot No. _____ Side of Street _____ Zone _____
 Nearest cross street _____
 Owner of building Bob Shumishoff Address 11 Elm St.
 Builder Bob Zaleniski Address 16 Union St.
 Architect _____ Address _____

Size Main Bldg.: No. ft. front overall _____ No. ft. deep overall _____ Area _____
 Size of wings _____ Garages _____ No. of families _____ No. of stories _____
 Construction _____ No. of rooms: 1st _____ 2nd _____ 3rd _____
 Size of Lot _____ Dist. from Street Line _____ Dist. from Side Line Street _____
 Purpose of building is 10 x 12 Deck around Pool.
as per school drawings.

Sewer Septic Tank

t. from lot line E. _____, W. _____, S. _____, N. _____, Dist. nearest bldg. _____
 Height of stories—cellar _____ 1st _____ 2nd _____ 3rd _____ 4th _____ 5th _____
 Ind. depth below grade _____ Above grade _____ Mat. footing _____ Size footing _____
 t. for found. _____ Found. thickness _____ Mat. for sidewalls _____
 if _____ Outside studs _____ Dist. centers _____ Size sill _____ Ledges and girts _____
 Size of plate _____ Size hips and valleys _____ No. of rows _____ Size of pier foundation _____
 Ra. _____ Dist. apart _____ No. of same—1st _____ 2nd _____ 3rd _____
 Check walls, if any _____
 Any front, rear, side or partition walls are supported on steel girders: 1st _____ 2nd _____
 Sizes of lumber—Floor joists _____ Studs _____ Rafters _____ R. Fl. _____ Fin. Fl. _____
 Floor joists, size: 1st _____ 2nd _____ 3rd _____ stories. Dist. on center _____
 Largest span of floor joist: 1st _____ 2nd _____ 3rd _____ If not wood joist const. what type of floor? _____
 Size of studs carrying partitions _____ Size of Roof Rafters _____ Longest span _____ on center _____
 How many? _____ Where does tile start? _____
 Oil burners, Permit No. _____ Fixtures, Permit No. _____
 Electrical, Permit No. _____

I hereby agree to conform to all the requirements of the Laws of the State of Connecticut and the Ordinances of the Town of Seymour, and to notify the Building Inspector of any alteration in the plans or specifications of the Building for which this permit is asked. And agree that this building is to be located the proper distance from all street lines, side yard lines and require lines from all other zones and is located in a zone in which this building and its use is allowed.

hereby apply for a Certificate of Occupancy for _____ described in the above application for permit.
 Signed [Signature]

TOWN OF SEYMOUR

B 01952

DATE: 6-25-2001

RECEIVED FROM: R & R Construction.

RECEIVED BY: J.M.M.

OFFICE OF COMPLIANCE:

Building Permit	# <u>8830</u>	\$ <u>35.00</u>
Electrical Permit	# _____	\$ _____
Heat, AC, Tank permit	# _____	\$ _____
Plumbing Permit	# _____	\$ _____
Other	# _____	\$ _____

Check# 2356

Cash _____



165 CAPITOL AVE • HARTFORD CT 06106-1630
Be it known that

ROBERT E ZALENSKI JR
16 UNION ST
SHELTON, CT 06484

Is certified by the Department of Consumer Protection as a registered

HOME IMPROVEMENT CONTRACTOR

DBA: R & R CONSTRUCTION
Registration Number: 545835
Effective Date: 12/07/2000
Expiration Date: 11/30/2001

James T. Fleming
James T. Fleming, Commissioner

Pete o Cindy Shomcher.
11 Elm St.

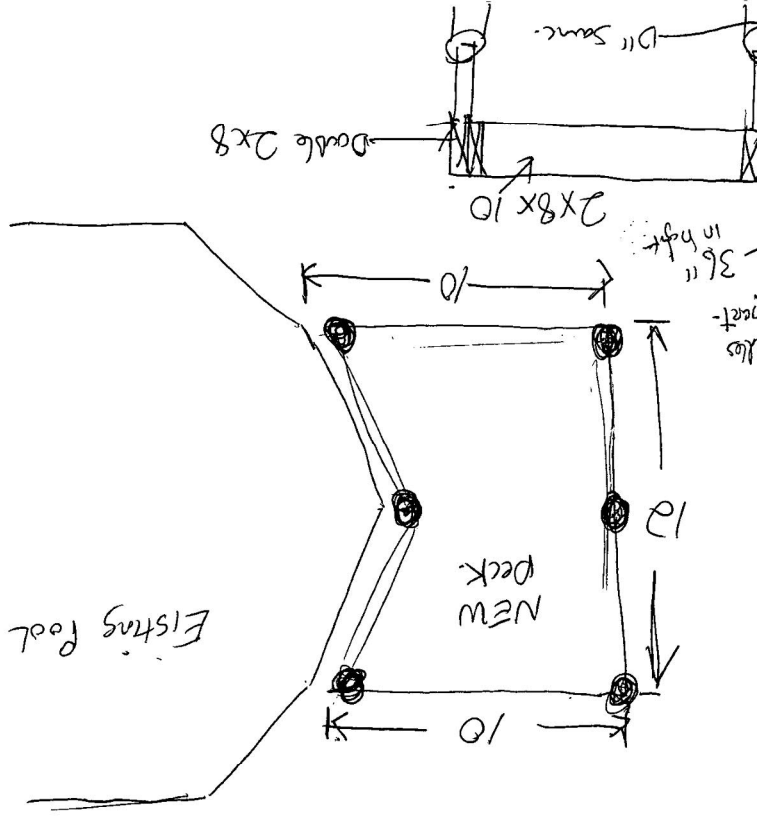

Re: Building Department
1999 TIDBITS

GUARDRAILS - 315.3 CABO (1995)

- Porches, balconies, or raised floor surfaces located more than 30" above the floor or grade shall have guardrails not less than 36" in height.
- Open sides of stairs with a total rise of more than 30" above floor or grade shall have guardrails not less than 34". 315.4--- Guardrails not to allow passage of an object 4" or more in diameter.

OPEN DECK

Please provide a deck framing plan showing the size of the deck, joist location, girder and footing locations etc. also an elevation view drawing.

Girder size :	3 - 2 x 8	span 7 feet
	3 - 2 x 10	span 8 feet
	3 - 2 x 12	span 9 feet

- Use decay resistant materials.
- Built-up girder splices must be over a post.
- Footings of minimum 42" below grade 12" diameter.
- Posts 4 x 4 maximum height 5 feet - taller use 4 x 6 posts.
- Angle brace posts.
- Two foot cantilever maximum.
- Bolt deck to house minimum two each end and one every 2nd bay staggered.
- Nail in all holes of joist hangers.
- Use full size hangers for required joists.
- Flashing is required under siding and over ledger.
- Stair stringers shall have concrete slab or blocks under stair stringers at grade.
- Treads minimum 9" with open riser and 10-1/4" closed riser to include nosing.
- Rise - ~~Riser~~ minimum 4" maximum 6- 1/4" all must be equal.
- Guard rails 36" minimum height.
- Pickets maximum 4" between.
- Grasping Handrails 2 - 1/4" cross sectional diameter. Maximum of 38" high.
- Block or use hangers on the inside of the box at the guardrail post connection.

Date 6/13/07 19.....

APPLICATION FOR SWIMMING POOL PERMIT

REC # B-01936

No. 8814

Estimated Cost \$ 3800
Fee . . . \$ 50

check # 1726

TO THE BUILDING DEPARTMENT, TOWN OF SEYMOUR, CONN.

The undersigned, hereby applies for a permit to do work according to the following specifications. All provisions of the Building Ordinances shall be complied with in the installation of this work whether specified herein or not.

Location 11 ELMA STREET Lot No. Side of Street Zone R-18
Owner Peter & Cynthia Schumacher Address 11 ELMA STREET
Pool Contractor Keslie's Pool Address
Electrical Contractor Address

Make of Pool Cambria Model ABOVE GROUND Size 24' RA X 52"
Type of Construction ACRYL & ~~CONCRETE~~ VINYL Capacity (Gallons) 13,175 Maximum Depth 4
Type of Deck No. of Ladders 1 Diving Board Yes No
Voltage Does pool have; Submerged lighting fixtures. (See other side of card)

Indicate Location of Pool, Filter and Accessories — Specify Distances to at Least Two Corners of Building and Filter.

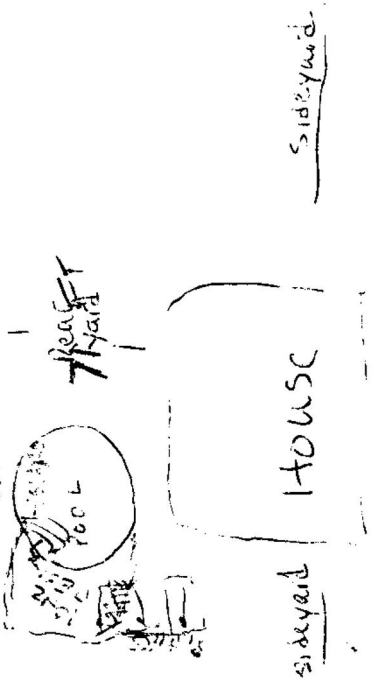

Pool Contractor
Address
Signed
State License No. Type

(Fence must be installed around pool.) All electrical wiring to be done by a licensed electrical contractor. Do not back fill pool or install deck until electrical installation and grounding has been inspected.

TOWN OF SEYMOUR

B 01936

DATE: 6/13/01

RECEIVED FROM: C. Schumacher

RECEIVED BY: JAR

OFFICE OF COMPLIANCE:

Building Permit	# <u>8814</u>	\$ <u>50</u>
Electrical Permit	# _____	\$ _____
Heat, AC, Tank permit	# _____	\$ _____
Plumbing Permit	# _____	\$ _____
Other	# _____	\$ _____

Check 1726

Cash _____

Name of Applicant: Celia & Cynthia Schumacher Phone No. 888-4112

Address: 11 Elm St

DESCRIPTION OF WORK

24' Deck Above Ground Pool
10' x 12' Deck

PLOT PLAN AND SURVEY

1. Attach plot plan prepared from available data showing all proposed substantial improvements at a scale of not more than 60 ft to one inch.
2. As Built A-2 Survey Not Required
 Required before Certificate of Occupancy is authorized. Survey to show all substantial improvements. Surveys showing only the building or the foundation will not be accepted.

EROSION CONTROL

Not Required Required - Show on plot plan

APPROVALS

1. Zoning Permit Approved, Building Permit Authorized.

Arthur Baldwin ZEO 6-12-01 Date

Completion Certificate

Based on a review of the As Built survey and/or field inspection, this project is found to be in compliance with the zoning regulations and a certificate of occupancy is authorized.

ZEO _____ DATE _____

BUILDING PERMIT # _____ DATE 6-12-01 STREET/AVENUE _____
 LOCATION N S SIDE 11 Elm St
 HOUSE NUMBER _____ LOT NUMBER _____ REC. VOL. _____ PAGE _____
 OWNER OF LAND Peter & Cynthia Schumacher
 INTERIOR or CORNER LOT ZONE R-1.8

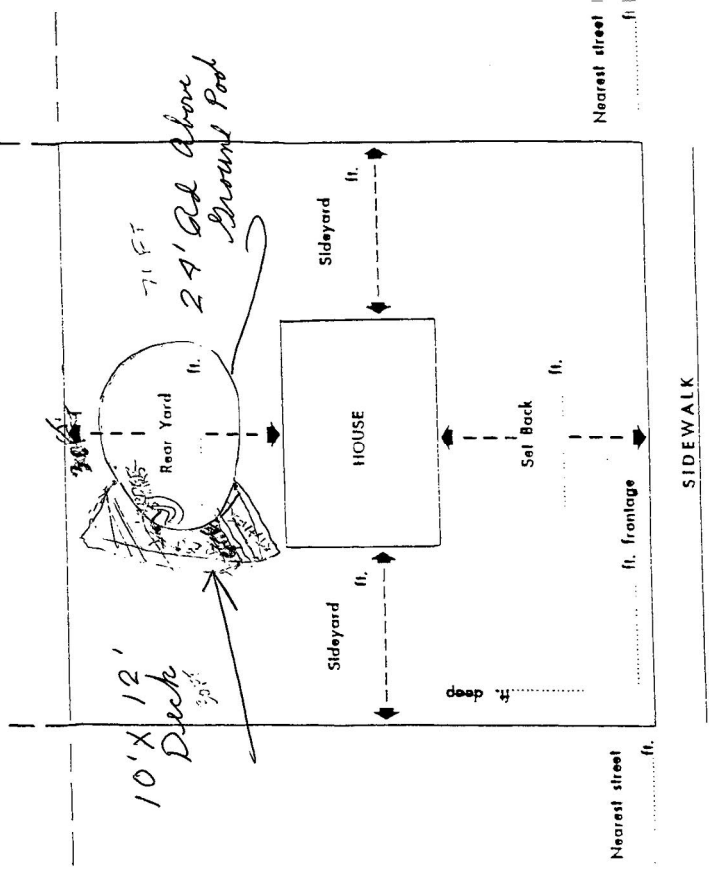

Application For Building Permit: Departmental Approvals

1. Applicant's Name, Address & Phone Number
Peter & Cynthia Schumacher
11 Elm Street
Seymour, CT 06483 868-4112
2. Property Address or Location
11 Elm Street
Seymour, CT 06483
3. Building Use
Pool
4. Fire Marshal Approval
 Note: The Fire Marshal's Office must have stamped plans submitted for review for any building other than one & two family dwellings thirty (30) days before a permit is expected to be issued.
 a) Based on review of the plans submitted, the project was found to be in compliance with the Connecticut Fire Safety Code
 Date: _____ Fire Marshal _____
 b) Based on review of the plans submitted, the project was found to be in substantial compliance with the Connecticut Fire Safety Code and the deficiencies attached will be corrected prior to the project's completion.
 Date: _____ Fire Marshal _____
5. Inland Wetlands Approval (Signature required for either A or B)
 a) Based on a review of the Inland Wetlands Map, record subdivision plan, site plan or other data, the project does not involve a regulated activity. _____
 b) Project approved by Inland Wetlands Commission on _____
 Date: _____ Agent for Wetlands _____
6. Zoning Approval
 A. As built A-2 Survey submitted: _____
 As built A-2 Survey not required: _____
 B. Zoning Board of Appeals
 _____ ZBA approval not required. Project meets all zoning requirements.
 _____ Variances approved by ZBA at meeting of _____

C. Planning and Zoning Commission

Use allowed by administrative approval. Zoning permit is attached.
Site plan and/or special permit approved by P. & Z. Commission on _____
Date: _____ ZEO or Town Planner _____

7. Sanitary Sewers (Signature required for either A or B)

A. Building to be served by municipal sanitary sewers.
Connection municipal system is authorized. Sewer assessment and/or
impact fee for this property is \$ _____

Fees/assessment has been paid: _____

Fees/assessment has not been paid. _____

All fees must be paid before a Certificate of Occupancy is issued.

Date: _____ SWPCA _____

B. Building to be served by on site system.
Location and design of septic system have been approved by the Naugatuck Valley
Health District.

Date: _____ NVHD _____

8. Naugatuck Valley Health District. (Food Service or Day-Care)

The plans submitted are in conformance with the applicable health regulations.

Date: _____ NVHD _____

9. Public Works

All work has been completed

A. A driveway permit for the above property has been issued. _____

B. A road opening permit for the above property has been issued. _____

A road opening permit for this property is not required. _____

Date: _____ Public Works _____

10 Tax Collector # 3050

There are no delinquent taxes due on the above property.

Date: 6-13-01 Tax Collector: Robert J. Anderson

DATE: _____

TO: Pete Schumacher
11 Elm St
Seymour, CT 06483

FROM: PARADIS CONSTRUCTION, INC. CT LIC # 530013
33 WAYNE DRIVE
PLAINVILLE, CT 06062
860-747-0585

TO THE TOWN OF Seymour BUILDING DEPARTMENT.

WE, PARADIS CONSTRUCTION, INC. GIVE PERMISSION TO
THE PERSON(S) LISTED ABOVE THE USE OF OUR CONTRACTOR'S
LICENSE # IN ORDER TO FULLY ANY NEEDED PERMITS FOR THE
INSTALLATION OF AN ABOVE GROUND SWIMMING POOL AT THE
ADDRESS LISTED ABOVE.

SINCERELY,

VICTOR PARADIS (LICENSEE DESIGNEE)
PARADIS CONSTRUCTION, INC.



STATE OF CONNECTICUT
 DEPARTMENT OF CONSUMER PROTECTION
 165 CAPITOL AVE • HARTFORD CT 06106-1630
 Be it known that

PARADIS CONSTRUCTION INC
 33 WAYNE DRIVE
 PLAINVILLE, CT 06062

Is certified by the Department of Consumer Protection as a registered
HOME IMPROVEMENT CONTRACTOR

Contractor of Record: VICTOR PARADIS
 Registration Number: 530013
 Effective Date: 12/01/2000
 Expiration Date: 11/30/2001

James Fleming
 James Fleming, Commissioner

Date 7/27 19__

APPLICATION FOR BUILDING PERMIT

Estimated Cost \$ 319
 Fee \$ 10.0
 Occupancy Fee \$
 Additional Cost \$ 10.0

No. 1986

ding _____
 nbing _____
 ting _____
 tric _____
 ures _____
 davit _____
 r. Dept. _____
 ith Dept. _____
 roved _____

THE BUILDING DEPARTMENT, TOWN OF SEYMOUR, CONN.
 undersigned, hereby applies for a permit to do work according to the following specifications:

11 ELM ST. Lot No. 135 Side of Street _____ Zone K

rest cross street _____
 ner of building BRUCE BLANCHARD Address 11 ELM ST.
 ider HENDON POOLS Address 90X BOSTON ROAD
 hitect HENDON POOLS Address _____ MILFOR

Main Bldg.: No. ft. front overall _____ No. ft. deep overall _____ Area _____
 ; of wings _____ Garages _____ No. of families _____ No. of stories _____
 struction _____ No. of rooms: 1st _____ 2nd _____ 3rd _____

se of Lot _____ Dist. from Street Line _____ Dist. from Side Line Street _____
 pose of building is Swim in 16x24 above ground pool

Sewer Septic Tank

East from lot line E....., W....., S....., N....., Dist. nearest bldg.....
 eight of stories—cellar..... 1st..... 2nd..... 3rd..... 4th..... 5th.....
 ound, depth below grade..... Above grade..... Mat. footing..... Size footing.....
 at. for found. Found. thickness..... Mat. for sidewalls.....
 oof..... Outside studs..... Dist. centers..... Size sill..... Ledges and girts.....
 ze of plate..... Size hips and valleys..... No. of stairways..... Beams.....
 ers..... Dist. apart..... No. of rows..... Size of pier foundation.....
 rick walls, if any..... Size of same—1st..... 2nd..... 3rd.....
 any front, rear, side or partition walls are supported on steel give sizes: 1st..... 2nd.....
 ecies of lumber—Floor joists..... Studs..... Rafters..... R. Fl..... Fin. Fl.....
 oor joists, size: 1st..... 2nd..... 3rd..... stories. Dist. on center.....
 ngest span of floor joist: 1st..... 2nd..... 3rd..... If not wood joist const. what type of floor?.....
 ze of studs carrying partitions..... Size of Roof Rafters..... Longest span..... on center.....
 imneys, size of flues..... How many?..... Where does tile start?.....
 umbing contractor, Permit No..... Oil burners, Permit No..... Fixtures, Permit No.....
 ating contractor, Permit No..... Electrical, Permit No.....

I hereby agree to conform to all the requirements of the Laws of the State of Connecticut and the Ordinances of the Town of _____, and to notify the Building Inspector of any alteration in the plans or specifications of the Building for which permit is asked. And agree that this building is to be located the proper distance from all street lines, side yard lines and rear yard lines from all other zones and is located in a zone in which this building and its use is allowed.

..... hereby apply for a Certificate of Occupancy for

..... described in the above application for permit.

Signed