



## Property Information

## Request Information

## Update Information

File#:	BF-X01651-4769292152	Requested Date:	05/23/2024	Update Requested:
Owner:	GARY GLEE SR	Branch:		Requested By:
Address 1:	568 SW ALABAMA TRL	Date Completed:		Update Completed:
Address 2:		# of Jurisdiction(s):		
City, State Zip:	GREENVILLE, FL	# of Parcel(s):	1	

## Notes

**CODE VIOLATIONS** Per Madison County Department of Zoning there are no Code Violation cases on this property.  
Collector: Madison County Code Enforcement  
Payable: 229 Pinckney St # 219, Madison, FL 32340  
Business# (860) 973-3641

**PERMITS** Per Madison County Building Department there are no Open/Pending/ Expired Permit on this property.  
Collector: Madison County Building Department  
Payable: 229 Pinckney St # 219, Madison, FL 32340  
Business# (860) 973-6785

**SPECIAL ASSESSMENTS** Per Madison County Tax Collector there are no Special Assessments/liens on the property.  
Collector: Madison County Tax Collector  
Payable: 229 SW Pinckney St, Madison, FL 32340  
Business# (860) 973-6136

UNABLE TO PROVIDE DOCUMENTATION TO THIRD PARTIES. VERBAL INFO ACQUIRED

**DEMOLITION** NO

**UTILITIES** Water & Sewer  
The house is on a community water and sewer. All houses go to the shared well and septic system.  
Garbage:  
GARBAGE PRIVATE HAULER WITH LIEN STATUS AND BALANCE UNKNOWN.

# Madison County, FL

## Hurricane Damage Form

Hurricane Damage Form

## Homestead Application

Apply for Homestead Exemption

## 2023 TRIM Notices

[2023 TRIM Notice \(PDF\)](#)

## Parcel Summary

**Parcel ID** 21-1N-08-2850-001-000  
**Location** 568 SW ALABAMA TRL  
**Address** GREENVILLE 32331  
**Brief Tax** BEG 504' S OF SW COR, RUN NE 2219' THEN NW 155' TO POB, CONT NW'LY  
**Description** 210' NE 210' SE 210' SW 210' TO POB, BEING PART OF SW1/4, OR BK 135 PG  
 772  
 (Note: Not to be used on legal documents.)  
**Property Use Code** SINGLE FAMILY (0100)  
**Sec/Twp/Rng** 21-1N-08  
**Tax District** COUNTY (10)  
**Millage Rate** 15.2453  
**Acreage** 1  
**Homestead** Y

[View Map](#)



## Owner Information

**Primary Owner**  
[GLEE GARY](#)  
 GLEE ELVIRA  
 568 SW ALABAMA TRL  
 GREENVILLE, FL 32331

## Address Change

Mailing Address Change

## Map



### Valuation

**Working Values are Subject to Change**

	2024 Working Values	2023 Certified Values	2022 Certified Values	2021 Certified Values
Building Value	\$101,938	\$101,335	\$81,070	\$59,022
Extra Features Value	\$1,053	\$1,053	\$1,053	\$974
Land Value	\$8,800	\$8,000	\$6,200	\$3,800
Land Agricultural Value	\$0	\$0	\$0	\$0
Agricultural (Market) Value	\$0	\$0	\$0	\$0
Just (Market) Value	<b>\$111,791</b>	<b>\$110,388</b>	<b>\$88,323</b>	<b>\$63,796</b>
Assessed Value	\$65,146	\$63,249	\$61,407	\$59,618
Exempt Value	\$40,146	\$38,249	\$36,407	\$34,618
Taxable Value	\$25,000	\$25,000	\$25,000	\$25,000
Maximum Save Our Homes Portability	(\$46,645)	\$47,139	\$26,916	\$4,178

### Land Information

Land Use	Number of Units	Unit Type	Price/Unit	Frontage
0100 - SINGLE FAM	1	AC	\$8,800	0

### Building Information

Type	SINGLE FAM	Heat	F AIR-DUCT
Total Area	2,972	Air Conditioning	CENTRAL
Heated Area	2,360	Bathrooms	2
Exterior Walls	BRICK	Bedrooms	0
Roof Cover	COMP SHNGL	Stories	1
Interior Walls	PLYWOOD	Actual Year Built	1940
Frame Type		Effective Year Built	1940
Floor Cover	VINYL TILE; CARPET	Value	\$101,938

### Extra Features

Code	Description	Length x Width	Area	Year Built
1661	FIREPL-B	0 x 0 x	1	1940
1806	WELL/SEPTIC	0 x 0 x	1	1971

### Sales

Multi Parcel	Sale Date	Sale Price	Instrument	Book/Page	Instrument Number	Qualification	Reason	Vacant/Improved	Grantor	Grantee
N	8/1/1982	\$10	WD	<a href="#">135/772</a>		Unqualified	N/A	Vacant		

### Photos



### Sketches

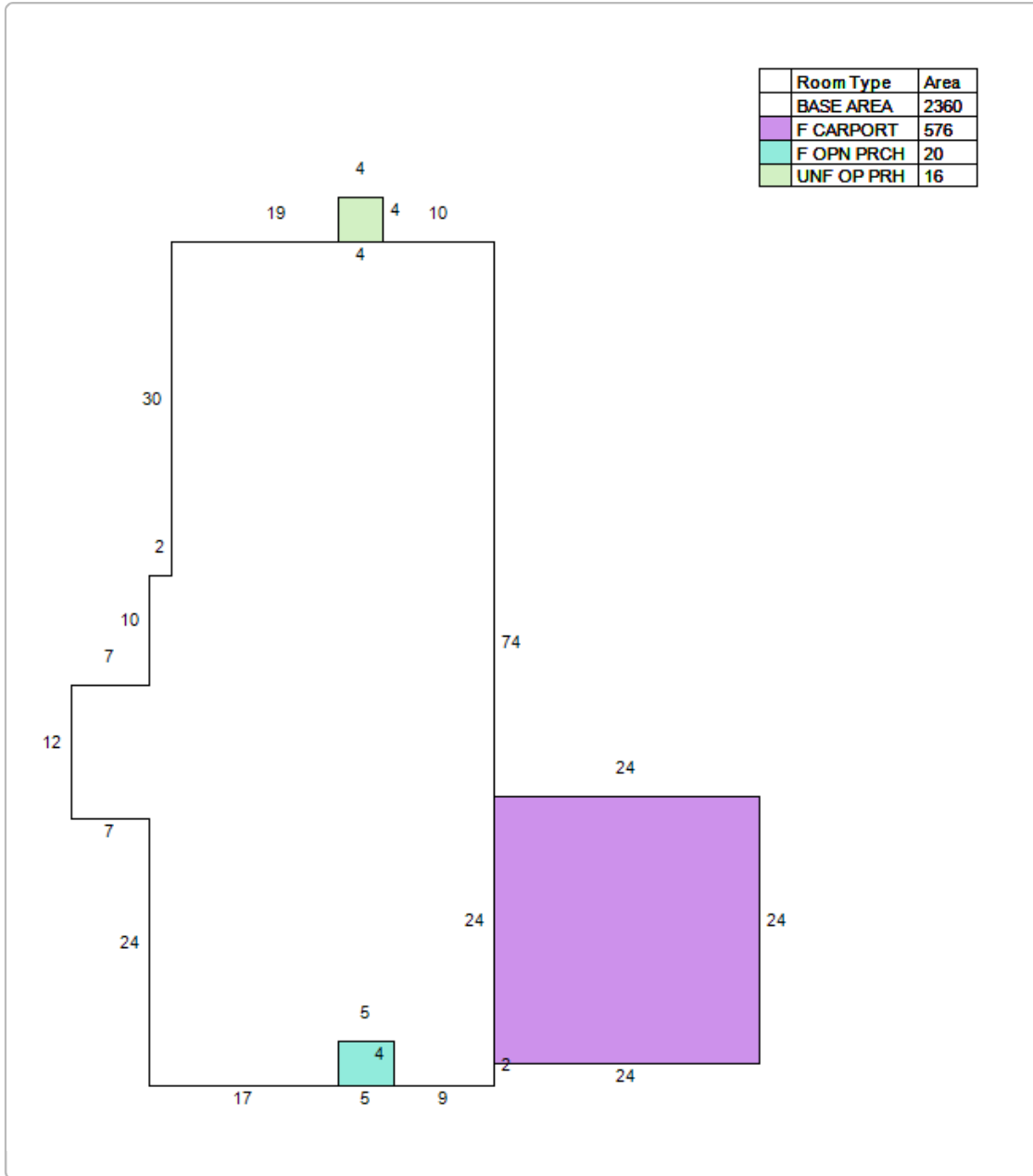

No data available for the following modules: Permits.

The information in this web site represents current data from a working file which is updated continuously. Information is believed reliable, but its accuracy cannot be guaranteed. No warranty, expressed or implied, is provided for the data herein, or its use.

[User Privacy Policy](#) | [GDPR Privacy Notice](#)  
 Last Data Upload: 23/05/2024, 07:00:06

Contact Us



# Board of County Commissioners Madison County, Florida



Madison County is an Equal Opportunity Employer

CODE ENFORCEMENT OFFICE  
Phone 850-973-3641 • Fax 850-973-6727  
code@madisoncountyfl.com  
www.madisoncountyfl.com

May 30, 2024

Madison County Code Enforcement Office does not have any open pending code violations on said properties:

Owner	Gary & Elvira Glee
Address:	568 SW Alabama Trl.
Legal Description:	21-1N-08-2850-001-000

Please note that this letter does not include information on liens that are put on the property. For lien research you need to contact the County Clerk of Court Recording Office (850) 973-1500.

Respectfully,

*GJR*  
Gloria J. Randall  
Gloria J. Randall

# Board of County Commissioners Madison County, Florida

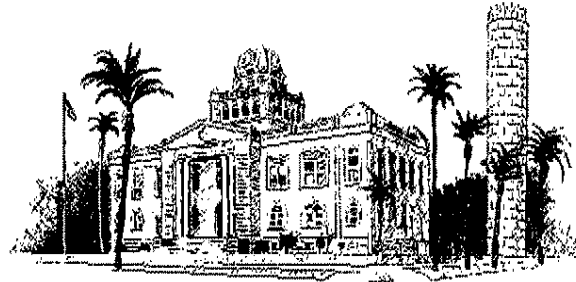

Madison County Is an Equal Opportunity Employer

**MADISON COUNTY BUILDING DEPARTMENT**  
Phone 850-973-6785 • Fax 850-973-6727  
bldgadmin@madisoncountyfl.com  
www.madisoncountyfl.com

To Whom it May Concern:

Madison County Florida does not have any opened or expired permit on this property.

Owner:	Gary Glee SR
Property:	568 SW Alabama Trail
Property Identification:	21-1N-08-2850-001-000

If you have any questions regarding this matter, please do not hesitate to contact me at (850)-973-6785.

Sincerely,

*Debra Green*<sup>76</sup>

Debra Green  
Madison County Building Department  
Administrative Assistant