



## Property Information      Request Information      Update Information

File#:	BS-X01661-3614754381	Requested Date:	06/04/2024	Update Requested:
Owner:	BELLO-SUERO CANDIDO	Branch:		Requested By:
Address 1:	2263 FOCHT AVE	Date Completed:		Update Completed:
Address 2:		# of Jurisdiction(s):		
City, State Zip:	ALLENTOWN, PA	# of Parcel(s):	1	

## Notes

**CODE VIOLATIONS**      Per South Whitehall Township Department of Zoning there are no Code Violation cases on this property.

Collector: South Whitehall Township  
 Payable Address: 4444 Walbert Avenue Allentown PA 18104  
 Business# 610-398-0401

**PERMITS**      Per South Whitehall Township Building Department there are no Open/Pending/ Expired Permit on this property.

Collector: South Whitehall Township  
 Payable Address: 4444 Walbert Avenue Allentown PA 18104  
 Business# 610-398-0401

**SPECIAL ASSESSMENTS**      Per South Whitehall Township Department of Finance there are no Special Assessments/liens on the property.

Collector: South Whitehall Township  
 Payable Address: 4444 Walbert Avenue Allentown PA 18104  
 Business# 610-398-0401

**DEMOLITION**      NO

**UTILITIES**      Water,Sewer & Trash  
 Account #: 103000  
 Payment Status: DELINQUENT  
 Status: Pvt & Liable  
 Amount: N/A  
 Good Thru: N/A  
 Account Active: Yes  
 Collector: South Whitehall Township  
 Payable Address: 4444 Walbert Avenue, Allentown, PA 18104  
 Business # 610-398-0407

UNABLE TO PROVIDE INFORMATION TO THIRD PARTIES. HOMEOWNERS AUTHORIZATION REQUIRED.

County of Lehigh Online Records Access  
Property Details

Street View



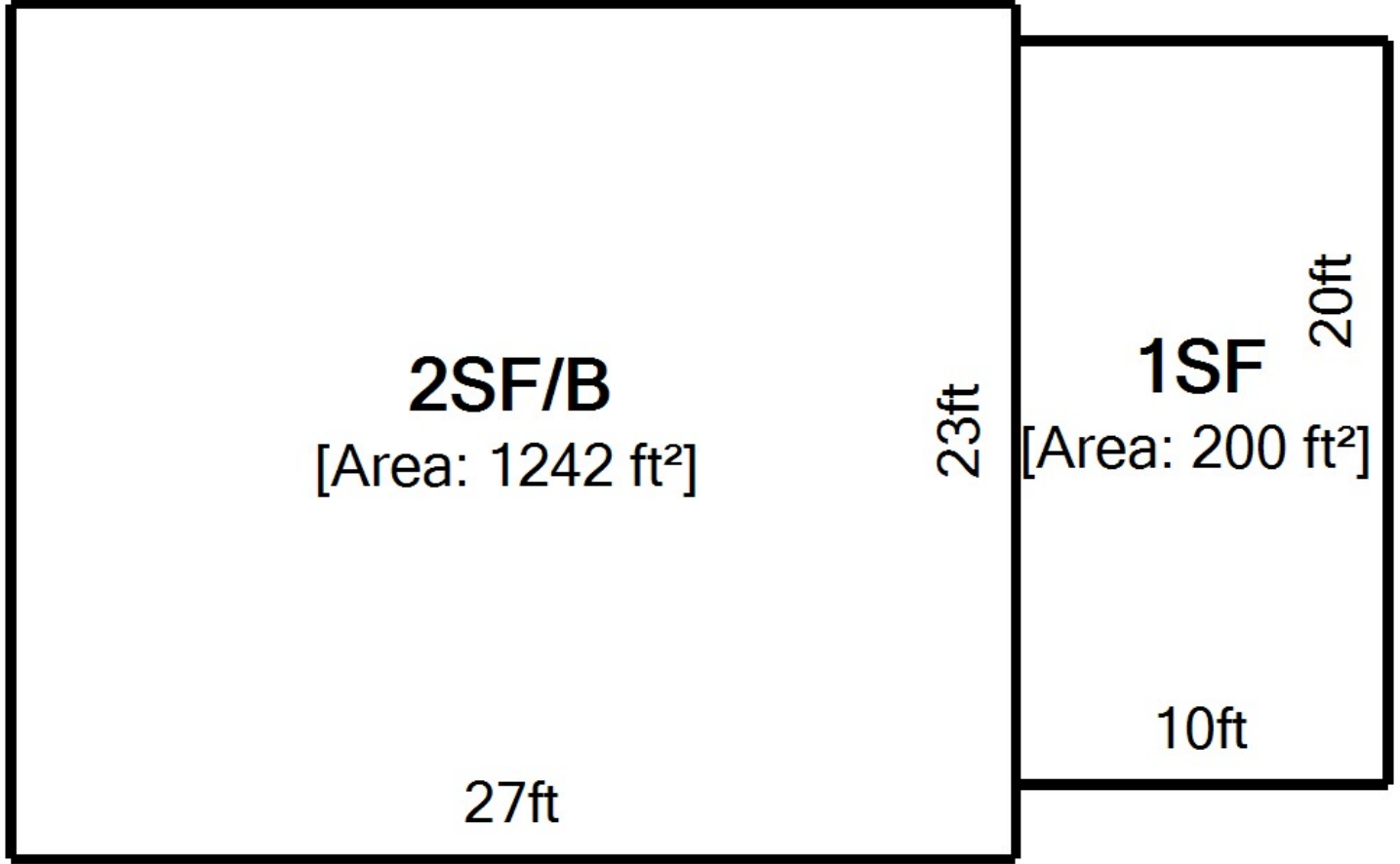

Property Overview

2024																
<b>Owner Name</b>	BELLO-SUERO CANDIDO & A C R JIMENEZ															
<b>Owner Address</b>	2263 FOCHT AVE ALLENTOWN PA 18104-1017															
<b>Property Address</b>	2263 FOCHT AVE ALLENTOWN PA 18104															
<b>Parcel Viewer</b>	<a href="#">View in Parcel Viewer</a>															
<b>Low Number</b>	2263															
<b>High Number</b>	2263															
<b>Tax Authority</b>	SOUTH WHITEHALL TOWNSHIP															
<b>School District</b>	PARKLAND SCHOOL DISTRICT															
<b>Parcel Id</b>	548778856929 1															
<b>Old Parcel Id</b>	19 G08NE2 011 016															
<b>Tile</b>	475804															
<b>Acres/Dimension</b>	50.8 X 154.13 IRREG															
<b>Lot Sq Ft</b>	6992															
<b>Utilities</b>	PUBLIC WATER/SEWER															
<b>Class</b>	RESIDENTIAL															
<b>Land Use</b>	SINGLE FAMILY - DETACHED															
<b>Living Units</b>	1															
<b>Zoning</b>	R-4															
<b>Homestead Act 72</b>	Application Approved and Enrolled - 11/15/2017															
<b>Preferential Land Act</b>	NO															
<b>Agricultural Easement</b>	NO															
<b>Assessment Base Year</b>	2013															
<b>Total Assessment</b>	<table border="1"> <tbody> <tr> <td>Exempt Land</td> <td>0</td> </tr> <tr> <td>Exempt Building</td> <td>0</td> </tr> <tr> <td>Taxable Land</td> <td>25,100</td> </tr> <tr> <td>Taxable Building</td> <td>109,800</td> </tr> <tr> <td>Total</td> <td>134,900</td> </tr> <tr> <td>Taxable Total</td> <td>134,900</td> </tr> </tbody> </table>	Exempt Land	0	Exempt Building	0	Taxable Land	25,100	Taxable Building	109,800	Total	134,900	Taxable Total	134,900			
Exempt Land	0															
Exempt Building	0															
Taxable Land	25,100															
Taxable Building	109,800															
Total	134,900															
Taxable Total	134,900															
<b>Estimated Taxes</b>	<table border="1"> <thead> <tr> <th></th> <th>Mills</th> <th>Estimated Taxes</th> </tr> </thead> <tbody> <tr> <td>County</td> <td>3.780000</td> <td>\$ 509.92</td> </tr> <tr> <td>School</td> <td>16.400000</td> <td>\$ 2,212.36</td> </tr> <tr> <td>Municipality</td> <td>3.319750</td> <td>\$ 447.83</td> </tr> <tr> <td>Total</td> <td></td> <td>\$ 3,170.11</td> </tr> </tbody> </table> <p>Tax calculations do not reflect any reduction received due to enrollment in Homestead Act 72</p>		Mills	Estimated Taxes	County	3.780000	\$ 509.92	School	16.400000	\$ 2,212.36	Municipality	3.319750	\$ 447.83	Total		\$ 3,170.11
	Mills	Estimated Taxes														
County	3.780000	\$ 509.92														
School	16.400000	\$ 2,212.36														
Municipality	3.319750	\$ 447.83														
Total		\$ 3,170.11														
<b>Bill Number</b>	1900508															
<b>LC_PropertyAddress</b>	2263 FOCHT AVE ALLENTOWN PA 18104															

Basic Residential Profile

<b>Type of Residence</b>	SINGLE FAMILY - DETACHED
<b>Number of Stories</b>	2 STORY

<b>Type of Construction</b>	FRAME
<b>Type of Basement</b>	FULL
<b>Type of Heating/Cooling</b>	BASE
<b>Type of Garage</b>	NONE
<b>Number of Full Bathrooms</b>	1
<b>Number of Half Bathrooms</b>	0
<b>Fireplaces</b>	0
<b>Square Feet</b>	1442
<b>Year Built</b>	1940
<b>Pool</b>	NO POOL
<b>Implement Buildings</b>	NO IMPLEMENT BLDG

#### Residential Profile Data With No Influence on Assessment Value

<b>Total Rooms</b>	6
<b>Number of Bedrooms</b>	3
<b>Family Rooms</b>	0

#### Sales History

Sale Date	Owner Name	Document Id	Sale Price
10/2017	BELLO-SUERO CANDIDO & A C R JIMENEZ	2017031954	\$ 152,000
10/2014	JACOBS WILLIAM D	2014029404	\$ 1
12/1978	JACOBS WILLIAM D & AGNES A	1259/0385	\$ 46,000

The building sketch represents the actual exterior measurement of the structure as measured from the outside. The sketch will show any attached areas and will be labeled with a descriptive code. Measurements are rounded to the nearest foot. Certain sketch dimensions and angles are drawn in approximation to their actual measurements.

The total square-foot area includes only the assessed living area of a residential structure, generally areas that are heated and/or cooled. Living area does not include porches, decks, patios, or garages.

Some of the common abbreviations are listed below for reference:

BUILDING STYLE	
CODE	DESCRIPTION
1S	1 STORY
1.5S	1½ STORY
2S	2 STORY
2.5S	2½ STORY
3S	3 STORY
3.5S	3½ STORY
B-L	BI-LEVEL
S-L	SPLIT-LEVEL

EXTERIOR	
CODE	DESCRIPTION
AV, A, V	ALUMINUM OR VINYL
B	BRICK
B&F	BRICK & FRAME
BFR	BRICK FRONT
BTR	BRICK TRIM
C	CONCRETE
CB	CONCRETE BLOCK
F, FR	FRAME
ST	STONE
SD	STUCCO OR DRYVIT
MTL	METAL
GL	GLASS

CODE	DESCRIPTION	CODE	DESCRIPTION
A	ATTIC	IGP	INGROUND POOL
BAL	BALCONY	LD	LOADING DOCK
B	BASEMENT	MP	MASONRY PATIO
BAY	BAY	MS	MASONRY SLAB
BSG	BASEMENT GARAGE	NB	NO BASEMENT
BW	BREEZEWAY	NA	NOT ADDED
BLT	BUILT	NI	NOT INCLUDED
CP	CARPORT	OFF	OPEN FRAME PORCH
CPY	CANOPY	OMP	OPEN MASONRY PORCH
CC	CATHEDRAL CEILING	OH	OVERHANG
CRLS	CRAWL SPACE	PB	PART BASEMENT
DECK	DECK	PW	PARTY WALL
EFP	ENCLOSED FRAME PORCH	RECRM	RECREATION ROOM
EMP	ENCLOSED MASONRY PORCH	S	SHED
FB	FINISHED BASEMENT	SQFT	SQUARE FOOT
FDN	FOUNDATION	STRG	STORAGE
G	GARAGE	UFB	UNFINISHED BASEMENT
GH	GREENHOUSE	WD	DECK

EXAMPLE SKETCH

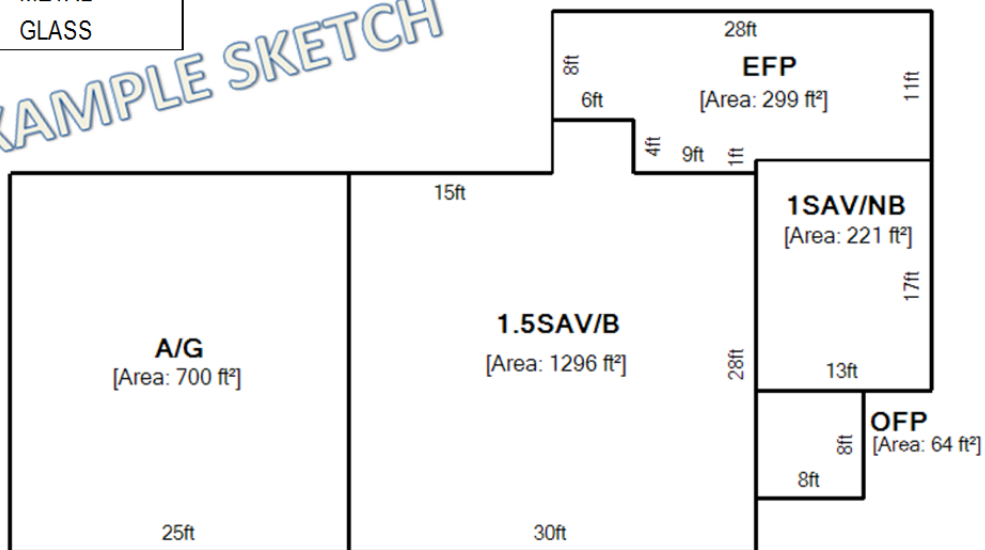

Information on this site is used for tax assessment purposes only and is subject to change without prior notice. The County of Lehigh Assessment Office assumes no responsibility for the use of the information for any other purpose. The use of information for any other purpose other than for tax assessment purposes is the sole and exclusive responsibility of the individual or entity using the information.

**FW: Right to Know - RTK 2024-57 - 2263 Focht Avenue**

Tue 11/06/2024 04:43

2263 FOCHT AVENUE

---

**From:** Lynette Romig <RomigL@southwhitehall.com>**Sent:** Friday, June 7, 2024 7:40 PM**Cc:** Tracy J. Fehnel <fehnel@southwhitehall.com>; Tom Petrucci <petruccit@southwhitehall.com>; David Manhardt <manhardtd@southwhitehall.com>; Tricia Dickert <dickertt@southwhitehall.com>; Tom Harper <harpert@southwhitehall.com>**Subject:** Right to Know - RTK 2024-57 - 2263 Focht Avenue**Importance:** High

Some people who received this message don't often get email from [romigl@southwhitehall.com](mailto:romigl@southwhitehall.com). [Learn why this is important](#)

**CAUTION:** This email originated from outside of the organization. Do not click links or open attachments unless you recognize the sender and know the content is safe.

Good morning,

This email is in response to the right to know you submitted for the above referenced address. You requested:

1. Any open/pending/expired permits and demolition permits that need attention and any fees due currently – **There are no open/pending or expired permits.**
2. Any open code violation or fines due that need attention currently – **None found**
3. Any unrecorded liens/fines/special assessment fees due. – **None found**

After reviewing the active and archived files, this was the information discovered by our staff in relation to your request. If you have any questions, please let us know.

This request is now considered closed.

Sincerely,

*Lynette Romig*

Open Records Coordinator  
South Whitehall Township  
4444 Walbert Avenue  
Allentown PA 18104  
610-398-0401 (office) ext.241  
[www.southwhitehall.com](http://www.southwhitehall.com)



This email message, including any attachments, is intended for the sole use of the individual(s) and entity(ies) to which it is addressed, and may contain information that is privileged, confidential and exempt from disclosure under applicable law. If you are not the intended addressee, nor authorized to receive for the intended addressee, you are hereby notified that you may not use, copy, disclose or distribute to anyone this email message including any attachments, or any information contained in this email message. If you have received this email message in error, please immediately notify the sender by reply email and delete the message. Thank you.



DISCLAIMER: The information contained in this message is proprietary and/or confidential and may be privileged. If you are not the intended recipient of this communication, you are hereby notified to: (i) delete the message and all copies; (ii) do not disclose, distribute or use the message in any manner; and (iii) notify the sender immediately. (iv) The recipient should check this email and any attachments for the presence of malware. The company accepts no liability for any damage caused by any Malware transmitted by this email.