



Property Information Request Information Update Information

File#:	BS-X01661-8124717158	Requested Date:	06/04/2024	Update Requested:
Owner:	BROGLE JOHN & SHARI	Branch:		Requested By:
Address 1:	4075 HUCKLEBERRY DR	Date Completed:		Update Completed:
Address 2:		# of Jurisdiction(s):		
City, State Zip:	CENTER VALLEY, PA	# of Parcel(s):	1	

Notes

CODE VIOLATIONS Per Upper Saucon Township Department of Zoning there are no Code Violation cases on this property.

Collector: Upper Saucon Township Zoning Department
Payable: 5500 Camp Meeting Road, Center Valley, PA 18034
Business# 610-282-1171

PERMITS Per Upper Saucon Township Building Department there are no Open/Pending/ Expired Permit on this property.

Collector: Upper Saucon Township Building Department
Payable: 5500 Camp Meeting Road, Center Valley, PA 18034
Business# 610-282-1171

SPECIAL ASSESSMENTS Per Upper Saucon Township Finance Department there are no Special Assessments/liens on the property.

Collector: Upper Saucon Township Finance Department
Payable: 5500 Camp Meeting Road, Center Valley, PA 18034
Business# 610-282-1171

DEMOLITION NO

UTILITIES WATER & SEWER

Account #: N/A
Payment Status: PAID
Status: Pvt & Lienable
Amount: \$0.00
Good Thru: N/A
Account Active: Active
Collector: Upper Saucon Township Utility Billing
Payable: 5500 Camp Meeting Road, Center Valley, PA 18034
Business# 610-282-1171 EXT 1229

UNABLE TO PROVIDE DOCUMENTATION TO THIRD PARTIES. VERBAL INFO ACQUIRED

GARBAGE:
GARBAGE PRIVATE HAULER WITH LIEN STATUS AND BALANCE UNKNOWN.

County of Lehigh Online Records Access
Property Details

Street View



Footprint

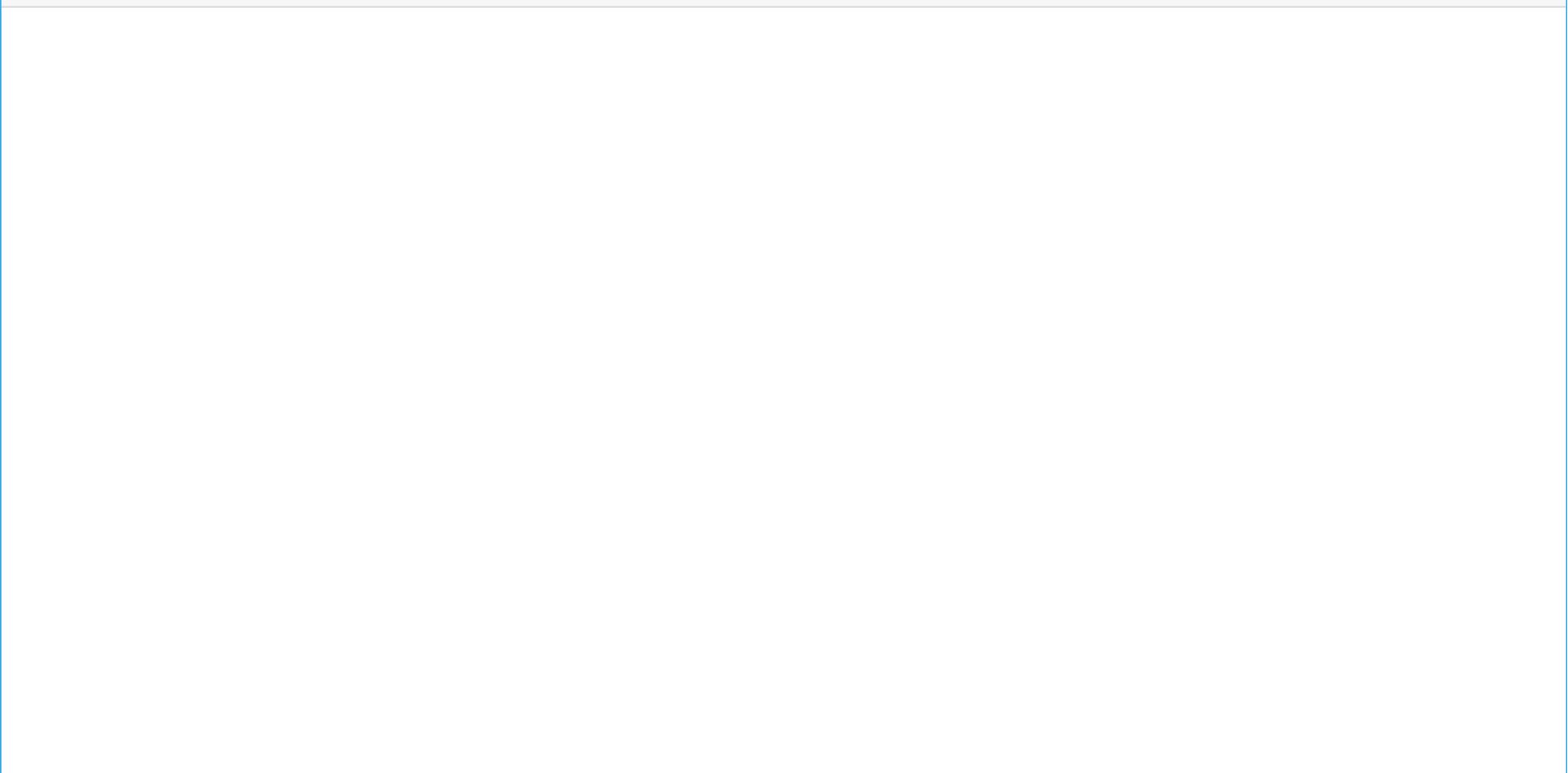

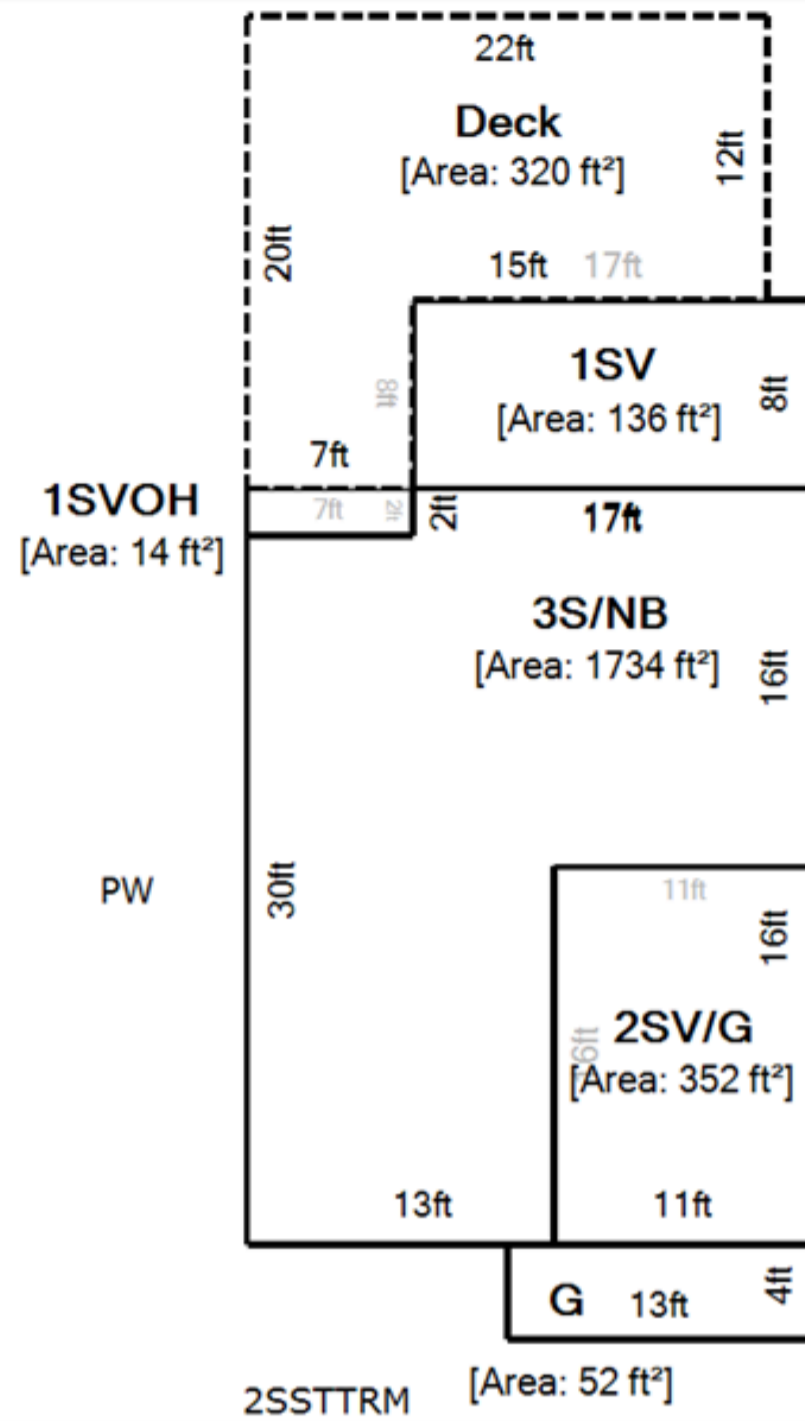

[? Sketch Codes](#)

Options

[Back To Results](#)

[New Search](#)

[Create PDF](#)

Property Overview

2024

Owner Name

BROGLE JOHN & SHARI

Owner Address

4075 HUCKLEBERRY DR
CENTER VALLEY PA 18034-8527

Property Address

4075 HUCKLEBERRY DR
CENTER VALLEY PA 18034

Parcel Viewer

[View in Parcel Viewer](#)

Low Number

4075

High Number		
4075		
Sub Division		
COUNTRYSIDE		
Tax Authority		
UPPER SAUCON TOWNSHIP		
School District		
SOUTHERN LEHIGH SCHOOL DISTRICT		
Parcel Id		
641469132659 1		
Old Parcel Id		
22 K10NE2 011 017		
Tile		
446103A		
Acres/Dimension		
31.36 X 130.57 IRREG		
Lot Sq Ft		
5783		
Utilities		
PUBLIC WATER/SEWER		
Class		
RESIDENTIAL		
Land Use		
SINGLE FAMILY - END OF ROW		
Living Units		
1		
Zoning		
R-3		
Homestead Act 72		
Application Mailed - Please fill out and return for processing.		
Preferential Land Act		
NO		
Agricultural Easement		
NO		
Assessment Base Year		
2013		
Total Assessment		
Exempt Land	0	
Exempt Building	0	
Taxable Land	22,000	
Taxable Building	168,400	
Total	190,400	
Taxable Total	190,400	
Estimated Taxes		
	Mills	Estimated Taxes
County	3.780000	\$ 719.71
School	17.259500	\$ 3,286.21

Municipality		1.645100		\$ 313.23
Total				\$ 4,319.15

Bill Number

2200614

LC_PropertyAddress

4075 HUCKLEBERRY DR CENTER VALLEY PA 18034

Basic Residential Profile

Type of Residence

SINGLE FAMILY - END OF ROW

Number of Stories

3 STORY

Type of Construction

ALUMINIUM/VINYL

Type of Basement

NO

Type of Heating/Cooling

CENTRAL AIR

Type of Garage

ATTACHED ONE CAR

Number of Full Bathrooms

2

Number of Half Bathrooms

1

Fireplaces

0

Square Feet

2236

Year Built

2003

Pool

NO POOL

Implement Buildings

NO IMPLEMENT BLDG

Residential Profile Data With No Influence on Assessment Value

Total Rooms

6

Number of Bedrooms

3

Family Rooms

1

Sales History

Sale Date	Owner Name	Document Id	Sale Price
-----------	------------	-------------	------------

03/2004	BROGLE JOHN & SHARI	7170811	\$ 221,740
11/2003	NVR INC	7142902	\$ 301,000
04/2002	UPPER SAUCON DEVELOPMENT LP	7005871	\$ 1
/0000	NEW PARCEL	0000000	\$ 0

From: Patricia Lang <plang@uppersaucon.org>

Sent: Tuesday, June 11, 2024 12:21 AM

To: MLS <MLS@stellaripl.com>

Subject: Right to Know Request

Good Afternoon,

Thank you for contacting the Township. Your request for information associated with property addressed as 4075 Huckleberry Drive was forwarded to me for response.

You have requested information related to Building Permits, code violations, or special assessment fees.

The unit was constructed in 2003 however we do not have this permit in our records. A building permit for a deck was issued in 2007 and is attached. No other building permits have been issued for work at this site. There are no code violations on record and the Township has no special assessment fees associated with this address.

Trisha Lang
Director of Community Development
Upper Saucon Township, Lehigh County
5500 Camp Meeting Road
Center Valley, PA 18034

Phone: 610-282-1171

Fax: 610-282-3557

e-mail: plang@uppersaucon.org

UPPER SAUCON TOWNSHIP

BUILDING PERMIT

DEPT. FILE COPY

AMOUNT PAID

VALIDATION

DATE **AUGUST 22, 2007**

PERMIT NO. **B07-242**

APPLICANT **THOMAS NICOLETTE**

ADDRESS _____ (NO.) _____ (STREET) _____ (CONTR'S LICENSE)

PERMIT TO **ALTERATION**
(TYPE OF IMPROVEMENT)

(**1**) STORY **DECK**
NO. (PROPOSED USE)

NUMBER OF DWELLING UNITS _____

AT (LOCATION) **PIN #641469132659**
(NO.)

4075 HUCKLEBERRY DRIVE CENTER VALLEY
(STREET)

ZONING DISTRICT **R3**

BETWEEN _____ AND _____
(CROSS STREET) (CROSS STREET)

SUBDIVISION **COUNTRYSIDE**

LOT **144A** BLOCK _____

LOT SIZE _____

BUILDING IS TO BE **12** FT. WIDE BY **22** FT. LONG BY _____ FT. IN HEIGHT AND SHALL CONFORM IN CONSTRUCTION

TO TYPE **5B** USE GROUP **U** BASEMENT WALLS OR FOUNDATION _____ (TYPE)

REMARKS: **PUBLIC WATER/PUBLIC SEWER**

AREA OR VOLUME **264 SQUARE FEET**
(CUBIC/SQUARE FEET)

ESTIMATED COST \$ **3,000.00**

PERMIT FEE \$ **30.00**

OWNER **JOHN BROGLE**

ADDRESS **4075 HUCKLEBERRY DRIVE CENTER VALLEY PA 18034**

BUILDING DEPT BY _____

(Affidavit on reverse side of application to be completed by authorized agent of owner)

FORM NO. I.C.C. - BP 2003