

Street View

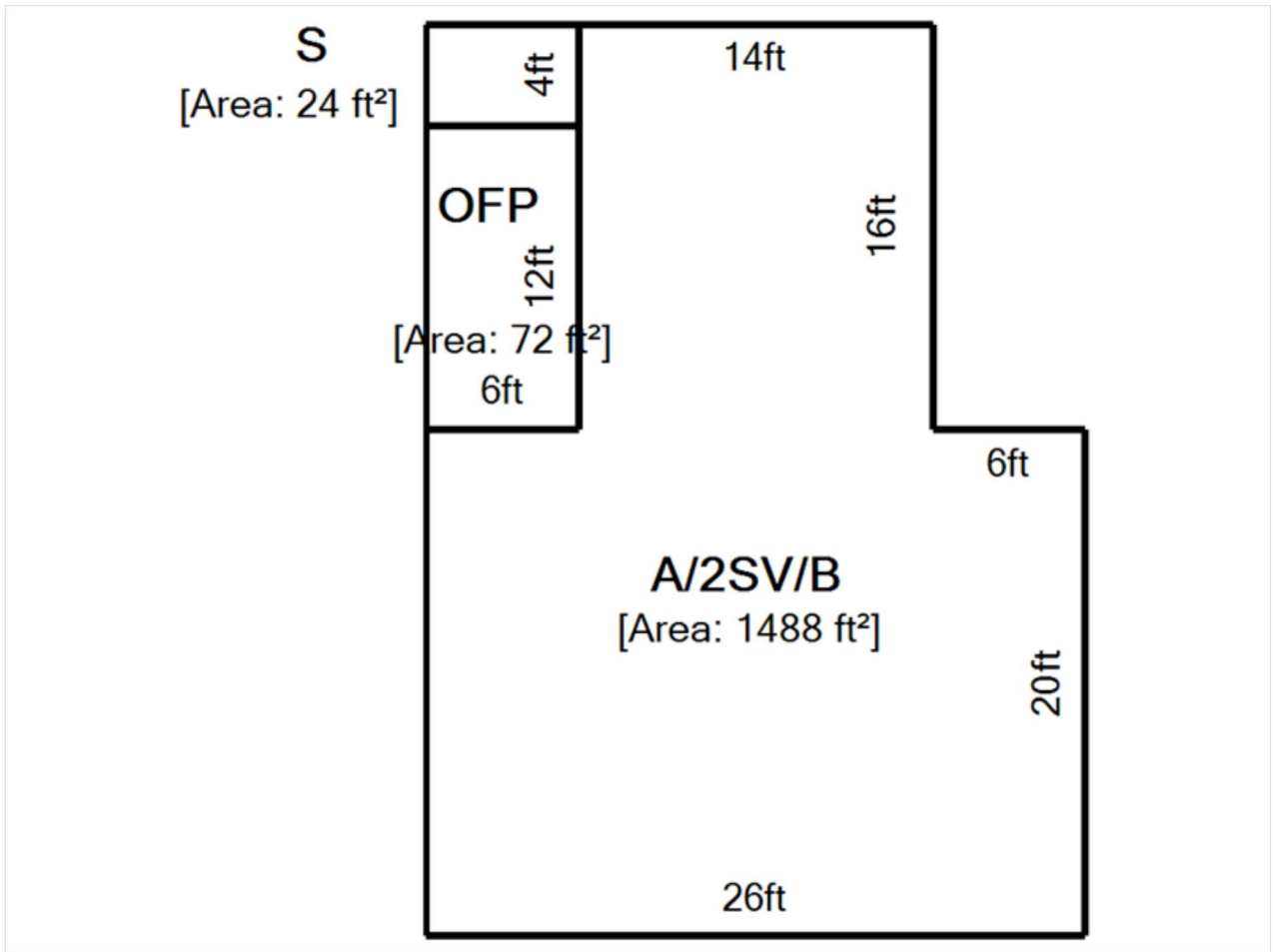

Footprint



[Sketch Codes](#)

Options

- [Back To Results](#)
- [New Search](#)
- [Create PDF](#)

Property Overview

2024

Owner Name

BILHEIMER KAY L & KENNETH BILHEIMER

Owner Address

4134 N CHURCH ST
WHITEHALL PA 18052-1434

Property Address

4134 N CHURCH ST
WHITEHALL PA 18052

Parcel Viewer

[View in Parcel Viewer](#)

Low Number

4134

High Number		
4134		
Tax Authority		
WHITEHALL TOWNSHIP		
School District		
WHITEHALL-COPLAY SCHOOL DISTRICT		
Parcel Id		
548938986361 1		
Old Parcel Id		
25 E08NE1A 007 008		
Title		
495802B		
Acres/Dimension		
50 X 150		
Lot Sq Ft		
7500		
Utilities		
PUBLIC WATER/SEWER		
Class		
RESIDENTIAL		
Land Use		
SINGLE FAMILY - DETACHED		
Living Units		
1		
Zoning		
R-4		
Homestead Act 72		
You may apply if it is your permanent primary residence.		
Preferential Land Act		
NO		
Agricultural Easement		
NO		
Assessment Base Year		
2013		
Total Assessment		
Exempt Land		0
Exempt Building		0
Taxable Land		26,500
Taxable Building		89,600
Total		116,100
Taxable Total		116,100
Estimated Taxes		
	Mills	Estimated Taxes
County	3.780000	\$ 438.86
School	20.755800	\$ 2,409.75
Municipality	3.800000	\$ 441.18
Total		\$ 3,289.79

Bill Number

2500828

LC_PropertyAddress

4134 N CHURCH ST WHITEHALL PA 18052

Basic Residential Profile

Type of Residence

SINGLE FAMILY - DETACHED

Number of Stories

2 1/2 STORY

Type of Construction

ALUMINIUM/VINYL

Type of Basement

PART

Type of Heating/Cooling

BASE

Type of Garage

DETACHED ONE CAR

Number of Full Bathrooms

1

Number of Half Bathrooms

1

Fireplaces

0

Square Feet

1488

Year Built

1880

Pool

NO POOL

Implement Buildings

NO IMPLEMENT BLDG

Residential Profile Data With No Influence on Assessment Value

Total Rooms

6

Number of Bedrooms

4

Family Rooms

0

Sales History

Sale Date	Owner Name	Document Id	Sale Price
05/2015	BILHEIMER KAY L & KENNETH BILHEIMER	2015014180	\$ 155,500

05/2014	RIVERA JACQUELINE M	2014014497	\$ 90,000
02/2014	FEDERAL NATIONAL MORTGAGE ASSOC	2014006893	\$ 1
02/1956	MECKEL DALE E & NANCY L	0868/0160	\$ 8,900