

**Property Location:**

1000 Hickory Road

**Residential Property Record Card - Carbon County, PA**

**Parcel ID:** 28A-56-A11

**Map Block No:** 1

**Class:** R

**State Class:** 101

**Card 1 of 1**

Current Owner
Kralik, Toby M & Tara L 1000 Hickory Road Palmerton PA 18071

Previous Owner History		
Name	Deed	Date
Balent, Brian S	668/380	08/15/1996

Miscellaneous	
<b>Deed Info:</b>	2388/171-09/24/2018-X
<b>Zoning:</b>	RC
<b>Routing No:</b>	21-01962-0
<b>Neighborhd:</b>	2110
<b>Living Units:</b>	1
<b>Census Trct:</b>	
<b>District:</b>	56

Assessment Information		
<b>Market Value</b>	<b>Valu</b>	<b>* Prior</b>
<b>Land:</b>	27,100	1,196
<b>Building:</b>	97,800	
<b>Total:</b>	124,900	1,196
<b>Assessed Information:</b>		
<b>Land:</b>		13,550
<b>Building:</b>		48,900
<b>Total:</b>		62,450
<b>Effective DOV:</b> 1/1/2000		
<b>Value Flag:</b> MARKET VALUE		
<b>Manual Override Reason:</b>		

Notes

Entrance Information					
Date	Time	ID	Actv	Entrance Code	Source
06/22/1999		BS		Unimproved	Other
06/24/2002		PB		Estimated	
03/26/2003		PB		Not At Home	

Sales History				
Book/Page	Date	Price	Type	Validity

Permit Information				
Date	Permit #	Price	Purpose	% Comp.
04/01/2000	0350	5,000	Garage	100
11/19/2003	0935	80,000	Home	100

Land Information				
Type	Size	Grade	Influence Factor 1, 2 and %	Value
Primary	A	1 0	0	25,000
Residual	A	0.166 0	0	2,080
<b>Total Acres for this Parcel</b>		1.166	<b>Total Land Value</b>	27,100

Out Building Information								
Type	Qty	Year	Size1	Size2	Grade	Cond	%Good	Value
Garage-Wd/Cb	1	2000	30	36	C	A	0%	17,800
	0	0	0	0			0%	0
	0	0	0	0			0%	0
	0	0	0	0			0%	0
	0	0	0	0			0%	0
	0	0	0	0			0%	0
	0	0	0	0			0%	0
	0	0	0	0			0%	0
	0	0	0	0			0%	0
<b>Total OBY for this card</b>								17,800

No Picture Available

Inspection witness by: \_\_\_\_\_

Property Location:  
1000 Hickory Road

## Residential Property Record Card - Carbon County, PA

Parcel ID: 28A-56-A11

Map Block No: 1

Class: R    State Class: 101    Card 1 of 1

Dwelling Information	
Style:	Ranch
Condo Style:	
Exterior Walls:	Alum/Vinyl
Story Height:	1.0
Attic:	None
Interior/Exterior:	Same
Basement:	Full
Bsmt Garage:	0
Rec Room size:	0    0
FBLA size:	0    0
Unfinished Area:	0
Inlaw Apts:	0
WB Fireplace:	Stacks 0    Openings 0
MTL Fireplace:	Stacks 0    Openings 0
Heating Type:	Basic
Fuel:	Oil
Heating System:	Hot Water
Year Built:	2003
Eff. Yr Built:	0
GFA/True GFA:	960    960
TLA/True TLA:	960    960
Basement Area:	960
Grade:	C
Condition:	Good
CDU:	AV
<i>Building Notes:</i>	
<b>Tot</b>	
Rooms:	5
Bedrooms:	2
Full Baths:	1
Half Baths:	1
Add'l Fixtures:	0

Replacement Costs	
Base Price:	62,990
Additions:	18,000
Unfinished Area:	0
Basement:	0
Attic:	0
Plumbing:	1,480
Heating A/C Adj.:	0
FBLA:	0
Rec Room:	0
Fire Place:	0
Basement Garage:	0
Exterior Trim:	0
<b>Subtotal:</b>	<b>82,470</b>
Grade Factor:	1.00
C & D Factor:	0.00
<b>Total RCN:</b>	<b>82,470</b>
Percent Good:	0.98
Market Adj.:	0.00
<b>Total RCNLD:</b>	<b>80,800</b>

Addition Information					
Low	1st	2nd	3rd	Area	Points
				624	9800
				256	5600
				120	2600

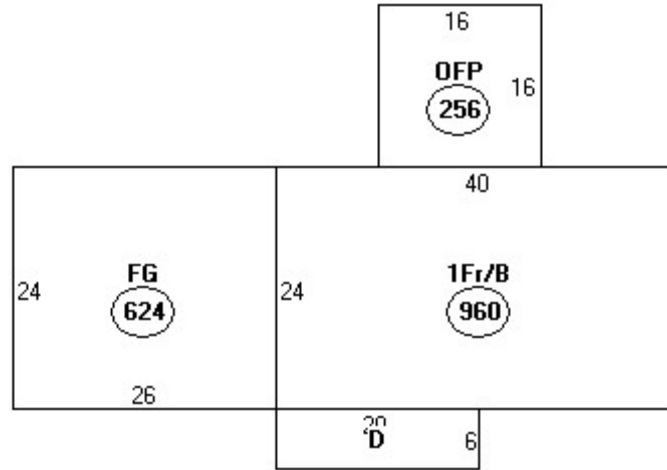

Descriptor/Area

A: 1Fr/B  
960 sqft

B: FG  
624 sqft

C: OFF  
256 sqft

D: OFF  
120 sqft

Owner/Values: Includes all Land/Buildings/OBYs for this Parcel					
	Current	Cost	Market	Income	Prior
<b>Land:</b>	27,100	27,100	27,100	0	1,196
<b>Building:</b>	97,800	98,600	97,800	0	0
<b>Total:</b>	124,900	125,700	124,900	0	1,196