



Property Information Request Information Update Information

File#:	BS-X01672-3966372017	Requested Date:	06/14/2024	Update Requested:
Owner:	EWELL, STEVEN E	Branch:		Requested By:
Address 1:	61 GENTLE DR	Date Completed:		Update Completed:
Address 2:		# of Jurisdiction(s):		
City, State Zip:	EAST EARL, PA	# of Parcel(s):	1	

Notes

CODE VIOLATIONS Per Town of East Earl Department of Zoning there are no Code Violation cases on this property.

Collector: Town of East Earl
 Payable Address: 4610 Division Highway East Earl, PA 17519
 Business# 717-354-5593 Ext. 24

PERMITS Per Town of East Earl Building Department there are no Open/Pending/ Expired Permit on this property.

Collector: Town of East Earl
 Payable Address: 4610 Division Highway East Earl, PA 17519
 Business# 717-354-5593 Ext. 24

SPECIAL ASSESSMENTS Per Town of East Earl Department of Finance there are Special Assessments due on the property.

Comments: Per East Earl Township, there is a Streetlight tax due in the amount of \$54.39 for 2023 and balance of \$49.40 is outstanding for 2024. Please contact Town of East Earl for any more information.

Collector: Town of East Earl
 Payable Address: 4610 Division Highway East Earl, PA 17519
 Business# 717-354-5593 Ext. 24

DEMOLITION NO

UTILITIES Water & Sewer
 Account #: 20555
 Payment Status: DELINQUENT
 Status: Pvt & Non-Lienable
 Amount: \$647.94
 Good Thru: 07/15/2024
 Account Active: Yes
 Collector: Weaverland Valley Authority
 Payable: PO Box 339, Blue Ball, Pennsylvania, 17506
 Business # 717-354-5593 ext 25

UNABLE TO PROVIDE DOCUMENTATION TO THIRD PARTIES. VERBAL INFO ACQUIRED

GARBAGE:
 GARBAGE PRIVATE HAULER WITH LIEN STATUS AND BALANCE UNKNOWN.

Tax Payment Available

Pay Taxes

Property Information

Property ID 200-66393-0-0000
Tax Year 2024
Township 200 East Earl Twp
Site Address 61 GENTLE DR

Property Use 100 - RESIDENTIAL
Land Use 113 - SINGLE FAMILY DWELLING
Tax Status Taxable
Clean & Green No

Property Sketches & Photos

1-1

Imported Image

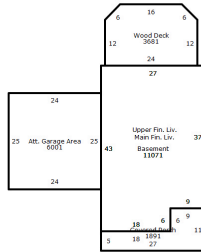

Sketch by AutoSketch™

Related Names

Parcel Owner EWELL, STEVEN E
 61 GENTLE DRIVE
 EAST EARL, PA 17519
Status Current

Structure 1 of 1

Property Type	Description	Style	Total Living Area	Year Built
RES - Residential	CONTEMPORARY #1	Two Story	2,214	2010

Accommodations	
Extra Fixtures	4
Full Baths	2
Half Baths	1
Number of Bedrooms	4
Number of Families	1
Number of Rooms	7

Garage/Carport	
Attached Garage	600.00 Sq.Ft.

Porches, Decks, Breezeways	
Slab Porch with Roof	189.00 Sq.Ft.
Wood Deck	368.00 Sq.Ft.

Story Height	
Number of Stories	2.00

Basement	
Total Basement Area	1107.00 Sq.Ft.

Exterior Walls	
Frame, Siding, Vinyl	2214.00 Sq.Ft.

Fireplaces	
Single 2-Story Fireplace	1.00 Units

Fuel Type	
Fuel Type	Electric

Heating/Cooling	
Warmed & Cooled Air	2214.00 Sq.Ft.

Roofing	
Composition Shingle	2214.00 Sq.Ft.

Style	
Style	CONTEMPORARY

No Exemptions

Contact Information

Mail current year, county & municipal real estate tax payments to...

Lancaster County Treasurer
County & Municipal Tax Bill
P.O. BOX 3894
LANCASTER, PA 17604
(717) 299-8222

Tax certification **OVERNIGHT** requests can be sent to...

Lancaster County Treasurer
150 North Queen Street, Suite 122
Lancaster, PA 17603

Regular Mail

Lancaster County Treasurer
P.O. Box 1447
Lancaster, PA 17608

Delinquent Taxes

NOT A CERTIFIED COPY - FOR INFORMATIONAL PURPOSES ONLY

Tax Year	Due	Paid	Total Due
----------	-----	------	-----------

© 2024 DEVNET, Inc
Data updated: 2024-07-01 17:15:00
wEdge Version 4.0.8755.27488
Assembly Date: 2023/12/21

Subject: 61 Gentle Dr

You don't often get email from jsauder@eastearltpw.org. [Learn why this is important](#)

CAUTION: This email originated from outside of the organization. Do not click links or open attachments unless you recognize the sender and know the content is safe.

In response to your Right to know request regarding 61 Gentle Dr. I was able to find one outstanding issue. The Streetlight tax in the amount of \$54.39 from 2023 has not been paid and is past due. In addition, a balance of \$49.40 is outstanding for 2024 and is due by June 30. Thank you for inquiring.

Justin M. Sauder
Township Manager
East Earl Township
4610 Division Highway
East Earl, PA 17519
717-354-5593 Ext. 24

DISCLAIMER: The information contained in this message is proprietary and/or confidential and may be privileged. If you are not the intended recipient of this communication, you are hereby notified to: (i) delete the message and all copies; (ii) do not disclose, distribute or use the message in any manner; and (iii) notify the sender immediately. (iv) The recipient should check this email and any attachments for the presence of malware. The company accepts no liability for any damage caused by any Malware transmitted by this email.

DISCLAIMER: The information contained in this message is proprietary and/or confidential and may be privileged. If you are not the intended recipient of this communication, you are hereby notified to: (i) delete the message and all copies; (ii) do not disclose, distribute or use the message in any manner; and (iii) notify the sender immediately. (iv) The recipient should check this email and any attachments for the presence of malware. The company accepts no liability for any damage caused by any Malware transmitted by this email.