

### Tax Payment Available

Pay Taxes

### Property Information

**Property ID** 200-66393-0-0000  
**Tax Year** 2024   
**Township** 200 East Earl Twp  
**Site Address** 61 GENTLE DR

**Property Use** 100 - RESIDENTIAL  
**Land Use** 113 - SINGLE FAMILY DWELLING  
**Tax Status** Taxable  
**Clean & Green** No

### Property Sketches & Photos

1-1

Imported Image

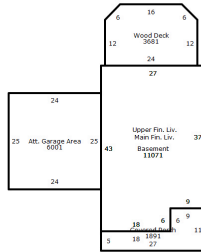

Sketch by AutoSketch™

### Related Names

**Parcel Owner** EWELL, STEVEN E  
 61 GENTLE DRIVE  
 EAST EARL, PA 17519  
**Status** Current

Structure 1 of 1

Property Type	Description	Style	Total Living Area	Year Built
RES - Residential	CONTEMPORARY #1	Two Story	2,214	2010

Accommodations	
Extra Fixtures	4
Full Baths	2
Half Baths	1
Number of Bedrooms	4
Number of Families	1
Number of Rooms	7

Garage/Carport	
Attached Garage	600.00 Sq.Ft.

Porches, Decks, Breezeways	
Slab Porch with Roof	189.00 Sq.Ft.
Wood Deck	368.00 Sq.Ft.

Story Height	
Number of Stories	2.00

Basement	
Total Basement Area	1107.00 Sq.Ft.

Exterior Walls	
Frame, Siding, Vinyl	2214.00 Sq.Ft.

Fireplaces	
Single 2-Story Fireplace	1.00 Units

Fuel Type	
Fuel Type	Electric

Heating/Cooling	
Warmed & Cooled Air	2214.00 Sq.Ft.

Roofing	
Composition Shingle	2214.00 Sq.Ft.

Style	
Style	CONTEMPORARY

No Exemptions

Contact Information

Mail current year, county & municipal real estate tax payments to...

Lancaster County Treasurer  
County & Municipal Tax Bill  
P.O. BOX 3894  
LANCASTER, PA 17604  
(717) 299-8222

Tax certification **OVERNIGHT** requests can be sent to...

Lancaster County Treasurer  
150 North Queen Street, Suite 122  
Lancaster, PA 17603

Regular Mail

Lancaster County Treasurer  
P.O. Box 1447  
Lancaster, PA 17608

Delinquent Taxes

**NOT A CERTIFIED COPY - FOR INFORMATIONAL PURPOSES ONLY**

Tax Year	Due	Paid	Total Due
----------	-----	------	-----------

© 2024 DEVNET, Inc  
Data updated: 2024-07-01 17:15:00  
wEdge Version 4.0.8755.27488  
Assembly Date: 2023/12/21