



## Property Information

## Request Information

## Update Information

|                  |                           |                       |            |                   |
|------------------|---------------------------|-----------------------|------------|-------------------|
| File#:           | BS-X01672-8741943905      | Requested Date:       | 06/14/2024 | Update Requested: |
| Owner:           | HEINTZELMAN, DANIEL JAMES | Branch:               |            | Requested By:     |
| Address 1:       | 1804 CENTRE ST            | Date Completed:       |            | Update Completed: |
| Address 2:       |                           | # of Jurisdiction(s): |            |                   |
| City, State Zip: | ASHLAND, PA               | # of Parcel(s):       | 1          |                   |

## Notes

**CODE VIOLATIONS** Per Ashland Borough Department of Zoning there are no Code Violation cases on this property.  
Collector: Ashland Borough  
Payable Address: 401 South 18th Street, Ashland, PA 17921  
Business# (570) 875-2411  
UNABLE TO PROVIDE DOCUMENTATION TO THIRD PARTIES. VERBAL INFO ACQUIRED.

**PERMITS** Per Ashland Borough Building Department there are no Open/Pending/ Expired Permit on this property.  
Collector: Ashland Borough  
Payable Address: 401 South 18th Street, Ashland, PA 17921  
Business# (570) 875-2411  
UNABLE TO PROVIDE DOCUMENTATION TO THIRD PARTIES. VERBAL INFO ACQUIRED.

**SPECIAL ASSESSMENTS** Per Town of Ashland Borough Department of Finance there are no Special Assessments/liens on the property.  
Collector: Ashland Borough  
Payable Address: 401 South 18th Street, Ashland, PA 17921  
Business# (570) 875-2411  
UNABLE TO PROVIDE DOCUMENTATION TO THIRD PARTIES. VERBAL INFO ACQUIRED.

**DEMOLITION** NO

**UTILITIES** Water, Sewer & Garbage  
Account #: 000923  
Payment Status: DELINQUENT  
Status: Pvt & Non-Lienable  
Amount: \$1,565.65  
Good Thru: 09/07/2024  
Account Active: Yes  
Collector: Ashland Borough  
Payable: 401 South 18th Street, Ashland, PA 17921  
Business # (570) 875-2411  
UNABLE TO PROVIDE DOCUMENTATION TO THIRD PARTIES. VERBAL INFO ACQUIRED.

# 1804 CENTRE ST

**Location** 1804 CENTRE ST **Tax Map** 38/ 06/ 0045/ 000/  
**Control#** 00052200 **Owner** HEINTZELMAN, DANIEL JAMES  
**Property Type** Buildings < 10 Acres **Assessment** \$17,500  
**Appraisal** \$35,000 **PID** 52200  
**Building Count** 1 **Tax Status** T  
**School District:** North Schuylkill School Distri **Homestead Appr** N  
**Farmstead Appr** N **Lot Type**  
**Terrain** **Value** Paved  
**Utilities** **Sewer** Public Sewer  
**Water** Public **Historic**  
**Rail Avl** No **Sidewalk** Yes  
**Road Access** Conventional **Hard Top Drive**  
**Waterfront** **Superior View**  
**NBHD Location** SS **Gas in Use?** N  
**Tree Cover** **District** 38: Ashland Borough

## Current Value

| Appraisal      |              |         |          |
|----------------|--------------|---------|----------|
| Valuation Year | Improvements | Land    | Total    |
| 1996           | \$28,750     | \$6,250 | \$35,000 |
| Assessment     |              |         |          |
| Valuation Year | Improvements | Land    | Total    |
| 1996           | \$14,375     | \$3,125 | \$17,500 |

## Owner of Record

**Owner** HEINTZELMAN, DANIEL JAMES  
**Co-Owner**  
**Address** 1804 CENTRE AVE  
 ASHLAND, PA 17921

**Sale Price** \$46,000  
**Certificate**  
**Book & Page** 2615-1267  
**Sale Date** 12/21/2017

## Ownership History

| Ownership History                    |            |             |             |            |
|--------------------------------------|------------|-------------|-------------|------------|
| Owners                               | Sale Price | Certificate | Book & Page | Sale Date  |
| HEINTZELMAN, DANIEL JAMES            | \$46,000   |             | 2615-1267   | 12/21/2017 |
| DEMKO, STEVEN D; JOHNSON, RACHELLE M | \$50,000   |             | 2419-1376   | 11/10/2011 |
| RAMSAY, DANIEL                       | \$0        |             | 1383-0317   | 11/05/1986 |
| MORGAN, A & S                        | \$0        |             | 1219-0850   | 02/23/1976 |
| MORGAN, A & S                        | \$0        |             | 1216-0645   | 11/14/1975 |
| WALSH, M & J                         | \$0        |             | 1111-0773   | 06/14/1969 |
| WALSH, A & M                         | \$0        |             | 0935-0099   | 01/07/1956 |

## Building Information

### Building 1 : Section 1

**Year Built:** 1926  
**Living Area:** 1,414

| Building Attributes |                  |
|---------------------|------------------|
| Field               | Description      |
| Attic Heat          |                  |
| Model               | Residential      |
| Stories             | 03               |
| Int vs Ext          | S                |
| Full Bath(s)        | 1                |
| Half Bath(s)        | 0                |
| Bedroom(s)          | 3                |
| Total Rooms         | 6                |
| Basement            | 3                |
| Bsmt Exposure       |                  |
| Bsmt Garage(s)      | 0                |
| Bldg Use            | 01               |
| Style               | Waiting for Data |
| Roof Structure      |                  |
| Roof Cover          |                  |
| Exterior Wall 1     | AS               |

### Building Photo



<https://images.vgsi.com/photos/schuylkillcountypaPhotos/\pix\OO\002\OC>

|                  |        |
|------------------|--------|
| Exterior Wall 2  |        |
| Heat Fuel        |        |
| Heat Dist.       | HW     |
| AC Type          | NO     |
| Fireplace(s)     | 0      |
| Attic (P/S)      | NONE   |
| MH Park ID       |        |
| MH Class         |        |
| Grade            |        |
| Govern BaseRate  | 38B-31 |
| Econ Dep Adj     |        |
| Percent Complete |        |
| Future Eff Age   |        |
| Future Grade     |        |
| Future Condition |        |

### Building Layout

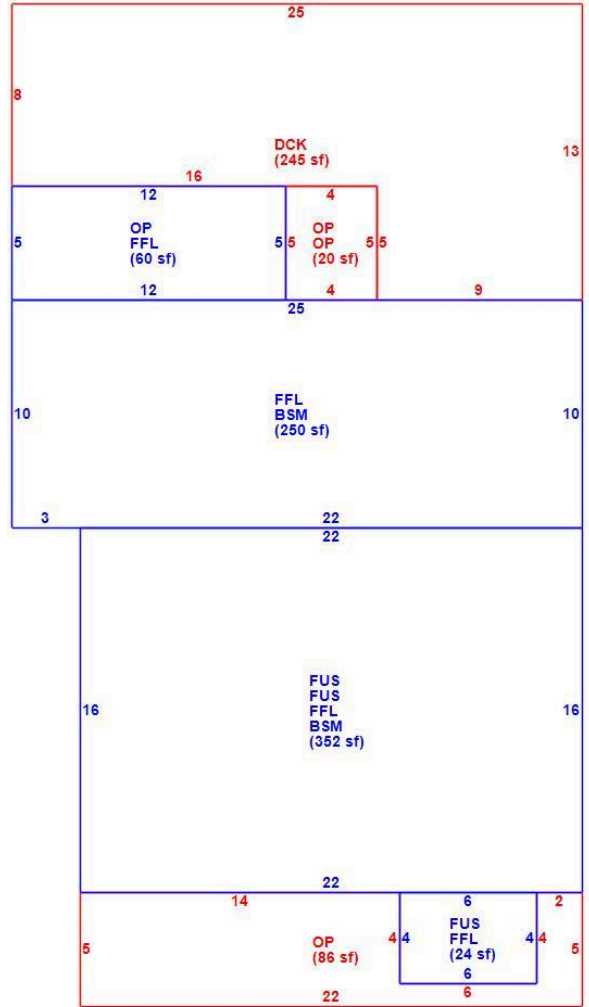

(ParcelSketch.ashx?pid=52200&bid=52200)

| Building Sub-Areas (sq ft) |                      |            | Legend      |  |
|----------------------------|----------------------|------------|-------------|--|
| Code                       | Description          | Gross Area | Living Area |  |
| FUS                        | FINISHED UPPER STORY | 728        | 728         |  |
| FFL                        | FIRST FLOOR          | 686        | 686         |  |
| BSM                        | BASEMENT             | 602        | 0           |  |
| DCK                        | DECK                 | 245        | 0           |  |
| OP                         | OPEN PORCH           | 186        | 0           |  |
|                            |                      | 2,447      | 1,414       |  |

### Parcel Information

**Use Code** 101  
**Description** Res. 1 Family  
**Deeded Acres** 0.07

### Land

**Land Use**

**Use Code** 101  
**Description** Res. 1 Family  
**Clean & Green Approved** No

**Land Line Valuation**

**Size (Acres)** 0.07  
**Frontage** 25  
**Depth** 125  
**Land** \$3,125  
**Appraised Value** \$6,250

**Outbuildings**

| Outbuildings |                      |          |                 |           |                |        |
|--------------|----------------------|----------|-----------------|-----------|----------------|--------|
| Code         | Description          | Sub Code | Sub Description | Size      | Assessed Value | Bldg # |
| garage       | 11 Garage (Detached) | F        | FRAME           | 480.00 SF | \$840          | 1      |