



Property Information

Request Information

Update Information

File#:	BS-X01693-9436566748	Requested Date:	07/17/2024	Update Requested:
Owner:	SAMUEL STRAUSSER JR	Branch:		Requested By:
Address 1:	623 FAIRVIEW ST	Date Completed:		Update Completed:
Address 2:		# of Jurisdiction(s):		
City, State Zip:	POTTSVILLE, PA	# of Parcel(s):	1	

Notes

CODE VIOLATIONS	Per City of Pottsville Department of Zoning there are no Code Violation cases on this property. Collector: City of Pottsville Payable Address: 401 North Centre Street Pottsville, PA 17901 Business# 570.622.1234 ext 1346
PERMITS	Per City of Pottsville Building Department there are no Open/Pending/ Expired Permit on this property. Collector: City of Pottsville Payable Address: 401 North Centre Street Pottsville, PA 17901 Business# 570.622.1234 ext 1346
SPECIAL ASSESSMENTS	Per City of Pottsville Department of Finance there are no Special Assessments/liens on the property. Collector: City of Pottsville Payable Address: 401 North Centre Street Pottsville, PA 17901 Business# 570.622.1234 ext 1346
DEMOLITION	NO



UTILITIES

Water
Account #: 03907480-0
Payment Status: DUE
Status: Pvt & Non-Lienable
Amount: \$162.44
Good Thru: 08/15/2024
Account Active: Yes
Collector: Schuylkill County Municipal Auth
Payable: 221 S Centre St, Pottsville, PA 17901
Business # 570-622-8240

UNABLE TO PROVIDE DOCUMENTATION TO THIRD PARTIES. VERBAL INFO ACQUIRED.

Sewer
Account #: 390748
Payment Status: DUE
Status: Pvt & Non-Lienable
Amount: \$127.50
Good Thru: 08/12/2024
Account Active: Yes
Collector: Greater Pottsville Area Sewer Authority
Payable: 401 North Centre Street P.O. Box 1163 Pottsville, PA 17901
Business # (570) 622-0513

UNABLE TO PROVIDE DOCUMENTATION TO THIRD PARTIES. VERBAL INFO ACQUIRED.

Garbage:
Garbage private hauler with lien status and balance unknown.

623 FAIRVIEW ST

Location 623 FAIRVIEW ST

Tax Map 68/ 19/ 0234/ 000/

Control# 00086512

Owner STRAUSSER, SAMUEL H

Property Type Buildings < 10 Acres

Assessment \$12,730

Appraisal \$25,460

PID 86512

Building Count 1

Tax Status T

School District: Pottsville Area School Distric

Homestead Appr Y

Farmstead Appr N

Lot Type Interior

Terrain Level

Value Paved

Utilities Natural Gas, Sewer, Water

Sewer Public Sewer

Water Public

Historic No

Rail Avl No

Sidewalk Yes

Road Access Conventional

Hard Top Drive Yes

Waterfront N

Superior View N

NBHD Location SPOT

Gas in Use? N

Tree Cover O

District 68: Pottsville

Current Value

Appraisal			
Valuation Year	Improvements	Land	Total
1996	\$21,460	\$4,000	\$25,460
Assessment			
Valuation Year	Improvements	Land	Total
1996	\$10,730	\$2,000	\$12,730

Owner of Record

Owner STRAUSSER, SAMUEL H
Co-Owner
Address 623 FAIRVIEW ST
 POTTSVILLE, PA 17901

Sale Price \$1
Certificate
Book & Page 2227-1104
Sale Date 09/26/2006

Ownership History

Ownership History				
Owners	Sale Price	Certificate	Book & Page	Sale Date
DINGER, DOROTHY A; STRAUSSER, DOROTHY A; STRAUSSER, SAMUEL H	\$1		2227-1104	09/26/2006
DINGER, DOROTHY A; STRAUSSER, SAMUEL H	\$26,500		1613-0250	07/07/1995
FLANNERY, ALBERT J	\$0		1433-0804	09/05/1989
FLANNERY, GREGORY	\$0		1394-0237	07/16/1987
FLANNERY, ALBERT J & KAREN M	\$0		1357-0483	04/05/1985

Building Information

Building 1 : Section 1

Year Built: 1930
Living Area: 1,280

Building Attributes	
Field	Description
Attic Heat	
Model	Residential
Stories	02
Int vs Ext	S
Full Bath(s)	1
Half Bath(s)	0
Bedroom(s)	3
Total Rooms	6
Basement	4
Bsmt Exposure	04
Bsmt Garage(s)	0
Bldg Use	18
Style	Conventional
Roof Structure	06
Roof Cover	01
Exterior Wall 1	V
Exterior Wall 2	
Heat Fuel	O

Building Photo



<https://images.vgsi.com/photos/schuylkillcountypaPhotos/Photo\FF\001\F>

Heat Dist.	HA
AC Type	NO
Fireplace(s)	0
Attic (P/S)	NONE
MH Park ID	
MH Class	
Grade	
Govern BaseRate	68F-21
Econ Dep Adj	
Percent Complete	
Future Eff Age	
Future Grade	
Future Condition	

Building Layout

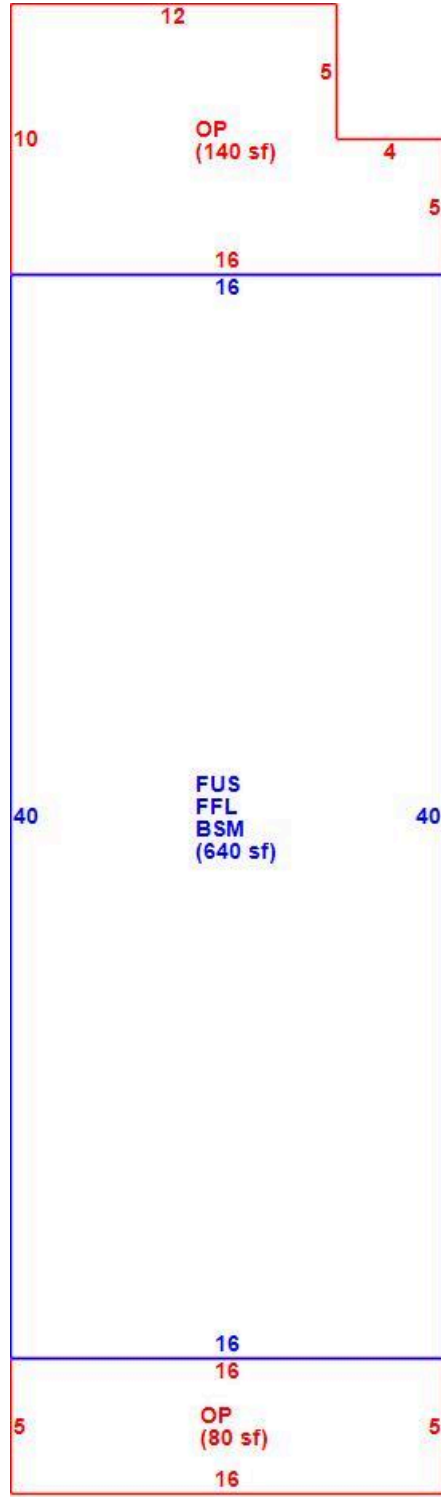

([ParcelSketch.ashx?pid=86512&bid=86512](#))

Building Sub-Areas (sq ft)			Legend
Code	Description	Gross Area	Living Area
FFL	FIRST FLOOR	640	640
FUS	FINISHED UPPER STORY	640	640
BSM	BASEMENT	640	0
OP	OPEN PORCH	220	0

		2,140	1,280
--	--	-------	-------

Parcel Information

Use Code 101
Description Res. 1 Family
Deeded Acres 0.05

Land

Land Use		Land Line Valuation	
Use Code	101	Size (Acres)	0.05
Description	Res. 1 Family	Frontage	19
Clean & Green Approved	No	Depth	115
		Land	\$2,000
		Appraised Value	\$4,000

Outbuildings

Outbuildings						
Code	Description	Sub Code	Sub Description	Size	Assessed Value	Bldg #
shedcl	10 shedcls (Closed Shed, describe in not	W	WOOD	80.00 SF	\$80	1



CITY OF POTTSVILLE, PENNSYLVANIA

401 N. CENTRE ST., P.O. BOX 50, POTTSVILLE, PA 17901 - 0050

(570) 622-1234 • FAX: (570) 628-4222

Thank you for writing to the Office of Open Records with your request for information pursuant to the Pennsylvania Right-To-Know Law, 65 P.S. 67, 101 *et. Seq.* On July 22, 2024 you requested the following information:

- Our firm has been requested to research the referenced property for any BUILDING PERMITS, CODE VIOLATION & SPECIAL ASSESSMENT on record in any city, town, village, or port authority.
- Address: 623 Fairview Street, Pottsville, PA 17901, Parcel: 68-19-234

On July 29, 2024, the Office of Open Records invoked a 30-day extension to respond to your request which moved the deadline to August 28, 2024. The OOR now issues its response.

After further review, your request, as such, has been granted in part and denied in part. We have enclosed a building permit that has been paid. That is all we have in the file for the above address. For any special assessments, you would need to contact the Schuylkill County Courthouse, as we do not handle special assessments at City Hall.

You have a right to appeal the redactions/denial of information in writing to Commonwealth of Pennsylvania, Office of Open Records, 333 Market Street, 16th Floor, Harrisburg, PA 17101-2234. If you choose to file an appeal, you must do so within 15 business days of the mailing date of the agency's response, as outlined in Section 1101.

If you have further questions, please submit your inquiry in writing or via email to Rebecca Trefsgger, Agency Open Records Officer. Please be advised that this correspondence will serve to close this record with our office, as permitted by law.

Sincerely,
Rebecca Trefsgger
Administrative Assistant/Open Records Officer

A handwritten signature in cursive script that reads "Rebecca Trefsgger".

CITY OF POTTSVILLE
 401 NORTH CENTRE STREET
 SUITE 1
 POTTSVILLE, PA 17901

Construction Permit

Permit Number: 16-00221	Permit Issue Date: 08/01/16	Invoice #: 16-02836
Application Id: 1157	Application Date: 08/01/16	
Owner/Property Details		
Block/Lot/Qual: 68-19-234. Owner Name: STRAUSSER JR,SAM & DINGER,DOT Address: 623 FAIRVIEW ST POTTSVILLE, PA 17901	Phone #: Use Type: R-5 Res; 1 & 2 Family Location: 623 FAIRVIEW ST	
Contractor: STRAUSSER JR,SAM & DINGER,DOT Address: 623 FAIRVIEW ST POTTSVILLE, PA 17901		
Approved By:		
Phone Number: License #: Federal Tax Id:	Code Enforcement Officer: _____ Date: _____	
is hereby granted permission to perform the following work:		
BUILDING	Engineer: _____ Date: _____	
Description of Work		
CONSTRUCT 8X10 STORAGE SHED NON-VARIANCE # 2281	Health Officer: _____ Date: _____	
	Fire Chief: _____ Date: _____	
	Sewer Authority: _____ Date: _____	
	Zoning Officer: _____ Date: _____	
	Planning Commission: _____ Date: _____	

Alteration Cost: 500.00

New Construction Volume: 0

NOTE: If construction does not commence within one (1) year of issuance or if construction ceases for a period of six (6) months, this permit is void.

 Construction Official Date