



Property Information

Request Information

Update Information

File#: BS-X01693-6001637902
Owner: KATHLEEN CELOTTI
Address 1: 31 BAYBERRY LANE
Address 2:
City, State Zip: JEWETT CITY, CT

Requested Date: 07/17/2024
Branch:
Date Completed:
of Jurisdiction(s):
of Parcel(s): 1

Update Requested:
Requested By:
Update Completed:

Notes

CODE VIOLATIONS

Per Town of Lisbon Zoning Department there are no Code Violation cases on this property.

Collector:Town of Lisbon
Address:1 Newent Road Lisbon, CT 06351
Business:860-334-0135

UNABLE TO PROVIDE DOCUMENTATION TO THIRD PARTIES. VERBAL INFO ACQUIRED

PERMITS

Per Town of Lisbon Building Department there are no Open/Pending/ Expired Permit on this property.

Collector:Town of Lisbon
Address:1 Newent Road Lisbon, CT 06351
Business:860-334-0135

UNABLE TO PROVIDE DOCUMENTATION TO THIRD PARTIES. VERBAL INFO ACQUIRED

SPECIAL ASSESSMENTS

Per Town of Lisbon Tax Collector there are no Special Assessments/liens on the property.

Collector:Town of Lisbon
Address:1 Newent Road Lisbon, CT 06351
Business:860-376-4188

UNABLE TO PROVIDE DOCUMENTATION TO THIRD PARTIES. VERBAL INFO ACQUIRED

DEMOLITION

NO

UTILITIES

WATER AND SEWER
THE HOUSE IS ON A COMMUNITY WATER & SEWER. ALL HOUSES GO TO A SHARED WELL & SEPTIC SYSTEM.

GARBAGE
GARBAGE PRIVATE HAULER WITH LIEN STATUS AND BALANCE UNKNOWN

31 BAYBERRY LA

Location 31 BAYBERRY LA

Mblu 16/ 071/ 000B/ /

Acct# S0163800

Owner CELOTTI KATHLEEN C

Assessment \$397,100

Appraisal \$567,280

PID 1678

Building Count 1

Current Value

Appraisal			
Valuation Year	Improvements	Land	Total
2021	\$480,580	\$86,700	\$567,280

Assessment			
Valuation Year	Improvements	Land	Total
2021	\$336,400	\$60,700	\$397,100

Owner of Record

Owner CELOTTI KATHLEEN C

Sale Price \$595,000

Co-Owner

Certificate

Care Of
Address 31 BAYBERRY LA
LISBON, CT 06351

Book & Page 137/164
Sale Date 08/27/2008
Instrument 29

Ownership History

Ownership History					
Owner	Sale Price	Certificate	Book & Page	Instrument	Sale Date
CELOTTI KATHLEEN C	\$595,000		137/164	29	08/27/2008
GWIAZDOWSKI MARCI J & JOHN D	\$0		111/724	29	12/01/2003
GWIAZDOWSKI MARCI J	\$0		75/876	29	05/16/1995

Building Information

Building 1 : Section 1

Year Built: 1995
Living Area: 3,576
Replacement Cost: \$554,783
Building Percent Good: 81
Replacement Cost
Less Depreciation: \$449,370

Building Attributes	
Field	Description
Style	Colonial
Model	Residential
Grade	A-

No. of Stories	2
Occupancy	1
Exterior Wall 1	Vinyl Siding
Exterior Wall 2	
Roof Structure	Gable
Roof Cover	Asphalt
Interior Wall 1	Drywall
Interior Wall 2	
Interior Flr 1	Hardwood
Interior Flr 2	Carpet
Heat Fuel	Oil
Heat Type	Radiant
AC Type	Central
Total Bedrooms	4 Bedrooms
Total Bathrms	2
Total Half Baths	2
Xtra Fixtrs.	5
Total Rooms	9
Bath Style	Average
Kitchen Style	Average
Wood Fireplaces	1
Gas Fireplaces	
Rental Unit	
Fin. Bsmnt. Qual.	

Building Photo



(<https://images.vgsi.com/photos2/LisbonCTPhotos//LegacyPhotos/S01638/>)

Building Layout

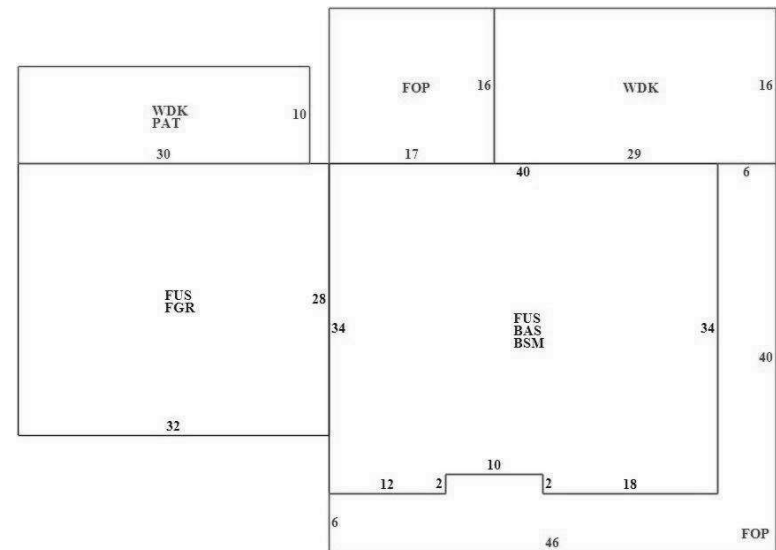

(ParcelSketch.aspx?pid=1678&bid=1678)

Foundation	Concrete
Bsmnt Garage	
Int vs Ext	Unknown
Mobile Complex	
Fin. Basement	

Building Sub-Areas (sq ft)			<u>Legend</u>
Code	Description	Gross Area	Living Area
FUS	Upper Story, Finished	2,236	2,236
BAS	First Floor	1,340	1,340
BSM	Basement	1,340	0
FGR	Garage	896	0
FOP	Open Porch	772	0
PAT	Patio	300	0
WDK	Wood Deck	764	0
		7,648	3,576

Extra Features

Extra Features					<u>Legend</u>
Code	Description	Size	Value	Assessed Value	Bldg #
WHL	Whirlpool	1.00 UNITS	\$1,620	\$1,130	1

Land

Land Use

Use Code 1010
Description Single Family
Neighborhood 300
Category

Land Line Valuation

Size (Acres) 9
Assessed Value \$60,700
Appraised Value \$86,700

Outbuildings

Outbuildings							<u>Legend</u>
Code	Description	Sub Code	Sub Description	Size	Value	Assessed Value	Bldg #
SPL2	Inground Vinyl Pool			700.00 S.F.	\$6,300	\$4,410	1
PAT2	Patio-Cement			460.00 S.F.	\$690	\$480	1
STB1	Stable			1280.00 S.F.	\$19,200	\$13,440	1
LNT	Lean-To			680.00 S.F.	\$3,400	\$2,380	1

Valuation History

Appraisal			
Valuation Year	Improvements	Land	Total
2023	\$480,580	\$86,700	\$567,280
2022	\$480,580	\$86,700	\$567,280
2021	\$480,580	\$86,700	\$567,280

Assessment			
Valuation Year	Improvements	Land	Total
2023	\$336,400	\$60,700	\$397,100
2022	\$336,400	\$60,700	\$397,100
2021	\$336,400	\$60,700	\$397,100

