

224 EAST RD

Location 224 EAST RD

Mblu 070/ 57/ 019/ /

Acct# 00487500

Owner HAYES SHEILA M

Assessment \$241,470

Appraisal \$344,960

PID 741

Building Count 1

Current Value

Appraisal					
Valuation Year	Building	Extra Features	Outbuildings	Land	Total
2023	\$253,970	\$0	\$0	\$90,990	\$344,960

Assessment					
Valuation Year	Building	Extra Features	Outbuildings	Land	Total
2023	\$177,780	\$0	\$0	\$63,690	\$241,470

Owner of Record

Owner HAYES SHEILA M
Co-Owner
Care Of
Address 224 EAST RD
BROAD BROOK, CT 060160000

Sale Price \$0
Certificate
Book & Page 0320/0471
Sale Date 10/22/2007
Instrument

Ownership History

Ownership History					
Owner	Sale Price	Certificate	Book & Page	Instrument	Sale Date
HAYES SHEILA M	\$0		0320/0471		10/22/2007
MUSKA IRENE W EST OF BORNHORST K	\$0		0312/0484		03/08/2007
MUSKA IRENE W EST OF	\$0		0244/0280		11/05/2002

Building Information

Building 1 : Section 1

Year Built: 1975
Living Area: 2,232

Building Attributes	
Field	Description
Style	Ranch
Model:	Residential
Grade:	C

Stories	1.00
Occupancy	1
Exterior Wall 1	Aluminum Sidng
Exterior Wall 2	
Roof Structure	Gable
Roof Cover	Arch Shingles
Interior Wall 1	Drywall
Interior Wall 2	
Interior Flr 1	Hardwood
Interior Floor 2	Linoleum
Heat Type:	Forced Hot Air
Heat Fuel	Oil
AC Percent	89
Cooling Type	Central
Total Bedrooms:	4 Bedrooms
Full Bthrms:	2
Half Baths:	1
Extra Fixtures	0
Total Rooms:	9
Bath Style	
Kitchen Style	Typical
Extra Kitchens	1
Bsmt Gar(s)	2
SF Fin. Bsmt.	0
Fin Bsmt Qual	
Wood Stoves	0
Fireplace(s)	2
Attic Access	
Finished Area	2232
Above Ground Area	0

Building Photo



(<https://images.vgsi.com/photos/EastWindsorCTPhotos//2554.JPG>)

Building Layout

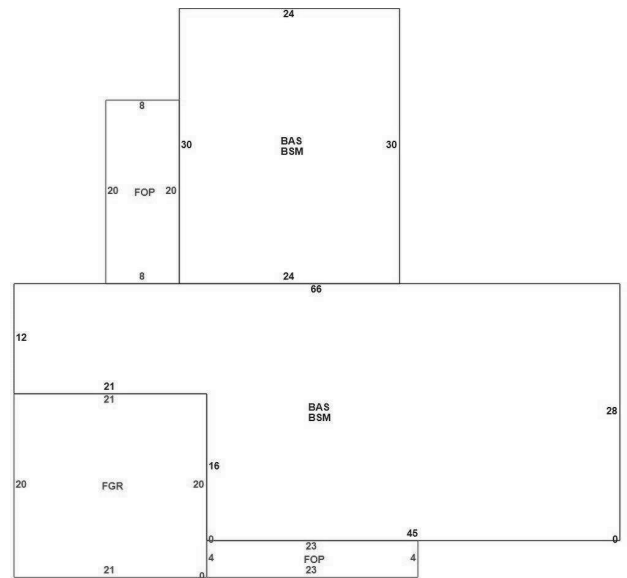

(ParcelSketch.ashx?pid=741&bid=741)

Building Sub-Areas (sq ft)			Legend
Code	Description	Gross Area	Living Area
BAS	First Floor	2,232	2,232
BSM	Basement	2,232	0
FGR	Garage	420	0
FOP	Open Porch	252	0
		5,136	2,232

Extra Features

Extra Features	Legend
No Data for Extra Features	

Land

Land Use

Use Code	101
Description	Single Family

Land Line Valuation

Size (Acres)	1.07
Assessed Value	\$63,690

Zone R-3
Alt Land Appr No
Category

Appraised Value \$90,990

Outbuildings

Outbuildings	<u>Legend</u>
No Data for Outbuildings	

Valuation History

Appraisal					
Valuation Year	Building	Extra Features	Outbuildings	Land	Total
2023	\$253,970	\$0	\$0	\$90,990	\$344,960
2022	\$116,030	\$0	\$0	\$49,930	\$165,960
2021	\$165,760	\$0	\$0	\$71,330	\$237,090

Assessment					
Valuation Year	Building	Extra Features	Outbuildings	Land	Total
2023	\$177,780	\$0	\$0	\$63,690	\$241,470
2022	\$116,030	\$0	\$0	\$49,930	\$165,960
2021	\$116,030	\$0	\$0	\$49,930	\$165,960