



# 224 EAST RD

**Location** 224 EAST RD

**Mblu** 070/ 57/ 019/ /

**Acct#** 00487500

**Owner** HAYES SHEILA M

**Assessment** \$241,470

**Appraisal** \$344,960

**PID** 741

**Building Count** 1

## Current Value

Appraisal					
Valuation Year	Building	Extra Features	Outbuildings	Land	Total
2023	\$253,970	\$0	\$0	\$90,990	\$344,960

Assessment					
Valuation Year	Building	Extra Features	Outbuildings	Land	Total
2023	\$177,780	\$0	\$0	\$63,690	\$241,470

## Owner of Record

**Owner** HAYES SHEILA M

**Sale Price** \$0

**Co-Owner**

**Certificate**

**Care Of**

**Book & Page** 0320/0471

**Address** 224 EAST RD  
BROAD BROOK, CT 060160000

**Sale Date** 10/22/2007

**Instrument**

## Ownership History

Ownership History					
Owner	Sale Price	Certificate	Book & Page	Instrument	Sale Date
HAYES SHEILA M	\$0		0320/0471		10/22/2007
MUSKA IRENE W EST OF BORNHORST K	\$0		0312/0484		03/08/2007
MUSKA IRENE W EST OF	\$0		0244/0280		11/05/2002

## Building Information

### Building 1 : Section 1

**Year Built:** 1975

**Living Area:** 2,232

Building Attributes	
Field	Description
Style	Ranch
Model:	Residential
Grade:	C

Stories	1.00
Occupancy	1
Exterior Wall 1	Aluminum Sidng
Exterior Wall 2	
Roof Structure	Gable
Roof Cover	Arch Shingles
Interior Wall 1	Drywall
Interior Wall 2	
Interior Flr 1	Hardwood
Interior Floor 2	Linoleum
Heat Type:	Forced Hot Air
Heat Fuel	Oil
AC Percent	89
Cooling Type	Central
Total Bedrooms:	4 Bedrooms
Full Bthrms:	2
Half Baths:	1
Extra Fixtures	0
Total Rooms:	9
Bath Style	
Kitchen Style	Typical
Extra Kitchens	1
Bsmt Gar(s)	2
SF Fin, Bsmt.	0
Fin Bsmt Qual	
Wood Stoves	0
Fireplace(s)	2
Attic Access	
Finished Area	2232
Above Ground Area	0

### Building Photo



(<https://images.vgsi.com/photos/EastWindsorCTPhotos//2554.JPG>)

### Building Layout

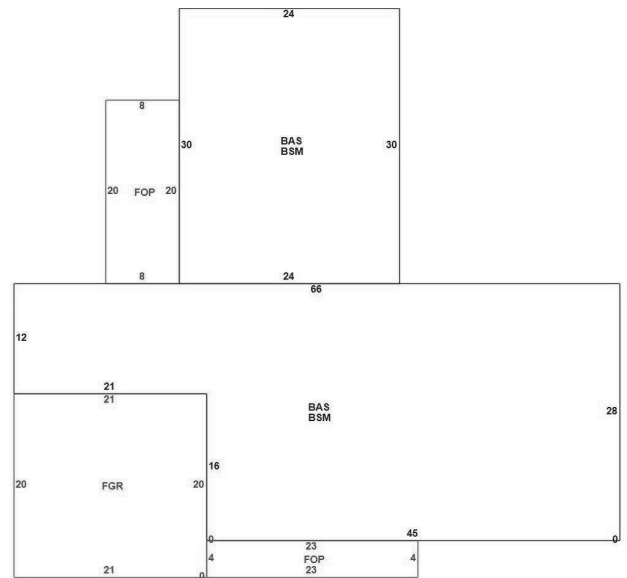

(ParcelSketch.ashx?pid=741&bid=741)

Building Sub-Areas (sq ft)			Legend
Code	Description	Gross Area	Living Area
BAS	First Floor	2,232	2,232
BSM	Basement	2,232	0
FGR	Garage	420	0
FOP	Open Porch	252	0
		5,136	2,232

### Extra Features

Extra Features	Legend
No Data for Extra Features	

### Land

#### Land Use

Use Code	101
Description	Single Family

#### Land Line Valuation

Size (Acres)	1.07
Assessed Value	\$63,690

Zone R-3  
Alt Land Appr No  
Category

Appraised Value \$90,990

**Outbuildings**

Outbuildings	<u>Legend</u>
No Data for Outbuildings	

**Valuation History**

Appraisal					
Valuation Year	Building	Extra Features	Outbuildings	Land	Total
2023	\$253,970	\$0	\$0	\$90,990	\$344,960
2022	\$116,030	\$0	\$0	\$49,930	\$165,960
2021	\$165,760	\$0	\$0	\$71,330	\$237,090

Assessment					
Valuation Year	Building	Extra Features	Outbuildings	Land	Total
2023	\$177,780	\$0	\$0	\$63,690	\$241,470
2022	\$116,030	\$0	\$0	\$49,930	\$165,960
2021	\$116,030	\$0	\$0	\$49,930	\$165,960

## Code/permit/Special assessment Request // 224 EAST ROAD

**From:** Building <building@eastwindsorct.com>  
**Sent:** Thursday, July 18, 2024 7:50 PM  
**To:**  
**Cc:**  
**Subject:** RE: Code/permit/Special assessment Request // 224 EAST ROAD

Good morning,

We have nothing open or pending

Thank you

---

**From:** \_\_\_\_\_  
**Sent:** Thursday, July 18, 2024 10:13 AM  
**To:** Building <building@eastwindsorct.com>  
**Cc:** \_\_\_\_\_  
**Subject:** Code/permit/Special assessment Request // 224 EAST ROAD

Hello ,

We are currently working with closing on this property scheduled and would need the below records verified. Please provide the requested below info at the earliest.

**Address: 224 EAST ROAD BROAD BROOK CT 06016**  
**Parcel: 070/ 57/ 019/ /**  
**Owner: SHEILA HAYES**

---

Please advise if the below address has any OPEN/PENDING/EXPIRED Permits and demolition permits that needs attention and any fees due currently.

Also advise if there are any Code Violation or fines due that needs attention currently.

Any unrecorded liens/fines/special assessments due.