



Property Information Request Information Update Information

File#:	BS-X01693-9840810933	Requested Date:	07/17/2024	Update Requested:
Owner:	LAUREN RENALDI	Branch:		Requested By:
Address 1:	33 LAUREL DR	Date Completed:		Update Completed:
Address 2:		# of Jurisdiction(s):		
City, State Zip:	MONTVILLE, CT	# of Parcel(s):	1	

Notes

CODE VIOLATIONS Per Town of Montville Zoning Department There are no open/active violation on this property.

Collector: Town of Montville
Address: 310 Norwich-New London Turnpike, Uncasville, CT 06382
Business: 860-848-6782

UNABLE TO PROVIDE DOCUMENTATION TO THIRD PARTIES. VERBAL INFO ACQUIRED

PERMITS Per Town of Montville Building Department there are no Open/Pending/ Expired Permit on this property.

Collector: Town of Montville
Address:310 Norwich-New London Turnpike, Uncasville, CT 06382
Business:860-848-6782

UNABLE TO PROVIDE DOCUMENTATION TO THIRD PARTIES. VERBAL INFO ACQUIRED

SPECIAL ASSESSMENTS Per Town of Montville Tax Collector there are no Special Assessments/liens on the property.

Collector: Town of Montville
Address:310 Norwich-New London Turnpike Uncasville, CT 06382
Business:860) 848-6775

UNABLE TO PROVIDE DOCUMENTATION TO THIRD PARTIES. VERBAL INFO ACQUIRED

DEMOLITION NO

UTILITIES WATER AND SEWER
THE HOUSE IS ON A COMMUNITY WATER & SEWER. ALL HOUSES GO TO A SHARED WELL & SEPTIC SYSTEM.

GARBAGE
GARBAGE PRIVATE HAULER WITH LIEN STATUS AND BALANCE UNKNOWN



Property Card: 33 LAUREL POINT DR Unit B

Town of Montville, CT

Parcel Information

Location:	33 LAUREL POINT DR Unit B	Property Use:	Residential	Primary Use:	Residential
Unique ID:	K0620400	Map Block Lot:	105-032-000	Acres:	0.27
		Zone:	R80	Volume / Page:	0278/0821
		Sale Date:	06/22/1995	Sale Price:	\$10,000

Value Information

	Appraised Value	Assessed Value
Land	39600	27720
Buildings	115800	81060
Detached Outbuildings	0	0
Total	155400	108780

Owner's Information

Owner's Data
RENALDI LAUREN D & MARY A 44 LAUREL POINT DR OAKDALE, CT 06370

Building 1

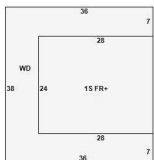

Category:	Residential	Siding:	Vinyl Siding	Total Rooms:	4
Stories:	1.00	Fuel:	Oil	Beds/Units:	2
GLA:	672	Heating:	Forced Hot Air	Baths:	1
Year Built:	1967	Fireplace:	0		
Class:	C	Cooling Percent:	None	Half Baths:	0
Use:	Single Family	Floors:	Hardwood	Basement Garage:	0
Construction Style:	Ranch	Roof Material:	Asphalt	Finished Basement:	300