



Property Information

File#: BS-W01469-1012483161
Owner: PAULA DORSET
Address 1: 2431 S Bradford St
Address 2:
City, State Zip: Allentown, PA

Request Information

Requested Date: 10/25/2023
Branch:
Date Completed:
of Jurisdiction(s):
of Parcel(s): 1

Update Information

Update Requested:
Requested By:
Update Completed:

Notes

- CODE VIOLATIONS** Per Salisbury Township Department of Zoning there are no Code Violation cases on this property.
Collector: Salisbury Township
Payable Address: 2900 South Pike Avenue, Allentown, PA 18103
Business# 610) 797-4000
- PERMITS** Per Salisbury Township Department of Building there are no Open/ Pending/ Expired Permit on this property.
Collector: Salisbury Township
Payable Address: 2900 South Pike Avenue, Allentown, PA 18103
Business# 610) 797-4000
- SPECIAL ASSESSMENTS** Per Salisbury Township Department of Finance there are no Special Assessments/liens on the property.
Collector: Salisbury Township
Payable Address: 2900 South Pike Avenue, Allentown, PA 18103
Business# 610) 797-4000
- DEMOLITION** NO
- UTILITIES** **Water, Sewer and Garbage:**
Account #: 10002401
Payment Status: DELINQUENT
Status: Pvt & Non-Lienable
Amount: \$92.96
Good Thru: 11/20/2023
Account Active: YES
Collector: Salisbury Township Municipal Building
Payable Address: 2900 S Pike Ave, Allentown, PA 18103
Business # 610-797-4000
- UNABLE TO PROVIDE DOCUMENTATION TO THIRD PARTIES. VERBAL INFO ACQUIRED.

County of Lehigh Online Records Access
Property Details

Street View



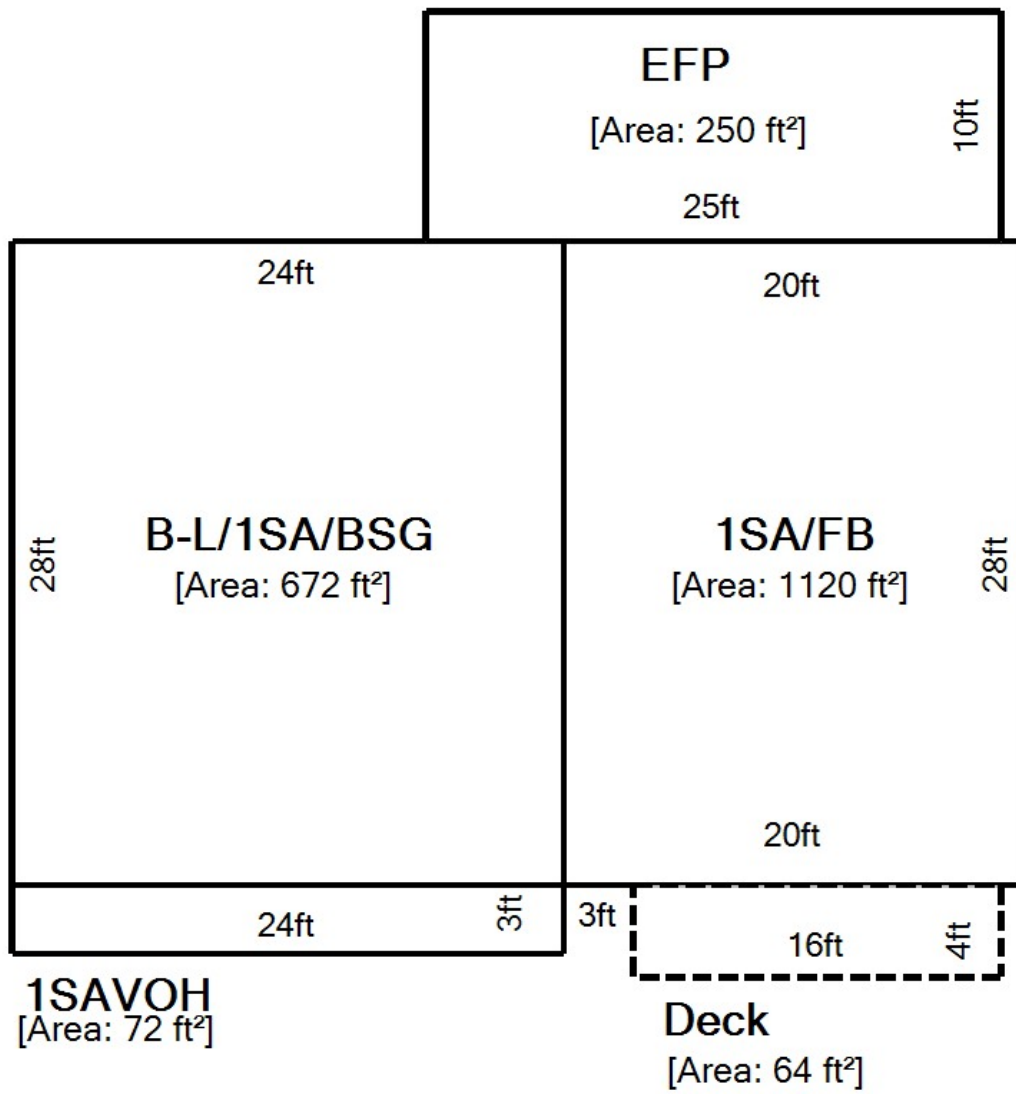

Property Overview

| 2023 | | | | | | | | | | | | | | | | |
|------------------------------|--|-----------------|-------|-----------------|--------|--------------|-----------|------------------|-----------|-------------|--------------|---------------|-----------|-------|--|-------------|
| Owner Name | DORSET PAULA & KENYATTE A THOMAS JR | | | | | | | | | | | | | | | |
| Owner Address | 2431 S BRADFORD ST ALLENTOWN PA 18103-5821 | | | | | | | | | | | | | | | |
| Property Address | 2431 S BRADFORD ST ALLENTOWN PA 18103 | | | | | | | | | | | | | | | |
| Parcel Viewer | View in Parcel Viewer | | | | | | | | | | | | | | | |
| Low Number | 2431 | | | | | | | | | | | | | | | |
| High Number | 2431 | | | | | | | | | | | | | | | |
| Sub Division | GREENLEAF HEIGHTS | | | | | | | | | | | | | | | |
| Tax Authority | SALISBURY TOWNSHIP | | | | | | | | | | | | | | | |
| School District | SALISBURY SCHOOL DISTRICT | | | | | | | | | | | | | | | |
| Parcel Id | 640681414529 1 | | | | | | | | | | | | | | | |
| Old Parcel Id | 17 03 H10SW3D 001 030 | | | | | | | | | | | | | | | |
| Tile | 466016C | | | | | | | | | | | | | | | |
| Acres/Dimension | 79 X 130 | | | | | | | | | | | | | | | |
| Lot Sq Ft | 10270 | | | | | | | | | | | | | | | |
| Utilities | PUBLIC WATER/SEWER | | | | | | | | | | | | | | | |
| Class | RESIDENTIAL | | | | | | | | | | | | | | | |
| Land Use | SINGLE FAMILY - DETACHED | | | | | | | | | | | | | | | |
| Living Units | 1 | | | | | | | | | | | | | | | |
| Zoning | R3 | | | | | | | | | | | | | | | |
| Homestead Act 72 | Application Approved and Enrolled - 02/22/2017 | | | | | | | | | | | | | | | |
| Preferential Land Act | NO | | | | | | | | | | | | | | | |
| Agricultural Easement | NO | | | | | | | | | | | | | | | |
| Assessment Base Year | 2013 | | | | | | | | | | | | | | | |
| Total Assessment | <table border="1"> <tbody> <tr> <td>Exempt Land</td> <td>0</td> </tr> <tr> <td>Exempt Building</td> <td>0</td> </tr> <tr> <td>Taxable Land</td> <td>34,100</td> </tr> <tr> <td>Taxable Building</td> <td>160,900</td> </tr> <tr> <td>Total</td> <td>195,000</td> </tr> <tr> <td>Taxable Total</td> <td>195,000</td> </tr> </tbody> </table> | Exempt Land | 0 | Exempt Building | 0 | Taxable Land | 34,100 | Taxable Building | 160,900 | Total | 195,000 | Taxable Total | 195,000 | | | |
| Exempt Land | 0 | | | | | | | | | | | | | | | |
| Exempt Building | 0 | | | | | | | | | | | | | | | |
| Taxable Land | 34,100 | | | | | | | | | | | | | | | |
| Taxable Building | 160,900 | | | | | | | | | | | | | | | |
| Total | 195,000 | | | | | | | | | | | | | | | |
| Taxable Total | 195,000 | | | | | | | | | | | | | | | |
| Estimated Taxes | <table border="1"> <thead> <tr> <th></th> <th>Mills</th> <th>Estimated Taxes</th> </tr> </thead> <tbody> <tr> <td>County</td> <td>3.780000</td> <td>\$ 737.10</td> </tr> <tr> <td>School</td> <td>22.739700</td> <td>\$ 4,434.24</td> </tr> <tr> <td>Municipality</td> <td>2.920000</td> <td>\$ 569.40</td> </tr> <tr> <td>Total</td> <td></td> <td>\$ 5,740.74</td> </tr> </tbody> </table> <p>Tax calculations do not reflect any reduction received due to enrollment in Homestead Act 72</p> | | Mills | Estimated Taxes | County | 3.780000 | \$ 737.10 | School | 22.739700 | \$ 4,434.24 | Municipality | 2.920000 | \$ 569.40 | Total | | \$ 5,740.74 |
| | Mills | Estimated Taxes | | | | | | | | | | | | | | |
| County | 3.780000 | \$ 737.10 | | | | | | | | | | | | | | |
| School | 22.739700 | \$ 4,434.24 | | | | | | | | | | | | | | |
| Municipality | 2.920000 | \$ 569.40 | | | | | | | | | | | | | | |
| Total | | \$ 5,740.74 | | | | | | | | | | | | | | |
| Bill Number | 170301232 | | | | | | | | | | | | | | | |
| LC_PropertyAddress | 2431 S BRADFORD ST ALLENTOWN PA 18103 | | | | | | | | | | | | | | | |

Basic Residential Profile

| | |
|--------------------------|--------------------------|
| Type of Residence | SINGLE FAMILY - DETACHED |
|--------------------------|--------------------------|

| | |
|---------------------------------|----------------------|
| Number of Stories | BI-LEVEL |
| Type of Construction | ALUMINIUM/VINYL |
| Type of Basement | FULL |
| Type of Heating/Cooling | BASE |
| Type of Garage | BASE TWO CAR OR MORE |
| Number of Full Bathrooms | 1 |
| Number of Half Bathrooms | 1 |
| Fireplaces | 0 |
| Square Feet | 1864 |
| Year Built | 1979 |
| Pool | INGROUND POOL |
| Implement Buildings | NO IMPLEMENT BLDG |

Residential Profile Data With No Influence on Assessment Value

| | |
|---------------------------|---|
| Total Rooms | 7 |
| Number of Bedrooms | 3 |
| Family Rooms | 1 |

Sales History

| Sale Date | Owner Name | Document Id | Sale Price |
|------------------|-------------------------------------|--------------------|-------------------|
| 11/2016 | DORSET PAULA & KENYATTE A THOMAS JR | 2016033432 | \$ 250,000 |
| 02/2003 | KESTER GAIL L | 7063950 | \$ 1 |
| 02/1979 | KESTER BARRY R & GAIL L | 1261/0439 | \$ 57,790 |

The building sketch represents the actual exterior measurement of the structure as measured from the outside. The sketch will show any attached areas and will be labeled with a descriptive code. Measurements are rounded to the nearest foot. Certain sketch dimensions and angles are drawn in approximation to their actual measurements.

The total square-foot area includes only the assessed living area of a residential structure, generally areas that are heated and/or cooled. Living area does not include porches, decks, patios, or garages.

Some of the common abbreviations are listed below for reference:

| BUILDING STYLE | |
|----------------|-------------|
| CODE | DESCRIPTION |
| 1S | 1 STORY |
| 1.5S | 1½ STORY |
| 2S | 2 STORY |
| 2.5S | 2½ STORY |
| 3S | 3 STORY |
| 3.5S | 3½ STORY |
| B-L | BI-LEVEL |
| S-L | SPLIT-LEVEL |

| EXTERIOR | |
|----------|-------------------|
| CODE | DESCRIPTION |
| AV, A, V | ALUMINUM OR VINYL |
| B | BRICK |
| B&F | BRICK & FRAME |
| BFR | BRICK FRONT |
| BTR | BRICK TRIM |
| C | CONCRETE |
| CB | CONCRETE BLOCK |
| F, FR | FRAME |
| ST | STONE |
| SD | STUCCO OR DRYVIT |
| MTL | METAL |
| GL | GLASS |

| CODE | DESCRIPTION | CODE | DESCRIPTION |
|------|------------------------|-------|---------------------|
| A | ATTIC | IGP | INGROUND POOL |
| BAL | BALCONY | LD | LOADING DOCK |
| B | BASEMENT | MP | MASONRY PATIO |
| BAY | BAY | MS | MASONRY SLAB |
| BSG | BASEMENT GARAGE | NB | NO BASEMENT |
| BW | BREEZEWAY | NA | NOT ADDED |
| BLT | BUILT | NI | NOT INCLUDED |
| CP | CARPORT | OFF | OPEN FRAME PORCH |
| CPY | CANOPY | OMP | OPEN MASONRY PORCH |
| CC | CATHEDRAL CEILING | OH | OVERHANG |
| CRLS | CRAWL SPACE | PB | PART BASEMENT |
| DECK | DECK | PW | PARTY WALL |
| EFP | ENCLOSED FRAME PORCH | RECRM | RECREATION ROOM |
| EMP | ENCLOSED MASONRY PORCH | S | SHED |
| FB | FINISHED BASEMENT | SQFT | SQUARE FOOT |
| FDN | FOUNDATION | STRG | STORAGE |
| G | GARAGE | UFB | UNFINISHED BASEMENT |
| GH | GREENHOUSE | WD | DECK |

EXAMPLE SKETCH

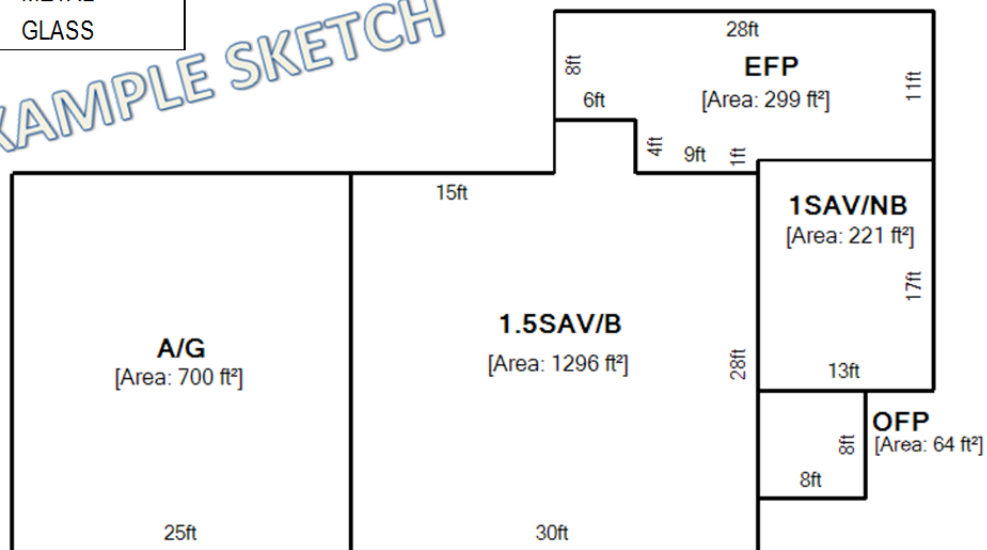

Information on this site is used for tax assessment purposes only and is subject to change without prior notice. The County of Lehigh Assessment Office assumes no responsibility for the use of the information for any other purpose. The use of information for any other purpose other than for tax assessment purposes is the sole and exclusive responsibility of the individual or entity using the information.



Township of Salisbury

LEHIGH COUNTY, PA

Cathy Bonaskiewich
Township Manager
2900 South Pike Avenue
Allentown, PA 18103
P: 610-797-4000 F: 610-797-5516

November 6, 2023

RE: RIGHT-TO-KNOW REQUEST

Thank you for writing to Salisbury Township with your request for information pursuant to the Pennsylvania Right-To-Know Law ("RTKL"), 65 P.S. 67.101, *et. seq.* On October 30, 2023, the Township received your request for copies of the following records:

Address: 2431 S Bradford St, Allentown, PA 18103

Parcel: 640681414529 1

Owner: PAULA DORSET

- 1. Please advise if the below address has any OPEN/PENDING/EXPIRED Permits and demolition permits that need attention and any fees due currently.**
- 2. Also advise if there are any open Code Violation or fines due that needs attention currently.**
- 3. Advise if there are any unrecorded liens/fines/special assessments due.**

Your request is denied, as follows. Salisbury Township does not possess records of OPEN/PENDING/EXPIRED Permits and demolition permits that need attention and any fees due currently; any open Code Violation or fines due that needs attention currently; and any unrecorded liens/fines/special assessments due with respect to 2431 S Bradford St, Allentown, PA 18103.

You have a right to appeal this denial in writing to: Office of Open Records, 333 Market St., 16th Floor, Harrisburg, PA 17101-2234. Appeals can also be filed online at the Office of Open Records website, <https://www.openrecords.pa.gov>.

If you choose to file an appeal you must do so within 15 business days of the mailing date of the agency's response. See 65 P.S. § 67.1101. Please note that a copy of your original Right-to-Know request and this denial letter must be included when filing an appeal. More information about how to file an appeal under the RTKL is available at the Office of Open Records website, <https://www.openrecords.pa.gov>.

Please be advised that this correspondence will serve to close this record with our office as permitted by law.

Sincerely,

A handwritten signature in blue ink that reads "Cathy Bonaskiewich".

Cathy Bonaskiewich
Township Manager/
Open Records Officer
/srw