



**Property Information                      Request Information                      Update Information**

File#:                      BS-X01693-806290368  
Owner:                      WILLIAM HERTELLO  
Address 1:                      10 HARRISON RD  
Address 2:  
City, State Zip: CANTON, MA

Requested Date:                      07/17/2024  
Branch:  
Date Completed:  
# of Jurisdiction(s):  
# of Parcel(s):                      1

Update Requested:  
Requested By:  
Update Completed:

**Notes**

CODE VIOLATIONS                      Per Town of Canton Department of Zoning there are no Code Violation cases on this property.

Collector: Town of Canton  
Payable:801 Washington St, Canton, MA 02021  
Business# 781-821-5003

UNABLE TO PROVIDE DOCUMENTATION TO THIRD PARTIES. VERBAL INFO ACQUIRED

PERMITS                      Per Town of Canton Building Department There is an open permit on this property

1. Permit#: 53427  
Permit: Roofing/Siding/Windows

Collector: Town of Canton  
Payable:801 Washington St, Canton, MA 02021  
Business# 781-821-5003

SPECIAL ASSESSMENTS                      Per Town of Canton Tax Collector there is an Sewer lien on the property please cotact town of canton tax collector for more information.

Collector: Town of Canton  
Payable:801 Washington St, Canton, MA 02021  
Business# 781-821-5006

UNABLE TO PROVIDE DOCUMENTATION TO THIRD PARTIES. VERBAL INFO ACQUIRED

DEMOLITION                      NO



UTILITIES

WATER & SEWER

Account #: 014179000

Payment Status: Due

Status: Pvt & Lienable

Amount: \$226.59

Good Thru: 08/30/2024

Account Active: Yes

Collector: Town of Canton water and Sewer

Payable Address: 801 Washington Street Canton, MA 02021

Business # 781-821-5017

UNABLE TO PROVIDE DOCUMENTATION TO THIRD PARTIES. VERBAL INFO ACQUIRED

GARBAGE

GARBAGE PRIVATE HAULER WITH LIEN STATUS AND BALANCE UNKNOWN

Key: 4392

Town of Canton - Fiscal Year 2024

12/20/2023 3:22 pm SEQ #: 3,984

LEG  
AL

CURRENT OWNER				PARCEL ID				LOCATION				
HERTELLO, WILLIAM M & PAULA M				95-5				10 HARRISON RD				
10 HARRISON RD				TRANSFER HISTORY				DOS	T	SALE PRICE	BK-PG (Cert)	
CANTON, MA 02021				HERTELLO, WILLIAM M & PAU				01/24/2013	O	402,500	30955-347	
				YENSER THOMAS & THERESA					QS		3772-586	

CLASS	CLASS%	DESCRIPTION		BN ID	BN	CARD	
1010	100	SINGLE FAMILY			1	1 of 1	
PMT NO	PMT DT	TY	DESC	AMOUNT	INSP	BY	1st %
360	04/24/2019	3	ALTERATIONS	40,407	08/28/2019	KZ	100 100
826	08/24/2018	3	ALTERATIONS	4,248	06/03/2019	CF	100 100
1182	10/26/2015	3	ALTERATIONS	79,010	05/12/2016	CF	100 100
85	02/11/2015	3	ALTERATIONS	10,000	08/07/2015	CF	100 100
419	06/09/2014	3	ALTERATIONS	25,000	08/05/2014	CF	100 100

LAN  
D

CD	T	AC/SF/UN	Ngh	Infl-1	Infl-2	ADJ BASE	SAF	Topo	Lpi	VC	CREDIT AMT	ADJ VALUE
100	S	30,150	2	1.00	1.00	336,600	1.40	100	1.00	9	1.10	326,240

DET  
ACHED

TOTAL	30,150 SF	ZONING	10	FRNT	0	ASSESSED	CURRENT	PREVIOUS
Ngh	2	NOTE LOT 22 BK204 PL830 - Plot Plan	LAND			326,200	326,200	
Infl-1	FACTOR 100		BUILDING			354,600	310,700	
Infl-2	PHY 100		DETACHED			23,700	22,700	
			OTHER			0	0	
		TOTAL				704,500	659,600	

TY	QUAL	COND	DIM/NOTE	YB	UNITS	ADJ PRICE	RCNLD
SHF	A	1.00	40 0.60 8X18		144	13.19	1,100
IPG	A	1.00	10 0.90 31X15	2014	465	54.10	22,600



BUILDING	CD	ADJ	DESC	MEASURE	12/2/2009	MR
MODEL	1		RESIDENTIAL	LIST	12/2/2009	MR
STYLE	3	1.00	SPLIT LEVEL [100%]	REVIEW	1/12/2010	KC
QUALITY	+	1.20	AVG +GOOD - [100%]			
FRAME	1	1.00	WOOD FRAME [100%]			

BLDG COMMENTS

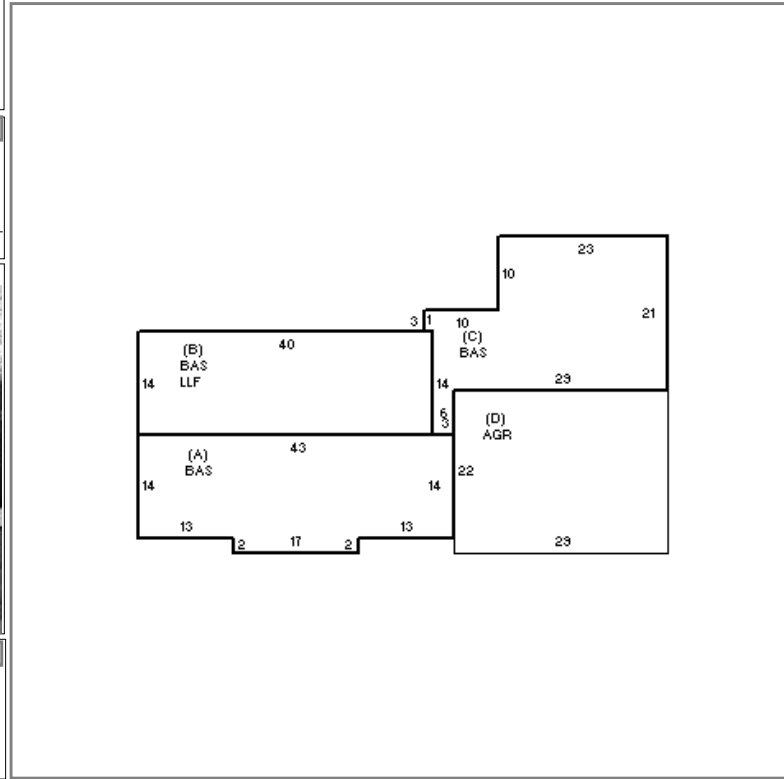

BU  
ILD  
ING

YEAR BLT	1959	SIZE ADJ	1.000	ELEMENT	CD	DESCRIPTION	ADJ	S	BAT	T	DESCRIPTION	UNITS	YB	ADJ PRICE	RCN	TOTAL RCN	571,979			
NET AREA	2,359	DETAIL ADJ	1.030	FOUNDATION	4	CONT BSMT WALL	1.00	+	BAS	L	BASE AREA	1,799	1959	239.13	430,195	CONDITION ELEM CD				
\$NLA(RCN)	\$242	OVERALL	1.000	EXT COVER	1	WD SHINGLES	1.00	B	LLF	L	LOWER LEVEL FIN	560		173.42	97,115	EXTERIOR	G			
				ROOF SHAPE	1	GABLE	1.00	D	AGR	N	ATT GARAGE	638		48.81	31,144	INTERIOR	A			
				ROOF COVER	1	ASPH SHINGLES	1.00		F11	O	FPL 1S 1OP	1		8,581.20	8,581	KITCHEN	A			
				FLOOR COVER	3	W/W CARPET	1.00											BATHS	A	
				INT FINISH	2	DRYWALL	1.00											HEAT	U	
				HEATING/COOLING	9	WARM/COOL AIR	1.03											ELECT	A	
				FUEL SOURCE	2	GAS	1.00											EFF.YR/AGE 1967 / 55		
																	COND	38	38 %	
																	FUNC	0		
																	ECON	0		
																	DEPR	38	% GD 62	
																	RCNLD	\$354,600		

Building Permit

# 53427

**Applicant**

**Location**

**10 HARRISON RD**

Canton, MA 02021

[View location details \(/locations/24943\)](/locations/24943)

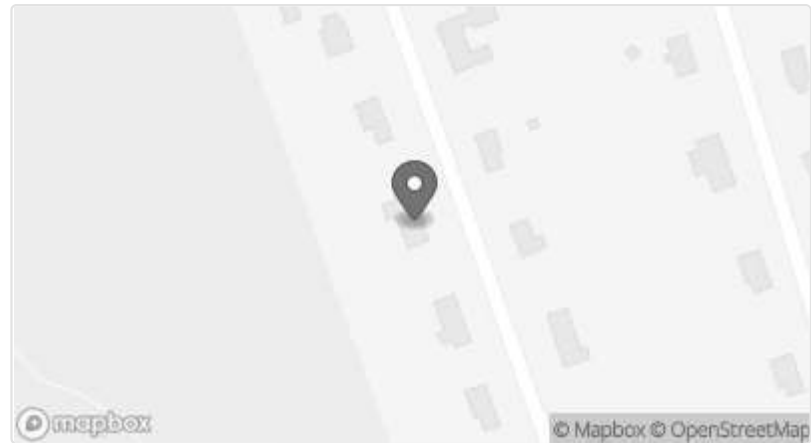

Created	Status	Expires
Apr 23, 2019	Active	Apr 24, 2020

**Details**   **Files (0)**

**Additional Applicant Info**

**Applicant Type**

--

**Documents**

**Permit/License Document**

Issued Jun 29, 2020

**Permit Info**

**Project Cost \***

40,407

**Permit For \***

Roofing/Siding/Windows

**Work Description \***

REPLACE 24 WINDOWS - NO STRUCTURAL CHANGES

**Building Type \***

Single Family

**Occupancy Type \***

Residential

**Sewage Disposal System**

Municipal

**Homeowners Name \***

--

**Homeowners Phone \***

--

**Homeowners Email**

--

**Contractors (Authorized Agent) Name \***

--

**Contractors (Authorized Agent) Phone \***

--

**Contractors (Authorized Agent) Email**

--

**Development Title**

--

**# of Temporary Structures**

--

**Water Type**

Public

---

**Setbacks**

---

**Contractors**

Name	Address	City	+ 20 Additional Fields
RENEWAL BY ANDERSON LLC.	30 FORBES RD NORTHBOROUGH MA 01532	--	...
JAIME L MORIN	--	LYNN	...

**Building  
Height & Area**

**Stories (Existing)**

0

**Stories (Proposed)**

0

**Bedrooms (Existing)**

0

**Bedrooms (Proposed)**

0

**Bathrooms (Existing)**

0

**Bathrooms (Proposed)**

0

**Lot Size (Existing)**

0

**Lot Size (Proposed)**

0

**Foundation Size (Existing)  
Area**

0

**Foundation Size (Proposed)  
Area**

0

**Foundation Thickness  
(Existing)**

0

**Foundation Thickness  
(Proposed)**

0

**Foundation Depth (Existing)**

0

**Foundation Depth  
(Proposed)**

0

**Foundation Type (Existing)**

--

**Foundation Type (Proposed)**

--

**Wall Material (Existing)**

--

**Wall Material (Proposed)**

--

**Units (Existing)**

0

**Units (Proposed)**

0

**Structure Height (Existing)**

0

**Structure Height**

**(Proposed)**

0

**Structure Width (Existing)**

0

**Structure Width (Proposed)**

0

**Structure Length (Existing)**

0

**Structure Length**

**(Proposed)**

0

**Garage Type**

--

**Cellar Area (Existing)**

0

---

**Additional  
Building Info**

**Non Habitable Area**

--

**Front Lot Line Width**

0.00

**Rear Lot Line Width**

0.00

**Lot Depth**

0.00

**House Style**

--

**Half Baths**

0

**Distance on Center**

--

**Deck**

--



**Porch**

--

**Pool**

--

**Pool Size**

--

**Pool Above Ground**

**Pool Distance From Front**

0.00

**Pool Distance From Rear**

0.00

**Pool Distance From Left**

0.00

**Pool Distance From Right**

0.00

**Windows**

0

**Doors**

0

**Stairways**

0

**Stairs Location**

--

**Finished Basement**

--

**Finished Attic**

--

**Elevator**

**Floor Timbers 1st Floor**

--

**Floor Timbers 2nd Floor**

--

**Floor Timbers 3rd Floor**

--

**Floor Timbers 4th Floor**

--

**Floor Timbers 5th Floor**

--

**Rooms 1st Floor**

0

**Rooms 2nd Floor**

0

**Rooms 3rd Floor**

--

**Rooms Above 3rd Floor**

--

**Floor Type Basement**

--

**Floor Type 1st Floor**

--

**Floor Type 2nd Floor**

--

**Floor Type 3rd Floor**

--

**Internal Finish Basement**

--

**Internal Finish 1st Floor**

--

**Internal Finish 2nd Floor**

--

**Finished Flooring 1st Floor**

**Finished Flooring 2nd Floor**

**Finished Flooring 3rd Floor**

**Completed Energy Report**

**Wall Covering**

--

**Heating**

--

**Heating System**

--

**Central Air**

**Span**

--

**Insulation Values**

--

**Insulation Blanket**

--

**Insulation Roof Ceiling**

--

**Roof Type**

--

**Roof Layers**

0

**Chimney / Fireplace**

0

**Fireplace Type**

--

**Fire Sprinklers**

--

**Frame Type**

--

**Tile Type**

--

**Fence Material**

--

**Siding Material**

--

**Lawn Sprinklered**

**Size of Skills**

--

**Distance Between Buildings**

--

**Carrying Partitions**

--

**Debris Location**

--

**Asbestos**

**Asbestos Removal Firm**

--

**Asbestos Removal Firm  
Address**

--

**Signs**

0

**Sign Length**

0.00

**Sign Width**

0.00

**Sign Height**

0.00

---

**Construction  
Type**

**Construction Type**

VB: Other, No Fire Ratings

**Plan Number**

--

**Occupant Load**

0

**ZBA Code**

--

---

**Engineer  
Information**

**Company Name**

--

**Engineer Name**

--

**Registration #**

--

**Insurance Expiration**

--

**Address**

--

**City**

--

**State**

--

**Zip**

--

**Phone**

--

**AOR**

--

**Email**

--

---

**Architect  
Information**

**Company Name**

--

**Architect Name**

--

**Registration #**

--

**License Expiration**

--

**Address**

**City**

--

--

State

Zip

--

--

Phone

Email

--

--

AOR

--

---

Insurance  
Coverage

I have a liability insurance policy or its substantial equivalent 

Yes

Other Coverage

--

---

Roofing/Siding/Windows

---

Acknowledgement

Signature of Applicant \*

--

I agree that my electronic signature above is equivalent to a handwritten signature and is binding for all purposes related to this transaction. \*

--

---

---

**Town of Canton, MA**

**Your Profile**

Sign Up (</sign-up>)

Your Records  
(</dashboard/records>)

**Resources**

Search for Records  
(</search>)

Claim a Record  
(</claimRecord>)

Employee Login  
(<https://cantonma.workflow.open>)