



Property Information

Request Information

Update Information

File#:	BS-X01693-8441101015	Requested Date:	07/17/2024	Update Requested:
Owner:	MARY MCLAUGHLIN	Branch:		Requested By:
Address 1:	473 MIDDLE ST	Date Completed:		Update Completed:
Address 2:		# of Jurisdiction(s):		
City, State Zip:	BRAINTREE, MA	# of Parcel(s):	1	

Notes

CODE VIOLATIONS Per Town of Braintree Department of Zoning there are no Code Violation cases on this property.
Collector:Town of Braintree
Address: 1 John F. Kennedy Memorial Drive Braintree, MA 02184
Business: (781)-794-8095

PERMITS Per Town of Braintree Building Department there are no Open/Pending/ Expired Permit on this property.
Collector:Town of Braintree
Address: 1 John F. Kennedy Memorial Drive Braintree, MA 02184
Business: (781)-794-8095

SPECIAL ASSESSMENTS Per Town of Braintree Tax Collector there are no Special Assessments/liens on the property.
Collector: Town of Braintree
Address: 1 John F. Kennedy Memorial Drive Braintree, MA 02184
Business: 781-794-8130

UNABLE TO PROVIDE DOCUMENTATION TO THIRD PARTIES. VERBAL INFO ACQUIRED

DEMOLITION NO

UTILITIES WATER, SEWER & TRASH
Account #: NA
Payment Status: NA
Status: Pvt & Liable
Amount: NA
Good Thru: NA
Account Active: NA
Collector: Braintree Water and Sewer Department
Payable Address: 85 Quincy Ave, Braintree, MA 02184
Business # 781-843-8097

UNABLE TO PROVIDE INFO TO THIRD PARTIES. HOMEOWNER AUTHORIZATION NEEDED.



Card 1 of 1

Location 473 MIDDLE ST	Property Account Number	Parcel ID 1001 0 21
-------------------------------	-------------------------	----------------------------

Old Parcel ID --

Current Property Mailing Address

Owner MCLAUGHLIN MARY Address 473 MIDDLE STREET	City BRAINTREE State MA Zip 02184 Zoning B
--	---

Current Property Sales Information

Sale Date 8/19/2005 Sale Price 1	Legal Reference 22795-518 Grantor(Seller) MCLAUGHLIN MARY TRUSTEE,
---	---

Current Property Assessment

Year 2024 Land Area 0.193 acres	<u>Card 1 Value</u> Building Value 208,400 Xtra Features Value 0 Land Value 284,600 Total Value 493,000
--	--

Narrative Description

This property contains 0.193 acres of land mainly classified as ONE FAM with a(n) SPLIT LEVL style building, built about 1954 , having VINYL exterior and ASPHALT roof cover, with 1 unit(s), 5 total room(s), 3 total bedroom(s), 1 total bath(s), 1 total half bath(s), 0 total 3/4 bath(s).

Legal Description

Click Property Images to Enlarge

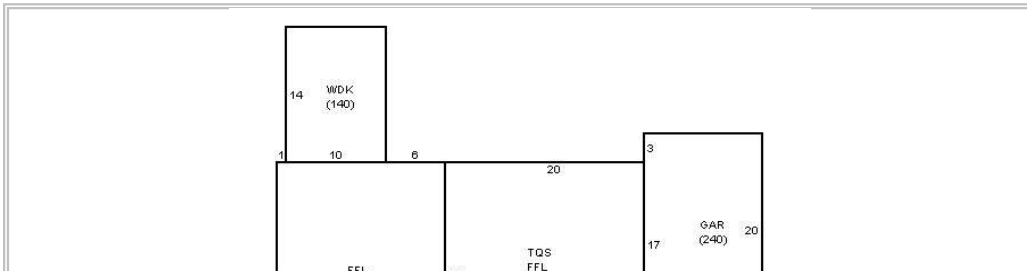

Request# 2024-1761 : Response to your Request

From: foiairect@townforms.com <foiairect@townforms.com>

Sent:

To:

Cc: mmcgrath@braintreema.gov; jmcasey@braintreema.gov

Subject: Request# 2024-1761 : Response to your Request

Town of Braintree, MA

Public Record Request Number:2024-1761

Requester:

Request Date:

Response Due Date: **Friday, September 6, 2024**

Dear

We have completed the work in reference to your request as referenced above. The response is given below

Request Response

A review of the Building Division file for the requested property has been conducted. No open/pending/expired permits were observed on file. No code violations observed on file.

Attachments

This response may or may not contain separate Response Documents to include specific response and data. In case such separate response documents exist, they are represented by attachments to this response email. Therefore, please look for any attachments if they exist. Between Request Response and attachments, we believe you are receiving a comprehensive response to your request.

If you have any questions or comments, please do not hesitate to contact us at the following email address.

Thank you.

Marybeth McGrath, RAO

Building/Health Department

Town of Braintree

1 John F. Kennedy Memorial Drive

Braintree, MA 02184

Tel: (781)-794-8095

Email: mmcgrath@braintreema.gov