

36 GOSHEN HILL RD

Location 36 GOSHEN HILL RD

Mblu 246 / / 45.001 / /

Acct# 04246451

Owner MCKUSICK DEAN P

Assessment \$305,510

PID 184424

Building Count 1

Current Value

Assessment			
Valuation Year	Improvements	Land	Total
2024	\$272,240	\$33,270	\$305,510

Owner of Record

Owner MCKUSICK DEAN P
Co-Owner
Address 36 GOSHEN HILL RD
LEBANON, CT 06249

Sale Price \$195,900
Certificate
Book & Page 0306/0215
Sale Date 12/21/2017
Instrument 14

Ownership History

Ownership History					
Owner	Sale Price	Certificate	Book & Page	Instrument	Sale Date
MCKUSICK DEAN P	\$195,900		0306/0215	14	12/21/2017
SI REALTY COMPANY INC	\$0		0304/0749	31	09/07/2017
NOWOSAD JAMES F & GENEVIEVE M	\$0		0234/0965	29	09/09/2005
NOWOSAD JAMES F	\$0		0233/0712	29	07/21/2005

Building Information

Building 1 : Section 1

Year Built: 2006
Living Area: 2,040
Replacement Cost: \$457,553
Building Percent Good: 85
Replacement Cost
Less Depreciation: \$388,920

Building Attributes	
Field	Description
Style:	Modern/Contemp
Model	Residential
Grade:	Average+

Stories:	2
Occupancy	1
Exterior Wall 1	Vinyl Siding
Exterior Wall 2	
Roof Structure:	Gable/Hip
Roof Cover	Asphlt/Architc
Interior Wall 1	Drywall/Sheet
Interior Wall 2	
Interior Flr 1	Hardwood
Interior Flr 2	Carpet
Heat Fuel	Geothermal
Heat Type:	Forced Air
AC Type:	Central
Total Bedrooms:	3 Bedrooms
Total Bthrms:	2
Total Half Baths:	1
Total Xtra Fixtrs:	2
Total Rooms:	8 Rooms
Bath Style:	Modern
Kitchen Style:	Average
Kitchens	1
Insulated	Yes
Usrflid 103	
Usrflid 104	
Usrflid 105	
Usrflid 106	
Usrflid 107	
Num Park	
Fireplaces	1
Gas Fireplaces	
Usrflid 101	
Usrflid 102	
Usrflid 100	
Usrflid 300	
Usrflid 301	
Usrflid 302	
Usrflid 304	
Fndtn Cndtn	
Basement	
Usrflid 701	
Usrflid 305	
Usrflid 900	No
Usrflid 901	No
Usrflid 303	
Usrflid 706	

Building Photo



(<https://images.vgsi.com/photos/LebanonCTPhotos/\00\01\23\83.jpg>)

Building Layout

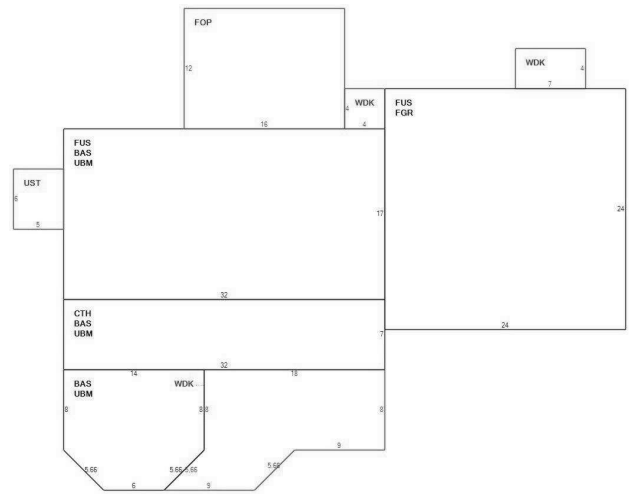

(ParcelSketch.ashx?pid=184424&bid=4445)

Building Sub-Areas (sq ft)			Legend
Code	Description	Gross Area	Living Area
FUS	Finished Upper Story	1,120	1,120
BAS	First Floor	920	920
CTH	Cathedral Ceiling	224	0
FGR	Garage	576	0
FOP	Open Porch	192	0
UBM	Unfinished Basement	920	0
UST	Utility - Storage	30	0
WDK	Wood Deck	224	0
		4,206	2,040

Extra Features

Extra Features	<u>Legend</u>
No Data for Extra Features	

Land

Land Use	Land Line Valuation
Use Code 1010	Size (Acres) 2.06
Description One Family	Frontage
Zone	Depth
Neighborhood 13	Assessed Value \$33,270
Alt Land Appr No	
Category	

Outbuildings

Outbuildings	<u>Legend</u>
No Data for Outbuildings	

Valuation History

Assessment			
Valuation Year	Improvements	Land	Total
2022	\$152,790	\$38,630	\$191,420
2021	\$152,790	\$38,630	\$191,420
2020	\$152,790	\$38,630	\$191,420