



Patio Permit
Limerick Township

646 W. Ridge Pike
Limerick, PA 19468

Phone: 610-495-0951 Fax: 610-495-0952

| Department Use Only |
|-------------------------|
| Permit #: 08-1733 |
| Approved Date: 9/3/2008 |
| Issued By: Bob Bieber |

| Job Site Information | Owner Information |
|----------------------|-------------------|
|----------------------|-------------------|

Address: 260 MASTERS DR
 City: Limerick State: PA
 Zone: R1
 Subdivision:
 Parcel/Block/Unit/Lot: 370002939651/005A/107/0107

Name: Koenck, Michael
 Address: 260 Masters Dr.
 City/State/Zip: Pottstown, PA 19464
 Telephone: 484-624-5545
 Lot Size:

| Applicant Information | Contractor Information |
|-----------------------|------------------------|
|-----------------------|------------------------|

Name: Michael Koenck
 Address: 260 Masters Dr.
 City/State/Zip: Pottstown, PA 19464
 Telephone: 484-624-5545
 Construction Type: Land Use:

Name: Murphy Construction
 Address: 1908 Glen Eagles Dr.
 City/State/Zip: Pottstown, PA 19464
 Telephone: 484-429-3839
 Use Group: Building Use:

This permit conveys no right to occupy any street, alley or sidewalk or any part thereof, either temporarily or permanently. Encroachments on public property, not specifically permitted under the building code, must be approved by the jurisdiction. Street or alley grades as well as depth and location of public sewers may be obtained from the Department of Public Works. The issuance of this permit does not release the applicant from the conditions of any applicable subdivision restrictions.

1. All applicable inspections must be called for with a minimum of twenty-four (24) hours notice to the building department.
2. Approved plans must be retained on the job and this card kept posted until final inspection has been made. Where a certificate of occupancy is required, such building shall not be occupied until final inspection has been made.
3. Work shall not proceed until the inspector has approved the various stages of construction.
4. Plumbing/Sewer Permits - A house trap with a fresh air vent and clean out is required on all buildings.
5. Permit will become null and void if construction work is not started within six months of the date the permit is issued, as noted above.

Description of Work: Build a 120 sq. ft. patio per plans submitted and Limerick Township building/zoning regulations. **Project Cost:** 1,000.00

| Permit Fees | | | | |
|-------------|--|--|--|--|
|-------------|--|--|--|--|

| Description | Work Being Done By | Units | Cost @ | Sum |
|-----------------------|--------------------|--------|-----------------|---------|
| PA State Training Fee | | 1.00 | \$4.00 per 1.00 | \$4.00 |
| New Construction Res. | | 120.00 | \$0.35 per 1.00 | \$42.00 |

Signature: Amanda Matraw
 Date: 9/3/08

Grand Total: \$46.00

PAVERS - EP HENRY COVENTRY 1
6x6 AND 6x9 INTERLOCKING
COLOR - HARVEST BLEND
WALL - COVENTRY

YARD

2 STEPS DOWN
FROM ~~DECK~~ DECK TO PATIO

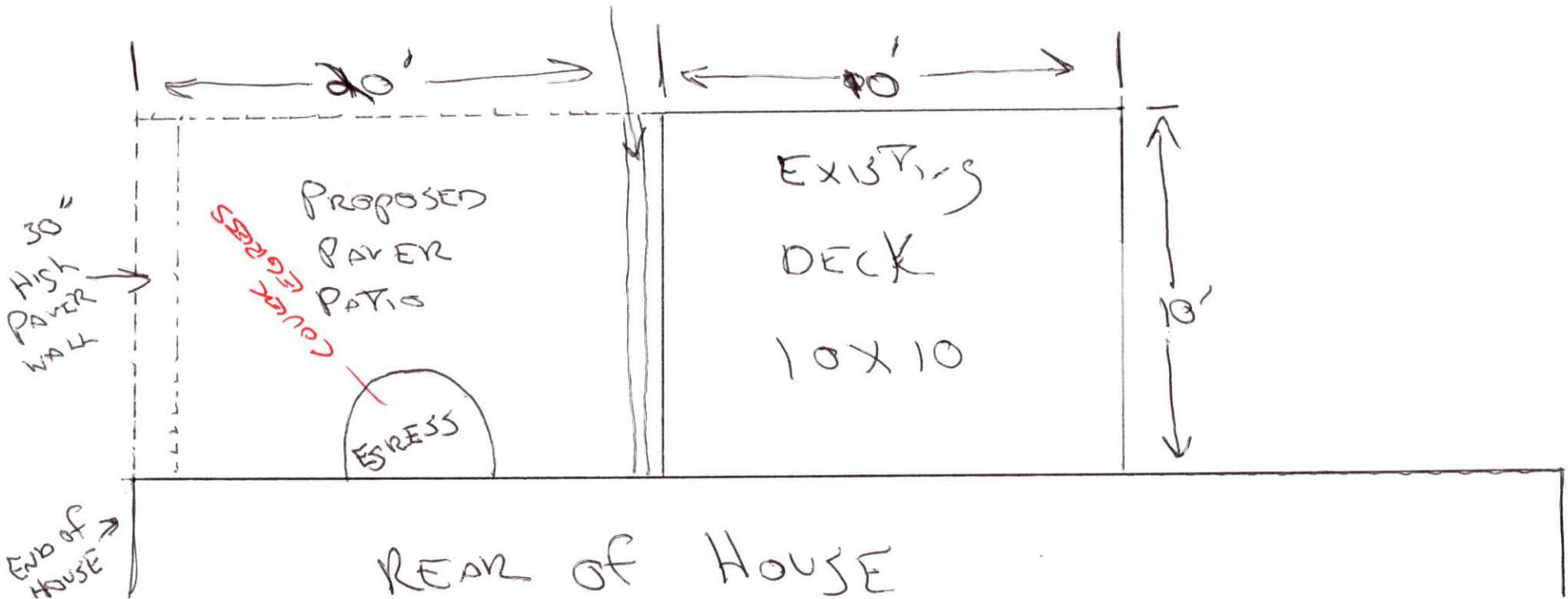

LIMERICK TOWNSHIP

APPLICATION FOR BUILDING PERMIT

646 West Ridge Pike, Limerick, PA 19467 610-495-6432 FAX 610-495-0952

| | | | | |
|-----------------------------|---|----------------|--------|------|
| LOCATION OF BUILDING | ADDRESS 260 MASTERS (RAVENS (LAW)) | | | |
| | Number | Street | Town | |
| | BETWEEN: _____ AND _____ | | ZONING | |
| | Cross Street | Cross Street | | |
| | SUBDIVISION | LOT 107 | BLOCK | UNIT |

- | | |
|---|--|
| 01) <input type="checkbox"/> NEW SINGLE FAMILY DWELLING 02) <input type="checkbox"/> NEW MULT. FAMILY DWELLING 04) <input type="checkbox"/> NEW INSTITUTIONAL BUILDING 05) <input type="checkbox"/> NEW PUBLIC BUILDING 11) <input checked="" type="checkbox"/> ADDITION SINGLE FAMILY DWELLING 12) <input type="checkbox"/> ADDITION MULT. FAMILY DWELLING 14) <input type="checkbox"/> ADDITION INSTITUTIONAL BUILDING 15) <input type="checkbox"/> ADDITION PUBLIC BUILDING 21) <input type="checkbox"/> ALTERATION SINGLE FAMILY DWELLING 22) <input type="checkbox"/> ALTERATION MULT. FAMILY DWELLING 24) <input type="checkbox"/> ALTERATION INSTITUTIONAL BUILDING 25) <input type="checkbox"/> ALTERATION PUBLIC BUILDING 31) <input type="checkbox"/> REPAIR SINGLE FAMILY DWELLING 32) <input type="checkbox"/> REPAIR MULT. FAMILY DWELLING 34) <input type="checkbox"/> REPAIR INSTITUTIONAL BUILDING 35) <input type="checkbox"/> REPAIR PUBLIC BUILDING <input type="checkbox"/> OTHER _____ | 52) <input type="checkbox"/> DEMOLITION 53) <input type="checkbox"/> FIRE REPAIR 54) <input type="checkbox"/> SWIMMING POOL 55) <input type="checkbox"/> TANKS / PUMP 56) <input type="checkbox"/> TENNIS COURT 57) <input type="checkbox"/> SIGN / AWNING 58) <input type="checkbox"/> OTHER (BLDG.) <u>PAVER PATO</u> <input type="checkbox"/> TEMPORARY TENT <input type="checkbox"/> SATELLITE ANTENNA 61) <input type="checkbox"/> H.V.A.C. SYSTEM 62) <input type="checkbox"/> A/C UNIT(S) ONLY 63) <input type="checkbox"/> GAS HEATER 64) <input type="checkbox"/> OIL HEATER 65) <input type="checkbox"/> HEAT PUMP 66) <input type="checkbox"/> CHIMNEY REPAIR |
|---|--|

RECEIVED

SEP 02 2003

LIMERICK TOWNSHIP

OWNERSHIP

- 81) PRIVATE (IND., INST., CORP.)
 82) PUBLIC (LOCAL, STATE, FED.)

COST

98) COST OF CONST.

COST

CONTRACTOR'S NAME

PROPOSED USE OF PROPERTY

- 91) SINGLE FAMILY DWELLING
 92) MULT. FAMILY DWELLING (#Units _____)
 93) BUSINESS (Type) _____
 94) INSTITUTIONAL BUILDING
 95) OTHER (Type) _____
 96) PUBLIC BUILDING

ELECTRICAL

PLUMBING

H.V.A.C.

99) TOTAL COST

FILL OUT SELECTED CHARACTERISTICS OF BUILDING

| | | | |
|--|--|---|--|
| <p>PRINCIPAL TYPE OF FRAME</p> <p><input type="checkbox"/> MASONRY (wall bearing) <input checked="" type="checkbox"/> WOOD FRAME <input type="checkbox"/> STRUCTURAL STEEL <input type="checkbox"/> REINFORCED CONCRETE <input type="checkbox"/> OTHER Specify _____</p> | <p>TYPE OF SEWAGE DISPOSAL</p> <p><input checked="" type="checkbox"/> PUBLIC OR PRIVATE CO. <input type="checkbox"/> INDIVIDUAL (septic tank, etc.)</p> <p>TYPE OF WATER SUPPLY</p> <p><input checked="" type="checkbox"/> PUBLIC OR PRIVATE CO. <input type="checkbox"/> INDIVIDUAL (well, cistern)</p> | <p>DIMENSIONS</p> <p>NUMBER OF STORIES</p> <p>TOTAL SQ. FT. OF FLOORAREA ALL FLOORS, BASED ON EXTERIOR DIMENSIONS</p> <p>TOTAL LAND AREA, SQ. FT.</p> | |
| <p>PRINCIPAL TYPE OF HEATING FUEL</p> <p><input type="checkbox"/> GAS <input type="checkbox"/> OIL <input type="checkbox"/> ELECTRICITY <input type="checkbox"/> COAL <input type="checkbox"/> OTHER Specify _____</p> | <p>TYPE OF MECHANICAL</p> <p>WILL THERE BE CENTRAL AIR CONDITIONING? <input type="checkbox"/> YES <input checked="" type="checkbox"/> NO</p> <p>WILL THERE BE AN ELEVATOR? <input type="checkbox"/> YES <input checked="" type="checkbox"/> NO</p> | <p>NUMBER OF OFF-STREET PARKING SPACES (Enclosed)</p> <p style="text-align: right; font-size: 1.5em;">2</p> <p>OUTDOORS</p> <p style="text-align: right; font-size: 1.5em;">2</p> <p>RESIDENTIAL BLDGS. ONLY</p> <p>NUMBER OF BEDROOMS</p> <p>NUMBER OF BATHROOMS Full Partial</p> | |

Appeal No.

Plan No.

Permit No.

| Name | Mailing Address - Number, Street, City, State, Zip | Tel. No. |
|---------------------------------------|--|--------------|
| 1. Property Owner KOENIG | 260 MASTERS (RAVENS CLAW) LIMERICK, PA | 484-624-5545 |
| 2. Contractor MURPHY CONSTRUCT. | 1988 GLEN EAGLES DR. POTTSTOWN, PA. 19464 | |
| 3. Architect or Engineer | | |

I hereby certify that the proposed work is authorized by the owner of record and that I have been authorized by the owner to make this application as his authorized agent and we agree to conform to all applicable laws of this jurisdiction. The issuance of this building permit authorizes Building and Planning Department employees the right to enter the property at reasonable hours for the purpose of conducting code inspections. The content of the certificate of workers compensation insurance or affidavit on file with Limerick Township is still in effect with no changes in coverage of employees.

| | | |
|---|---|------------------|
| Signature of Applicant  | Address | Application Date |
| Print Name TIMOTHY S. MURPHY | Contact Phone #'s BUS. + CELL - 484-429-3839 | |

DESCRIBE, IN DETAIL, THE WORK TO BE PERFORMED

INSTALL 10' x 20' PAVER PATIO
ONE END OF PATIO WILL HAVE A 30" WALL
DOWN 10' SIDE.

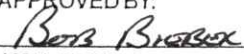
| | | | |
|---|---------------|------------------------|-----------------|
| APPROVED BY:  | PERMIT FEE: | DATE ISSUED: 9-3-08 | PERMIT #: |
| USE GROUP: | FIRE GRADING: | LIVE LOADING: | OCCUPANCY LOAD: |

INTER-OFFICE RECEIPT TRANSMITTAL

Name: Murphy Construction Date: 9/02/08

Development: _____ Lot #: _____

Location: 260 Masterson Dr. B _____ U _____

Check #: 105

107 - Cont. Reg. _____

Commercial or Residential: patio

113 - Solicitation _____

Sq. Ft.: 120

109 - Home Occup. Permit _____

Cost of Improvement: _____

114 - Trailer Park _____

101 - Building Permit 42.00

801 - Highway Occup. Permit _____

Cost for Electrical _____

115 - Zoning Permit _____

102 - Electrical Permit _____

108 - Sign Permit _____

Number of Plumbing Fixtures: _____

110 - Zoning Hearing _____

103 - Plumbing Permit _____

116 - Petition to Re-Zone _____

104 - Use & Occup. Permit: _____

904 - Conditional Use Hearing _____

Cost for Mechanical: _____

111 - Sale of Codes/Maps _____

105 - Mechanical Permit: _____

901 - Copying Fees _____

122 - Training Fee: 4.00

117 - Alarm Permit _____

119 - Building Plan Review: _____

106 - Grading Permit _____

Other _____

123 - Grading Application Escrow _____

Money Received for the funds listed below MUST be on separate Checks.

701 - Road Improvement: _____

702 - Act 209: _____

703 - Lewis Road: _____

708 - Open Space: _____

704 - Waiver Fees: _____

TOTAL \$116.00

MURPHY CONSTRUCTION GROUP LLC
1908 GLEN EAGLES DR
POTTSTOWN, PA 19464

105

3-7615/360
661

DATE 9/2/08

PAY TO THE ORDER OF Limerick Township

\$ 46.00

Forty Six

DOLLARS

Citizens Bank
Pennsylvania

Pay to the order of

[Signature]