

# 9 HEIDI LN

**Location** 9 HEIDI LN

**Mblu** 059/ / 2697/ /

**Acct#** 059-2697

**Owner** SHEA, JESSICA

**Assessment** \$536,800

**Appraisal** \$536,800

**PID** 181204

**Building Count** 1

## Current Value

Appraisal			
Valuation Year	Improvements	Land	Total
2024	\$392,600	\$144,200	\$536,800

Assessment			
Valuation Year	Improvements	Land	Total
2024	\$392,600	\$144,200	\$536,800

## Owner of Record

**Owner** SHEA, JESSICA  
**Co-Owner**  
**Address** 9 HEIDI LN  
MIDDLEBORO, MA 02346

**Sale Price** \$195,199  
**Certificate**  
**Book & Page** 41478/0060  
**Sale Date** 06/06/2012  
**Instrument** 1S

## Ownership History

Ownership History					
Owner	Sale Price	Certificate	Book & Page	Instrument	Sale Date
SHEA, JESSICA	\$195,199		41478/0060	1S	06/06/2012
THE BANK OF NEW YORK MELLON	\$280,000		41323/0103	1L	05/03/2012
ZUBRIS, DENNIS M & BONNIE L	\$275,900		22760/0068	00	08/30/2002
HARVESTWOOD DEVELOPMENT CORP	\$500,000		20431/0119	1V	08/27/2001
SEVEN HILLS CORPORATION	\$230,000		20431/0117	1V	08/27/2001

## Building Information

### Building 1 : Section 1

**Year Built:** 2002  
**Living Area:** 2,312  
**Replacement Cost:** \$435,268  
**Building Percent Good:** 90  
**Replacement Cost  
Less Depreciation:** \$391,700

**Building Attributes**

Field	Description
Style:	Colonial
Model	Residential
Grade:	AVE PLUS
Stories:	2.5
Occupancy	1
Exterior Wall 1	Vinyl Siding
Exterior Wall 2	
Roof Structure:	Gable
Roof Cover	Asph/F Gls/Cmp
Interior Wall 1	Drywall/Sheet
Interior Wall 2	
Interior Flr 1	Carpet
Interior Flr 2	Hardwood
Heat Fuel	Gas
Heat Type:	Forced Air-Duc
AC Type:	Central
Total Bedrooms:	3 Bedrooms
Total Bthrms:	1
Total Half Baths:	1
Num Xtra Fix	
Total Rooms:	6 Rooms
Bath Style:	Average
Kitchen Style:	Average
Extra Kitchens	
Cndtn	
Kitchenettes	
Interior Flr 3	Vinyl
Num Park	
Fireplaces	
Fndtn Cndtn	
Basement	

## Building Photo



(<https://images.vgsi.com/photos/MiddleboroughMAPPhotos/A0010076\33.jpg>)

## Building Layout

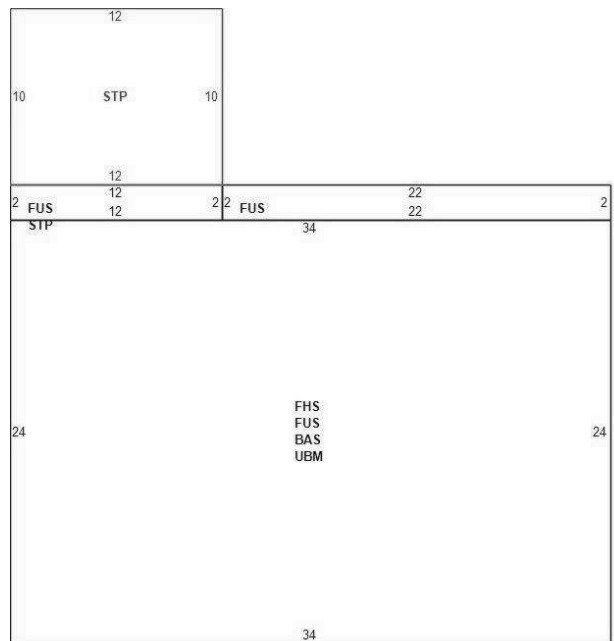

(ParcelSketch.ashx?pid=181204&bid=100720)

Building Sub-Areas (sq ft)			Legend
Code	Description	Gross Area	Living Area
FUS	Upper Story, Finished	884	884
BAS	First Floor	816	816
FHS	Half Story, Finished	816	612
STP	Stoop	144	0
UBM	Basement, Unfinished	816	0
		3,476	2,312

## Extra Features

Extra Features				Legend
Code	Description	Size	Value	Bldg #
HTLR	HEATILATOR	1.00 UNITS	\$900	1

## Land

### Land Use

**Use Code** 1010  
**Description** SINGLE FAMILY

### Land Line Valuation

**Size (Acres)** 0.47  
**Assessed Value** \$144,200  
**Appraised Value** \$144,200

## Outbuildings

Outbuildings	<a href="#">Legend</a>
No Data for Outbuildings	

## Valuation History

Appraisal			
Valuation Year	Improvements	Land	Total
2024	\$392,600	\$144,200	\$536,800
2023	\$318,100	\$144,200	\$462,300
2022	\$274,300	\$125,500	\$399,800

Assessment			
Valuation Year	Improvements	Land	Total
2024	\$392,600	\$144,200	\$536,800
2023	\$318,100	\$144,200	\$462,300
2022	\$274,300	\$125,500	\$399,800