



Property Information		Request Information		Update Information
File#:	BF-X01719-9288021255	Requested Date:	07/29/2024	Update Requested:
Owner:	DAVIS, YOLANDA J & DAVIS, ANTHONY G	Branch:		Requested By:
Address 1:	103 CHANNEL DR	Date Completed:		Update Completed:
Address 2:		# of Jurisdiction(s):		
City, State Zip:	LAKE MARY, FL	# of Parcel(s):	1	

## Notes

**CODE VIOLATIONS** Per City of Lake Mary Department of Zoning there are no Code Violation cases on this property.

Collector: City of Lake Mary  
 Payable Address: 100 N Country Club Road, Lake Mary, FL 32746  
 Business # 407-585-1365

UNABLE TO PROVIDE DOCUMENTATION TO THIRD PARTIES. VERBAL INFO ACQUIRED

**PERMITS** Per City of Lake Mary Building Department there are no Open/Pending/ Expired Permit on this property.

Collector: City of Lake Mary  
 Payable Address: 100 N Country Club Road, Lake Mary, FL 32746  
 Business # 407-585-1361

UNABLE TO PROVIDE DOCUMENTATION TO THIRD PARTIES. VERBAL INFO ACQUIRED

**SPECIAL ASSESSMENTS** Per Seminole County Tax Collector Department there are no Special Assessments/liens on the property.

Collector: Seminole County Tax Collector  
 Payable: 1101 E 1st Street, Room 1200, Sanford, FL 32771  
 Business# (407) 665-1000

UNABLE TO PROVIDE DOCUMENTATION TO THIRD PARTIES. VERBAL INFO ACQUIRED

**DEMOLITION** NO

**UTILITIES** WATER & GARBAGE  
 Account #: 68145-13000  
 Payment Status: Due  
 Status: Pvt & Lienable  
 Amount: \$67.24  
 Good Thru: 08/20/2024  
 Account Active: Active  
 Collector: City of Lake Mary Utility  
 Payable Address: 100 N Country Club Road, Lake Mary, FL 32746  
 Business # 407-585-1417

UNABLE TO PROVIDE DOCUMENTATION TO THIRD PARTIES. VERBAL INFO ACQUIRED

**SEWER**  
 The house is on a community sewer. All houses go to the shared septic system.



# DAVID JOHNSON, CFA

## SEMINOLE COUNTY PROPERTY APPRAISER



DAVIS, YOLANDA J; WILLIAMS, JEANNETTE S; DAVIS, ANTHONY G  
2024 Market \$465,798 Assessed \$317,517  
2023 Tax Bill \$3,655.62 Tax Savings with Exemptions/Cap \$1,959.95



Map - Parcel View



0920305100000220 05/17/2023

Street View - View in New Window

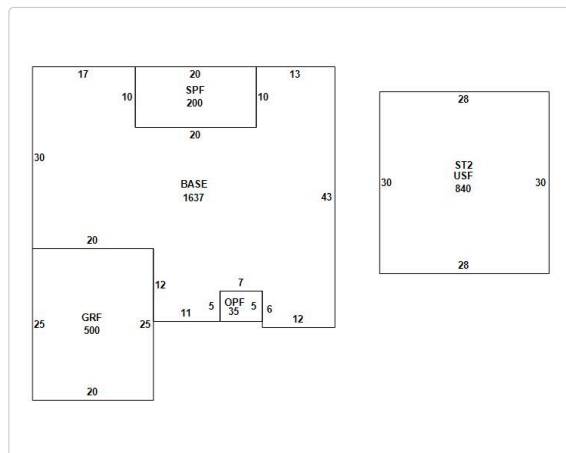

Footprint Building 1, Page 1 - View in New Window

Use



Single Family



# DAVID JOHNSON, CFA

SEMINOLE COUNTY PROPERTY APPRAISER

4 Bedrooms

Bathrooms  
 2.5 Bathrooms

Land Size  
 0.45 Acres

Homestead Status  
 Has Homestead

AG Class  
 NO Agriculture

Tax District  
 LAKE MARY

Zoning  
 R-1AA

- Details
- Value Summary
- Land
- Building
- Permit
- Other Features
- Taxes
- Sales
- Area Information

<b>Parcel #</b>	09-20-30-510-0000-0220
<b>Owner</b>	DAVIS, YOLANDA J - Tenancy by Entirety :25 WILLIAMS, JEANETTE S - Tenants in Common :50 DAVIS, ANTHONY G - Tenancy by Entirety :25 <a href="#">? Ownership Types</a>
<b>Mailing</b>	103 CHANNEL DR LAKE MARY, FL 32746-2721 <a href="#">Change Mailing Address</a>
<b>Bed/Bath</b>	4 Bedrooms, 2.5 Bathrooms <a href="#">! Incorrect Bed Bath?</a>
<b>Legal</b>	LOT 22 CRYSTAL RIDGE PB 38 PGS 96 TO 98
<b>Property Use Code</b>	01:Single Family
<b>Tax District</b>	M1:LAKE MARY
<b>Subdivision</b>	CRYSTAL RIDGE <a href="#">Show All Parcels in Subdivision</a>
<b>Subdivision Book/Page(s)</b>	Book 38/Pages 96,97,98 <a href="#">View Plat at Clerk of the Court</a>
<b>Exemptions</b>	00-HOMESTEAD (2007) <a href="#">Report Suspected Homestead Fraud</a>