

Property Information		Request Information		Update Information
File#:	24-2205017	Requested Date:	08/05/2024	Update Requested:
Owner:	Romeo Homes Kansas LLC	Branch:		Requested By:
Address 1:	11256 North Madison Avenue	Date Completed:		Update Completed:
Address 2:		# of Jurisdiction(s):		
City, State Zip:	Kansas City, MO 64155	# of Parcel(s):	1	

Notes

CODE VIOLATIONS Per Kansas City Department of Zoning there are no Code Violation cases on this property.

Collector: Kansas City
 Payable Address: 414 E. 12th Street Kansas City, MO 64106
 Business# 816-513-1313

PERMITS Per Kansas City Building Department there are Open Permit's on this property.

Permit# CPEM-200024251
 Permit Type: Electrical

Permit# CPMP-200024160
 Permit Type - Mechanical

Permit# CPPM-200018366
 Permit Type: With Gas Service

Collector: Kansas City
 Payable Address: 414 E. 12th Street Kansas City, MO 64106
 Business# 816-513-1313

SPECIAL ASSESSMENTS Per Kansas City Department of Finance there are no Special Assessments/liens on the property.

Collector: Kansas City
 Payable Address: 414 E. 12th Street Kansas City, MO 64106
 Business# 816-513-1313

DEMOLITION NO

UTILITIES Water & Sewer
 Account #: N/A
 Payment Status: N/A
 Status: Pvt & Non-Lienable
 Amount: N/A
 Good Thru: N/A
 Account Active: Yes
 Collector: KC Water
 Payable: 4800 E. 63rd St. Kansas City, MO 64130
 Business # 816-513-0285

UNABLE TO PROVIDE INFORMATION TO THIRD PARTIES. HOMEOWNERS AUTHORIZATION REQUIRED.

Garbage:
 Garbage private hauler with lien status and balance unknown.



[Home](#) [Help](#)

[Property Search](#) > [Search Results](#) > [Property Summary](#)

Property Account Summary

Parcel Number	09520000600500	Property Address	11256 N MADISON AVE MO , KANSAS CITY, MO 00000
---------------	----------------	------------------	--

General Information

Property Description	BRISTOL HIGHLANDS 3RD PLAT LT 108
Property Category	Land and Improvements
Status	Active, Locally Assessed
Tax Code Area	128

Property Characteristics

No Property Characteristics Found

Parties

Role	Percent	Name	Address	Since
Taxpayer	100	ROMEO HOMES KANSAS LLC	103 FOULK RD STE 900, WILMINGTON, DE 19803-3742 UNITED STATES	10/04/2023
Owner	100	ROMEO HOMES KANSAS LLC	103 FOULK RD STE 900, WILMINGTON, DE 19803-3742 UNITED STATES	10/04/2023
Mortgage Company	100	LERETA CORP 2	901 CORPORATE CENTER DR, POMONA, CA 91768	11/02/2023

Property Values

Value Type	Tax Year 2023	Tax Year 2022	Tax Year 2021	Tax Year 2020	Tax Year 2019
Assessed Value Total (AVR)	51,280	43,870	43,870	39,200	39,200
Taxable Value Total (TVR)	51,280	43,870	43,870	39,200	39,200

Events

Effective Date	Entry Date-Time	Type	Remarks
10/04/2023	2023-10-27 18:40:00.000	Taxpayer Changed	by asix
10/04/2023	2023-10-27 15:53:00.000	Owner Added	by asix
10/03/2023	2023-10-27 15:53:00.000	Owner Terminated	Load Party Information from file by asix
10/04/2022	2022-10-21 18:29:00.000	Taxpayer Changed	by asix
10/04/2022	2022-10-21 18:02:00.000	Owner Added	by asix
10/03/2022	2022-10-21 18:02:00.000	Owner Terminated	Load Party Information from file by asix
10/04/2021	2021-10-20 18:50:00.000	Taxpayer Changed	by asix
10/04/2021	2021-10-20 18:14:00.000	Owner Added	by asix
10/03/2021	2021-10-20 18:14:00.000	Owner Terminated	Load Party Information from file by asix
10/15/2020	2020-10-29 19:08:00.000	Taxpayer Changed	by asix
10/15/2020	2020-10-29 17:25:00.000	Owner Added	by asix
10/14/2020	2020-10-29 17:25:00.000	Owner Terminated	Load Party Information from file by asix
10/18/2019	2019-10-22 14:20:00.000	Taxpayer Changed	by asix
10/18/2019	2019-10-22 13:24:00.000	Owner Added	by asix
10/17/2019	2019-10-22 13:24:00.000	Owner Terminated	Load Party Information from file by asix

No Charges are currently due.

No Charge Amounts are currently due for this property. If you believe this is incorrect, please contact our office at (816) 407-3200.

Distribution of Current Taxes

District	Amount	Voted Amount	Non-Voted Amount
COUNTY SERVICES	67.18	0.00	67.18
HANDICAP TAX	49.69	0.00	49.69
HEALTH TAX	41.43	0.00	41.43
KANSAS CITY	766.79	0.00	766.79
KCJC TAX	91.28	0.00	91.28

LIBRARY TAX	149.27	0.00	149.27
MENTAL HEALTH TAX	41.43	0.00	41.43
NORTH KANSAS CITY SCHOOL DISTRICT	2,872.24	0.00	2,872.24
STATE TAX	15.40	0.00	15.40

Receipts

Date	Receipt No.	Amount Applied	Amount Due	Tendered	Change
12/20/2023	4568113	4,094.71	4,094.71	4,094.71	0.00
12/15/2022	4317647	3,665.21	3,665.21	3,665.21	0.00
12/16/2021	4116963	3,669.47	3,669.47	3,669.47	0.00
12/21/2020	3907164	3,544.93	3,544.93	3,544.93	0.00
12/27/2019	3707065	3,478.80	3,478.80	3,478.80	0.00

[Printable Version](#)

Developed by Manatron/ASIX, Incorporated.
 @2005-2006 All rights reserved.
 Version 1.0.6626.23691



Public Information

Search

Code Case ▾

for

11256 N Madison

Exact Phrase

Search

Advanced ▾

Reset

Export

Found 1 result

Sort

Code Case Number ▾

Ascending ▾

[Next \(\)](#) | [Top \(\)](#) | [Paging Options \(\)](#) | [Main Menu \(\)](#)

Code Case Number 11-0433309-482744

Status Complete

Type CPIN - Permit Compliance

Project Name

Opened Date 05/10/2011

Closed Date 05/12/2011

Address 11256 N MADISON Ave Kansas City, MO 64155

Main Parcel 207922

Description DATE: 5/10/2011 EMPL_NUM: DB3398 MEMO: RFS for a HQS. DB



Good Afternoon,

[Home](#)
[Apply](#)
[Today's Inspections](#)
[Report](#)
[Fee Estimator](#)
[Search](#)
[Calendar 0](#)
[Submission Forms](#)
[Helpful Resource](#)

Public Information

Search for
 Exact Phrase
 Search
 Export

Found 8 results

Sort

[Next](#) | [Top](#) | [Paging Options](#) | [Main Menu](#)

Permit Number CICO-200110249 **Applied Date** 06/21/2000
Type Residential Certificate of Occupancy **Issued Date** 06/21/2000
Project Name SINGLE FAMILY RESIDENCE **Expiration Date**
Status Closed **Finalized Date** 07/26/2000
Main Parcel 207922
Address 11256 N Madison Ave Kansas City, MO 64155
Description Construct new single family residence

[Previous](#) | [Next](#) | [Top](#) | [Paging Options](#) | [Main Menu](#)

Permit Number CPBS-200017407 **Applied Date** 09/09/1999
Type Construct New Single Family Dwelling **Issued Date** 09/09/1999
Project Name SINGLE FAMILY RESIDENCE **Expiration Date** 03/07/2000
Status Closed **Finalized Date** 05/26/2000
Main Parcel 207922
Address 11256 N Madison Ave Kansas City, MO 64155
Description Lot 108 Bristol Highlands 3rd Permit revised from 11262 N Madison Ave to 11256 N Madison Ave.

[Previous](#) | [Next](#) | [Top](#) | [Paging Options](#) | [Main Menu](#)

Permit Number CPEM-200024251 **Applied Date** 01/07/2000
Type Electrical Service- Residential **Issued Date** 01/07/2000
Project Name SINGLE FAMILY **Expiration Date** 07/05/2000
Status Issued **Finalized Date**
Main Parcel 207922
Address 11256 N Madison Ave Kansas City, MO 64155
Description Install 200AMP electrical service , wiring and fixtures.

[Previous](#) | [Next](#) | [Top](#) | [Paging Options](#) | [Main Menu](#)

Permit Number CPMP-200024160 **Applied Date** 01/06/2000
Type Mechanical General - Residential **Issued Date** 01/06/2000
Project Name SINGLE FAMILY **Expiration Date** 07/04/2000
Status Issued **Finalized Date**
Main Parcel 207922
Address 11256 N Madison Ave Kansas City, MO 64155
Description Install 3 1/2 TON HEAT PUMP , 3 1/2 ton coil , 91,000 btu furnace and ductwork.

[Previous](#) | [Next](#) | [Top](#) | [Paging Options](#) | [Main Menu](#)

Permit Number CPPM-200018366 **Applied Date** 09/24/1999
Type With Gas Service- Residential **Issued Date** 09/24/1999
Project Name SINGLE FAMILY RESIDENCE **Expiration Date** 03/22/2000
Status Issued **Finalized Date**
Main Parcel 207922

Address 11256 N Madison Ave Kansas City, MO 64155

Description Permit revised from 11262 N Madison Ave to 11256 N Madison Ave. Cliff 11-09-99

[Previous](#) | [Next](#) | [Top](#) | [Paging Options](#) | [Main Menu](#)

Permit Number SEEC-70194652

Applied Date 03/05/2014

Type Excavation For Communications Utility

Issued Date 03/05/2014

Project Name INSTALL CONDUITS

Expiration Date 06/03/2014

Status Closed

Finalized Date 05/28/2014

Main Parcel 229334

Address 11256 N Madison Ave Kansas City, MO 64155

Description Where: In Pavement in front of: _ 10900, 10904, 10908, 10909, 10915, 10916, 10919, 10920, 10924, 10927, 10928, 10932, 10936, 10939, 10940, 10944, 10947, 10948, 10952, 11035, 11039, 11043, 11047, 11100, 11101, 11105, 11109, 11115, 11119, 11120, 11124, 11125, 11128, 11131, 11136, 11137, 11139, 11140, 11141, 11143, 11144,...

[Previous](#) | [Next](#) | [Top](#) | [Paging Options](#) | [Main Menu](#)

Permit Number SEEW-70080339

Applied Date 11/15/1999

Type Excavation For Water Pipeline

Issued Date 11/15/1999

Project Name PW/ENG NON PROJECT EXCAVATION

Expiration Date 02/13/2000

Status Closed

Finalized Date 01/06/2000

Main Parcel 207923

Address 11254 N Madison Ave Kansas City MO 64155

Description WHERE: 11256 N MADISON REASON FOR EXCAVATION: NEW CONNECTION SEWER CONNECTION PERMIT NO.:_ WATER

[Previous](#) | [Top](#) | [Paging Options](#) | [Main Menu](#)

Permit Number WS01-162736

Applied Date 11/10/1999

Type New Water Service Line - Residential Domestic

Issued Date 11/10/1999

Project Name 162736

Expiration Date 02/08/2000

Status Closed

Finalized Date 02/05/2007

Main Parcel 207922

Address 11256 N Madison Ave Kansas City, MO 64155

Description 3/4 X 8 ; 5/8 IN

Results per page 1 - 8 of 8 << < 1 > >>

11256 N Madison Ave

Search/Tools Results Print Map Download

< Back to search tools

Parcel Data Parcel Notification

Parcel Data	
City PIN:	207922 Code Cases (1) Permits (7) Plans (1) Holds (0)
Clay County APN:	CL0952000060050001
Plat:	BRISTOL HIGHLANDS THIRD PLAT
Lot:	108
Block:	
Tract:	
Owner:	Romeo Homes Kansas LLC 103 Foulk Rd Ste 900 Wilmington, DE 19803
Address:	11256 N Madison Ave View all addresses (1)
Zip code:	64155
	311 Cases
Council District:	1st
Trash Day:	Monday (North)
	Neighborhood & Homes Associations
Patrol Division:	North
	Show Special Assessments
Census Neighborhood:	Outer Gashland-Nashua
School District:	NORTH KANSAS CITY 250
Park District:	North
PW Maint District:	D1
Impact Fee Zone:	A
Water Inspector Route:	1
MFS Servicer Route:	2
EDC Territory:	North

Code Cases

Opened	Case Number	Type	Status	Closed
2011-05-10	11-0433309-482744	CPIN - Permit Compliance	Complete	2011-05-12

Close

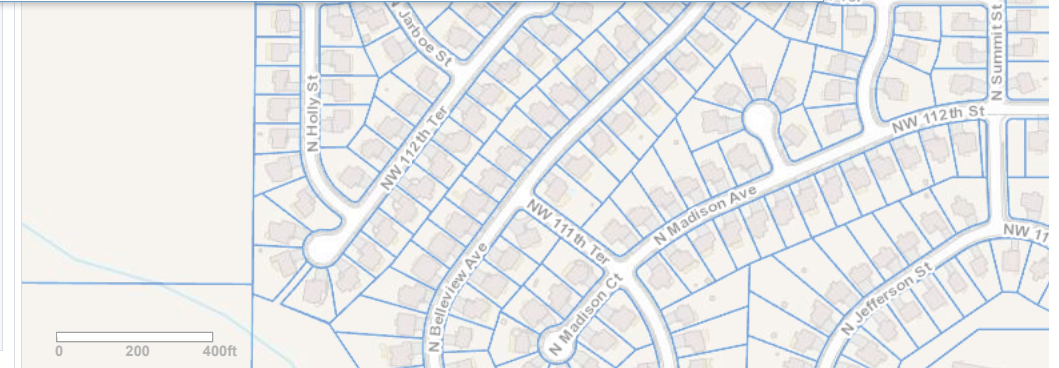

11256 N Madison Ave

Search/Tools Results Print Map Download

Projects Platting Layers

< Back to search tools

Parcel Data Parcel Notification

Parcel Data

City PIN: 207922 [Code Cases \(1\)](#) [Permits \(7\)](#) [Plans \(1\)](#) [Holds \(0\)](#)

Clay County APN: [CL0952000060050001](#)

Plat: BRISTOL HIGHLANDS THIRD PLAT

Lot: 108

Block:

Tract:

Owner: Romeo Homes Kansas LLC
103 Foulk Rd Ste 900
Wilmington, DE 19803

Address: 11256 N Madison Ave
[View all addresses \(1\)](#)

Zip code: 64155

[311 Cases](#)

Council District: [1st](#)

Trash Day: Monday (North)

[Neighborhood & Homes Associations](#)

Patrol Division: [North](#)
[Show Special Assessments](#)

Census Neighborhood: Outer Gashland-Nashua

School District: NORTH KANSAS CITY 250

Park District: North

PW Maint District: D1

Impact Fee Zone: A

Water Inspector Route: 1

MFS Servicer Route: 2

EDC Territory: North

Permits

Issue Date	Permit Number	Type	Work Class	Status
1999-11-10	WS01-162736	WS - New Service	Residential	Closed
2000-01-07	CPEM-200024251	CPPU - Electrical (Residential)	Electrical with Service	Issued
1999-09-24	CPPM-200018366	CPPU - Plumbing (Residential)	Plumbing with Gas Service	Issued
2000-06-21	CICO-200110249	CPPU - Certificate of Occupancy	Certificate of Occupancy (Residential)	Closed
2014-03-05	SEEC-70194652	PW - Excavation	Communication	Closed
2000-01-06	CPMP-200024160	CPPU - Mechanical (Residential)	Mechanical General	Issued
1999-09-09	CPBS-200017407	CPPU - Building (Residential)	Single Family - New	Closed

[Close](#)

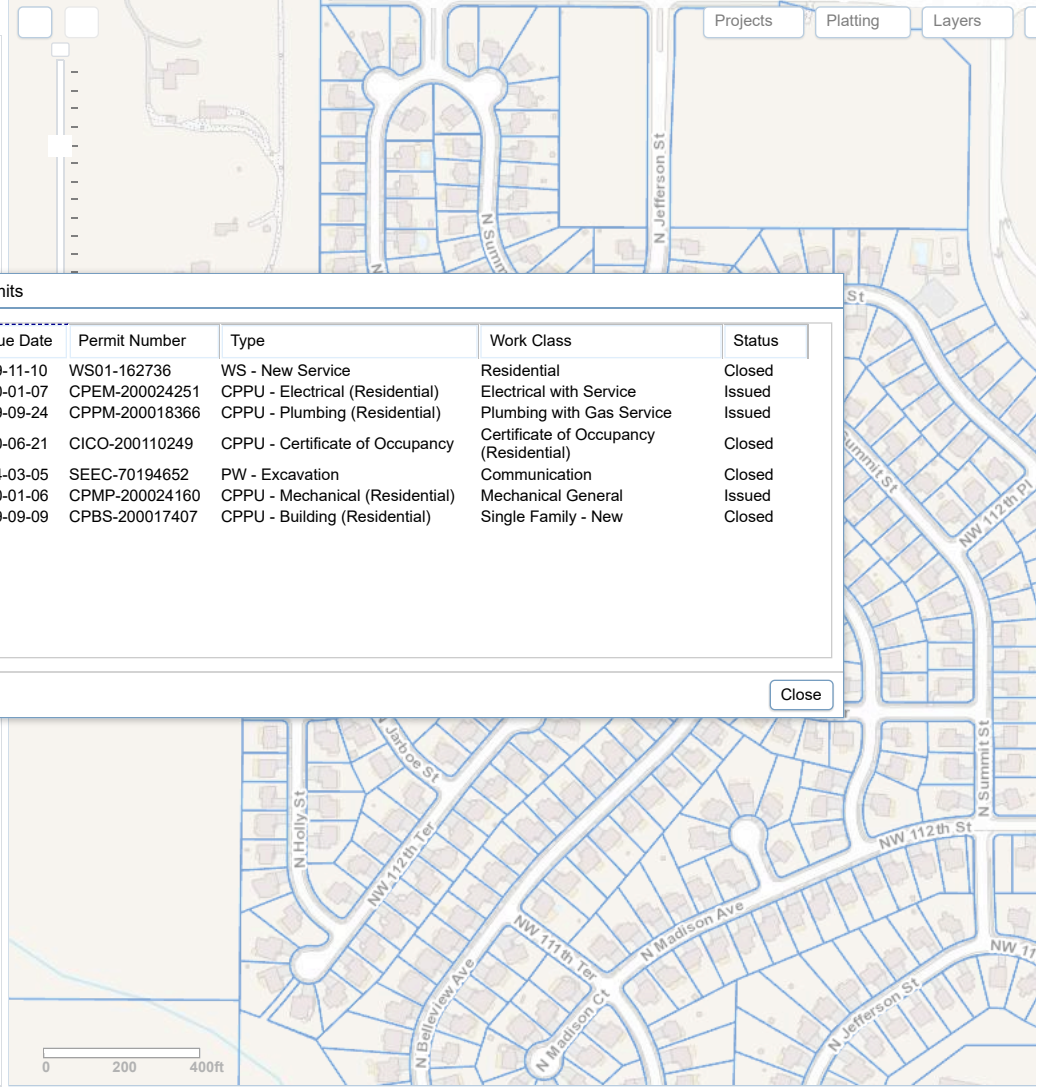



Quick Tax

[Home](#)

Please Note:

- Quick Tax may not disclose all City obligations. Please contact the county where the property is located for more information on additional obligations that may exist.
- Assessed value of property is provided for information only and should not be relied upon for a final determination of value. For the most updated assessed value information, please contact the County Assessor for the county in which the property is located.

Owner ROMEO HOMES KANSAS LLC
Mailing Address 200 BELLEVUE PKWY 210 STE WILMINGTON DE 198093709
Location Address 11256 N MADISON AVE KANSAS CITY MO 64155

Total Balance

\$0.00

Parcel Information **Active Assessments** **Pending Assessments** **Historical Assessments**

County	Clay
Land	7,220
Improvements	31,980
Exempt Land	0
Exempt Improvements	0
Bld Front Footage	0
Council District	2

[GIS Map View of Property](#)



Quick Tax

[Home](#)

Please Note:

- Quick Tax may not disclose all City obligations. Please contact the county where the property is located for more information on additional obligations that may exist.
- Assessed value of property is provided for information only and should not be relied upon for a final determination of value. For the most updated assessed value information, please contact the County Assessor for the county in which the property is located.

Owner ROMEO HOMES KANSAS LLC
Mailing Address 200 BELLEVUE PKWY 210 STE WILMINGTON DE 198093709
Location Address 11256 N MADISON AVE KANSAS CITY MO 64155

Total Balance

\$0.00

[Parcel Information](#) [Active Assessments](#) [Pending Assessments](#) [Historical Assessments](#)

There are no active special assessments for this parcel.

[Home](#)

Please Note:

- **Quick Tax may not disclose all City obligations. Please contact the county where the property is located for more information on additional obligations that may exist.**
- **Assessed value of property is provided for information only and should not be relied upon for a final determination of value. For the most updated assessed value information, please contact the County Assessor for the county in which the property is located.**

Owner ROMEO HOMES KANSAS LLC
Mailing Address 200 BELLEVUE PKWY 210 STE WILMINGTON DE 198093709
Location Address 11256 N MADISON AVE KANSAS CITY MO 64155

Total Balance

\$0.00

[Parcel Information](#) [Active Assessments](#) [Pending Assessments](#) [Historical Assessments](#)

There are no pending special assessments for this parcel.

Please Note:

- Quick Tax may not disclose all City obligations. Please contact the county where the property is located for more information on additional obligations that may exist.
- Assessed value of property is provided for information only and should not be relied upon for a final determination of value. For the most updated assessed value information, please contact the County Assessor for the county in which the property is located.

Owner ROMEO HOMES KANSAS LLC
Mailing Address 200 BELLEVUE PKWY 210 STE WILMINGTON DE 198093709
Location Address 11256 N MADISON AVE KANSAS CITY MO 64155

Total Balance
\$0.00

Parcel Information **Active Assessments** **Pending Assessments** **Historical Assessments**

Account Id	Assessment Type	Assmnt Date	Tax	Penalty	Interest	Credit
1041554560	Real Estate	31-Dec-2011	\$546.38	\$0.00	\$0.00	(\$546.38)
1041554560	Real Estate	31-Dec-2010	\$552.29	\$0.00	\$0.00	(\$552.29)