

Property Information		Request Information		Update Information
File#:	24-2205045	Requested Date:	08/05/2024	Update Requested:
Owner:	Romeo Homes Kansas LLC	Branch:		Requested By:
Address 1:	315 North West 110th Terrace	Date Completed:		Update Completed:
Address 2:		# of Jurisdiction(s):		
City, State Zip:	Kansas City, MO 64155	# of Parcel(s):	1	

Notes

CODE VIOLATIONS Per Kansas City Department of Zoning there are no Code Violation cases on this property.

Collector: Kansas City
 Payable Address: 414 E. 12th Street Kansas City, MO 64106
 Business# 816-513-1313

PERMITS Per Kansas City Building Department there are Open Permit's on this property.

Permit# CICO-200010156
 Permit Type: Residential Certificate of Occupancy

Permit# CPMP-201324494
 Permit Type: Mechanical General

Permit# CPZD-201110588
 Permit Type: Zoning Clearance for Business License

Collector: Kansas City
 Payable Address: 414 E. 12th Street Kansas City, MO 64106
 Business# 816-513-1313

SPECIAL ASSESSMENTS Per Kansas City Department of Finance there are no Special Assessments/liens on the property.

Collector: Kansas City
 Payable Address: 414 E. 12th Street Kansas City, MO 64106
 Business# 816-513-1313

DEMOLITION NO

UTILITIES Water & Sewer
 Account #: N/A
 Payment Status: N/A
 Status: Pvt & Non-Lienable
 Amount: N/A
 Good Thru: N/A
 Account Active: Yes
 Collector: KC Water
 Payable: 4800 E. 63rd St. Kansas City, MO 64130
 Business # 816-513-0285

UNABLE TO PROVIDE INFORMATION TO THIRD PARTIES. HOMEOWNERS AUTHORIZATION REQUIRED.

Garbage:
 Garbage private hauler with lien status and balance unknown.



Property Account Summary

Parcel Number	09905001501800	Property Address	315 NW 110TH TER MO , KANSAS CITY, MO 00000
---------------	----------------	------------------	---

General Information

Property Description	PINE LAKE 6TH PLAT LT 174
Property Category	Land and Improvements
Status	Active, Locally Assessed
Tax Code Area	128

Property Characteristics

No Property Characteristics Found

Parties

Role	Percent	Name	Address	Since
Taxpayer	100	ROMEO HOMES KANSAS LLC	103 FOULK RD STE 900, WILMINGTON, DE 19803-3742 UNITED STATES	10/04/2023
Owner	100	ROMEO HOMES KANSAS LLC	103 FOULK RD STE 900, WILMINGTON, DE 19803-3742 UNITED STATES	10/04/2023
Mortgage Company	100	LERETA CORP 2	901 CORPORATE CENTER DR, POMONA, CA 91768	11/02/2023

Property Values

Value Type	Tax Year 2023	Tax Year 2022	Tax Year 2021	Tax Year 2020	Tax Year 2019
Assessed Value Total (AVR)	39,620	33,400	33,400	31,080	31,080
Taxable Value Total (TVR)	39,620	33,400	33,400	31,080	31,080

Events

Effective Date	Entry Date-Time	Type	Remarks
10/04/2023	2023-10-27 17:43:00.000	Owner Added	by asix
10/04/2023	2023-10-27 17:31:00.000	Taxpayer Changed	by asix
10/03/2023	2023-10-27 17:43:00.000	Owner Terminated	Load Party Information from file by asix
10/04/2022	2022-10-21 17:33:00.000	Taxpayer Changed	by asix
10/04/2022	2022-10-21 16:11:00.000	Owner Added	by asix
10/03/2022	2022-10-21 16:11:00.000	Owner Terminated	Load Party Information from file by asix
10/04/2021	2021-10-20 17:29:00.000	Taxpayer Changed	by asix
10/04/2021	2021-10-20 17:00:00.000	Owner Added	by asix
10/03/2021	2021-10-20 17:00:00.000	Owner Terminated	Load Party Information from file by asix
10/15/2020	2020-10-29 18:49:00.000	Taxpayer Changed	by asix
10/15/2020	2020-10-29 17:04:00.000	Owner Added	by asix
10/14/2020	2020-10-29 17:04:00.000	Owner Terminated	Load Party Information from file by asix
10/18/2019	2019-10-22 14:16:00.000	Taxpayer Changed	by asix
10/18/2019	2019-10-22 13:19:00.000	Owner Added	by asix
10/17/2019	2019-10-22 13:19:00.000	Owner Terminated	Load Party Information from file by asix

No Charges are currently due.

No Charge Amounts are currently due for this property. If you believe this is incorrect, please contact our office at (816) 407-3200.

Distribution of Current Taxes

District	Amount	Voted Amount	Non-Voted Amount
COUNTY SERVICES	51.90	0.00	51.90
HANDICAP TAX	38.39	0.00	38.39
HEALTH TAX	32.01	0.00	32.01
KANSAS CITY	592.44	0.00	592.44
KCJC TAX	70.52	0.00	70.52

LIBRARY TAX	115.34	0.00	115.34
MENTAL HEALTH TAX	32.01	0.00	32.01
NORTH KANSAS CITY SCHOOL DISTRICT	2,219.16	0.00	2,219.16
STATE TAX	11.89	0.00	11.89

Receipts

Date	Receipt No.	Amount Applied	Amount Due	Tendered	Change
12/20/2023	4568121	3,163.66	3,163.66	3,163.66	0.00
12/15/2022	4317655	2,790.47	2,790.47	2,790.47	0.00
12/16/2021	4116971	2,793.71	2,793.71	2,793.71	0.00
12/21/2020	3907172	2,810.62	2,810.62	2,810.62	0.00
12/27/2019	3707073	2,758.19	2,758.19	2,758.19	0.00

[Printable Version](#)

Developed by Manatron/ASIX, Incorporated.
 @2005-2006 All rights reserved.
 Version 1.0.6626.23691



Public Information

Search

Code Case ▾

for

315 NW 110TH

Exact Phrase

Search

Advanced ▾

Reset

Export

Found 1 result

Sort

Code Case Number ▾

Ascending ▾

[Next \(\)](#) | [Top \(\)](#) | [Paging Options \(\)](#) | [Main Menu \(\)](#)

Code Case Number NPD-2022-05607

Status Complete

Type NPD - Property Violations

Project Name

Opened Date 05/23/2022

Closed Date 06/09/2022

Address 315 NW 110th Ter Kansas City, MO 64155

Main Parcel 101969

Description car parked in drive that alarm is sounding intermittently all hours of the day and night since 5/14/22. it also hasn't moved since 5/14/22. I left note on for residents to address and it was removed but was ignored. The car hasn't been moved and the alarm has sounded 3 times today. It is also going off during...



Good Afternoon,

- [Home](#)
- [Apply](#)
- [Today's Inspections](#)
- [Report](#)
- [Fee Estimator](#)
- [Search](#)
- [Calendar](#) 19
- [Submission Forms](#)
- [Helpful Resources](#)

Public Information

Search for **Exact Phrase** Search

Found 10 results

Sort

[Next](#) | [Top](#) | [Paging Options](#) | [Main Menu](#)

Permit Number CICO-200010156 **Applied Date** 05/28/1999
Type Residential Certificate of Occupancy **Issued Date** 05/28/1999
Project Name **Expiration Date**
Status Issued **Finalized Date**
Main Parcel 101969
Address 315 NW 110th Ter Kansas City, MO 64155
Description SINGLE FAMILY RESIDENCE PER APPROVED MP TL43-1605 ; PARTIAL BASEMENT FINISH; AND REAR DECK INCLUDED.

[Previous](#) | [Next](#) | [Top](#) | [Paging Options](#) | [Main Menu](#)

Permit Number CPBS-9908908 **Applied Date** 10/05/1998
Type Construct New Single Family Dwelling **Issued Date** 10/05/1998
Project Name **Expiration Date**
Status Closed **Finalized Date** 06/02/1999
Main Parcel 101969
Address 315 NW 110th Ter Kansas City, MO 64155
Description TL43-1605-MP SINGLE FAMILY RESIDENCE CONSTRUCT SINGLE FAMILY RESIDENCE PER APPD MP TL43-1605 WITH DRIVE & SIDEWALK; PART BSMT FINISH; AND REAR DECK

[Previous](#) | [Next](#) | [Top](#) | [Paging Options](#) | [Main Menu](#)

Permit Number CPEM-9913889 **Applied Date** 01/08/1999
Type Electrical Service- Residential **Issued Date** 01/08/1999
Project Name **Expiration Date**
Status Closed **Finalized Date** 06/02/1999
Main Parcel 101969
Address 315 NW 110th Ter Kansas City, MO 64155
Description RESIDENTIAL ELECTRIC SINGLE FAMILY RESIDENCE INSTALL 200 AMP SERVICE AND WIRING FOR NEW S/F RESIDENCE

[Previous](#) | [Next](#) | [Top](#) | [Paging Options](#) | [Main Menu](#)

Permit Number CPMP-201324494 **Applied Date** 04/11/2013
Type Mechanical General - Residential **Issued Date** 04/11/2013
Project Name SINGLE FAMILY **Expiration Date**
Status Issued **Finalized Date**
Main Parcel 101969
Address 315 NW 110th Ter Kansas City, MO 64155
Description Install 3 ton air conditioning unit and coil.

[Previous](#) | [Next](#) | [Top](#) | [Paging Options](#) | [Main Menu](#)

Permit Number CPMP-9914274 **Applied Date** 01/15/1999
Type Mechanical General - Residential **Issued Date** 01/15/1999

Project Name

Status Closed

Main Parcel 101969

Address 315 NW 110th Ter Kansas City, MO 64155

Description RESIDENTIAL SINGLE FAMILY RESIDENCE INSTALL 1-70,000 BTU FURN,1-2 TON HEAT PUMP, 1-2 TON COIL AND DUCTWORK

[Previous](#) | [Next](#) | [Top](#) | [Paging Options](#) | [Main Menu](#)

Permit Number CPPL-9910965

Type Plumbing General - Residential

Project Name

Status Closed

Main Parcel 101969

Address 315 NW 110th Ter Kansas City, MO 64155

Description RESIDENTIAL PLUMBING SINGLE FAMILY RESIDENCE 99-08908 INSTALL WWV, SET FIX FOR 1 3/4 1/2 BATHS,GAS PIPING, SEWER LINE ON PRIVATE PROPERTY

[Previous](#) | [Next](#) | [Top](#) | [Paging Options](#) | [Main Menu](#)

Permit Number CPZD-201110588

Type Zoning Clearance for Business License

Project Name GAMMING BIG TIME ENTERTAINMENT

Status Issued

Main Parcel 101969

Address 315 NW 110th Ter Kansas City, MO 64155

Description Description of the business: home office for entertainment promotions business. Is this business run from your home? YES

Address Line 1315 NW 110TH TER

[Previous](#) | [Next](#) | [Top](#) | [Paging Options](#) | [Main Menu](#)

Permit Number SEEC-70195400

Type Excavation For Communications Utility

Project Name INSTALL CONDUITS

Status Closed

Main Parcel 101966

Address 315 NW 110th Ter Kansas City, MO 64155

Description Where: In Pavement in front of: 303, 307, 308, 314, 315, 319, 320 NW 110th Ter. - 11022 N Central St. A Bore/Trench Excavation as Follows: Installation of 2" HDPE conduit and 6 handholes on both the north and south sides of NW 110th Ter. and crossing at various locations between the end of the cul-de-sac at 319 NW 110th Ter. an...

[Previous](#) | [Next](#) | [Top](#) | [Paging Options](#) | [Main Menu](#)

Permit Number SEES-70068748

Type Excavation For Sanitary Sewer

Project Name

Status Closed

Main Parcel 101969

Address 315 NW 110th Ter Kansas City, MO 64155

Description

[Previous](#) | [Top](#) | [Paging Options](#) | [Main Menu](#)

Permit Number SEEW-70068787

Type Excavation For Water Pipeline

Project Name

Status Closed

Main Parcel 101969

Address 315 NW 110th Ter Kansas City, MO 64155

Description

Expiration Date

Finalized Date 06/02/1999

Applied Date 11/10/1998

Issued Date 11/10/1998

Expiration Date

Finalized Date 06/02/1999

Applied Date 09/03/2010

Issued Date 09/03/2010

Expiration Date 09/17/2010

Finalized Date

Applied Date 03/27/2014

Issued Date 03/27/2014

Expiration Date 06/25/2014

Finalized Date 07/31/2014

Applied Date 02/04/1999

Issued Date 11/12/1998

Expiration Date 02/10/1999

Finalized Date 02/04/1999

Applied Date 02/04/1999

Issued Date 11/13/1998

Expiration Date 02/11/1999

Finalized Date 02/04/1999

315 NW 110th Ter

Search/Tools Results Print Map Download

< Back to search tools

Parcel Data Parcel Notification

Parcel Data

City PIN: 101969 [Code Cases \(1\)](#)
[Permits \(10\)](#) [Plans \(0\)](#) [Holds \(0\)](#)

Clay County APN: [CL0990500150180001](#)

Plat:

Lot:

Block:

Tract:

Owner: Romeo Homes Kansas LLC
 103 Foulk Rd Ste 900
 Wilmington, DE 19803

Address: 315 NW 110th Ter
[View all addresses \(1\)](#)

Zip code: 64155
[311 Cases](#)

Council District: [1st](#)

Trash Day: Monday (North)

[Neighborhood & Homes Associations](#)

Patrol Division: [North](#)
[Show Special Assessments](#)

Census Neighborhood: Meadowbrook Heights

School District: NORTH KANSAS CITY 250

Park District: North

PW Maint District: D1

Impact Fee Zone: B

Water Inspector Route: 1

MFS Servicer Route: 2

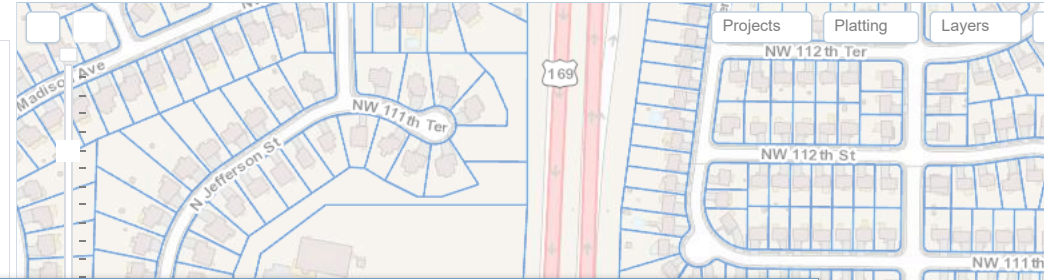

Code Cases

Opened	Case Number	Type	Status	Closed
2022-05-23	NPD-2022-05607	NPD - Property Violations	Complete	2022-06-09

[Close](#)

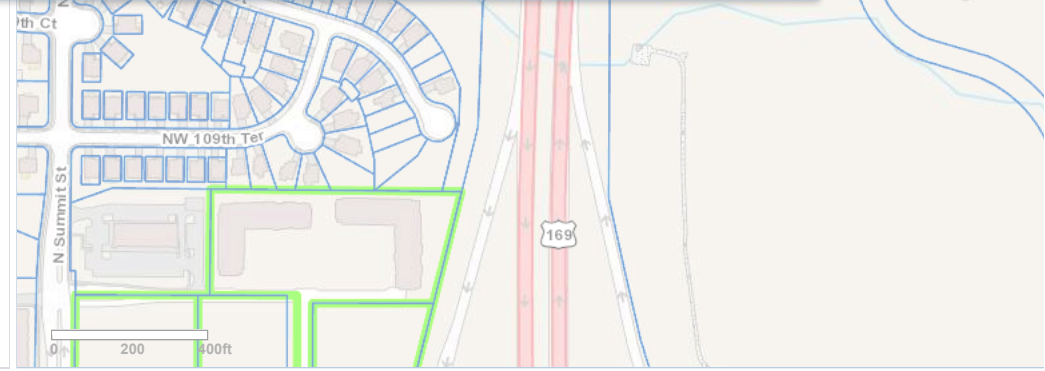



Quick Tax

[Home](#)

Please Note:

- Quick Tax may not disclose all City obligations. Please contact the county where the property is located for more information on additional obligations that may exist.
- Assessed value of property is provided for information only and should not be relied upon for a final determination of value. For the most updated assessed value information, please contact the County Assessor for the county in which the property is located.

Owner ROMEO HOMES KANSAS LLC
Mailing Address 200 BELLEVUE PKWY 210 STE WILMINGTON DE 198093709
Location Address 315 NW 110TH TER KANSAS CITY MO 64155

Total Balance

\$0.00

[Parcel Information](#) [Active Assessments](#) [Pending Assessments](#) [Historical Assessments](#)

County	Clay
Land	5,320
Improvements	25,760
Exempt Land	0
Exempt Improvements	0
Bld Front Footage	0
Council District	2

[GIS Map View of Property](#)



Quick Tax

[Home](#)

Please Note:

- Quick Tax may not disclose all City obligations. Please contact the county where the property is located for more information on additional obligations that may exist.
- Assessed value of property is provided for information only and should not be relied upon for a final determination of value. For the most updated assessed value information, please contact the County Assessor for the county in which the property is located.

Owner ROMEO HOMES KANSAS LLC
Mailing Address 200 BELLEVUE PKWY 210 STE WILMINGTON DE 198093709
Location Address 315 NW 110TH TER KANSAS CITY MO 64155

Total Balance

\$0.00

[Parcel Information](#) [Active Assessments](#) [Pending Assessments](#) [Historical Assessments](#)

There are no active special assessments for this parcel.



Quick Tax

[Home](#)

Please Note:

- Quick Tax may not disclose all City obligations. Please contact the county where the property is located for more information on additional obligations that may exist.
- Assessed value of property is provided for information only and should not be relied upon for a final determination of value. For the most updated assessed value information, please contact the County Assessor for the county in which the property is located.

Owner ROMEO HOMES KANSAS LLC
Mailing Address 200 BELLEVUE PKWY 210 STE WILMINGTON DE 198093709
Location Address 315 NW 110TH TER KANSAS CITY MO 64155

Total Balance

\$0.00

[Parcel Information](#) [Active Assessments](#) [Pending Assessments](#) [Historical Assessments](#)

There are no pending special assessments for this parcel.

Home

Please Note:

- Quick Tax may not disclose all City obligations. Please contact the county where the property is located for more information on additional obligations that may exist.
- Assessed value of property is provided for information only and should not be relied upon for a final determination of value. For the most updated assessed value information, please contact the County Assessor for the county in which the property is located.

Owner ROMEO HOMES KANSAS LLC
Mailing Address 200 BELLEVUE PKWY 210 STE WILMINGTON DE 198093709
Location Address 315 NW 110TH TER KANSAS CITY MO 64155

Total Balance

\$0.00

Parcel Information **Active Assessments** Pending Assessments **Historical Assessments**

Account Id	Assessment Type	Assmnt Date	Tax	Penalty	Interest	Credit
0883311872	Real Estate	31-Dec-2011	\$476.73	\$0.00	\$0.00	(\$476.73)
0883311872	Real Estate	31-Dec-2010	\$479.18	\$0.00	\$0.00	(\$479.18)