

Parcel Number:

04-05-21-000-000-473.000

Computer ID:

2323775

Deed Holder:

ROMEO HOMES KANSAS LLC

Property Address:

716 WESTMINSTER CT
RAYMORE, MO 64083-0000 [MAP THIS ADDRESS](#)

Mailing Address:

103 FOULK RD, STE 900
WILMINGTON, DE 19803-0000 USA

Class:

RESIDENTIAL

Map Area:

RMORE BROOKSIDE

Plat Map:

3809/183

Subdivision:

BROOKSIDE 2ND

Sec-Twp-Rng:

21-46-32

Lot-Block:

72-

Brief Legal Description:

BROOKSIDE 2ND PLAT LOT 72
(NOT TO BE USED ON LEGAL DOCUMENTS)



Pin 04-05-21-000-000-473.000 Photo

1 / 1



Current Value Information

FULL MARKET	Agricultural	Residential	Commercial\Other	Exempt	Total
Land	\$0	\$34,260	\$0	\$0	\$34,260
Building	\$0	\$122,810	\$0	\$0	\$122,810
Total	\$0	\$157,070	\$0	\$0	\$157,070
ASSESSED	Agricultural	Residential	Commercial\Other	Exempt	Total
Land	\$0	\$6,510	\$0	\$0	\$6,510
Building	\$0	\$23,330	\$0	\$0	\$23,330
Total	\$0	\$29,840	\$0	\$0	\$29,840

Prior Year Value Information

2024 Appraised	Agricultural	Residential	Commercial\Other	Exempt	Total
Land Full Market	\$0	\$34,260	\$0	\$0	\$34,260
Building Full Market	\$0	\$122,810	\$0	\$0	\$122,810
Total Full Market	\$0	\$157,070	\$0	\$0	\$157,070
2023 Appraised	Agricultural	Residential	Commercial\Other	Exempt	Total
Land Full Market	\$0	\$34,260	\$0	\$0	\$34,260
Building Full Market	\$0	\$122,810	\$0	\$0	\$122,810
Total Full Market	\$0	\$157,070	\$0	\$0	\$157,070

▼ More Years...

Land Front Foot Information

Lot	Front	Rear	Side 1	Side 2
Main Lot	90.00	90.00	125.00	125.00

Residential Building Information

Occupancy	Style	Year Built	Total Living Area
▼ Single-Family / Owner Occupied	1 Story Frame	2002	1,390

Sale Information

Sale Date	Recording
▼ 06/18/2014	3809/183

Sketch

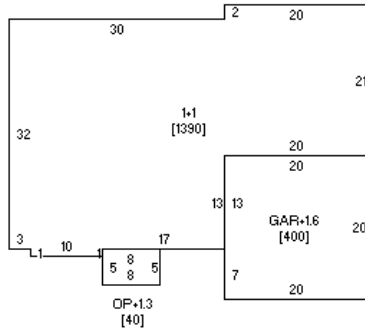

Sketch of Pin 04-05-21-000-000-473.000

1 / 1

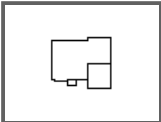

GIS Map Information

