



Parcel Number:

04-05-21-000-000-552.000

Computer ID:

2323851

Deed Holder:

ROMEO HOMES KANSAS LLC

Property Address:

1015 WELLINGTON CT
RAYMORE, MO 64083-0000 [MAP THIS ADDRESS](#)

Mailing Address:

103 FOULK RD, STE 900
WILLMINGTON, DE 19803-0000 USA

Class:

RESIDENTIAL

Map Area:

RMORE BROOKSIDE

Plat Map:

3791/435

Subdivision:

BROOKSIDE 3RD

Sec-Twp-Rng:

21-46-32

Lot-Block:

-

Brief Legal Description:

BROOKSIDE 3RD PLAT LOT 113
(NOT TO BE USED ON LEGAL DOCUMENTS)



Pin 04-05-21-000-000-552.000 Photo

1 / 2



Current Value Information

FULL MARKET	Agricultural	Residential	Commercial\Other	Exempt	Total
Land	\$0	\$31,100	\$0	\$0	\$31,100
Building	\$0	\$165,420	\$0	\$0	\$165,420
Total	\$0	\$196,520	\$0	\$0	\$196,520
ASSESSED	Agricultural	Residential	Commercial\Other	Exempt	Total
Land	\$0	\$5,910	\$0	\$0	\$5,910
Building	\$0	\$31,430	\$0	\$0	\$31,430
Total	\$0	\$37,340	\$0	\$0	\$37,340

Prior Year Value Information

2024 Appraised	Agricultural	Residential	Commercial\Other	Exempt	Total
Land Full Market	\$0	\$31,100	\$0	\$0	\$31,100
Building Full Market	\$0	\$165,420	\$0	\$0	\$165,420
Total Full Market	\$0	\$196,520	\$0	\$0	\$196,520
2023 Appraised	Agricultural	Residential	Commercial\Other	Exempt	Total
Land Full Market	\$0	\$31,100	\$0	\$0	\$31,100
Building Full Market	\$0	\$165,420	\$0	\$0	\$165,420
Total Full Market	\$0	\$196,520	\$0	\$0	\$196,520

▼ More Years...

Land Front Foot Information

Lot	Front	Rear	Side 1	Side 2
Main Lot	72.00	72.00	129.00	129.00

Residential Building Information

Occupancy	Style	Year Built	Total Living Area
▼ Single-Family / Owner Occupied	Split Level Frame	2005	1,433

Sale Information

Sale Date	Recording
▼ 04/24/2014	3791/435
▼ 06/21/2013	3705/190

Sketch

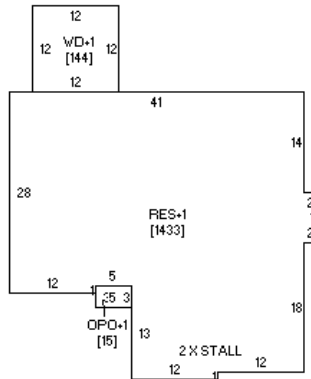

Sketch of Pin 04-05-21-000-000-552.000

1 / 1

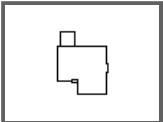

GIS Map Information

