

Property Information		Request Information		Update Information	
File#:	24-2204983	Requested Date:	08/07/2024	Update Requested:	
Owner:	Romeo Homes Kansas LLC	Branch:		Requested By:	
Address 1:	1015 Wellington Court	Date Completed:		Update Completed:	
Address 2:		# of Jurisdiction(s):			
City, State Zip:	Raymore, MO 64083	# of Parcel(s):	1		

Notes

CODE VIOLATIONS Per City of Raymore Department of Zoning there are no Code Violation cases on this property.

Collector:City of Raymore
Payable Address: 100 Municipal Circle, Raymore, MO 64083
Business# 816-892-3012

PERMITS Per City of Raymore Building Department there are no Open/Pending/ Expired Permit on this property.

Collector: City of Raymore
Payable Address: 100 Municipal Circle, Raymore, MO 64083
Business# 816-892-3012

SPECIAL ASSESSMENTS Per City of Raymore Department of Finance there are no Special Assessments/liens on the property.

Collector: City of Raymore
Payable Address: 100 Municipal Circle, Raymore, MO 64083
Business# 816-892-3012

DEMOLITION NO

UTILITIES Water / Sewer / Garbage

Account #: N/A
Payment Status: N/A
Status: Pvt & Lienable
Amount: N/A
Good Thru: N/A
Account Active: N/A
Collector: Raymore Water Department
Payable Address: 100 Municipal Cir, Raymore, MO 64083
Business # (816) 331-5182

UNABLE TO PROVIDE INFORMATION TO THIRD PARTIES. HOMEOWNERS NEEDS TO CONTACT THE UTILITY DEPARTMENT FOR ACCOUNT DETAILS.

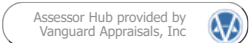

Parcel Number:

04-05-21-000-000-552.000

Computer ID:

2323851

Deed Holder:

ROMEO HOMES KANSAS LLC

Property Address:

1015 WELLINGTON CT
RAYMORE, MO 64083-0000 [MAP THIS ADDRESS](#)

Mailing Address:

103 FOULK RD, STE 900
WILLMINGTON, DE 19803-0000 USA

Class:

RESIDENTIAL

Map Area:

RMORE BROOKSIDE

Plat Map:

3791/435

Subdivision:

BROOKSIDE 3RD

Sec-Twp-Rng:

21-46-32

Lot-Block:

-

Brief Legal Description:

BROOKSIDE 3RD PLAT LOT 113
(NOT TO BE USED ON LEGAL DOCUMENTS)



Pin 04-05-21-000-000-552.000 Photo

1 / 2



Current Value Information

FULL MARKET	Agricultural	Residential	Commercial\Other	Exempt	Total
Land	\$0	\$31,100	\$0	\$0	\$31,100
Building	\$0	\$165,420	\$0	\$0	\$165,420
Total	\$0	\$196,520	\$0	\$0	\$196,520
ASSESSED	Agricultural	Residential	Commercial\Other	Exempt	Total
Land	\$0	\$5,910	\$0	\$0	\$5,910
Building	\$0	\$31,430	\$0	\$0	\$31,430
Total	\$0	\$37,340	\$0	\$0	\$37,340

Prior Year Value Information

2024 Appraised	Agricultural	Residential	Commercial\Other	Exempt	Total
Land Full Market	\$0	\$31,100	\$0	\$0	\$31,100
Building Full Market	\$0	\$165,420	\$0	\$0	\$165,420
Total Full Market	\$0	\$196,520	\$0	\$0	\$196,520
2023 Appraised	Agricultural	Residential	Commercial\Other	Exempt	Total
Land Full Market	\$0	\$31,100	\$0	\$0	\$31,100
Building Full Market	\$0	\$165,420	\$0	\$0	\$165,420
Total Full Market	\$0	\$196,520	\$0	\$0	\$196,520

▼ More Years...

Land Front Foot Information

Lot	Front	Rear	Side 1	Side 2
Main Lot	72.00	72.00	129.00	129.00

Residential Building Information

Occupancy	Style	Year Built	Total Living Area
▼ Single-Family / Owner Occupied	Split Level Frame	2005	1,433

Sale Information

Sale Date	Recording
▼ 04/24/2014	3791/435
▼ 06/21/2013	3705/190

Sketch

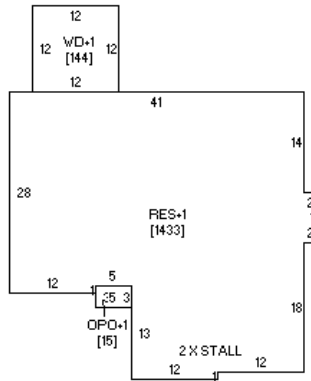

Sketch of Pin 04-05-21-000-000-552.000

1 / 1

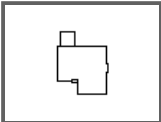

GIS Map Information



From: Erica Hill <ehill@raymore.com>
Sent: Thursday, August 1, 2024 11:17 PM

Subject: Open Record Requests

I have received your requests for the following information for the 15 addresses listed below.

1. OPEN/PENDING/EXPIRED Permits and demolition permits that need attention and any fees due currently.
2. Open Code Violations or fines due that need attention currently.
3. Unrecorded liens/fines/special assessments due.

Addresses:

1015 Bristol Drive, 04-05-21-000-000-005.114
733 Carlisle Drive, 04-05-21-000-000-005.097
1015 Wellington Court, 04-05-21-000-000-552.000
2188 East Sierra Drive, 04-01-12-000-000-032.087
526 Bradford Court, 04-01-12-000-000-032.104
413 W Heritage Drive, 04-02-09-400-000-001.047
408 W Heritage Drive, 04-02-09-400-000-001.042
416 Wiltshire Drive, 04-02-09-400-000-001.056
414 W Heritage Drive, 04-02-09-400-000-001.045
415 Wiltshire Drive, 04-02-09-400-000-001.068
819 Garnes Street, 04-04-20-000-000-680.000
1518 Eagle Glen Circle, 04-04-17-400-001-002.121
716 Westminster Court, 04-05-21-000-000-473.000
1703 Rolling Rock Rd, 04-04-20-000-000-188.000
735 Carlisle Dr, 04-05-21-000-000-005.098

There are no open, pending, or expired permits or demolition permits that need attention or fees due, no code assessments, and no open violations for any of these properties.

Please confirm receipt.

Erica Hill, CMC/MRCC

City Clerk

City of Raymore

100 Municipal Circle, Raymore, MO 64083

P: 816-892-3012 F: 816-331-8724

ehill@raymore.com

www.Raymore.com/CityClerk