



**Parcel Number:**  
04-05-21-000-000-005.114

**Computer ID:**  
2326730

**Deed Holder:**  
ROMEO HOMES KANSAS LLC

**Property Address:**  
1015 BRISTOL DR  
RAYMORE, MO 64083-0000 [MAP THIS ADDRESS](#)

**Mailing Address:**  
103 FOULK RD, STE 900  
WILMINGTON, DE 19803-0000 USA

**Class:**  
RESIDENTIAL

**Map Area:**  
RMORE BROOKSIDE

**Plat Map:**  
3795/168

**Subdivision:**  
BROOKSIDE 7TH

**Sec-Twp-Rng:**  
21-46-32

**Lot-Block:**  
297-

**Brief Legal Description:**  
BROOKSIDE 7TH PLAT LOT 297  
**(NOT TO BE USED ON LEGAL DOCUMENTS)**



Pin 04-05-21-000-000-005.114 Photo

1 / 1



**Current Value Information**

FULL MARKET	Agricultural	Residential	Commercial\Other	Exempt	Total
Land	\$0	\$33,860	\$0	\$0	\$33,860
Building	\$0	\$128,640	\$0	\$0	\$128,640
<b>Total</b>	\$0	\$162,500	\$0	\$0	\$162,500
ASSESSED	Agricultural	Residential	Commercial\Other	Exempt	Total
Land	\$0	\$6,430	\$0	\$0	\$6,430
Building	\$0	\$24,440	\$0	\$0	\$24,440
<b>Total</b>	\$0	\$30,870	\$0	\$0	\$30,870

**Prior Year Value Information**

2024 Appraised	Agricultural	Residential	Commercial\Other	Exempt	Total
Land Full Market	\$0	\$33,860	\$0	\$0	\$33,860
Building Full Market	\$0	\$128,640	\$0	\$0	\$128,640
<b>Total Full Market</b>	\$0	\$162,500	\$0	\$0	\$162,500
2023 Appraised	Agricultural	Residential	Commercial\Other	Exempt	Total
Land Full Market	\$0	\$33,860	\$0	\$0	\$33,860
Building Full Market	\$0	\$128,640	\$0	\$0	\$128,640
<b>Total Full Market</b>	\$0	\$162,500	\$0	\$0	\$162,500

▼ More Years...

Land Front Foot Information

Lot	Front	Rear	Side 1	Side 2
Main Lot	80.05	80.05	124.94	124.93

Residential Building Information

Occupancy	Style	Year Built	Total Living Area
▼ Single-Family / Owner Occupied	1 Story Frame	2005	1,330

Sale Information

Sale Date	Recording
▼ 04/29/2014	3795/168

Sketch

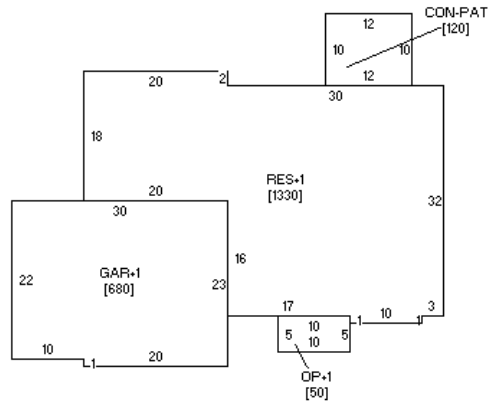

Sketch of Pin 04-05-21-000-000-005.114

1 / 1

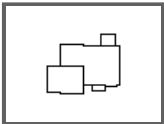

GIS Map Information

