

County of Lehigh Online Records Access

Property Details

Street View



Footprint

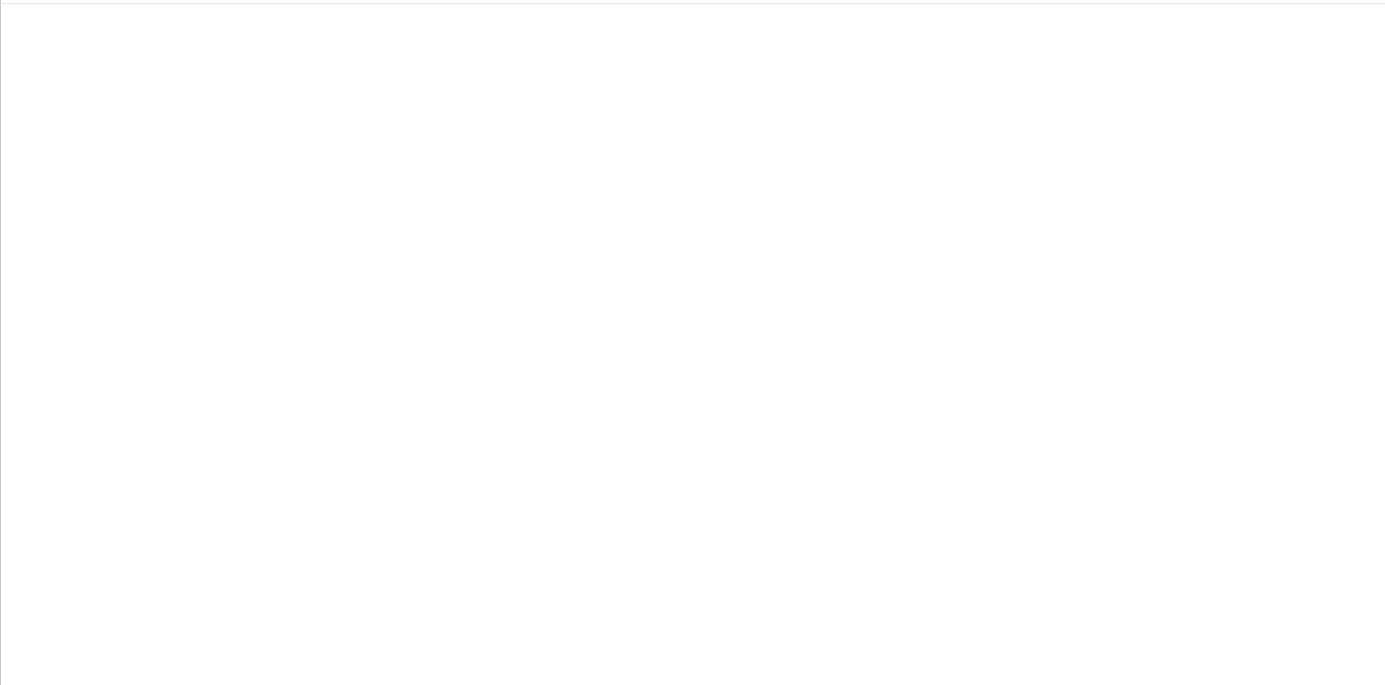

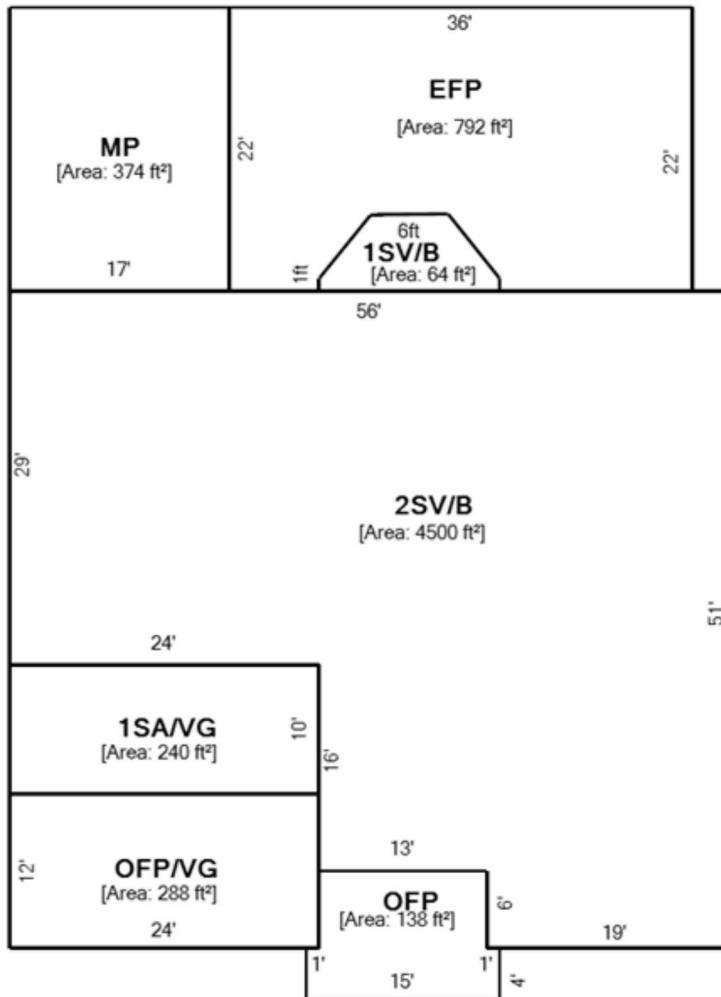

[Sketch Codes](#)

Options

[Back To Results](#)

[New Search](#)

[Create PDF](#)

Property Overview

2024

Owner Name

YACOB MUNZER A

Owner Address

1001 N 9TH ST
WHITEHALL PA 18052-6901

Property Address

906 W LIVINGSTON ST
WHITEHALL PA 18052

Parcel Viewer

[View in Parcel Viewer](#)

Low Number

0906

High Number		
0906		
Sub Division		
ALLENCREST		
Tax Authority		
WHITEHALL TOWNSHIP		
School District		
WHITEHALL-COPLAY SCHOOL DISTRICT		
Parcel Id		
549775846144 1		
Old Parcel Id		
25 G09NE4D 015 007		
Tile		
475908C		
Acres/Dimension		
75 X 110 IRREG		
Lot Sq Ft		
9581		
Utilities		
PUBLIC WATER/SEWER		
Class		
RESIDENTIAL		
Land Use		
SINGLE FAMILY - DETACHED		
Living Units		
1		
Zoning		
R-4		
Homestead Act 72		
Rejected on 03/01/2013. THE PROPERTY IS NOT YOUR PRIMARY RESIDENCE.		
Preferential Land Act		
NO		
Agricultural Easement		
NO		
Assessment Base Year		
2013		
Total Assessment		
Exempt Land		0
Exempt Building		0
Taxable Land		32,700
Taxable Building		357,200
Total		389,900
Taxable Total		389,900
Estimated Taxes		
	Mills	Estimated Taxes
County	3.780000	\$ 1,473.82
School	21.689800	\$ 8,456.85

Municipality	3.800000	\$ 1,481.62
Total		\$ 11,412.29
Bill Number		
2509397		
LC_PropertyAddress		
906 W LIVINGSTON ST WHITEHALL PA 18052		

Basic Residential Profile	
Type of Residence	
SINGLE FAMILY - DETACHED	
Number of Stories	
2 STORY	
Type of Construction	
ALUMINIUM/VINYL	
Type of Basement	
FULL	
Type of Heating/Cooling	
CENTRAL AIR	
Type of Garage	
ATTACHED TWO CAR OR MORE	
Number of Full Bathrooms	
3	
Number of Half Bathrooms	
1	
Fireplaces	
0	
Square Feet	
4804	
Year Built	
2007	
Pool	
NO POOL	
Implement Buildings	
NO IMPLEMENT BLDG	

Residential Profile Data With No Influence on Assessment Value	
Total Rooms	
9	
Number of Bedrooms	
4	
Family Rooms	
1	

Sales History			
Sale Date	Owner Name	Document Id	Sale Price

09/1998	YACOUB MUNZER A	1619/0833	\$ 10,500
10/1987	DERFLER DONALD S & PAMELA W	1403/0492	\$ 18,000
12/1982	BINES DAVID R & WILLIANN L	1313/0132	\$ 22,500
11/1980	JOSEPH ESAU T	1288/0063	\$ 58,000