



Property Information Request Information Update Information

File#: BF-X01738-441292897
Owner: R BISBEE LILLIAN
Address 1: 58 EAST ST
Address 2:
City, State Zip: CHESTERFIELD, MA

Requested Date: 08/12/2024
Branch:
Date Completed:
of Jurisdiction(s):
of Parcel(s): 1

Update Requested:
Requested By:
Update Completed:

Notes

CODE VIOLATIONS Per Chesterfield Township Department of Zoning there are no Code Violation cases on this property.

Collector: Chesterfield Township
Payable Address: 422 Main Road Chesterfield, MA 01012
Business # (413) 296-0127

PERMITS Per Chesterfield Township Department of Building there are no Open/Pending/ Expired Permit on this property.

Collector: Chesterfield Township
Payable Address: 422 Main Road Chesterfield, MA 01012
Business # (413) 296-0127

SPECIAL ASSESSMENTS Per Chesterfield Township Tax Collector there are no Special Assessments/liens on the property.

Collector: Chesterfield Township
Payable Address: 422 Main Road Chesterfield, MA 01012
Business # (413) 296-4771

UNABLE TO PROVIDE DOCUMENTATION TO THIRD PARTIES. VERBAL INFO ACQUIRED

DEMOLITION NO

UTILITIES WATER AND SEWER
THE HOUSE IS ON A COMMUNITY WATER & SEWER. ALL HOUSES GO TO A SHARED WELL & SEPTIC SYSTEM.

GARBAGE
GARBAGE PRIVATE HAULER WITH LIEN STATUS AND BALANCE UNKNOWN

Key: 392

Town of CHESTERFIELD - Fiscal Year 2024

12/3/2023 5:36 pm SEQ#: 389

LAND

CURRENT OWNER						PARCEL ID				LOCATION					
BISBEE HENRY B BISBEE LILLIAN R 58-A EAST ST CHESTERFIELD, MA 01012						32-27-0				58 EAST ST					
						TRANSFER HISTORY				DOS	T	SALE PRICE		BK-PG (Cert)	
						BISBEE HENRY B				09/26/1994	A	1 4561-42			
						BISBEE CHARLES A				09/26/1994	A	1 N/A-N/A			
BISBEE HENRY B				06/05/1972	A	1 N/A-N/A									
CD	T	AC/SF/UN	Nbhd	St Ind	Loc	ADJ BASE	SAF	Infl	Lpi	VC	CREDIT AMT	ADJ VALUE			
100	A	1.250	2	1.00	19	1.00	A	1.00	R4	1.00		32,500			

LAND

TOTAL	1.250 Acres	ZONING	1	FRNT	924	ASSESSED	CURRENT	PREVIOUS
Nbhd	SOUTH CHF	NOTE				LAND	32,500	31,200
St Ind	EAST					BUILDING	336,300	286,100
Loc	AVG					DETACHED	11,400	10,900
						OTHER	0	0
						TOTAL	380,200	328,200

DETACHED

TY	QUAL	COND	DIM/NOTE	YB	UNITS	ADJ PRICE	RCNLD
SHF	A	1.00	60 0.40		154	13.13	800
FBN	-	0.90	50 0.50		800	26.47	10,600



BUILDING

BUILDING	CD	ADJ	DESC	MEASURE	9/19/2018	RJM
MODEL	1		RESIDENTIAL	LIST	9/19/2018	EST
STYLE	7	1.20	CONV/OLD STYLE [100%]	REVIEW	9/28/2018	WJB
QUALITY	A	1.00	AVERAGE [100%]			
FRAME	1	1.00	WOOD FRAME [100%]			

BLDG COMMENTS
VACANT

BLDG

YEAR BLT	1835	SIZE ADJ	1.000	ELEMENT	CD	DESCRIPTION	ADJ	S	BAT	T	DESCRIPTION	UNITS	YB	ADJ PRICE	RCN
NET AREA	3.023	DETAIL ADJ	1.188	FOUNDATION	4	FLR & WALL	1.00	A	OPA	N	OPEN PORCH	200		50.70	10,140
\$NLA(RCN)	\$206	OVERALL	1.000	EXT. COVER	2	CLAPBOARD	1.00	+	BMU	N	BSMT UNFINISHED	1,436		45.45	65,265
				ROOF SHAPE	5	MANSARD	1.00	B	USF	L	UPPER STORY FIN	1,244	1835	166.52	207,153
				ROOF COVER	1	ASPH/CMP SHIN	1.00	+	BAS	L	BASE AREA	1,779	1835	166.52	296,242
STORIES	2		1.00	FLOOR COVER	1	HARDWOOD	1.00	F	AGR	N	ATT GARAGE	252		63.80	16,078
ROOMS	10		1.00	INT. FINISH	1	PLASTER	1.00	G	CPA	N	CAR PORT	336		20.40	6,856
BEDROOMS	5		1.00	HEATING/COOL	4	STEAM	0.99	H	ASH	N	ATT SHED	288		24.95	7,185
BATHROOMS	2		1.00	FUEL SOURCE	1	OIL	1.00	F21	O	O	FPL 2S 1OP	1		8,121.00	8,121
FIXTURES	6	\$5,702													
GARAGE SPACES	1		1.00												
% BSMT FIN	0		1.00												
# 1/2 BATHS	0		1.00												
# OF UNITS	1		1.00												

CLASS	CLASS%	DESCRIPTION			BN ID	BN	CARD	
1010	100	SINGLE FAMILY				1	1 of 1	
PMT NO	PMT DT	TY	DESC	AMOUNT	INSP	BY	1st	%
53	12/30/1987	3	CYC. REINSP. RENOVATIONS	1,000	09/19/2018	RJM	100	100
					06/30/1988	ER	100	100

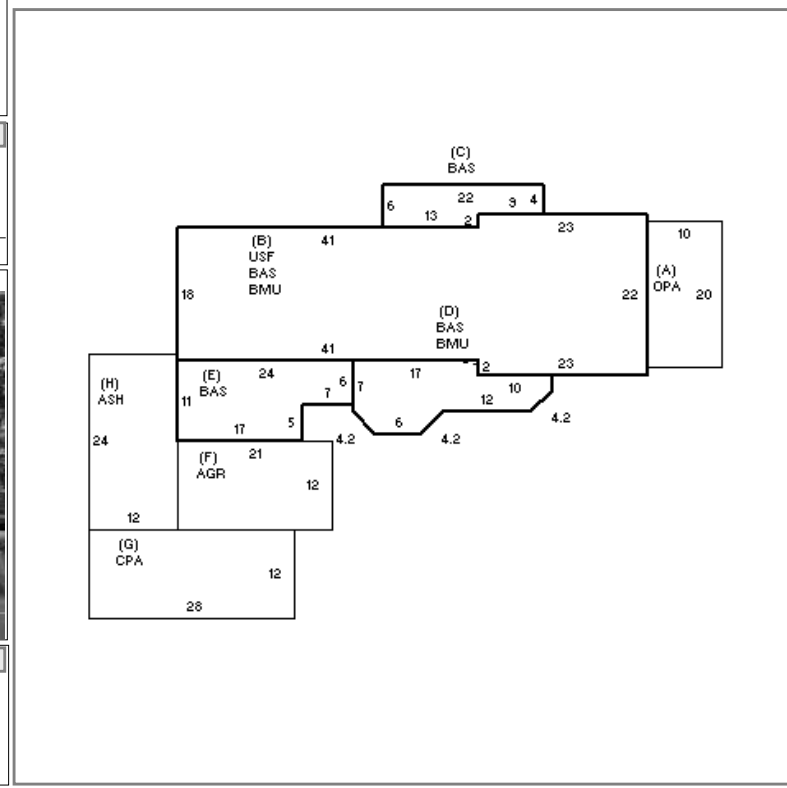

BLDG

TOTAL RCN	622,742
CONDITION ELEM	CD
EXTERIOR	F
INTERIOR	F
KITCHEN	F
BATHS	F
HEAT	A
ELECT	A
EFF.YR/AGE	1963 / 59
COND	46 46 %
FUNC	0
ECON	0
DEPR	46 % GD 54
RCNLD	\$336,300

Code/permit/Special assessment Request - 58 EAST ST

From: Chesterfield Building <building@townofchesterfieldma.com>

Sent:

To:

Subject: Re: Code/permit/Special assessment Request - 58 EAST ST

There are no open permits or violations from my department at that address.

Best,
Jason