

# 45 HOOPER ST

**Location** 45 HOOPER ST

**Mblu** 1076F/ 305/ 244/ /

**Acct#** 00183601

**Owner** MILLER DONA

**Assessment** \$621,400

**PID** 1471

**Building Count** 1

**Assessing District**

## Current Value

Assessment			
Valuation Year	Improvements	Land	Total
2024	\$353,700	\$267,700	\$621,400

## Owner of Record

**Owner** MILLER DONA  
**Co-Owner** MARK W  
**Care Of**  
**Address** 45 HOOPER ST  
QUINCY, MA 02169

**Sale Price** \$345,000  
**Book & Page** 17615/0415  
**Sale Date** 11/14/2002  
**Instrument** 1A

## Ownership History

Ownership History				
Owner	Sale Price	Book & Page	Instrument	Sale Date
MILLER DONA	\$345,000	17615/0415	1A	11/14/2002
MOHAMMED NUHU	\$169,000	14912/0551	NA	04/11/2001
OKEEFE JOHN M JR &	\$149,000	11830/0479	1N	05/29/1997

## Building Information

### Building 1 : Section 1

**Year Built:** 1905  
**Living Area:** 2,120  
**Replacement Cost:** \$552,183  
**Building Percent Good:** 64  
**Replacement Cost Less Depreciation:** \$353,400

Building Attributes	
Field	Description
Style:	Colonial
Model	Residential
Grade:	AVERAGE

Stories:	2
Occupancy	1
Exterior Wall 1	Wood Shingle
Exterior Wall 2	
Roof Structure:	Gambrel
Roof Cover	Asphalt
Interior Wall 1	Plastered
Interior Wall 2	
Interior Flr 1	Carpet
Interior Flr 2	
Heat Fuel	Gas
Heat Type:	Hot Water
AC Type:	None
Total Bedrooms:	3 Bedrooms
Total Bthrms:	1 Full
Total Half Baths:	1
Total Xtra Fixtrs:	
Total Rooms:	6
Bath Style:	Average
Kitchen Style:	SModern
Extra Kitchens	
Cndtn	
Num Park	
Fireplaces	
Fndtn Cndtn	
Basement	

### Building Photo



([https://images.vgsi.com/photos/QuincyMAPphotos/A0107/Copy%20of%20C HOOPER-ST\\_NO-SCAN\\_1471\\_20210311\\_125949\\_107885.jpg](https://images.vgsi.com/photos/QuincyMAPphotos/A0107/Copy%20of%20C HOOPER-ST_NO-SCAN_1471_20210311_125949_107885.jpg))

### Building Layout

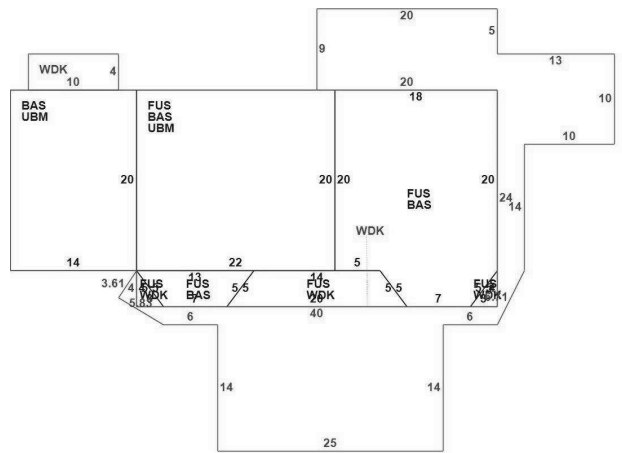

([ParcelSketch.ashx?pid=1471&bid=1471](#))

Building Sub-Areas (sq ft)			Legend
Code	Description	Gross Area	Living Area
BAS	First Floor	1,160	1,160
FUS	Upper Story, Finished	960	960
UBM	Basement, Unfinished	720	0
WDK	Deck, Wood	913	0
		3,753	2,120

### Extra Features

Extra Features				Legend
Code	Description	Size	Assessed Value	Bldg #
SLR	SOLAR	23.00 UNITS	\$0	1

### Land

#### Land Use

**Use Code** 1010  
**Description** Single Fam  
**Neighborhood** 50

#### Land Line Valuation

**Size (Sqr Feet)** 12000  
**Assessed Value** \$267,700

## Outbuildings

Outbuildings						Legend
Code	Description	Sub Code	Sub Description	Size	Assessed Value	Bldg #
SHD3	METAL			64.00 S.F.	\$300	1

## Valuation History

Assessment			
Valuation Year	Improvements	Land	Total
2024	\$353,700	\$267,700	\$621,400
2023	\$328,500	\$244,100	\$572,600
2022	\$312,600	\$213,400	\$526,000