

PROPERTY INFORMATION	
Parcel Number 37-3N-28-0740-0203-0000	
Owner Name	WGH FLORIDA LLC
Mailing Address	103 FOULK RD STE 900 WILMINGTON, DE 19803
Location Address	96495 COMMODORE POINT DR YULEE 32097
Tax District	004 - UNINCORPORATED COUNTY
Milage	15.0452
Homestead	No
Property Usage	SINGLE FAMILY 000100
Deed Acres	0
Short Legal	LOT 203 IN OR 1936/1012 HERON ISLES PHASE 1 REPLAT

2024 Preliminary Values	
Land Value	\$55,000
(+) Improved Value	\$192,186
(=) Market Value	\$247,186
(-) Agricultural Classification	\$0
(-) SOH or Non-Hx* Capped Savings	\$30,542
(=) Assessed Value	\$216,644
(-) Homestead	\$0
(-) Additional Exemptions	\$0
(=) School Taxable Value	\$247,186
(-) Non-School HX & Other Exempt Value	\$0
(=) County Taxable Value	\$216,644

Note - *10% Cap does not apply to School Taxable Value

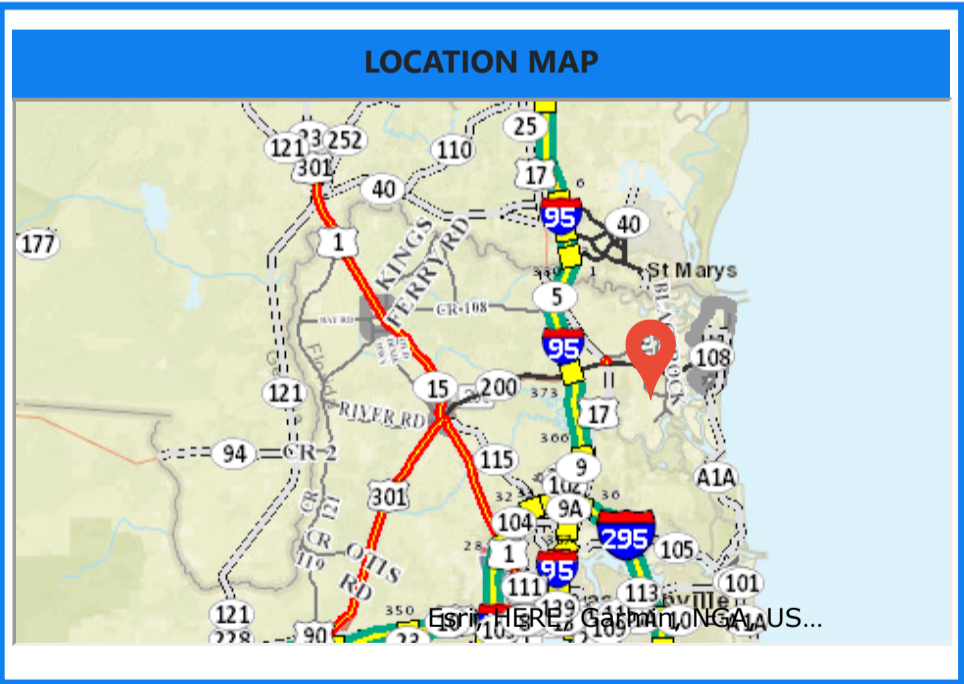
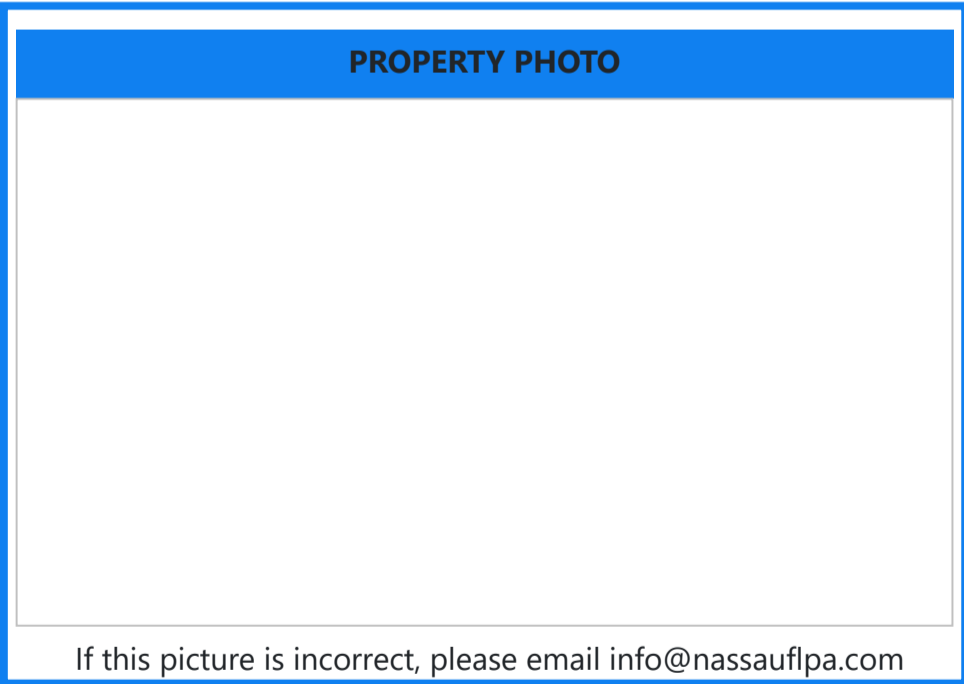
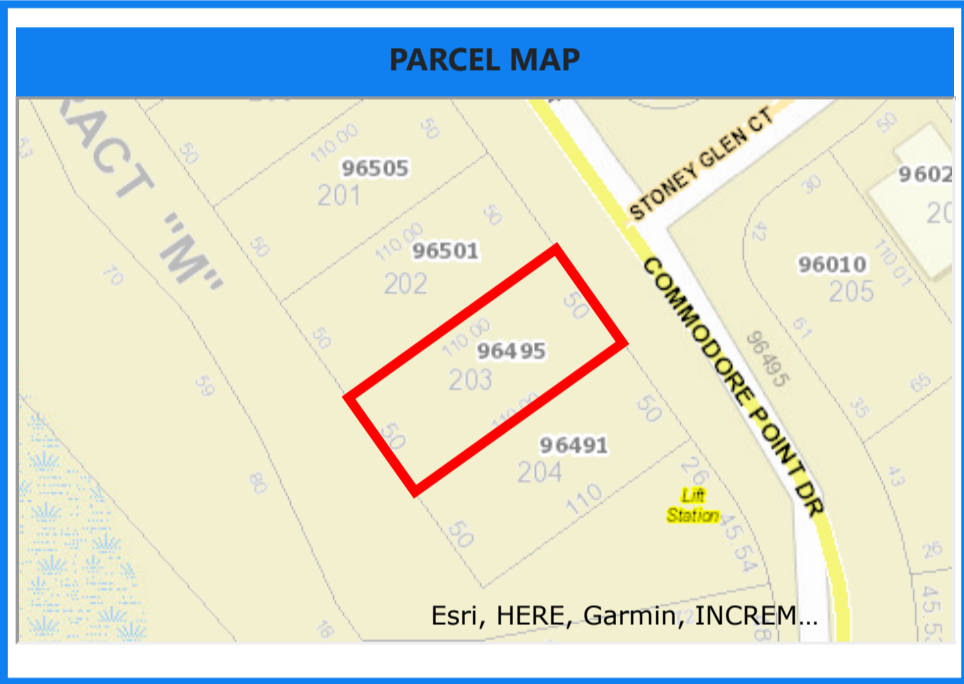

BUILDING INFORMATION									
Type	Total Area	Heated Area	Bedrooms	Baths	Primary Exterior	Secondary Exterior	Heating	Cooling	Actual Year Built
SINGLE FAM	1953	1437	3	2	WD FR STUC	AVERAGE	AIR DUCTED	FORCED AIR	2014



MISCELLANEOUS INFORMATION

Description	Dimensions L X W	Units	Year Built
CONCRETE B	0 X 0	685	2014
CONCRETE B	0 X 0	0	0

SALES INFORMATION

Sale Date	Book Page	Price	Instr	Qual	Imp	Grantor	Grantee
2014-08-15	1936 / 1012	\$20,000	WD	U	V	HERON ISLES JOINT VENTURE LLP	WGH FLORIDA LLC