

Property Information		Request Information		Update Information	
File#:	24-2204923	Requested Date:	08/26/2024	Update Requested:	
Owner:	Romeo Homes Kansas LLC	Branch:		Requested By:	
Address 1:	587 Kreisel Drive	Date Completed:		Update Completed:	
Address 2:		# of Jurisdiction(s):			
City, State Zip:	Raymore, MO 64083	# of Parcel(s):	1		

Notes

CODE VIOLATIONS	<p>Per City of Raymore Department of Zoning there are no Code Violation cases on this property.</p> <p>Collector: City of Raymore Payable Address: 100 Municipal Circle, Raymore, MO 64083 Business# 816-892-3012</p>
PERMITS	<p>Per City of Raymore Building Department there are no Open/Pending/ Expired Permit on this property.</p> <p>Collector: City of Raymore Payable Address: 100 Municipal Circle, Raymore, MO 64083 Business# 816-892-3012</p>
SPECIAL ASSESSMENTS	<p>Per City of Raymore Department of Finance there are no Special Assessments/liens on the property.</p> <p>Collector: City of Raymore Payable Address: 100 Municipal Circle, Raymore, MO 64083 Business# 816-892-3012</p> <p>UNABLE TO PROVIDE INFORMATION TO THIRD PARTIES. VERBAL INFO ACQUIRED.</p>
DEMOLITION	NO
UTILITIES	<p>Water, Sewer and Trash</p> <p>Account #: N/A Amount : N/A Payment status: N/A Good Thru: NA Account Active: N/A Status: Pvt & Non-Lienable Collector : Raymore Water Department Payable Address: 100 Municipal Cir, Raymore, MO 64083 Business# 816-331-5182</p> <p>UNABLE TO PROVIDE INFORMATION TO THIRD PARTIES. HOMEOWNERS NEEDS TO CONTACT THE UTILITY DEPARTMENT FOR ACCOUNT DETAILS</p>

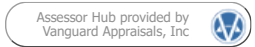

Parcel Number:

04-04-17-000-000-006.011

Computer ID:

2319011

Deed Holder:

ROMEO HOMES KANSAS LLC

Property Address:

587 KREISEL DR
RAYMORE, MO 64083-0000 [MAP THIS ADDRESS](#)

Mailing Address:

103 FOULK RD, STE 900
WILMINGTON, DE 19803-0000 USA

Class:

RESIDENTIAL

Map Area:

RMORE LEMOR EST

Plat Map:

3793/266

Subdivision:

LEMOR EST

Sec-Twp-Rng:

17-46-32

Lot-Block:

15-

Brief Legal Description:

LEMOR ESTATES LOT 15
(NOT TO BE USED ON LEGAL DOCUMENTS)



Pin 04-04-17-000-000-006.011 Photo

1 / 1



Current Value Information

FULL MARKET	Agricultural	Residential	Commercial\Other	Exempt	Total
Land	\$0	\$30,320	\$0	\$0	\$30,320
Building	\$0	\$168,190	\$0	\$0	\$168,190
Total	\$0	\$198,510	\$0	\$0	\$198,510
ASSESSED	Agricultural	Residential	Commercial\Other	Exempt	Total
Land	\$0	\$5,760	\$0	\$0	\$5,760
Building	\$0	\$31,960	\$0	\$0	\$31,960
Total	\$0	\$37,720	\$0	\$0	\$37,720

Prior Year Value Information

2024 Appraised	Agricultural	Residential	Commercial\Other	Exempt	Total
Land Full Market	\$0	\$30,320	\$0	\$0	\$30,320
Building Full Market	\$0	\$168,190	\$0	\$0	\$168,190
Total Full Market	\$0	\$198,510	\$0	\$0	\$198,510
2023 Appraised	Agricultural	Residential	Commercial\Other	Exempt	Total
Land Full Market	\$0	\$30,320	\$0	\$0	\$30,320
Building Full Market	\$0	\$168,190	\$0	\$0	\$168,190
Total Full Market	\$0	\$198,510	\$0	\$0	\$198,510

▼ More Years...

Land Front Foot Information

Lot	Front	Rear	Side 1	Side 2
Main Lot	66.00	83.00	125.00	125.00

Residential Building Information

Occupancy	Style	Year Built	Total Living Area
▼ Single-Family / Owner Occupied	Split Foyer Frame	2013	1,181

Sale Information

Sale Date	Recording
▼ 05/01/2014	3793/266
▼ 04/05/2013	3677/237

Sketch

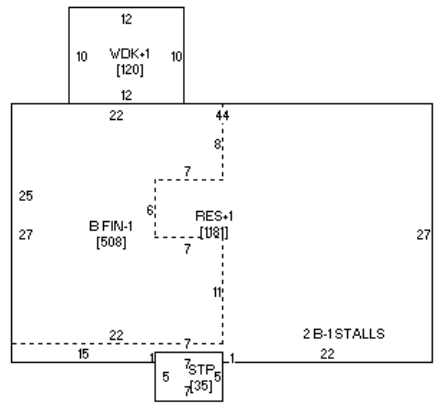

Sketch of Pin 04-04-17-000-000-006.011

1 / 1

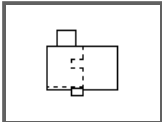

GIS Map Information



Code Enforcement Request

From: Erica Hill <ehill@raymore.com>
Sent: Friday, August 9, 2024 9:58 PM
Subject: Re: Code Enforcement Request

Good morning,

None of the addresses below have open code violations at this time.
None of the addresses have any open or expired permits.

Thank you,

Erica Hill, CMC/MRCC

City Clerk

City of Raymore

100 Municipal Circle, Raymore, MO 64083

P: 816-892-3012 F: 816-331-8724

ehill@raymore.com

www.Raymore.com/CityClerk

Could you please advise if the below properties have any Open Code Violations currently.

1. 814 Derby Street // 04-05-21-000-000-352.000
2. 587 Kreisel Drive // 04-04-17-000-000-006.011
3. 717 Furlong Drive // 04-05-21-000-000-222.000
4. 814 Canter Street // 04-05-21-000-000-379.000
5. 1608 Johnston Drive // 04-04-17-000-000-069.000
6. 589 Kreisel Drive // 04-04-17-000-000-006.010
7. 713 Derby Street // 04-05-21-000-000-318.000
8. 1114 Tudor Drive // 04-02-09-000-000-095.000
9. 308 Shenandoah Drive// 04-02-10-300-001-038.000
10. 328 Shenandoah Drive // 04-02-10-300-001-028.000