



PROPERTY TAX
Marshall County, Alabama

Current Date: 10/28/2024 Tax Year: 2023 (Billing Year: 2023)

You are currently viewing a record for the 2023 tax year which began October 1, 2022 and ended September 30, 2023

Parcel Info

PIN 62786
PARCEL 23-06-24-0-000-003.001
ACCOUNT NUMBER 96782

OWNER GARRETT, JUSTIN DAVID & SHELIA F
MAILING ADDRESS 510 HIGHLAND ST, BOAZ, AL 35957
PROPERTY ADDRESS 200 MAPLE LANE

LEGAL DESCRIPTION COM SE COR NE1/4 SEC 24-10-3E THN N 558' TO POB THN SWLY 305.58'; NWLY 609.81'; E 515.71'; S 425.14' TO POB CONT 5 AC
EXEMPT CODE
TAX DISTRICT County



Tax Information

TAXES WERE DUE BEGINNING 10/1/2023, DELINQUENT AFTER 12/31/2023

PPIN	YEAR	TAX TYPE	TAXES	PENALTIES / INTEREST	SUBTOTAL	AMT PAID	BALANCE DUE
62786	2023	REAL	\$ 1,303.50	\$ 0.00	\$ 1,303.50	\$ 1,303.50	\$ 0.00

Total Due: \$ 0.00

LAST PAYMENT DATE 11/17/2023
PAID BY SHELLPOINT MORTGAGE SERVICES

Property Values

Total Acres 5.00
Use Value \$0
Land Value \$36,000
Improvement Value \$137,800
Total Appraised Value \$173,800
Total Taxable Value \$173,800
Assessment Value \$34,760

Subdivision Information

Code
Name
Lot
Block
Type / Book / Page N/A / 2869 / 0000098
S/T/R 00-00-00

Detail Information

TYPE	REF	DESCRIPTION	LAND USE	TC	HS	PN	APPRAISED VALUE
LAND	1	5.000 Acres	111-SINGLE FAMILY RESIDENCE	2	N	N	\$36,000
RES/COM	1	111 - SINGLE FAMILY	-	2	N	N	\$122,600
GARAGE	2	24WCBF - GARAGE WOOD OR C.B. FLOOR	-	2	N	N	\$15,200

Building Components

Improvement

Year Built	1979
Structure	SINGLE FAMILY
Structure Code	111
Total Living Area	1816
Building Value	N/A

Computations

Stories	1.0
1st Level Sq. Ft.	1816
Add'l Level Sq. Ft.	0
Total Living Area	1816
Total Adjusted Area	2437

Improvement

Year Built	0
Structure	GARAGE WOOD OR C.B. FLOOR
Structure Code	24WCBF
Total Living Area	720
Building Value	N/A

Computations

Stories	1.0
1st Level Sq. Ft.	720
Add'l Level Sq. Ft.	0
Total Living Area	720
Total Adjusted Area	720

Photos



Sketches

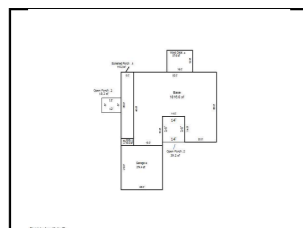

Tax Sales

NO TAX SALES FOUND

Materials and Features

Foundation	CONTINUOUS WALL - 100
Exterior Walls	WOOD & SHEATHING - 100
Roof Type	HIP-GABLE - 100
Roof Material	ASPH SHINGLE/HVY - 100
Floors	CARPET & UNDERLA - 100
Interior Finish	DRYWALL(SHEETROC - 100
Plumbing	AVERAGE - 100
Plumbing	BATH 3FIX - 1
Fireplaces	FIREPLACE +1 W/1 OPENING - 1
Heat/AC	HT06 FHA/AC - 1816

Materials and Features

** No Materials / Features For This Improvement **