

# DETAILS

The tax date or "assessment valuation date" is the January 1st preceding the fiscal year. For this reassessment, January 1, 2023 is the legal tax or assessment date. This means the values should represent the market value of the property based upon a theoretical sale date of January 1, 2023.

**MBL**

35-028-000P1

**Address**

102 LOXWOOD ST

**Assessed Owner**

WOLSKI,JOANNA

**Property Map & Information**

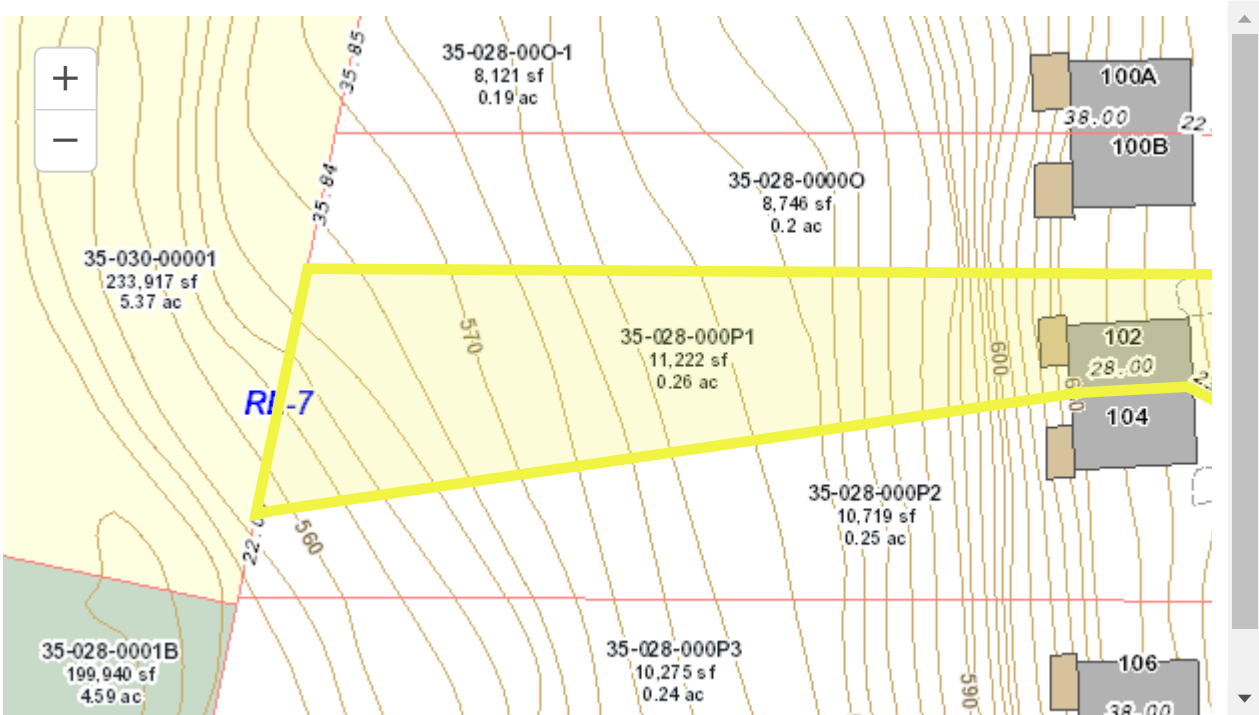

- VISION Property Card
- Worcester Map Viewer
- Tax Payment History



<b>i</b> Real Estate Tax/CML	➤
<b>i</b> CPA Surcharge	➤
<b>i</b> Permit History	➤
<b>i</b> Winter Parking Ban	➤

- The **Worcester Map Viewer** gives the public access to the City's GIS and Assessing Department information on a selected property.
  - **Tax Payment History** is available for the past three (3) calendar years.
  - A **Certificate of Municipal Lien (CML)** tells how much tax is owed on a property.
-