



Property Information

Request Information

Update Information

File#:	BS-W01492-1032348118	Requested Date:	11/10/2023	Update Requested:
Owner:	JOANNA WOLSKI	Branch:		Requested By:
Address 1:	102 Loxwood St	Date Completed:		Update Completed:
Address 2:		# of Jurisdiction(s):		
City, State Zip:	Worcester, MA	# of Parcel(s):	1	

Notes

CODE VIOLATIONS Per City of Worcester Department of Zoning there are no Code Violation cases on this property.
Collector: City of Worcester
Address: 25 Meade Street Worcester, MA 01610
Business# 508-799-1198
UNABLE TO PROVIDE DOCUMENTATION TO THIRD PARTIES. VERBAL INFO ACQUIRED

PERMITS Per City of Worcester Department of Building there are no Open/Pending/ Expired Permit on this property.
Collector: City of Worcester
Address: 25 Meade Street Worcester, MA 01610
Business# 508-799-1198
UNABLE TO PROVIDE DOCUMENTATION TO THIRD PARTIES. VERBAL INFO ACQUIRED

SPECIAL ASSESSMENTS Per City of Worcester Finance Department there are no Special Assessments/liens on the property.
Collector: City of Worcester
Address: 25 Meade Street Worcester, MA 01610
Business# 508-799-1198
UNABLE TO PROVIDE DOCUMENTATION TO THIRD PARTIES. VERBAL INFO ACQUIRED

DEMOLITION NO

UTILITIES Water & Sewer:
Account #: 26-0495-F00
Payment Status: DELINQUENT
Status: Pvt & Liable
Amount: \$121.72
Good Thru: 12/29/2023
Account Active: YES
Collector: Worcester Treasurer department
Payable Address: 455 MAIN ST ROOM 203, WORCESTER, MA 01608
Business# 508-799-1098
UNABLE TO PROVIDE DOCUMENTATION TO THIRD PARTIES. VERBAL INFO ACQUIRED

Garbage:
GARBAGE PRIVATE HAULER WITH LIEN STATUS AND BALANCE UNKNOWN

DETAILS

The tax date or "assessment valuation date" is the January 1st preceding the fiscal year. For this reassessment, January 1, 2023 is the legal tax or assessment date. This means the values should represent the market value of the property based upon a theoretical sale date of January 1, 2023.

MBL

35-028-000P1

Address

102 LOXWOOD ST

Assessed Owner

WOLSKI,JOANNA

Property Map & Information

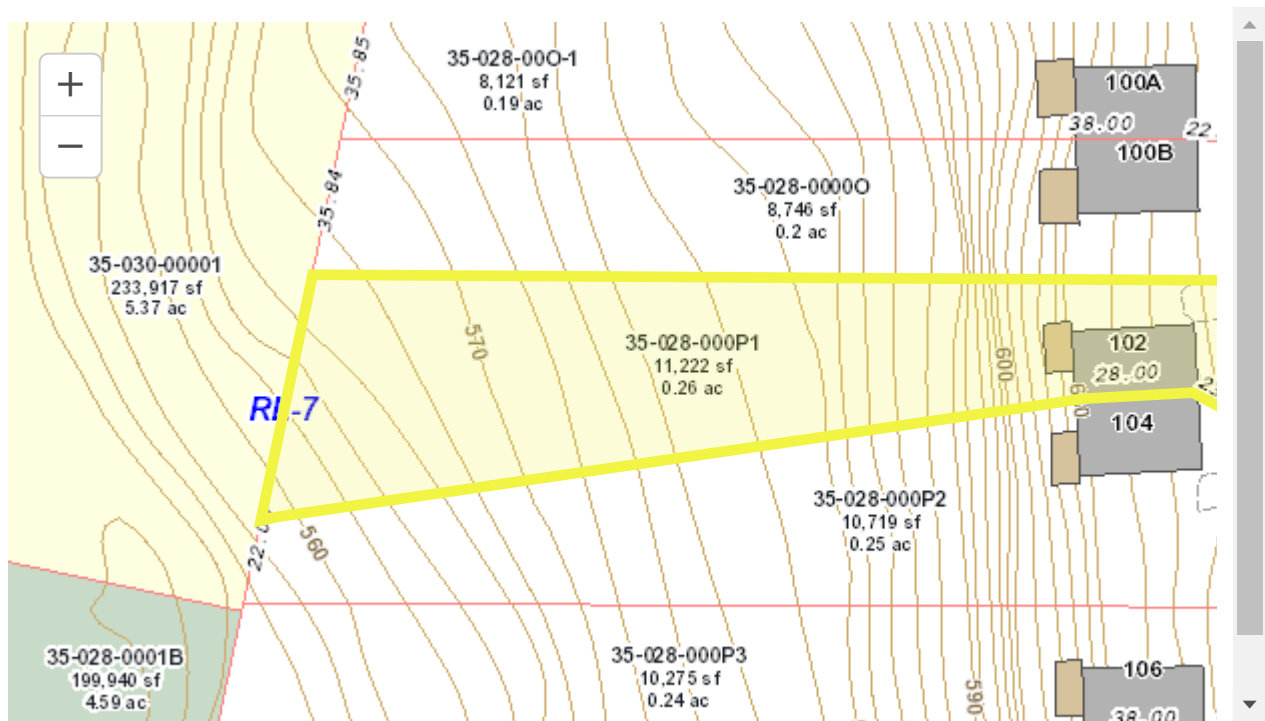

[VISION Property Card](#)

[Worcester Map Viewer](#)

[Tax Payment History](#)



i Real Estate Tax/CML	➤
i CPA Surcharge	➤
i Permit History	➤
i Winter Parking Ban	➤

- The **Worcester Map Viewer** gives the public access to the City's GIS and Assessing Department information on a selected property.
 - **Tax Payment History** is available for the past three (3) calendar years.
 - A **Certificate of Municipal Lien (CML)** tells how much tax is owed on a property.
-