



Property Information		Request Information		Update Information
File#:	BS-X01798-4597866329	Requested Date:	11/22/2024	Update Requested:
Owner:	MARK VENDETTI	Branch:		Requested By:
Address 1:	10 STRAITS ROCK RD	Date Completed:	12/03/2024	Update Completed:
Address 2:		# of Jurisdiction(s):		
City, State Zip:	NEW MILFORD, CT	# of Parcel(s):	1	

## Notes

**CODE VIOLATIONS** Per Town of New Milford Department of Zoning there are no Open Code Violation case on this property.

Collector: Town of New Milford  
 Payable Address: 10 Main St #1, New Milford, CT 06776  
 Business# 860-355-6090

UNABLE TO PROVIDE DOCUMENTATION TO THIRD PARTIES. VERBAL INFO ACQUIRED

**PERMITS** Per Town of New Milford Department of Building There are three Open permits on this property.

- Permit #: B-11-348  
Permit Type: Building Permit v1
- Permit #: C-11-112  
Permit Type: Conservation Permit
- Permit #: Z-11-105  
Permit Type: Zoning Permit

Collector: Town of New Milford  
 Payable Address: 10 Main St #1, New Milford, CT 06776  
 Business# 860-355-6090

**SPECIAL ASSESSMENTS** Per Town of New Milford Tax Collector there are no Special Assessments/liens on the property.

Collector: Town of New Milford  
 Payable Address: 10 Main Street New Milford, CT 06776  
 Business# 860-355-6085

UNABLE TO PROVIDE DOCUMENTATION TO THIRD PARTIES. VERBAL INFO ACQUIRED

**DEMOLITION** NO

**UTILITIES** WATER AND SEWER  
 THE HOUSE IS ON A COMMUNITY WATER & SEWER. ALL HOUSES GO TO A SHARED WELL & SEPTIC SYSTEM.

**GARBAGE**  
 GARBAGE PRIVATE HAULER WITH LIEN STATUS AND BALANCE UNKNOWN

## 10 STRAITS ROCK RD

**Location** 10 STRAITS ROCK RD

**Mblu** 61 / 3/8 /

**Acct#** 013138

**Owner** VENDETTI MARK + STILIANI

**Assessment** \$206,740

**Appraisal** \$295,300

**PID** 12431

**Building Count** 1

### Current Value

Appraisal			
Valuation Year	Improvements	Land	Total
2020	\$222,600	\$72,700	\$295,300

Assessment			
Valuation Year	Improvements	Land	Total
2020	\$155,820	\$50,920	\$206,740

### Parcel Addresses

Additional Addresses
No Additional Addresses available for this parcel

### Owner of Record

**Owner** VENDETTI MARK + STILIANI  
**Co-Owner**  
**Address** 10 STRAITS ROCK RD  
GAYLORDSVILLE, CT 06755

**Sale Price** \$239,000  
**Certificate**  
**Book & Page** 0629/0795  
**Sale Date** 02/28/2000  
**Instrument** 002

### Ownership History

Ownership History
-------------------

Owner	Sale Price	Certificate	Book & Page	Instrument	Sale Date
VENDETTI MARK + STILIANI	\$239,000		0629/0795	002	02/28/2000
SHEPERD WALLACE B + DEBRA M	\$229,214		0612/0621	07	06/16/1999
N M D PROPERTIES LLC	\$0		0503/0612		10/04/1994
N M D PROPERTIES	\$0		0494/0497		05/18/1994
NMD PROPERTIES	\$0	5	0374/0536		07/08/1987

## Building Information

### Building 1 : Section 1

**Year Built:** 2000  
**Living Area:** 1,950  
**Replacement Cost:** \$260,490  
**Building Percent Good:** 85  
**Replacement Cost  
Less Depreciation:** \$221,400

Building Attributes	
Field	Description
Style	Colonial
Model	Residential
Grade	C+
Stories	2 Stories
Occupancy	1
Exterior Wall 1	Vinyl Siding
Exterior Wall 2	
Roof Structure	Gable
Roof Cover	Asphalt Shngl
Interior Wall 1	Drywall/Sheet
Interior Wall 2	
Interior Flr 1	Carpet
Interior Flr 2	
Heat Fuel	Oil
Heat Type	Hot Water
AC Type	None
Total Bedrooms	4 Bedrooms
Full Bathrooms	2

### Building Photo



(<https://images.vgsi.com/photos/NewMilfordCTPhotos/A00\01\72\47.jpg>)

Half Bathrooms	1
Total Xtra Fixtrs	
Total Rooms	7 Rooms
Bath Style	Average
Kitchen Style	Average
Num Kitchens	01
Whirlpool Tub	1
Fireplaces	
Fin Bsmt Area	
Bsmt Garages	
Fireplaces_1	
Solar	
Insp. Letter	YES
Multi-House	
Fndtn Cndtn	
Basement	

**Building Layout**

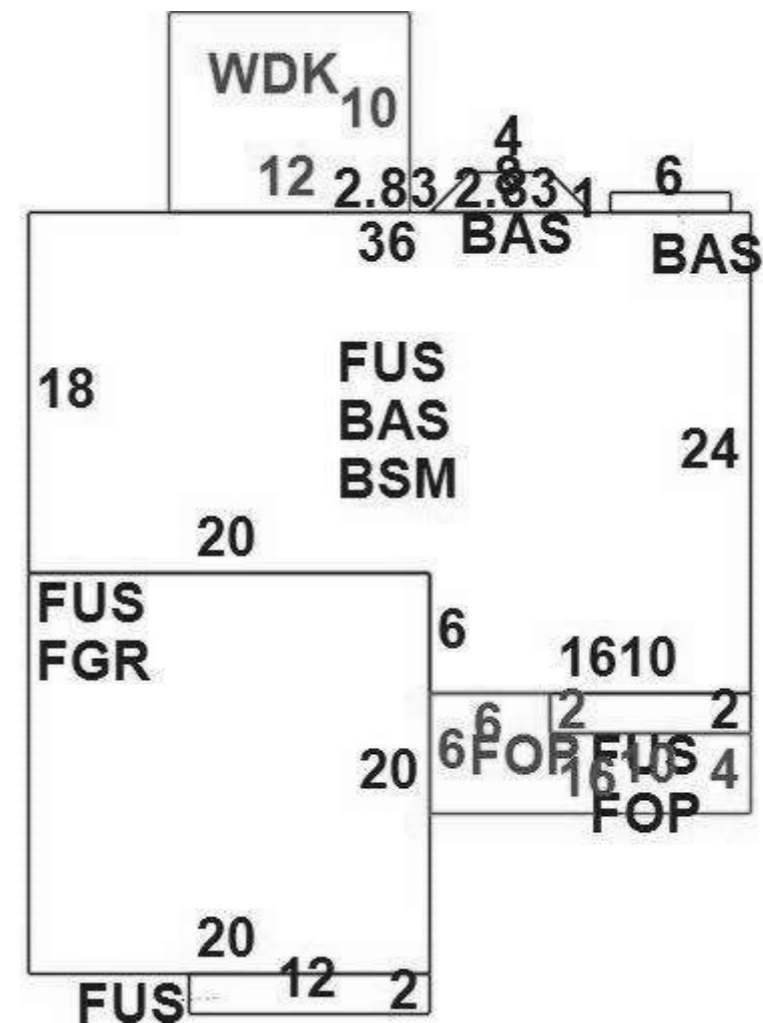

(ParcelSketch.ashx?pid=12431&bid=12849)

Building Sub-Areas (sq ft)			Legend
Code	Description	Gross Area	Living Area
FUS	Finished Upper Story	1,188	1,188
BAS	First Floor	762	762
BSM	Basement	744	0
FGR	Garage	400	0
FOP	Open Porch	96	0
WDK	Wood Deck	120	0
		3,310	1,950

**Extra Features**

Extra Features	Legend
No Data for Extra Features	

**Parcel Information**

Use Code 101  
 Description Single Family  
 Deeded Acres 0.47

**Land**

**Land Use**

Use Code 101  
 Description Single Family  
 Zone PRD/R80  
 Neighborhood R110  
 Alt Land Appr No  
 Category

**Land Line Valuation**

Size (Acres) 0.47  
 Frontage 0  
 Depth 0  
 Assessed Value \$50,920  
 Appraised Value \$72,700

**Outbuildings**

Outbuildings							<u>Legend</u>
Code	Description	Sub Code	Sub Description	Size	Value	Assessed Value	Bldg #
SHD1	Shed	FR	Frame	192.00 S.F.	\$1,200	\$840	1
SPL4	Pool AG Rect.			450.00 S.F.	\$0	\$0	1

**Valuation History**

Appraisal			
Valuation Year	Improvements	Land	Total
2021	\$222,600	\$72,700	\$295,300

Assessment			
Valuation Year	Improvements	Land	Total
2021	\$155,820	\$50,920	\$206,740

Building Permit v1

# B-11-348

**Applicant**

**Location**

**10 STRAITS ROCK RD**

New Milford, CT 06776

[View location details \(/locations/24435\)](/locations/24435)

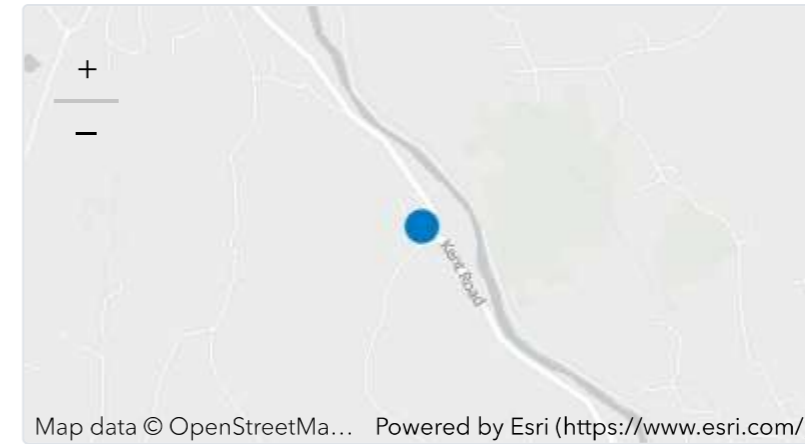

**Created**

Jun 20, 2011

**Status**

Active

**Expires**

--

**Details**   **Files (2)**

**Additional Applicant Info**

**Applicant Type \***

Other

**Documents**

**Permit/License Document**

Issued Mar 2, 2020

**Permit Info**

**Permit For \***

Building Permit - VB

**Project Cost \***

6,100

**Work Description \***

15' x 30' above ground pool.

**Occupancy Type \***

--

**Building Type**

Pool

**Water Type \***

--

**Sewage Disposal System \***

Municipal

**Tenant Name**

**Tenant Phone**

--

--

**Number of Additional Buildings Using an Identical Floor Plan on the Same Site**

--

**Square footage of building**

--

---

**Contractors**

---

<b>Building Height &amp; Area</b>	<b>Stories (Existing)</b>	<b>Stories (Proposed)</b>
	--	0
	<b>Bedrooms (Existing)</b>	<b>Bedrooms (Proposed)</b>
	--	0
	<b>Bathrooms (Existing)</b>	<b>Bathrooms (Proposed)</b>
	--	0
	<b>Lot Size (Existing)</b>	<b>Lot Size (Proposed)</b>
	--	--
	<b>Foundation Size (Existing)</b>	<b>Foundation Size (Proposed)</b>
--	--	
<b>Foundation Thickness (Existing)</b>	<b>Foundation Thickness (Proposed)</b>	
--	--	
<b>Foundation Depth (Existing)</b>	<b>Foundation Depth (Proposed)</b>	
--	--	
<b>Foundation Type (Existing)</b>	<b>Foundation Type (Proposed)</b>	
--	--	

<b>Wall Material (Existing)</b>	<b>Wall Material (Proposed)</b>
--	--
<b>Units (Existing)</b>	<b>Units (Proposed)</b>
--	1
<b>Structure Height (Existing)</b>	<b>Structure Height (Proposed)</b>
--	0
<b>Structure Width (Existing)</b>	<b>Structure Width (Proposed)</b>
--	--
<b>Structure Length (Existing)</b>	<b>Structure Length (Proposed)</b>
--	--
<b>Area:</b>	
<b>Cellar Area (Proposed)</b>	<b>Cellar Area (Existing)</b>
--	--
<b>Garage Area (Proposed)</b>	<b>Living Area (Existing)</b>
--	--
<b>Living Area (Proposed)</b>	<b>Total Area (Existing) *</b>
0	--
<b>Total Area (Proposed) *</b>	<b>Garage Type</b>
0	0
<b>Lot Type</b>	<b>Garage Area (Existing)</b>
Interior	--

---

**Additional Building Info**

**Non Habitable Area**

--

**Front Lot Line Width**

--

**Rear Lot Line Width**

--

**Lot Depth**

--



**House Style**

--

**Half Baths**

0

**Distance on Center**

--

**Deck**

0

**Porch**

0

**Pool**

0

**Pool Size**

0

**Pool Above Ground**

--

**Pool Distance From Front**

--

**Pool Distance From Rear**

--

**Pool Distance From Left**

--

**Pool Distance From Right**

--

**Windows**

0

**Doors**

--

**Stairways**

--

**Stairs Location**

--

**Finished Basement**

--

**Finished Attic**

--

**Elevator**

**Floor Timbers 1st Floor**

--

**Floor Timbers 2nd Floor**

--

**Floor Timbers 3rd Floor**

--

**Floor Timbers 4th Floor**

--

**Floor Timbers 5th Floor**

--

**Rooms 1st Floor**

--

**Rooms 2nd Floor**

--

Rooms 3rd Floor

--

Rooms Above 3rd Floor

--

Floor Type Basement

--

Floor Type 1st Floor

--

Floor Type 2nd Floor

--

Floor Type 3rd Floor

--

Internal Finish Basement

--

Internal Finish 1st Floor

--

Internal Finish 2nd Floor

--

Finished Flooring 1st Floor

--

Finished Flooring 2nd Floor

--

Finished Flooring 3rd Floor

--

Completed Energy Report

--

Wall Covering

--

Heating

1

Heating System

--

Central Air

Span

--

Insulation Values

--

Insulation Blanket

--

Insulation Roof Ceiling

--

Roof Type

--

Roof Layers

--

Chimney / Fireplace

0

Fireplace Type

--

Fire Sprinklers

--

<b>Frame Type</b>	<b>Tile Type</b>
--	--
<b>Fence Material</b>	<b>Siding Material</b>
--	--
<b>Lawn Sprinklered</b>	<b>Size of Skills</b>
--	--
<b>Distance Between Buildings</b>	<b>Carrying Partitions</b>
--	--
<b>Debris Location</b>	<b>Asbestos</b>
--	--
<b>Asbestos Removal Firm</b>	<b>Asbestos Removal Firm Address</b>
--	--
<b>Signs</b>	<b>Sign Length</b>
--	--
<b>Sign Width</b>	<b>Sign Height</b>
--	--

---

<b>Engineer Information</b>	<b>Company Name</b>	<b>Engineer Name</b>
	--	--
	<b>Registration #</b>	<b>Insurance Expiration</b>
	--	--
	<b>Address</b>	<b>City</b>
	--	--
<b>State</b>	<b>Zip</b>	
--	--	
<b>Phone</b>	<b>AOR</b>	

-- --

**Email**

--

---

**Architect Information**

**Company Name**

--

**Architect Name**

--

**Registration #**

--

**License Expiration**

--

**Address**

--

**City**

--

**State**

--

**Zip**

--

**Phone**

--

**Email**

--

**AOR**

--

---

**Use Groups**

---

**Insurance Coverage**

**I have a liability insurance policy or its substantial equivalent ⓘ**

No

**Other**

**Workers Compensation Insurance**

**Other Coverage**

--

If No, please select one of the options from the dropdown menu and attach the Workers Compensation Affidavit below (which meets the requirements of Conn. Gen Stat. 31-286b)

--

---

---

**Town of New Milford, CT**

**Your Profile**

[Sign Up \(/sign-up\)](/sign-up)

[Your Records \(/dashboard/records\)](/dashboard/records)

**Resources**

[Search for Records \(/search\)](/search)

[Claim a Record \(/claimRecord\)](/claimRecord)

[Employee Login \(https://newmilfordct.workflow.opengov.com\)](https://newmilfordct.workflow.opengov.com)

---

Portal powered by **OpenGov**

Conservation Permit

# C-11-112

**Applicant**

**Location**

**10 STRAITS ROCK RD**

New Milford, CT 06776

[View location details \(/locations/24435\)](/locations/24435)

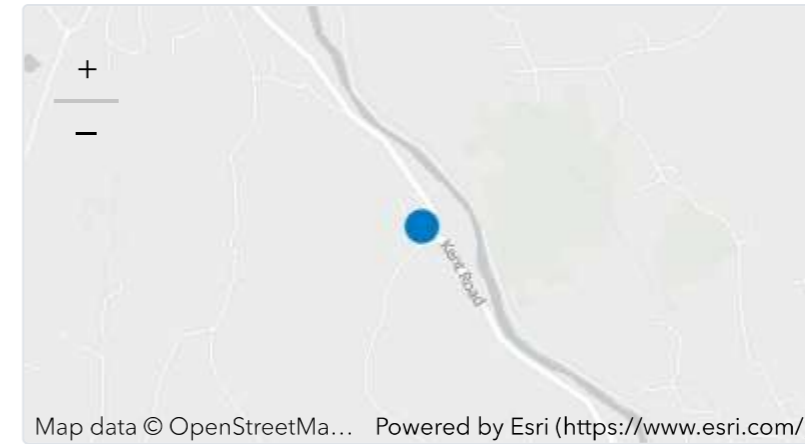

**Created**

Jun 9, 2011

**Status**

Active

**Expires**

--

**Details**

**Files (0)**

**Additional Applicant Info**

**Documents**

**Permit/License Document**

Issued Mar 2, 2020

**Permit Info**

**Development Title**

--

**Lots**

0

**Occupancy Type**

--

**Building Type**

--

**Permit For \***

Wetland Inland Permit

**Project Cost**

0

**Work Description \***

15' x 30' oval above ground pool

**Comments**

No Permit Required

**Additional Project Info****Date of Receipt**

06/10/2011

**Hearings Commencement Deadline**

--

**Hearings Completion Deadline**

--

**Decision Deadline**

--

**Total Acreage**

0

**Linear Feet**

0

**Disturbed Acres**

0

**Distance to Town Line**

--

**Extended**

--

**Hearing Not Required**

--

**Setbacks****Front Required**

--

**Front Provided**

--

**Back Required**

--

**Back Provided**

--

**Left Required**

--

**Left Provided**

--

**Right Required**

--

**Right Provided**

--

**Open Space Required**

--

**Open Space Provided**

--

**Lot Coverage Required**

--

**Lot Coverage Provided**

--

### Parcels Included in Project

---

<b>Attorney Info</b>	<b>Name</b>	<b>Address</b>
	--	--
	<b>City</b>	<b>State</b>
	--	--
	<b>Zip</b>	<b>Phone</b>
--	--	
	<b>Email</b>	
	--	

---

### Public Hearings

---

<b>Engineer Information</b>	<b>Company Name</b>	<b>Engineer Name</b>
	--	--
	<b>Address</b>	<b>City</b>
	--	--
	<b>State</b>	<b>Zip</b>
	--	--
	<b>Phone</b>	<b>Registration #</b>
--	--	
	<b>Insurance Expiration</b>	<b>AOR</b>
	--	--
	<b>Email</b>	
	--	

---



**Architect Information**

**Company Name**

--

**Architect Name**

--

**Registration #**

--

**License Expiration**

--

**Address**

--

**City**

--

**State**

--

**Zip**

--

**Phone**

--

**Email**

--

**AOR**

--

---

**Contractors**

---

---

**Town of New Milford, CT**

**Your Profile**

[Sign Up \(/sign-up\)](/sign-up)

[Your Records \(/dashboard/records\)](/dashboard/records)

**Resources**

[Search for Records \(/search\)](/search)

[Claim a Record \(/claimRecord\)](/claimRecord)

[Employee Login \(https://newmilfordct.workflow.opengov.com\)](https://newmilfordct.workflow.opengov.com)



Zoning Permit

# Z-11-105

**Applicant**

**Location**

**10 STRAITS ROCK RD**

New Milford, CT 06776

[View location details \(/locations/24435\)](/locations/24435)

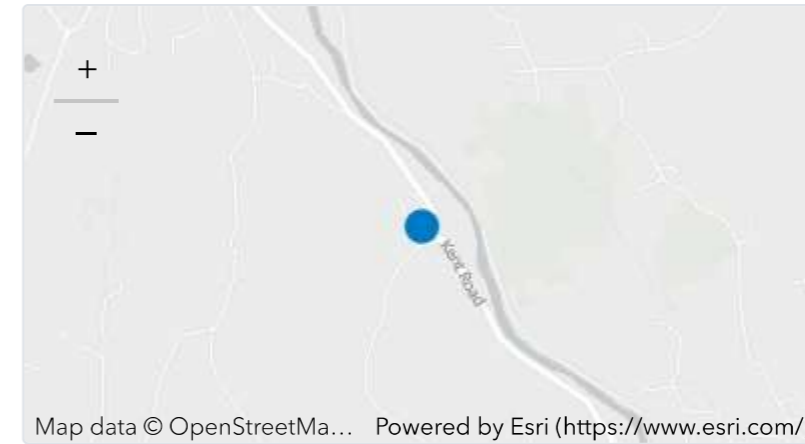

**Created**

Jun 9, 2011

**Status**

Active

**Expires**

Jun 19, 2014

**Details**

**Files (1)**

**Additional Applicant Info**

**Applicant Type**

Other

**Owner Name**

--

**Documents**

**Permit/License Document**

Issued Mar 2, 2020

**Permit Info**

**Occupancy Type \***

--

**Permit For \***

Zoning Permit

**Project Cost \***

0

**Work Description \***

pool - above ground

**Unit #**

--

---

**Town of New Milford, CT**

**Your Profile**

[Sign Up \(/sign-up\)](/sign-up)

[Your Records \(/dashboard/records\)](/dashboard/records)

**Resources**

[Search for Records \(/search\)](/search)

[Claim a Record \(/claimRecord\)](/claimRecord)

[Employee Login \(https://newmilfordct.workflow.opengov.com\)](https://newmilfordct.workflow.opengov.com)

---

Portal powered by **OpenGov**