



## Property Information      Request Information      Update Information

File#:	BS-X01798-5159645314	Requested Date:	11/22/2024	Update Requested:	
Owner:	GAJEWSKI JOHN J	Branch:		Requested By:	
Address 1:	1 FLD LN	Date Completed:	12/20/2024	Update Completed:	
Address 2:		# of Jurisdiction(s):			
City, State Zip:	LITITZ, PA	# of Parcel(s):	1		

## Notes

CODE VIOLATIONS      Per Warwick Township Department of Zoning there are no Code Violation cases on this property.

Collector: Warwick Township  
 Payable Address: 315 Clay Road, Lititz, PA 17543  
 Business# (717) 626-8900

UNABLE TO PROVIDE DOCUMENTATION TO THIRD PARTIES. VERBAL INFO ACQUIRED.

PERMITS      Per Warwick Township Building Department there are no Open/Pending/ Expired Permit on this property.

Collector: Warwick Township  
 Payable Address: 315 Clay Road, Lititz, PA 17543  
 Business# (717) 626-8900

UNABLE TO PROVIDE DOCUMENTATION TO THIRD PARTIES. VERBAL INFO ACQUIRED.

SPECIAL ASSESSMENTS      Per Warwick Township Department of Finance there are no Special Assessments/liens on the property.

Collector: Warwick Township  
 Payable Address: 315 Clay Road, Lititz, PA 17543  
 Business# (717) 626-8900

UNABLE TO PROVIDE DOCUMENTATION TO THIRD PARTIES. VERBAL INFO ACQUIRED.

DEMOLITION      NO

UTILITIES      Water & Sewer  
 Account #: N/A  
 Payment Status: N/A  
 Status: Pvt & Lienable  
 Amount: N/A  
 Good Thru: N/A  
 Account Active: Yes  
 Collector: Warwick Township Municipal Authority  
 Payable: 315 Clay Road P.O. Box 336 Lititz, PA 17543-0336  
 Business # (717) 627-2379

UNABLE TO PROVIDE INFORMATION TO THIRD PARTIES. HOMEOWNERS AUTHORIZATION REQUIRED.

GARBAGE:  
 GARBAGE PRIVATE HAULER WITH LIEN STATUS AND BALANCE UNKNOWN.

Property Information

<b>Property ID</b>	600-00853-0-0000	<b>Property Use</b>	100 - RESIDENTIAL
<b>Tax Year</b>	2024 <input type="button" value="v"/>	<b>Land Use</b>	113 - SINGLE FAMILY DWELLING
<b>Township</b>	600 Warwick Twp	<b>Tax Status</b>	Taxable
<b>Site Address</b>	1 FIELD LN	<b>Clean &amp; Green</b>	No

Property Sketches & Photos

1-1

Parcel photo

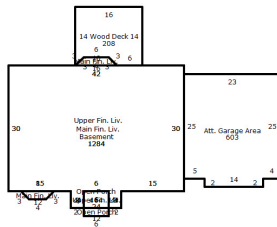

Related Names

**Parcel Owner** GAJEWSKI JOHN J,  
1 FIELD LANE  
LITITZ, PA 17543

**Status** Current

**Parcel Owner** GAJEWSKI LYNN M,  
1 FIELD LANE  
LITITZ, PA 17543

**Status** Current

Assessments

Annual Billing

	Land	Building	Total	Pref. Land	Pref. Building	Pref. Total
Non-Exempt	87,000	231,500	318,500	0	0	0
Exempt	0	0	0	0	0	0
<b>Total</b>	<b>87,000</b>	<b>231,500</b>	<b>318,500</b>	<b>0</b>	<b>0</b>	<b>0</b>

**Note:** Preferential assessment values are used for taxation when preferential values are greater than zero.

Property Characteristics			
Electric	Gas	Sewage	Water
HOOKED-UP	PRIVATE SYSTEM	PUBLIC SYSTEM	PUBLIC SYSTEM

Market Land Valuation			
Property Type	Land Type	Sq. Ft.	Calc. Acres
RES - Residential	2 - PRIMARY HOMESITE	15,246	0.3500

Structure 1 of 1				
Property Type	Description	Style	Total Living Area	Year Built
RES - Residential	COLONIAL-NEW #1	Two Story	2,620	2003

Accommodations	
Extra Fixtures	5
Full Baths	3
Half Baths	1
Number of Bedrooms	4
Number of Families	1
Number of Rooms	8

Fuel Type	
Fuel Type	Electric

Heating/Cooling	
Warmed & Cooled Air	2620.00 Sq.Ft.

Roofing	
Composition Shingle	2620.00 Sq.Ft.

Style	
Style	COLONIAL-NEW

Basement	
Minimal Finish Area	594.00 Sq.Ft.
Total Basement Area	1284.00 Sq.Ft.

Exterior Walls	
Frame, Siding, Vinyl	2620.00 Sq.Ft.

Fireplaces	
Single 2-Story Fireplace	1.00 Units

Garage/Carport	
Attached Garage	603.00 Sq.Ft.

Porches, Decks, Breezeways	
Open Slab Porch	36.00 Sq.Ft.
Wood Deck	208.00 Sq.Ft.

Story Height	
Number of Stories	2.00

Exemptions		
Exemption Type	Status	Farmstead
Homestead	Appl Approved (Full)	No

Sales History

Year	Document #	Sale Type	Sale Date	Sold By	Sold To	Price
2006	05576120		11/28/2006	GAJEWSKI JOHN J	GAJEWSKI JOHN J	\$1

Billing & Collection info for this District is not available for display. Please contact the following person or office:

Lynn Reapsome, Warwick Twp Tax Collector  
P.O. Box 653  
Lititz, PA 17543  
(717) 278-5289

No Delinquent Taxes