

Street View

Footprint

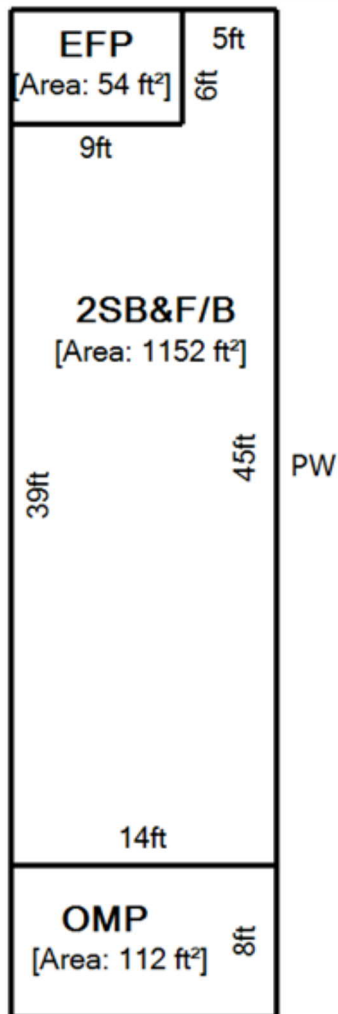

[Sketch Codes](#)

Options

[Back To Results](#)

[New Search](#)

[Create PDF](#)

Property Overview

2024

Owner Name

CRUZ ANTONIO

Owner Address

1771 BROADWAY
BETHLEHEM PA 18015-3821

Property Address

1771 BROADWAY
BETHLEHEM PA 18015

Parcel Viewer

[View in Parcel Viewer](#)

Low Number

1771

High Number

1771

Tax Authority

SALISBURY TOWNSHIP

School District

SALISBURY SCHOOL DISTRICT

Parcel Id

641678848158 1

Old Parcel Id

17 01 H10NE2 021 006

Tile

466104C

Acres/Dimension

25 X 125

Lot Sq Ft

3125

Utilities

PUBLIC WATER/SEWER

Class

RESIDENTIAL

Land Use

SINGLE FAMILY - TWIN

Living Units

1

Zoning

R4

Homestead Act 72

Application Mailed - Please fill out and return for processing.

Preferential Land Act

NO

Agricultural Easement

NO

Assessment Base Year

2013

Total Assessment

Exempt Land		0
Exempt Building		0
Taxable Land		11,800
Taxable Building		80,900
Total		92,700
Taxable Total		92,700

Estimated Taxes

	Mills	Estimated Taxes
County	3.780000	\$ 350.41
School	23.944900	\$ 2,219.69
Municipality	3.570000	\$ 330.94
Total		\$ 2,901.04

Bill Number

170101007

LC_PropertyAddress

1771 BROADWAY BETHLEHEM PA 18015

[Basic Residential Profile](#)

Type of Residence

SINGLE FAMILY - TWIN

Number of Stories

2 STORY

Type of Construction

BRICK & FRAME

Type of Basement

FULL