

Parcel Information

Parcel ID 260-004-03-00-0078-00
 Property Address 2279 SANDY PLAINS RD CLARKSVILLE
 Property City/State
 Property Zip Code
 Class R - RESIDENTIAL
 District 260-EAST BETHLEHEM(25455)
 Utilities 1-ALL PUBLIC
 Front Footage 50
 Depth 105
 Calculated Cama Acres .1205
 Description LOT NO 720
 HSE 1 STY BR
 School District S14 - BETHLEHEM-CENTER SCHOOL DISTRICT(7502)

Owner

Name SMITH JOSEPH EDWARD & ANDREA M
 In Care Of
 Percent Owned
 Address 2279 SANDY PLAINS RD
 CLARKSVILLE PA 15322 1513

Current Assessed Values

Assessment Year 2025
Land Value 12,300
Building Value 34,000
Total Value 46,300

Sales

Date 23-JAN-08
Instrument No. 200804790
 Deed Book
 Deed Page
 Instrument Type
 Additional Instrument #2
 Additional Instrument #3
 Additional Instrument #4
Price \$1.00
 Grantor
 Grantee SMITH JOSEPH EDWARD & ANDREA M

Sales Summary

Date	Price	Deed Type	Grantor	Grantee
23-JAN-08	\$1.00			SMITH JOSEPH EDWARD & ANDREA M

Exemptions

Homestead* : Pending
Farmstead :

* If this property had a recent sale or deed change the new owners wishing to receive the abatement must apply.
 The deadline to apply is March 1st of each year.
 Details may be found on the County website <https://www.washingtoncopa.gov/tax-revenue/assessment-downloadable-documents>

Structure

Stories 1
Exterior Walls BLOCK
Year Built 1929
Style COTTAGE
Total Area 672
Finished Bsmt Living Area
Rec Room Area
Bsmt Garage # Cars

Residential Features

Total Rooms 4
 Bedrooms 2
 Full Baths 1
 Half Baths 0
 Wood Burning Fireplace 0
 Prefab Fireplace
 Heating CENTRAL
 Heating Fuel Type COAL/WOOD
 Heating System FORCED AIR
 Attic Code NONE
 Basement FULL

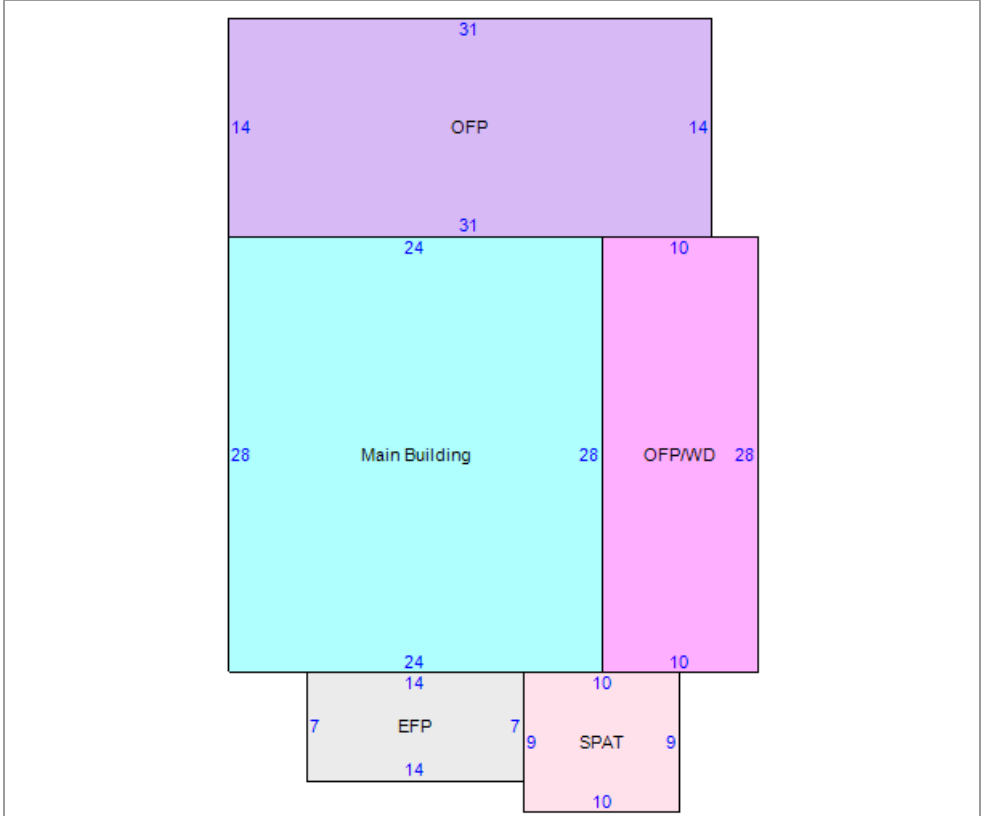

Item	Area
Main Building	672
OFP/WD - 11/31:OFP/WD	280
EFP - 12:EFP	98
SPAT - 34:SP	90
OFP - 11:OFP	434



