

2351 Skyhill Rd

Location 2351 Skyhill Rd

Parcel Number 24/ 2306/ 0148/000 /

Control # 24162700

Owner SALLMEN, JOSEPH S & MICHELE L

Taxable Status Non-Exempt

Parcel NBHD Mahoning Twp. North - Gen

Property Type Buildings Usually Res (<10 Ac)

Assessment \$194,800

Appraisal \$194,800

PID 24162700

Building Count 1

Legal Description H-G

Legal Muni/School 24-7

School Dist 7

Tax Status T

Special ID

BC Parcel ID

Comm Units

Comm Unit Size

Comm Apt Type

Assessing District Mahoning Twp. North - Gen

Lot Type

Terrain

Access

Utilities

Sewer

Water

Historic

Rail Avail

Sidewalk

Superior View

Road Access

Hard Top Drive

District 24: Mahoning Twp

Current Value

Appraisal			
Valuation Year	Improvements	Land	Total
2024	\$150,800	\$44,000	\$194,800

Owner of Record

Owner SALLMEN, JOSEPH S & MICHELE L
Co-Owner
Address 2581 SKYHILL RD
 EDINBURG, PA 16116-3223

Sale Price \$115,000
Book & Page 2007-006521
Sale Date 06/19/2007
Analysis Code 55

Ownership History

Ownership History				
Owner	Sale Price	Book & Page	Analysis Code	Sale Date
SALLMEN, JOSEPH S & MICHELE L	\$115,000	2007-006521	55	06/19/2007
KENNETH E WYANT SR	\$0	2002-007358	22	05/20/2002
KENNETH E WYANT SR	\$0	2002-005211	22	04/09/2002
KENNETH E WYANT SR ETAL	\$0	0	22	01/01/1983

Building Information

Building 1 : Section 1

Year Built: 2007
Living Area: 2,360
Building Percent Good: 95

Building Attributes	
Field	Description
Model	Residential
Style	Dwelling
Primary Bldg Use	Residential 1 Family
EST Dwell Code	Single Family
Grade	Grade C+
Stories	2 Stories
Occupancy	
Exterior Wall 1	Wood (Est: W)
Exterior Wall 2	
Brick LF	0
Roof Cover	
Roof Structure	
Interior Wall 1	
Interior Wall 2	
Interior Floor 1	
Interior Floor 2	
Int. vs Ext.	Interior Same Overall (Est: S)
Attic Type	Not Applicable (Est: None)
Add Liv Units	
Room(s)	7

Building Photo



(<https://images.vgsi.com/photos/LawrenceCountyPAPhotos/default.jpg>)

Building Layout

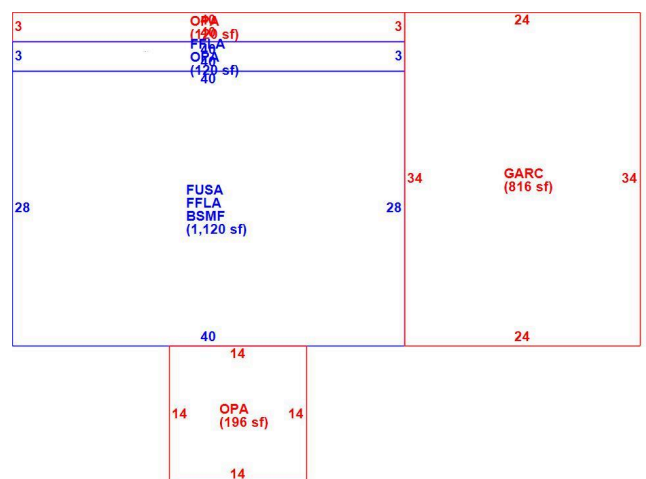

(<ParcelSketch.aspx?pid=24162700&bid=24162700>)

Bedroom(s)	3
Full Bath(s)	2
Half Bath(s)	0
Fixture(s)	3
Heat Type	Forced Hot Air (Est: F)
Heat Fuel	Other (Est: U)
Central AC	Central (Est: Ac)
Bsmt % Groups	76-100% (Est: 100)
Bsmt Exposure	
Fin Bsmt Area	0
Rec Room	0
Bsmt Garage #	0
Bsmt Garage Area	0
MH Park ID	
MH ID	
MH Class	
MH Mfg	
MH Length	
MH Width	
MH Addition?	
AYB Estimated	Yes
Last Reno Year Est	
FPL Masonry	
FPL Metal	
FPL Additional	
Addition	No
Conversion Factor	

Building Sub-Areas (sq ft)			Legend
Code	Description	Gross Area	Living Area
FUSA	Finished Upper Story - Frame	1,240	1,240
FFLA	First Floor - Frame	1,120	1,120
BSMF	Basement - Full	1,120	0
GARC	Garage - Frame	816	0
OPA	Open Porch - Frame	240	0
OPA	Open Porch - Frame	196	0
		4,732	2,360

Parcel Information

Use Code 101
Description Residential 1 Family
Deeded Acres 7.26

Land

Land Use

Use Code 101
Description Residential 1 Family
Clean & Green Approved No
Category

Land Line Valuation

Size (Acres) 7.26
Appraised Value \$44,000

Outbuildings

Outbuildings	Legend
--------------	---------------

Code	Description	Sub Code	Sub Description	Size	Value	Bldg #
RG1	Detached Frame Garage	FRAME	Frame	1120.00 SF	\$10,876	1

Valuation History

Appraisal				
Valuation Year	Improvements	Land	Total	
2024	\$150,800	\$44,000	\$194,800	
2023	\$150,800	\$44,000	\$194,800	
2022	\$150,800	\$44,000	\$194,800	
2021	\$155,800	\$102,000	\$257,800	