

PARID: 51-000-18-0068.00-00000
PROPERTY LOCATION: 1345 W COLLEGE AVE

MUNICIPALITY: 51 - WEST MANCHESTER TOWNSHIP
SCHOOL: 026 - WEST YORK AREA SCHOOL

HIGHLANDS PAUL ET AL

NBHD: 05102000
Tax Year: 2025

Parcel

Property Location 1345 W COLLEGE AVE
Unit Description -
Unit #
Legal Description

Class R - RESIDENTIAL
LUC 101 - R - ONE STORY HOUSE
GIS Code
Topo 1 - LEVEL
Utilities 1 - 1
Roads 1 - 1
Total Cards 1
Calculated CAMA Acres .2204
Total Acres .2204

Current Owner Details

Name HIGHLANDS PAUL ET AL
Owner Address 1345 W COLLEGE AVE
YORK PA 17404 3426
In Care Of
Deed Book 2510
Deed Page 3934

Sales

Sale Date	Sale Price	New Owner	Old Owner	Book	Page
03-25-2019	\$1	HIGHLANDS PAUL ET AL	HIGHLANDS PAUL	2510	3934
10-18-2007	\$109,500	HIGHLANDS PAUL	HOLZER GREGORY L	1928	2256
01-12-2007	\$1	HOLZER GREGORY L	HOLZER GREGORY L	1868	0792
06-20-2000	\$1	HOLZER GREGORY L	HOLZER GREGORY L	1402	2178
06-02-1999	\$3,553	HOLZER GREGORY L	WAGAMAN VICTORIA E	1366	2711

Legal Description

Municipality 51 - WEST MANCHESTER TOWNSHIP
School District 026 - WEST YORK AREA SCHOOL
Property Location 1345 W COLLEGE AVE
Description -
Building/Unit #
Subdivision Parent Parcel
Legal 1
Legal 2
Legal 3
Deeded Acres 0.220
Deeded Square Feet

Values

Appraised Land 27,890
Appraised Building 38,780
Appraised Total 66,670

Clean and Green 0

Abstract	0
Taxable Land	27,890
Taxable Building	38,780
Total Taxable Value	66,670

ACT Flags

Act 319	
HOMESTEAD	Yes
FARMSTEAD	
LERTA CODE	
LERTASMT\$M	
LERTASMT\$K	
RETAP CODE	
RETAP ASMT	
RTAPASMT\$M	
INTERIM	
LRT BEG DT	
LRT END DT	
TABLE	
RET BEG DT	
RET END DT	
EDIT LTR	
Effective Date	
Notice Date	06-16-1997

Tax Year	Reason	Effective Date	Land Asmt	Bldg Asmt	Total Asmt	319 Land	319 Bldg	319 Total
2006			27,890	\$38,780	\$66,670	\$0	\$0	\$0
1998		01-01-1998	22,760	\$34,750	\$57,510	\$0	\$0	\$0
1996	INITIAL	12-01-1987	15,100	\$22,900	\$38,000	\$0	\$0	\$0

LAND PAR

Line #	Type	Code	CAMA SQ FT	CAMA Acres	Value
1	S - SqFt	1 - PRIMARY SITE	9,600	0.2204	27890
		Total:		0.2204	27890

Residential Card Summary

Card	1
Land Use Code	101
Building Style	RANCH
Number of Living Units	1
Year Built	1940
Year Remodeled	
Exterior Wall Material	ALUM/VINYL
Number of Stories	1
Square Feet of Living Area	832
Total Rms/Bedrms/Baths/Half Baths	4/2/1/
Basement	FULL
Finished Basement Living Area	
Rec Room Area	
Unfinished Area	
Wood Burning Fireplace	1
Pre Fab Fireplace	
Heating System	CENTRAL WARM FORCED AIR
Fuel Type	GAS
Condo Level	

Condo/Townhouse Type
Attached Garage Area
Basement Garage No. of Cars

Permits

Permit Date	Permit Number	Amount	Completion Date
01-OCT-2010	10-2031	250	10-17-2011

Details

Permit Date	01-OCT-2010
Permit Number	10-2031
Amount	250
Purpose	PORCH, ENC-PORCH
Status	C-Closed Permit
Completion Date	10-17-2011
Who	REIDDM
When	18-OCT-11

Homestead

Homestead Denied	-
Homestead	H
Farmstead	
Approved?	A
Date Rec'd	02/15/2008

Current Tax Information

Property Owner:
HIGHLANDS PAUL ET AL

DISCLAIMER

Disclaimer:
The York County's Office makes no representations or warranties as to the suitability of this information for any particular purpose, and that to the extent you use or implement this information in your own setting, you do so at your own risk. The information provided herewith is solely for personal use and cannot be sold. In no event will York County be held liable for any damages whatsoever, whether direct, consequential, incidental, special, or claim for attorney fees, arising out of the use of or inability to use the information provided herewith. There is no warranty of merchantability or fitness for any purpose. This information may change or be deleted without notice.

****PLEASE CONTACT THE TAX COLLECTOR FOR A TAX CERTIFICATION.**

Tax Collector

WEST MANCHESTER TWP TAX COLL,
 380 EAST BERLIN RD
 YORK PA 17408

 717-793-9651

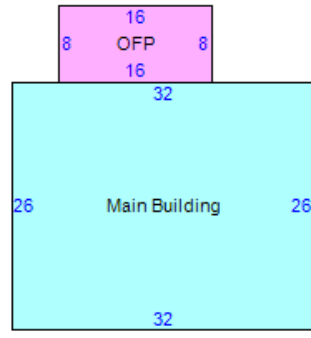

Item	Area
Main Building	832
OFP - 11:OFP OPEN FRAME PORCH	128