

Douglas County, NE

Summary

Parcel Number 1636620000
Key Number 3662 0000 16
Property Address 3927 AMES AV
 OMAHA, NE 68111
Brief Tax Description LOOMIS 2ND SUB DIV LOT 6 BLOCK 1 N 72 FT
 (Note: Not to be used on legal documents)
Class Commercial
Subdivision LOOMIS 2ND SUB DIV
Neighborhood MX RT_RES
Tax District 0100
Acres 0.07



[View Map](#)

Owners

[LANTEX LLC](#)
 1436 N 20 ST
 OMAHA, NE 68102

Buildings

Square Feet	3,475	Percent Complete	100
Unit Type		Quality	Average
Built As	Mixed Retail w/ Res Units	Condition	Average
Class Type	Masonry	Rooms	0
HVAC	Forced Air	Units	1
Exterior	Masonry Common Brick	Baths	0
ConstructionType	Masonry Common Brick	Bedrooms	0
Interior	Drywall	Stories	2
Roof Cover		Foundation	Concrete
Roof Type	Flat	Year Built	1905
Floorcover	Allowance	Adjusted Year Built	1905

Buildings Detail

Imp No.	Type	Description	Units
1	Add On	Paving Asphalt Park	500
1	Basement	Storage	1250

Land

Acres	SF	Units	Depth	Width	Vacant
0.07	3,168	1	0	0	No

Valuation

Assessed Year	2024	2023	2022	2021	2020
Assessed Land Value	\$3,300.00	\$3,300.00	\$3,100.00	\$3,100.00	\$3,100.00
Assessed Improvement Value	\$113,400.00	\$113,400.00	\$60,600.00	\$60,700.00	\$60,700.00
Assessed Total Value	\$116,700.00	\$116,700.00	\$63,700.00	\$63,800.00	\$63,800.00

Sales Information

Sale Date	Instrument Number	Sale Price	Grantor	Grantee	Deed Code
12/17/2012	2012128917	\$75,000	Harrell Romonda Watkins	Overton James R III	TRD

All Sales

Photos



[Print Photos](#)

Sketches

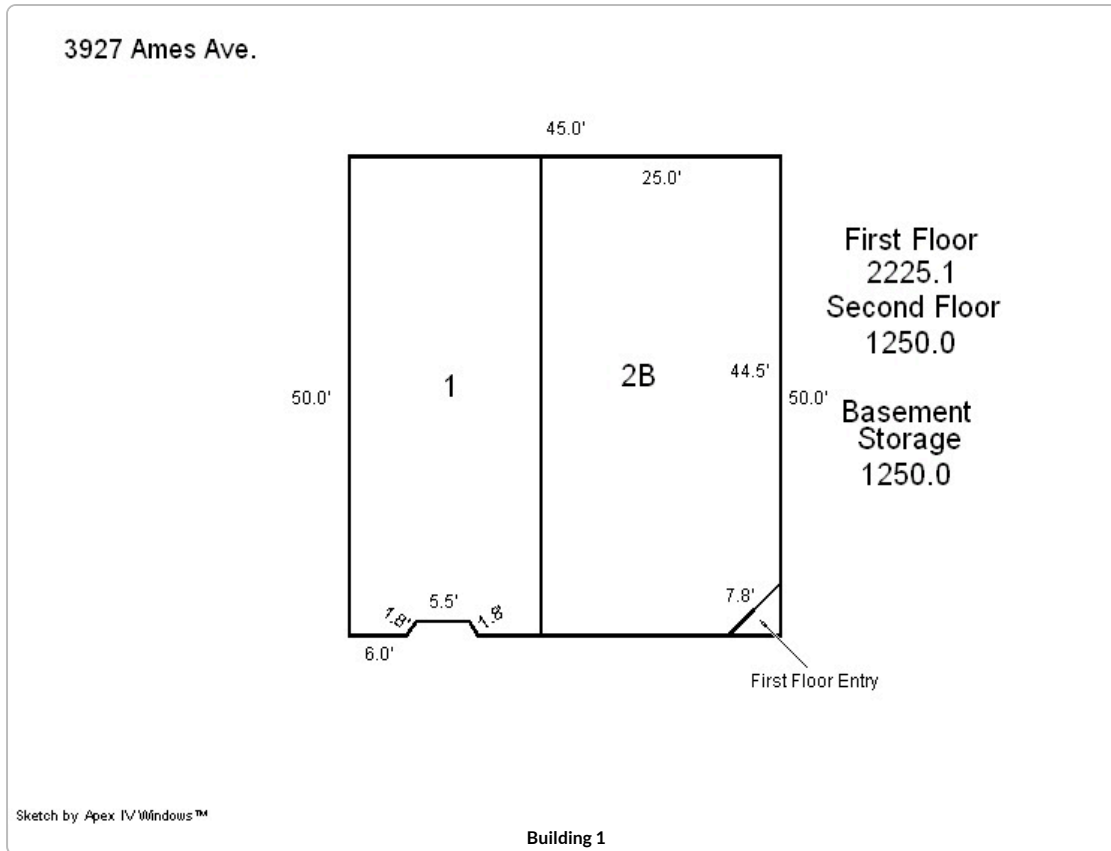

[Print Sketches](#)

Map



No data available for the following modules: Inactive Parcel Message, Extra Features, Farm Soils.

Welcome to the Douglas County NE Assessor website! This site is designed to make property records, sales data and maps more readily accessible. There are more than 225,000 parcels in Douglas County and each property owner matters and deserves the best possible service. The Douglas County, NE Geographic Information Web Server provides online access to geographic and assessment record info currently maintained by Douglas County, NE for individual parcels of property.
| [User Privacy Policy](#) | [GDPR Privacy Notice](#)
[Last Data Upload: 08/01/2025, 03:13:39](#)

[Contact Us](#)

