



## Property Information

File#: BS-W01492-6352120707  
Owner: ELSIE KYASKY  
Address 1: 30 Valley View Ave  
Address 2:  
City, State Zip: Derby, CT

## Request Information

Requested Date: 11/10/2023  
Branch:  
Date Completed:  
# of Jurisdiction(s):  
# of Parcel(s): 1

## Update Information

Update Requested:  
Requested By:  
Update Completed:

## Notes

CODE VIOLATIONS Per City of Derby Department of Zoning there are no Code Violation cases on this property.  
Collector: City of Derby  
Payable Address: 1 Elizabeth St, Derby, CT 06418  
Business# 203-736-1481  
UNABLE TO PROVIDE DOCUMENTATION TO THIRD PARTIES. VERBAL INFO ACQUIRED

PERMITS Per City of Derby Department of Building there are no Open/Pending/ Expired Permit on this property.  
Collector: City of Derby  
Payable Address: 1 Elizabeth St, Derby, CT 06418  
Business# 203-736-1481  
UNABLE TO PROVIDE DOCUMENTATION TO THIRD PARTIES. VERBAL INFO ACQUIRED

SPECIAL ASSESSMENTS Per City of Derby Finance Department there are no Special Assessments/liens on the property.  
Collector: City of Derby  
Payable Address: 1 Elizabeth St, Derby, CT 06418  
Business# 203-736-1481  
UNABLE TO PROVIDE DOCUMENTATION TO THIRD PARTIES. VERBAL INFO ACQUIRED

DEMOLITION NO

UTILITIES **WATER & SEWER:** THE HOUSE IS ON A COMMUNITY WATER & SEWER. ALL HOUSES GO TO A SHARED WELL & SEPTIC SYSTEM.  
GARBAGE : GARBAGE PRIVATE HAULER WITH LIEN STATUS AND BALANCE UNKNOWN



### Property Information

|                 |                                    |
|-----------------|------------------------------------|
| Owner           | KYASKY ELSIE                       |
| Address         | 30 SANTANGELO TERR                 |
| Mailing Address | 59 PAUGASSETT RD<br>DERBY CT 06418 |
| Land Use        |                                    |
| Land Class      | R R                                |

|                 |                          |
|-----------------|--------------------------|
| Neighborhood    | 703                      |
| Zoning          | R-M                      |
| Acreage         | 0                        |
| Utilities       | ALL PUBLIC<br>ALL PUBLIC |
| Lot Description | ABOVE STREET             |
| Census Tract    | 1202                     |

### Photo



### Sketch

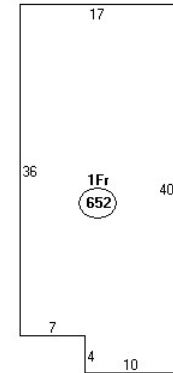

Descriptor/Area  
A: 1Fr  
652 sqft

### Construction Details

|                    |            |
|--------------------|------------|
| Year Built         | 1974       |
| Stories            | 1          |
| Building Style     | CONDO      |
| Building Condition | AVERAGE    |
| Total Rooms        | 3          |
| Bedrooms           | 1          |
| Bathrooms          | 1/0        |
| Roof Style         |            |
| Primary Ext. Wall  | ALUM/VINYL |
| Heating Type       | ELECTRIC   |
| Heating System     | ELECTRIC   |
| Heating Fuel       | ELECTRIC   |
| First Floor Area   |            |
| Total Living Area  | 652        |

### Parcel Valuations

(Assessed value = 70% of Appraised Value)

|              | Appraised    | Assessed     |
|--------------|--------------|--------------|
| Buildings    | 61200        |              |
| Land         | 0            |              |
| <b>Total</b> | <b>61200</b> | <b>42840</b> |

### Sales History:

|            |          |
|------------|----------|
| Sale Date  | 20090714 |
| Sale Price | 0        |
| Book/ Page | 586 80   |