



COUNTY OF HENRICO - FINANCE DEPARTMENT REAL ESTATE ASSESSMENT DIVISION

Address: 4301 E. Parham Rd.
Henrico, VA 23273-2745
Phone: 804-501-4300
Fax: 804-501-5420

(County Home) (Property Search)
(Residential Sales Search) (Commercial Sales Search)

Base Transfer & Assessment

(Back to Search)

(First) (Previous) 1 of 1 (Next) (Last) (View Large Map) (Display Summary for Printing)

Base Information

Parcel ID 751-753-6929
Vision PID # 28256
State Code R Resid (Urban)
Use Code 210 Res - Subd (1 Fam)
Tax Type Taxable
Zoning RTHC
Tax Dist Regular
Magisterial Three Chopt
Subdivision Aspen Grove
Section
Block A
Lot 12
Floodplain None Designated

Parcel Address 2221 ASPEN WAY
Appraiser L
Neighborhood 2W035
Acreage
Owner (Jan 1) POLUDNEVA VERONIKA EDUARDOVNA
Owner (Cur) POLUDNEVA VERONIKA EDUARDOVNA
Mailing Address
2221 ASPEN WAY
HENRICO VA
23233
Old Map # 0068130000A 0012
Pre 1992 Map # 86 B1 31
Map Page # 97

(Plats) (Old Property Card)

Image



Last Photo Update 01/30/2020

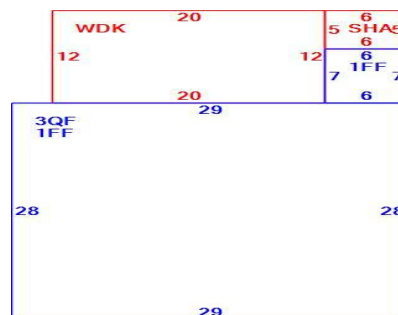

(Large Image) (Large Sketch)

School Information

Elementary **Middle** **High**
Davis Quiocassin Tucker

Residential Information

Style 12 Other 1.5/1.75 Story **No. of Stories** 1.75 **Sq Ft Finished Living** 1,463
Year Built 1983 **Total Rooms** 5 **Finished Attic** 0
Grade C+1 **Bedrooms** 2 **Unfinished Living** 0
Ext. Walls 02 Composition **Full Bathrooms** 2 **Basement** 0
Roof 1 Composition **Half Bathrooms** 0 **Finished Basement** 0
Heating 05 Heat Pump **Fireplace(s)** 1 **Foundation Type** 1 Crawl
Air Cond. 01 Yes **No. of Chimneys** 1 **Basement Garage** 0

Last Transfer

(Additional Transfer & Assessments)

Sale Date	Sale Price	Deed Book	Page	Previous Owner	Sale Comment
12/13/2019	\$220,000	5931	2233	POLUDNEVA MAINA M	Non-Qualified

Current Assessment

Year	Date	Land	Land Use	Improvements	Total
2025	01/24/2025	\$85,000		\$214,300	\$299,300

Additions, Outbuildings and Features

Type	Improvement	Units/Area
Addition	Deck	240
Addition	Shed Attached	30

Land Information

Type	# Units	Unit Type	Sqft	Zoning
G2	1	UT	0	RTHC

Notes

11-30-01-Poludneva Maina M & Edward Shamis DB-3180-2020.....
1 - 1

Sketch Details

Code	Desc	Gross	Living
1FF	1st Fl Finished	854	854
3QF	3/4 St Finished	609	609
SHA	Shed Attached	30	0
WDK	Deck	240	0
		1 - 4	

Map

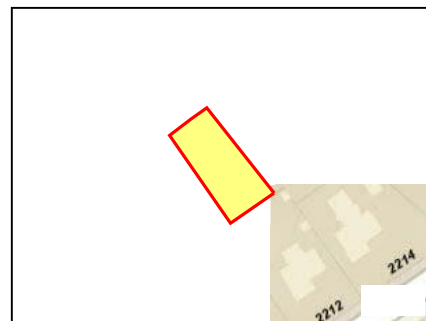

(View Large Map)

Legal Disclaimer: Non-confidential real estate assessment records are public information under Virginia law, and Internet display of non-confidential property information is specifically authorized by Virginia Code 58.1-3122.2. While the Real Estate Division has worked to ensure that the assessment data contained herein is accurate, Henrico County assumes no liability for any errors, omissions, or inaccuracies in the information provided or for any reliance on any maps or data provided herein. Please consult County records in the Real Estate Division for official information.

Click [Real Estate Comments](#) to submit comments or corrections.