



Property Information		Request Information		Update Information
File#:	BS-Y01935-5720943553	Requested Date:	06/27/2025	Update Requested:
Owner:	WILLIAM NAHODIL	Branch:		Requested By:
Address 1:	779 HIGH RD	Date Completed:	07/24/2025	Update Completed:
Address 2:		# of Jurisdiction(s):		
City, State Zip:	ASHLAND, PA	# of Parcel(s):	1	

Notes

CODE VIOLATIONS	<p>Per Butler Township Department of Zoning there are No Open Code Violation cases on this property.</p> <p>Collector: Butler Township Payable Address:211 Broad St, Ashland, PA 17921 Business#: (570) 875-4137</p> <p>UNABLE TO PROVIDE DOCUMENTATION TO THIRD PARTIES. VERBAL INFO ACQUIRED</p>
PERMITS	<p>Per Butler Township Building Department there are No Open/Pending/Expired Permits on this property.</p> <p>Collector: Butler Township Payable Address:211 Broad St, Ashland, PA 17921 Business#: (570) 875-4137</p> <p>UNABLE TO PROVIDE DOCUMENTATION TO THIRD PARTIES. VERBAL INFO ACQUIRED</p>
SPECIAL ASSESSMENTS	<p>Per Butler Township Treasurer's Office there are no Special Assessments/liens on the property.</p> <p>Collector: Butler Township Payable Address:211 Broad St, Ashland, PA 17921 Business#: (570) 875-4137</p> <p>UNABLE TO PROVIDE DOCUMENTATION TO THIRD PARTIES. VERBAL INFO ACQUIRED</p>
DEMOLITION	NO
UTILITIES	<p>Water and Sewer The House is on a community Water and sewer. All houses go to the shared well and septic system.</p> <p>Garbage Garbage Private Hauler with Lien Status and balance Unknown</p>

779 HIGH RD

Location	779 HIGH RD	Tax Map	04/ 35/ 0061/ 002/
Control#	00005614	Owner	NAHODIL, WILLIAM E
Property Type	Residential Bldg, <10 Acres	Assessment	\$64,210
PID	5614	Tax Status	T
School District:	North Schuylkill School Distri	Homestead Appr	Y
Farmstead Appr	N	Assessing Distr...	0410 - Butler - Helfenstein
Lot Type	Rural	Terrain	Rolling
Road Type	Paved	Utilities	None
Sewer	Septic Or Equivalent	Water	Well
Historic	No	Rail Avl	No
Sidewalk	No	Road Access	Conventional
Hard Top Drive	Yes	Waterfront	N
Superior View	N	Gas in Use?	N
Tree Cover	O	District	04: Butler Township

Current Value

Assessment			
Valuation Year	Improvements	Land	Total
1996	\$52,635	\$11,575	\$64,210

Owner of Record

Owner	NAHODIL, WILLIAM E	Sale Price	\$1
Co-Owner		Certificate	
		Book & Page	2141-1341
Address	779 HIGH RD	Sale Date	03/18/2005
	ASHLAND, PA 17921		

Ownership History

Ownership History				
Owners	Sale Price	Certificate	Book & Page	Sale Date
NAHODIL, WILLIAM E	\$1		2141-1341	03/18/2005
NAHODIL, SUSAN S; NAHODIL, WILLIAM E	\$9,700		1465-0357	06/25/1991

Building Information

Building 1 : Section 1

Year Built: 1992
Living Area: 2,232

Building Attributes	
Field	Description
Attic Heat	
Model	Residential
Stories	Two Story
Int vs Ext	Same

Building Photo

 Building Photo
(<https://images.vgsi.com/photos/schuylkillcountypaPhotos//\Photo>)

Full Bath(s)	2
Half Bath(s)	1
Bedroom(s)	4
Total Rooms	7
Basement	100 (76%-100%)
Bsmt Exposure	Walkout
BSMT Fin (web)	0
Bsmt Garage(s)	0
Dwell Typ/Bld Use	01 Detach (Single Family)
Style	Conventional
Roof Structure	Gable
Roof Cover	Asphalt
Exterior Wall 1	Vinyl
Exterior Wall 2	
Heat Fuel	Oil
Heat Dist.	Hot Water
AC Type	None
Fireplace(s)	0
Attic (P/S)	None
MH Park ID	
MH Class	
Grade	B03
Govern BaseRate	04C-25
Econ Dep Adj	

Building Layout

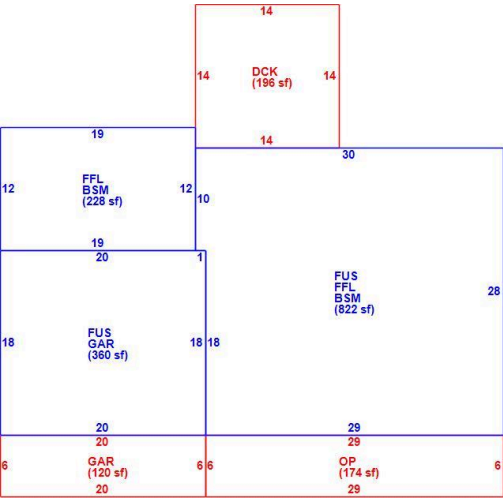

Building Sub-Areas (sq ft)		Legend	
Code	Description	Gross Area	Living Area
FUS	R-FINISHED UPPER STORY	1,182	1,182
FFL	R-FIRST FLOOR	1,050	1,050
BSM	Basement (Finished or Not)	1,050	0
DCK	R-DECK	196	0
GAR	Garage (Vehicle Storage)	480	0
OP	R-OPEN PORCH	174	0
		4,132	2,232

Parcel Information

Use Code 101
Description Res. 1 Family
Deeded Acres4.4

Land

Land Use

Use Code 101
Description Res. 1 Family
Neighborhood 0410 - Butler - Helf
Clean & Green ApprovedNo

Land Line Valuation

Size (Acres)4.4
Frontage
Depth

Outbuildings

Outbuildings					
Code	Description	Sub Code	Sub Description	Size	Bldg #
swimpo	15 Swimming pool (in-ground)	POOL	Pool	500.00 SF	1
shedcl	10 shedcls (Closed Shed)	W	Wood	288.00 SF	1
shedcl	10 shedcls (Closed Shed)	W	Wood	288.00 SF	1
Poolap	38 Poolaprn (Pool Apron)	CN	Concrete	700.00 SF	1
Slab	35 Slab	CN	Concrete	564.00 SF	1

Valuation History

Assessment			
Valuation Year	Improvements	Land	Total
2026	\$211,000	\$82,800	\$293,800
2025	\$52,635	\$11,575	\$64,210