



Property Information Request Information Update Information

| | | | | |
|------------------|---------------------|-----------------------|------------|-------------------|
| File#: | BS-W01492-117499819 | Requested Date: | 11/28/2023 | Update Requested: |
| Owner: | ANDREW SULLIVAN | Branch: | | Requested By: |
| Address 1: | 47 FOREST DR | Date Completed: | | Update Completed: |
| Address 2: | | # of Jurisdiction(s): | | |
| City, State Zip: | MASHPEE, MA | # of Parcel(s): | 1 | |

Notes

CODE VIOLATIONS Per Town of Mashpee Department of Zoning there are no Code Violation cases on this property.
 Collector: Town of Mashpee Department of Zoning
 Payable: 16 Great neck road North Mashpee MA 02649
 Business# 508-539-1406

PERMITS Per Town of Mashpee Building Department there are no Open/Pending/ Expired Permit on this property.
 Collector: Town of Mashpee Building Department
 Payable: 16 Great neck road North Mashpee MA 02649
 Business# 508-539-1406

SPECIAL ASSESSMENTS Per Town of Mashpee Tax Collector there are no Special Assessments/liens on the property.
 Collector: Town of Mashpee Tax Collector
 Payable: 816 Great neck road North Mashpee MA 02649
 Business# 508-539-1419

UNABLE TO PROVIDE DOCUMENTATION TO THIRD PARTIES. VERBAL INFO ACQUIRED

DEMOLITION NO

UTILITIES **WATER**
 Account #: 7674
 Payment Status: PAID
 Status: Pvt & Lienable
 Amount: \$0.00
 Good Thru: NA
 Account Active: YES
 Collector: Town of Mashpee Water District
 Payable Address: 79 Industrial Dr, Mashpee, MA 02649
 Business # 508-477-6767

UNABLE TO PROVIDE DOCUMENTATION TO THIRD PARTIES. VERBAL INFO ACQUIRED

SEWER
 The house is on a community sewer. All houses go to a shared septic system.

GARBAGE
 GARBAGE PRIVATE HAULER WITH LIEN STATUS AND BALANCE UNKNOWN

Key: 1440

Town of Mashpee - Fiscal Year 2023

11/29/2022 2:35 pm SEQ #: 1.374

LEGALS

| CURRENT OWNER | | | | PARCEL ID | | | | LOCATION | | | |
|--|--|--|--|------------|----|------------|--------------|--------------|--|--|--|
| SULLIVAN, ANDREW M PO BOX 293 SANDWICH, MA 02563 | | | | 29-65-0 | | | | 47 FOREST DR | | | |
| TRANSFER HISTORY | | | | DOS | T | SALE PRICE | BK-PG (Cert) | | | | |
| SULLIVAN, ANDREW M | | | | 05/11/2001 | QS | 145,000 | 13822-56 | | | | |
| HUMBER LAURENCE E & MARGA | | | | 05/12/1997 | J | 1 | 10743-337 | | | | |
| CELLA JOHN & MARGARET HUM | | | | 07/11/1974 | XX | | 2069-70 | | | | |

| CLASS | CLASS% | DESCRIPTION | | | BN ID | BN | CARD | |
|--------|--------|---------------|--------------|--------|------------|-----|--------|-----|
| 1010 | 100 | SINGLE FAMILY | | | | 1 | 1 of 1 | |
| PMT NO | PMT DT | TY | DESC | AMOUNT | INSP | BY | 1st | % |
| | | 7 | CYCLICAL REV | | 03/09/2018 | WFF | 100 | 100 |
| | | 7 | CYCLICAL REV | | 10/08/2008 | TWM | 100 | 100 |

LAND

| CD | T | AC/SF/UN | Area | Infl-1 | Infl-2 | ADJ BASE | SAF | Topo | Lpi | VC | CREDIT AMT | ADJ VALUE | |
|-----|---|------------|------|--------|--------|----------|------|---------|------|-----|------------|-----------|---------|
| 100 | S | 11,905 PND | 1.00 | 100 | 1.00 | 100 | 1.00 | 238,050 | 2.83 | 100 | 1.00 | PAV 1.15 | 184,070 |

| | | | | | | | | |
|--------|-----------|--------|--------------------|---------|---------|----------|---------|----------|
| TOTAL | 11,892 SF | ZONING | R5 | FRNT | 0 | ASSESSED | CURRENT | PREVIOUS |
| Area | PONDS | NOTE | NARROW/SMALL ROOMS | | | LAND | 184,100 | 149,700 |
| Infl-1 | NO ADJUST | | BUILDING | 157,400 | 130,300 | | | |
| Infl-2 | NO ADJUST | | DETACHED | 1,000 | 900 | | | |
| | | | OTHER | 0 | 0 | | | |
| | | | | | TOTAL | 342,500 | 280,900 | |

DETACHED

| TY | QUAL | COND | DIM/NOTE | YB | UNITS | ADJ PRICE | RCNLD |
|-----|------|------|---------------|------|-------|-----------|-------|
| SHF | A | 1.00 | 10 0.90 10X16 | 2005 | 160 | 7.28 | 1,000 |



BLDG COMMENTS

BUILDING

| BUILDING | CD | ADJ | DESC | MEASURE | 3/9/2018 | WFF |
|----------|----|------|-------------------|---------|-----------|-----|
| MODEL | 1 | | RESIDENTIAL | LIST | 7/8/1993 | GF |
| STYLE | 1 | 1.10 | RANCH [100%] | REVIEW | 3/21/2018 | TD |
| QUALITY | C- | 0.90 | AVG. (-) [100%] | | | |
| FRAME | 1 | 1.00 | WOOD FRAME [100%] | | | |

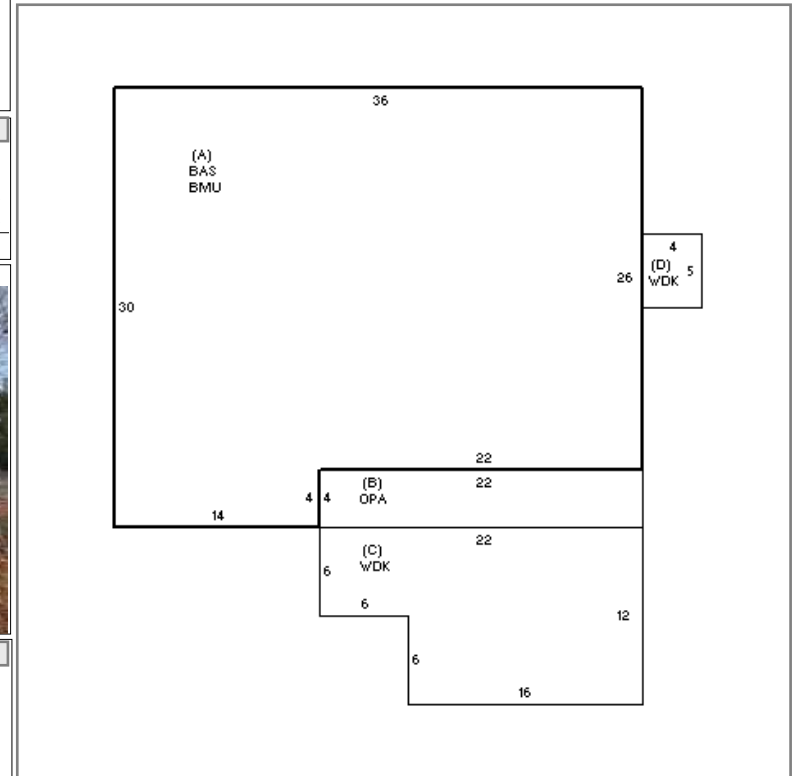

FINING

| YEAR BLT | 1973 | SIZE ADJ | 1.260 |
|------------|-------|------------|-------|
| NET AREA | 992 | DETAIL ADJ | 1.000 |
| \$NLA(RCN) | \$230 | OVERALL | 1.100 |
| CAPACITY | | UNITS | ADJ |
| STORIES | 1 | 1.00 | |
| ROOMS | 4 | 1.00 | |
| BEDROOMS | 3 | 1.00 | |
| BATHROOMS | 1 | 1.00 | |
| UNITS | 1 | 1.00 | |
| HALFBATHS | 0 | 1.00 | |
| FIXTURES | 3 | \$3,080 | |

| ELEMENT | CD | DESCRIPTION | ADJ |
|-----------------|----|-----------------|------|
| FOUNDATION | 4 | BSMT WALL | 1.00 |
| EXT. COVER | 10 | VERT. BOARD | 1.00 |
| ROOF SHAPE | 1 | GABLE | 1.00 |
| ROOF COVER | 1 | ASPHALT SHINGLE | 1.00 |
| FLOOR COVER | 3 | W/W CARPET | 1.00 |
| INT. FINISH | 4 | WALL BOARD | 1.00 |
| HEATING/COOLING | 1 | FORCED AIR | 1.00 |
| FUEL SOURCE | 2 | GAS | 1.00 |
| MODEL | 0 | | 1.00 |

| S | BAT | T | DESCRIPTION | UNITS | YB | ADJ PRICE | RCN |
|---|-----|---|-----------------|-------|------|-----------|---------|
| A | BMU | N | BSMT TOTAL AREA | 992 | | 48.37 | 47,984 |
| A | BAS | L | BAS AREA | 992 | 1973 | 165.03 | 163,711 |
| B | OPA | N | OPEN PORCH | 88 | | 48.15 | 4,237 |
| + | WDK | N | ATT WOOD DECK | 248 | | 36.87 | 9,143 |

| TOTAL RCN | 228,155 | |
|----------------|-----------|---------|
| CONDITION ELEM | CD | |
| EXTERIOR | A | |
| INTERIOR | A | |
| KITCHEN | A | |
| BATHS | A | |
| HEAT/ELEC | A | |
| EFF.YR/AGE | 1979 / 42 | |
| COND | 31 31 % | |
| FUNC | 0 | |
| ECON | 0 | |
| DEPR | 31 | % GD 69 |
| RCNLD | \$157,400 | |

Re: 47 FOREST DR - Public Records Request

Tamara Gray <TGray@mashpeema.gov>

Mon 11/13/2023 11:52 AM

Cc: Terrie Cook <tmcook@mashpeema.gov>

You don't often get email from tgray@mashpeema.gov. [Learn why this is important](#)

Dear Alfred,

Regarding your Public Record Request for 47 Forest Drive in Mashpee, there are no open permits or code violations.

If you request further information feel free to contact me.

Tamara Gray

Administrative Assistant / Building Department

Town of Mashpee

16 Great Neck Road, North

Mashpee, MA 02649

508-539-1406



"Preserving public trust and providing professional services."

Notice: This communication is intended for the listed recipient only. If you have received this in error, it may be unlawful and prohibited to retain, reproduce or disseminate this message. Please reply to sender if you have received this message in error and delete it with any attachments. Warning: The content of this message and any response may be considered a Public Record pursuant to Massachusetts General Law.