



**Property Information                      Request Information                      Update Information**

File#:	BS-X01542-2980791534	Requested Date:	01/18/2024	Update Requested:
Owner:	VERNON PATTON	Branch:		Requested By:
Address 1:	432 NATIONAL UN BLVD	Date Completed:		Update Completed:
Address 2:		# of Jurisdiction(s):		
City, State Zip:	TUCKERTON, NJ	# of Parcel(s):	1	

**Notes**

CODE VIOLATIONS                      Per Little Egg Harbor Township Department of Zoning there are no Code Violation cases on this property.

Collector: Little Egg Harbor Township Department of Zoning  
Payable: 665 Radio Road Little Egg Harbor, NJ 08087  
Business# 609-296-7241

UNABLE TO PROVIDE DOCUMENTATION TO THIRD PARTIES. VERBAL INFO ACQUIRED

PERMITS                      Per Little Egg Harbor Township Building Department there are no Open/Pending/ Expired Permit on this property.

Collector: Little Egg Harbor Township Building Department  
Payable: 665 Radio Road Little Egg Harbor, NJ 08087  
Business# 609-296-7241

UNABLE TO PROVIDE DOCUMENTATION TO THIRD PARTIES. VERBAL INFO ACQUIRED

SPECIAL ASSESSMENTS                      Per Little Egg Harbor Township Tax Collector there is a Special Assessments Due on this property.

Collector: Little Egg Harbor Township Tax Collector  
Payable: 665 Radio Road Little Egg Harbor, NJ 08087  
Business# 609-296-7241

Comments: Per Little Egg Harbor Township Tax Collector there is a Special Assessments Due on this property. Please contact Little Egg Harbor Township Tax Collector at 609-296-7241 for further queries.

UNABLE TO PROVIDE DOCUMENTATION TO THIRD PARTIES. VERBAL INFO ACQUIRED

DEMOLITION                      No



UTILITIES

WATER AND SEWER

Account #: NA

Payment Status: NA

Status: Pvt & Lienable

Amount: NA

Good Thru: NA

Account Active: NA

Collector: Little Egg Harbor Municipal Utilities Authority

Payable Address: 823 Radio Rd, Little Egg Harbor Township, NJ 08087

Business # 609-296-1168

UNABLE TO PROVIDE INFO TO THIRD PARTIES. HOMEOWNER AUTHORIZATION NEEDED

GARBAGE

GARBAGE PRIVATE HAULER WITH LIEN STATUS AND BALANCE UNKNOWN

Block: 325.65 Lot: 17 Qualifier: Card: 1 Last Sale: 12/20/21 for \$235,000

PATTON, VERNON  
 432 NATIONAL UNION BLVD  
 LITTLE EGG HARBOR NJ 08087  
 432 NATIONAL UNION BLVD.

Units: 1 Nbhd: Model: VCS: 718  
 SFLA: 1584 Floor: Bldg Name: Map Page: 71  
 Prop Class: 2 Occupancy: Zoning: R-75 Year Built: 1983/2005  
 Bldg Class: 16 Addtl Lot: NC Interior: GOOD  
 Bldg Desc: 1S-AL-R Land Dim: 84X100 NC Exterior: GOOD  
 Info By: OWNER Style: RANCH NC Layout: GOOD

Notes:

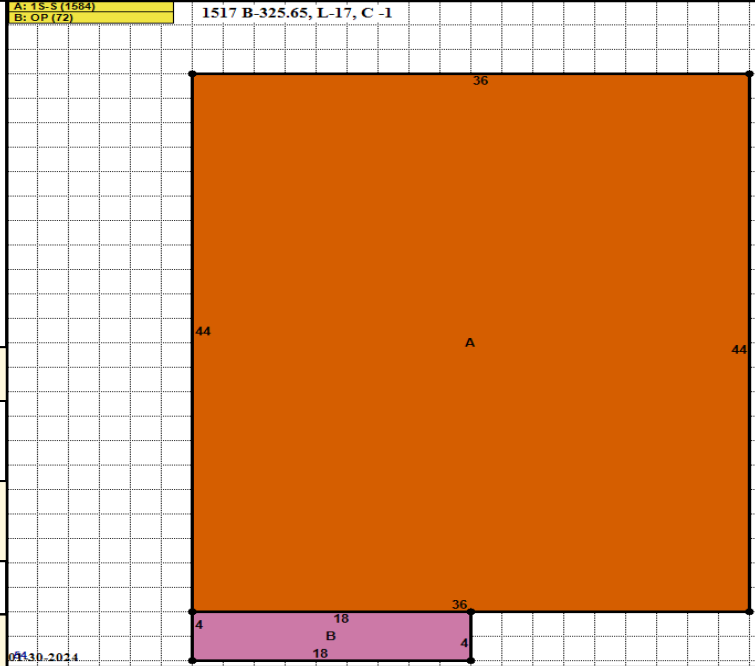

Room Count						
	B	1	2	3	4	T
Living	0	1	0	0	0	1
Dining	0	0	0	0	0	0
Kitchen	0	1	0	0	0	1
Bath	0	2	0	0	0	2
Bed	0	4	0	0	0	4
Rec	0	0	0	0	0	0
Den	0	0	0	0	0	0
Total	0	8	0	0	0	8

Valuation Summary			
	Computed	Override	Summary
Land	71,900		71,900
Improv	116,600		116,600
Total	188,500		188,500

Floor Area (footprint)					
Item	Bsmnt	First Uppr		Half	Attic
		Floor	Story		
A 1S-S	0	1,584	0	0	0
Totals	0	1,584	0	0	0

SqFt Living Area		Sketch Areas	
Item	Area	Description	Sq Ft
First Floor	1,584	A 1S-S	1,584
Upper Floor	0	B OP	72
Half Story	0		
Fin Attic	0		
Living Bsmnt	0		
Unfin Area (-)	0		
Total Area	1,584		

Attached Items		
Seg	Item	Area
B	OPEN PORCH	72
	Total Area	72

Detached Items			
Desc	Area		
	Miscellaneous	Write Ins	
Desc	Number	Desc	Value

Dwelling Detail	
Element	Description
Bldg Class	16
Type	ONE FAMILY
Yr Built	1983/2005
Height	1 STORY
Style	RANCH
Roof Type	GABLE
Roof Mat.	ASPH SHNGL
Bsmnt/Fin	
Foundation	CONC. SLAB
Exterior	ALUM/VINYL
Interior	DRYWALL
Floor	MIXED
Heat Src	GAS
Heat Sys	1584-ELECTRC BB
Air Cond	NONE
Fireplace	1-FRESTND FP 1-GAS FIREPLACE
Plumbing	2-3FIX BATH

Sales History				
Owner	Date	Book-Page	Price	NU
PATTON, VERNON	12/20/21	18959-01257	235,000	07
MCCLAREN, KENNETH E & RO		00000-00000		

Assessment History				
Year	Class	Land	Improv	Net
2024	2	71,900	116,600	188,500
2023	2	71,900	116,600	188,500
2022	2	71,900	91,500	163,400
2021	2	71,900	91,500	163,400
2020	2	71,900	91,500	163,400

Open Permits			
Open Date	Number	Description	Value