

6/29/2023

<p>General Information</p> <p>Tax Map 48-06-0236.000</p> <p>Parcel Address 1237 E MAHANOE AVENUE MAHANOE CITY, PA 17948</p> <p>School District Mahanoe Area Municipality Mahanoe City Borough</p>	<p>Legal Information</p> <p>Front Of Lot: 13 Depth: 125 Unit of Front: f Acres: 0.04 Land Use Type: 102 Roll Section: 1 Assessment Property Class: R (Assessment Property Class is NOT a Zoning Classification. Contact the appropriate Municipal Zoning Officer for Zoning Info.)</p>
--	---

Current Ownership Information			
Owner Name	Owner Address	Deed Bk/Pg	Sale Date
STOFANIK JUSTIN	1237 E MAHANOE AVE MAHANOE CITY, PA 17948	2279/1470	10/31/2007

Bill To Information	
Owner Name	Owner Address
STOFANIK JUSTIN	1237 E MAHANOE AVE MAHANOE CITY, PA 17948

<p>Value Data</p> <p>BASE YEAR: 1996</p> <table border="0"> <tr> <td>Base Year Value</td> <td>Assessed Value</td> </tr> <tr> <td>Land: 3660</td> <td>Land: 1830</td> </tr> <tr> <td>PA Ag Land:</td> <td>PA Ag Land:</td> </tr> <tr> <td>Misc Structures:</td> <td>Improvements: 10720</td> </tr> <tr> <td>Buildings: 21440</td> <td>Total: 12550</td> </tr> <tr> <td>Total: 25100</td> <td></td> </tr> </table> <p>Status</p> <p>Clean & Green: N Homestead: H</p>	Base Year Value	Assessed Value	Land: 3660	Land: 1830	PA Ag Land:	PA Ag Land:	Misc Structures:	Improvements: 10720	Buildings: 21440	Total: 12550	Total: 25100		<p>Site Information</p> <p>Site: L Terrain: Water Type: P Sewer Type: S Natural Gas: N Road Type: P Location Type: SPOT Road Access: C Sidewalk: Y Fronting: RES Rail Access: N</p>
Base Year Value	Assessed Value												
Land: 3660	Land: 1830												
PA Ag Land:	PA Ag Land:												
Misc Structures:	Improvements: 10720												
Buildings: 21440	Total: 12550												
Total: 25100													

[View Sales History](#)

Building Information	Hide Buildings	
Building (resident) 1 of 1		
Stories: 2	Finished Basement:	Total Living Area: 2188
Total Rooms: 12	Attic with Stairs UNF	Total Perimeter: 310
Bed Rooms: 6	Dug Basement %: 75	Exterior Wall 1 : V
Family Rooms: 0	Year Built: 1890	Exterior Wall 2 :
Full Baths: 2	Effective Age: 1890	# of Car Garage: 0
Half Baths: 0	Exterior Condition: G	Sq. Ft of Garage:
Heating Type: HW	Interior Condition: S	Sq. Ft. Encl. Porch: 50
Fireplace Count: 0	House Grade: D	Building Value: 21436
Central Air: N	Building Use Code: DUPLEX	
Sketch Floor:	Unfinished Basement:	Heating Type:
Floor Type/Finish:	Interior Wall:	Class of Construction:
Commercial Grade:	Exterior Wall:	

Miscellaneous Structures	Hide Structures
No Miscellaneous Structures Found	

Sketches	Hide Sketches
Image Id:37004-0	

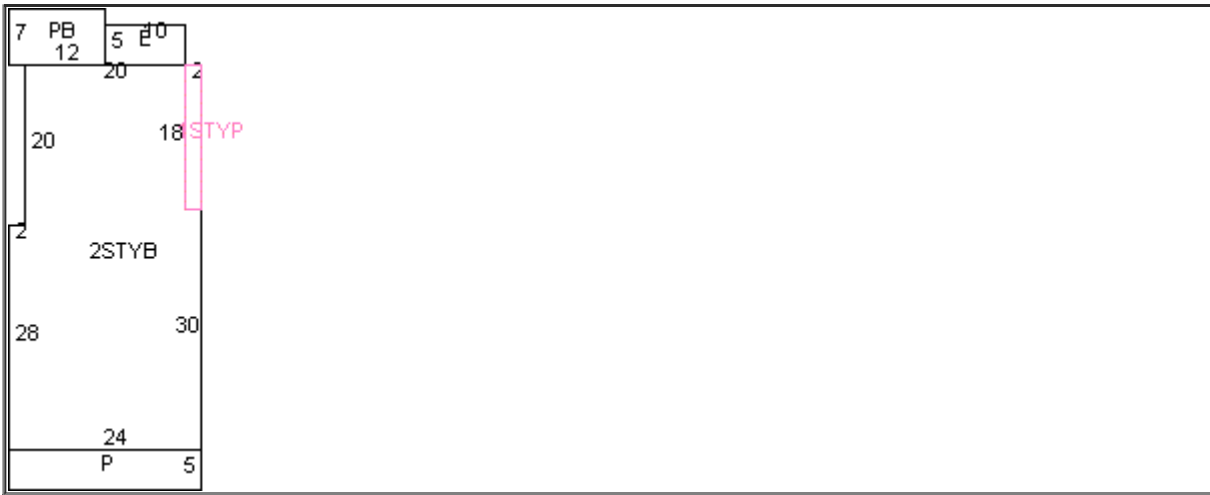

Pictures

[Hide Pictures](#)

Pictures: 1

